

filling

WOOD GUARD RAIL REQUIRED

Sta 530+22 to Sta 530+52	ON LEFT	Length	24 ft
Sta 534+88 " " 535+12	"	"	24 "
Sta 530+28 to Sta 530+52	ON RIGHT	Length	24 ft
" 534+88 " " 535+12	"	"	24 "
TOTAL THIS SHEET			96 ft

NEW CULVERTS REQUIRED

Sta. 530+10	18" Conc or Cast Iron Pipe	36 ft.
	Class B Concrete CI-2X-5J	2.7 Cuyds.
	Reinf. Steel	33 lbs.
Sta. 534+85	18" Conc or Cast Iron Pipe	32 ft.
	Class B Concrete CI-2X-5J	2.4 Cuyds.
	Reinf. Steel	33 lbs.

6" SUBBASE
Sta. 527+00 to Sta. 535+24 Length 824 ft.

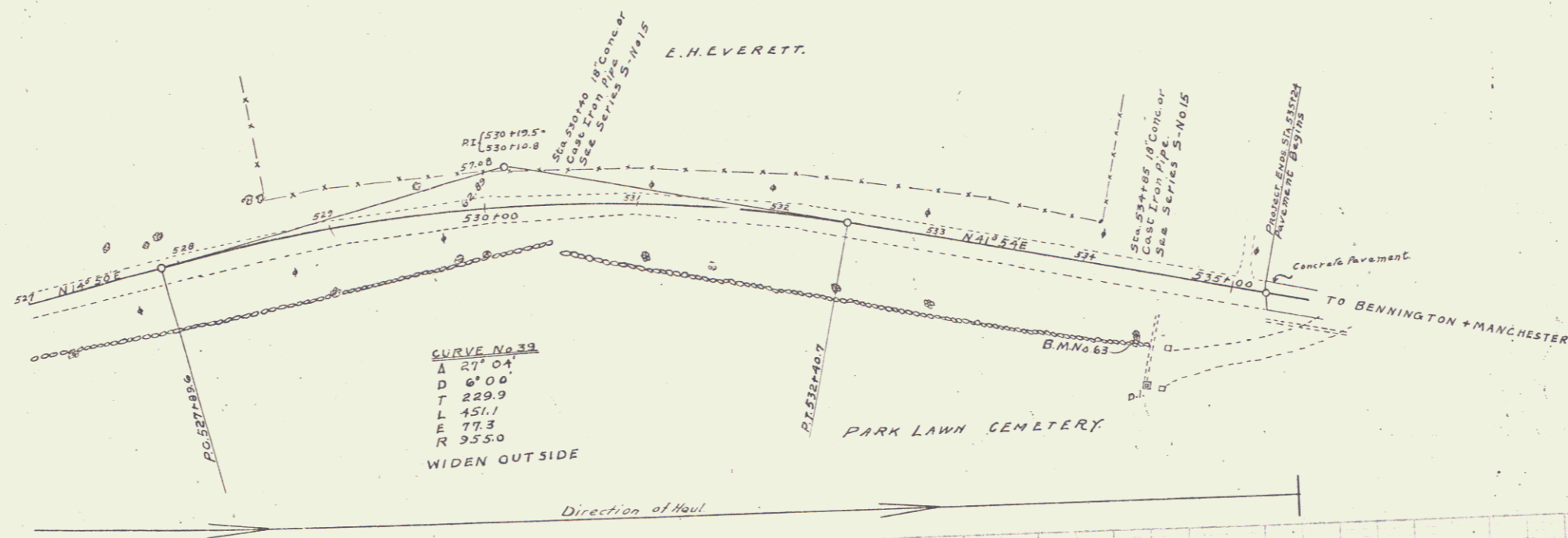

CURVE No. 39
 A 271.04
 D 6' 00"
 T 229.9
 L 151.7
 E 77.3
 R 355.0
 WIDEN OUTSIDE

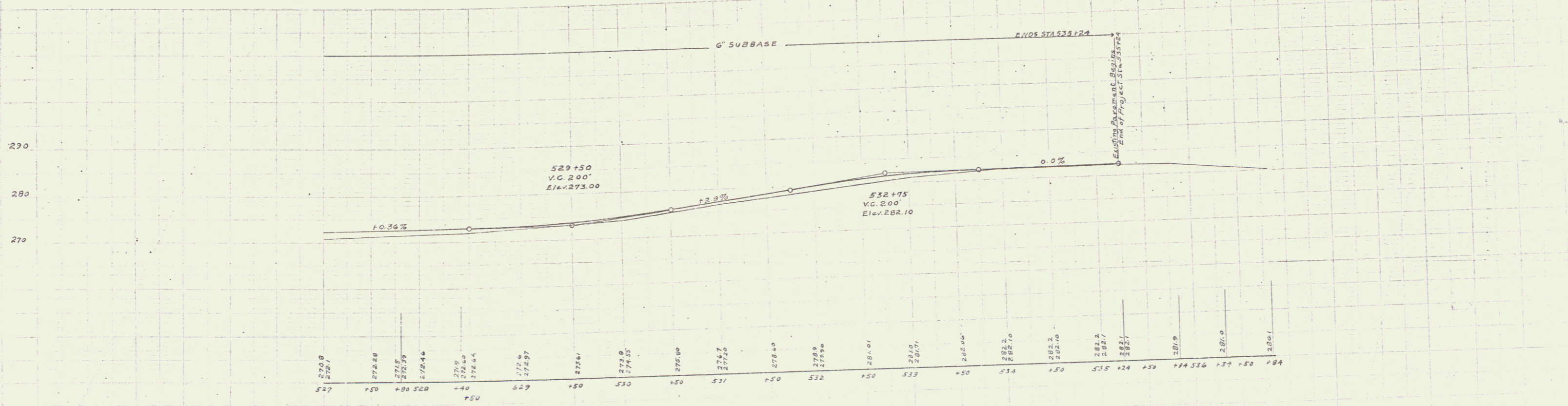

B.M. No 63 Spike in 24" Maple, Right of STA 534+45 Elev. 284.87

Series F No 73B
Sheet 23 of 73