

WOOD GUARD RAIL REQUIRED

Sta	to Sta	Length
302+00	to 302+172	Length 72 ft
301+00	to 301+55	Length 55 ft
302+38	to 302+62	24
306+88	to 307+12	24
TOTAL THIS SHEET 175 ft		

CABLE GUARD RAIL REQUIRED

Sta	to Sta	Length
300+70	to 300+100	Length 30 ft

NEW CULVERTS REQUIRED

Sta 392+50	15" Reinf Conc. or Cast Iron pipe Length 32 ft
	Class B. Con. (1-21-3) 21 Cyhd
	Reinf Steel 33 lbs
Sta 307+00	15" Reinf Conc. or Cast Iron pipe Length 36 ft
	Class B. Con. (1-21-3) 21 Cyhd
	Reinf Steel 33 lbs

6" SUB-BASE REQUIRED
Sta 304+00 to Sta 308+00 Length 1400 ft

738 1326 13 73

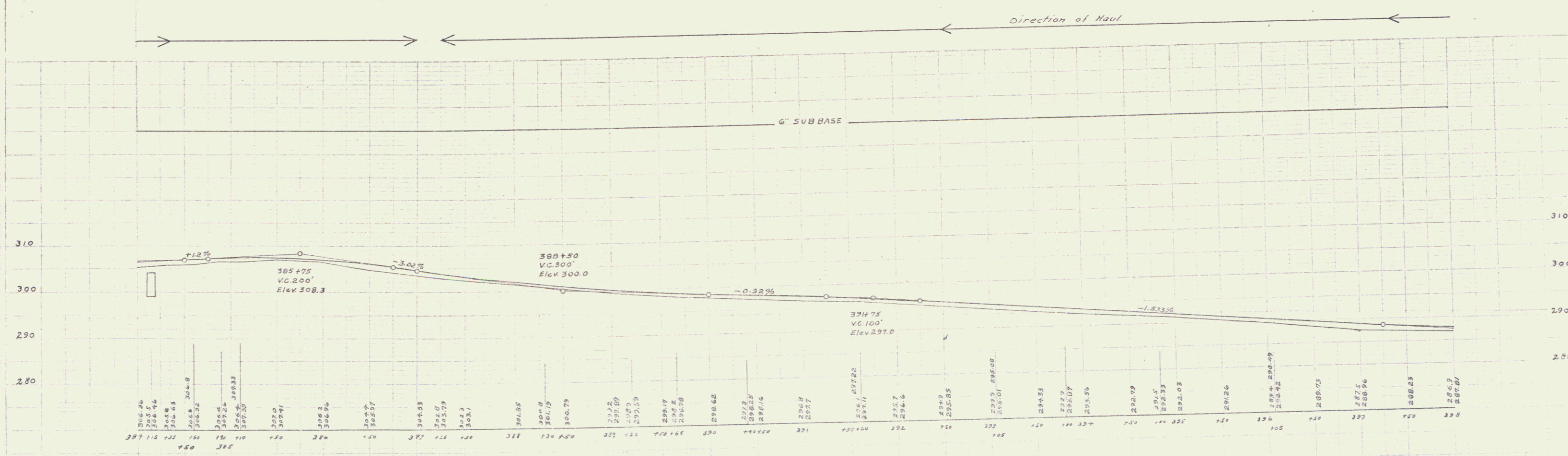
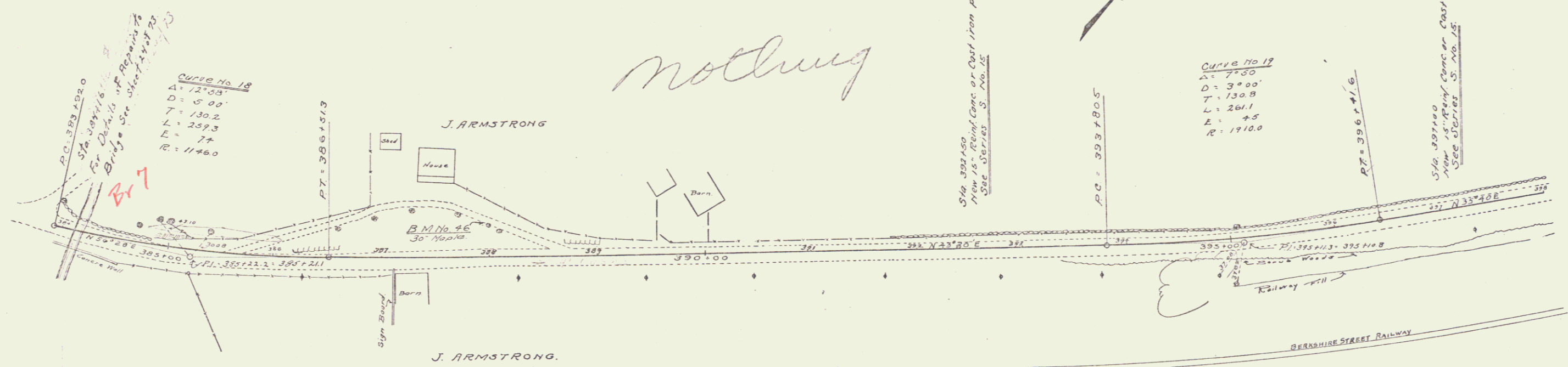

B.M. No 46 Spike in 30" Maple, Left of Sta. 308+00 Elev. 305.93

Series F No 735
Sheet 13 of 73