

FED. ROAD DIST. NO.	STATE	FED. AID PROJ. DIST.	TOTAL PROJ. COSTS	TOTAL COSTS
9	Vt.	73-C 1924	1	5

**INDEX OF SHEETS**

SHEET NO. 1 TITLE PAGE

- 2 TYPICAL CROSS-SECTION OF IMPROVEMENT
- 3 PLAN AND PROFILE STA. 238+00 TO STA 250+00
- 4
- 5 PLAN OF BRIDGE STA. 242+75 TO STA 242+54.0
- 6 TO 8 Cross Sections.

STATE OF VERMONT  
STATE HIGHWAY DEPARTMENT

PLAN AND PROFILE OF PROPOSED  
STATE HIGHWAY  
FEDERAL AID PROJECT

TOWN OF POWNAL.

POWNAL CENTER ROAD. *Route US Rte 7*

FROM NORTH END OF F.A.P 73-A NORTHERLY  
0.228 MILES TO SOUTH END  
OF F.A.P 73-B.

*Pin # 99R524*

*Project: FAP73C*

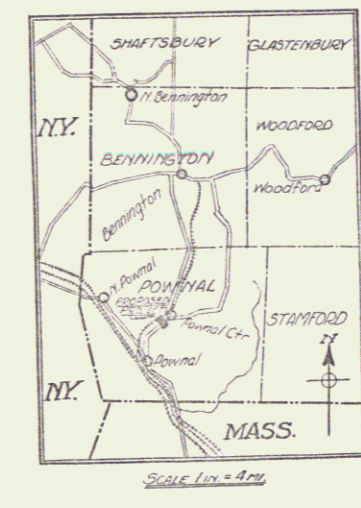

SCALES

PLAN: 1 INCH = 50 FEET  
PROFILE (HORIZ.) 1 IN = 50 FT.  
PROFILE (VERT.) 1 IN = 10 FT.  
CROSS SECTIONS 1 IN = 5 FT.

MP 4.45 - 4.68  
RIGHT-OF-WAY DIVISION  
TOWN FILE  
PERPETUAL  
Town of Pownal  
(To Be Returned To R.O.W. Division)

APPROVED: *July 16, 1926*  
*H.E. Sauguet*  
CHIEF ENGINEER  
SUBMITTED BY ORDER OF THE STATE HIGHWAY DEPARTMENT  
*July 16, 1926*  
*A.B. Balis*  
COMMISSIONER OF HIGHWAYS

LAYOUT  
SEE SHEET 3.

CONVENTIONAL SIGNS

COUNTY LINE	-----	GROUND ELEVATION	DATUM	100.0	LINE
TOWN LINE	-----	GRADE ELEVATION	DATUM	100.0	LINE
FENCE LINE	-----				
STONE WALL	-----				
UNFENCED PROPERTY	-----				
GUARD RAIL	-----				
TRAVELED WAY	-----				
RAILROAD	-----				
RETAINING WALL	-----				
CENTER LINE	-----				
SURVEY LINE	-----				
CULVERT	-----				
DROP INLET	-----				
TROLLEY POLE	-----				
POWER POLE	-----				
TELEPHONE POLE	-----				
TREES	-----				
HEDGE	-----				

  

	CURVE DATA	
	DEFLECTION ANGLE	Δ
	DEGREE OF CURVE	D.
	RADIUS OF CURVE	R.
	TANGENT DISTANCE	T.
	LENGTH OF CURVE	L.
	EXTERNAL DISTANCE	E.
	POINT OF INTERSECTION	P.I.
	POINT OF CURVE	P.C.
	POINT OF TANGENT	P.T.

RECOMMENDED  
DISTRICT ENGINEER  
BUREAU OF PUBLIC WORKS  
RECOMMENDED FOR APPROVAL  
CHIEF ENGINEER  
BUREAU OF PUBLIC WORKS  
APPROVED  
DIRECTOR - BUREAU OF PUBLIC WORKS

SERIES F No. 73-C FILED  
SHEET 1 OF 8

DIST. # 1 PLANS  
1

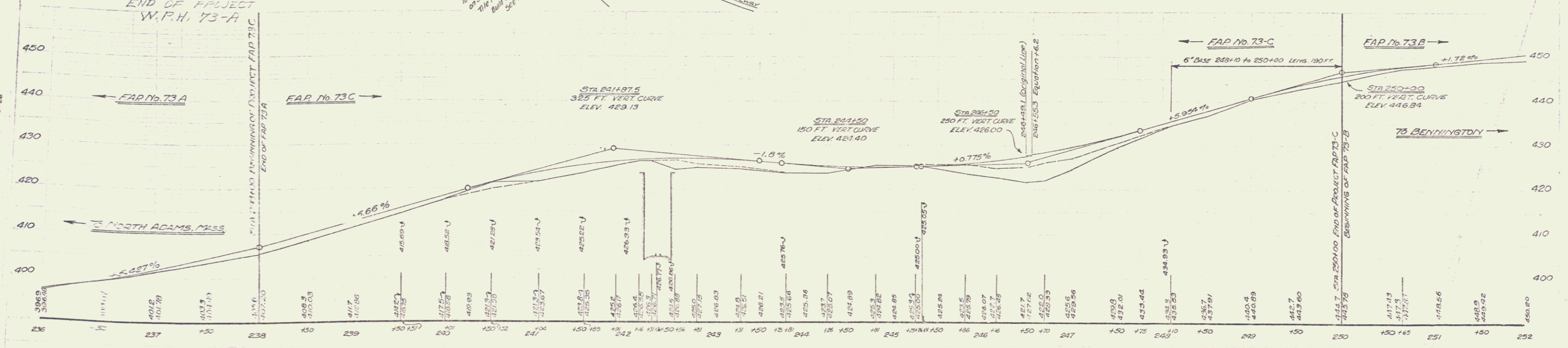

- 19 10" Apple Tree, Right of Sta 237+55 ELEV. 405.45
- 26 Old House, Top of 2' Taper Wall, SW Corner of Bridge, Left of Sta 241+90 ELEV. 425.65
- 27 Old House, Corner of Wall, Left of 248+76 ELEV. 422.31

SERIES F-73-C  
 SHEET 3 OF 8