

**WOOD GUARD RAIL REQUIRED**  
**LEFT**  
 STA 236+00 TO STA 246+23 LENGTH 24 FT  
**RIGHT**  
 STA 246+04 TO STA 246+23 LENGTH 24 FT  
 TOTAL LENGTH 43 FT

**CABLE GUARD RAIL REQUIRED**  
**LEFT**  
 STA 239+03 TO STA 242+03 LENGTH 400 FT  
 STA 242+34 TO STA 247+42 483 FT  
**RIGHT**  
 STA 241+46 TO STA 252+72 LENGTH 120 FT  
 STA 242+68 TO STA 243+80 112 FT  
 TOTAL LENGTH 1120 FT

**NEW CULVERTS REQUIRED**  
 STA 239+40 12" CONC. IRON PIPE CULVERT, LENGTH 30 FT  
 CONC. CLASS B (1-2-5) 1.5 cu. yd.  
 REIN. STEEL 33 LB.  
 (To be placed under Road Approach)  
 STA 241+25 18" REIN. CONC. OR CAST IRON PIPE CULV. LENS. 48 FT  
 CONC. CLASS A (1-2-4) 1.9 cu. yd.  
 REIN. STEEL 60 LB.  
 STA 246+16 15" REIN. CONC. OR CAST IRON PIPE CULV. LENS. 34 FT  
 CONC. CLASS B (1-2-5) 2.1 cu. yd.  
 REIN. STEEL 33 LB.  
 STA 248+47.5 15" REIN. CONC. OR CAST IRON PIPE LENS. 68 FT  
 18" 44"  
 CONC. CLASS A (1-2-4) 2.9 cu. yd.  
 REIN. STEEL 176 LB.  
 INLET GRATES 5 RINGS  
 (See note for details of construction)

**SUB-BASE REQUIRED**  
 STA 249+10 TO STA 250+00 LENGTH 190 FT  
 6" GRAVEL BASE

*Nothing*

**CURVE NO. 1**  
 Δ = 47°-45'  
 D = 18"  
 Q = 319.3  
 T = 140.9  
 L = 265.3  
 E = 29.9  
 (11' Bank)

**CURVE NO. 2**  
 Δ = 23°-0'  
 D = 8"  
 Q = 716.3  
 T = 145.7  
 L = 287.5  
 E = 14.7  
 (9' Bank)

**CURVE NO. 3**  
 Δ = 14°-57'  
 D = 6"  
 Q = 955.0  
 T = 125.3  
 L = 249.2  
 E = 8.2  
 (Wider Outside)

**RETAINING WALL REQUIRED**  
 STA 248+05 TO STA 249+55 LENGTH 50 FT  
 CONC. CLASS B (1-2-5) 12.0 cu. yd.

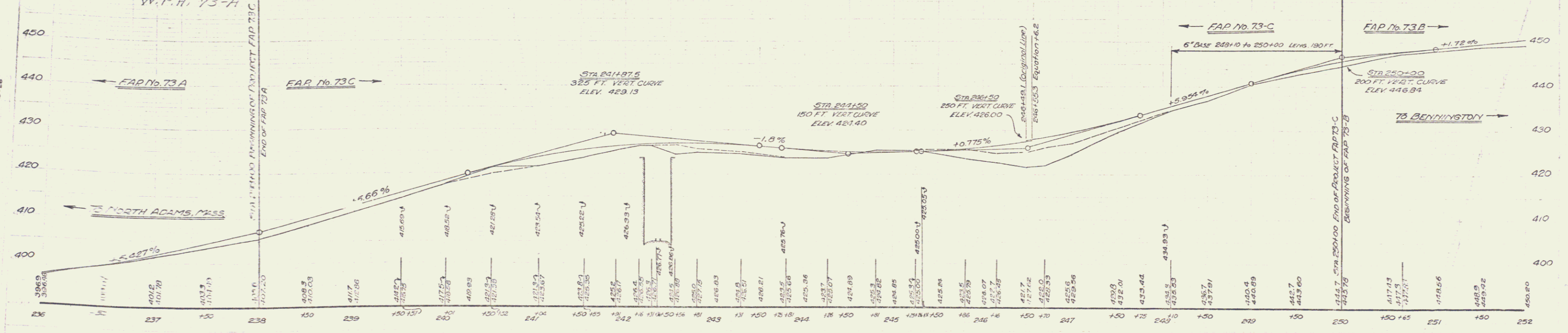
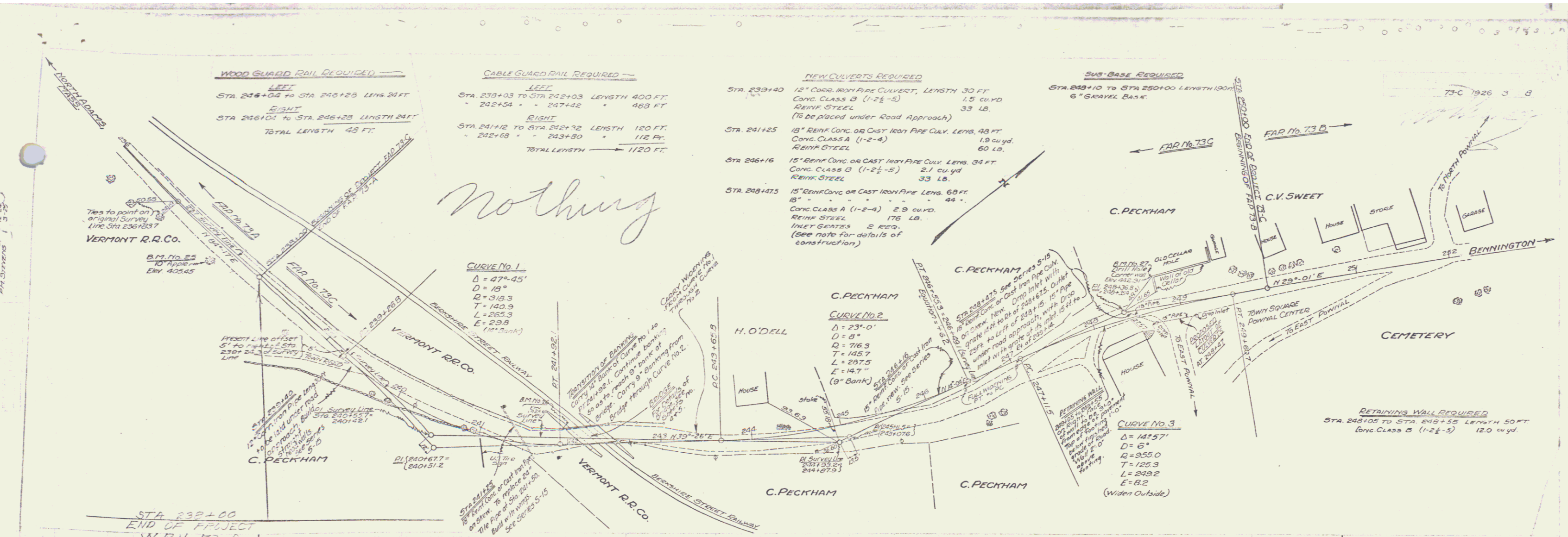

10' Apple Tree, Right of Sta 237+55 ELEV. 405.45  
 26 Old House, Top of 2' Retaining Wall, SW Corner of Bridge, Left of Sta 241+90 ELEV. 425.65  
 27 Old House, Corner of Wall, Left of 248+76 ELEV. 442.31

SERIES F-73-C  
 SHEET 3 OF 8