

INDEX OF SHEETS

SHEET NO.	TITLE PAGE
2	TYPICAL CROSS-SECTION OF IMPROVEMENT 5-8
3	PLAN AND PROFILE STA. 124+00 TO 136+00
4	" " " " " " 136+00 " 151+00
5	" " " " " " 151+00 " 166+00
6	" " " " " " 166+00 " 182+00
7	" " " " " " 182+00 " 195+00
8	" " " " " " 195+00 " 211+00
9	" " " " " " 211+00 " 227+00
10	" " " " " " 227+00 " 238+00
11	" " " " " " 243+00 " 256+00
12	" " " " " " 256+00 " 269+00
13	" " " " " " 269+00 " 292+00
14	" " " " " " 292+00 " 295+00
15	" " " " " " 295+00 " 309+00
SHEETS 10-17-BRIDGE (Overpass) 242+22	
SHEETS 18-19-CROSS SECTIONS	
SHEETS NO. 11-34 CROSS SECTIONS	

FED. ROAD DIST. NO.	STATE	FED. AID PROJ. NO.	YEAR	SHEET NO.	TOTAL SHEETS
9	VT.	73A	1925	1	34

STATE OF VERMONT
STATE HIGHWAY DEPARTMENT

PLAN AND PROFILE OF PROPOSED
STATE HIGHWAY
FEDERAL AID PROJECT

TOWN OF POWNAL *Pin# 99R523*

POWNAL CENTER ROAD
FROM F.A.P. NO. 42 NORTHERLY
2.16 MILES TO RESIDENCE OF H.W. MORGAN

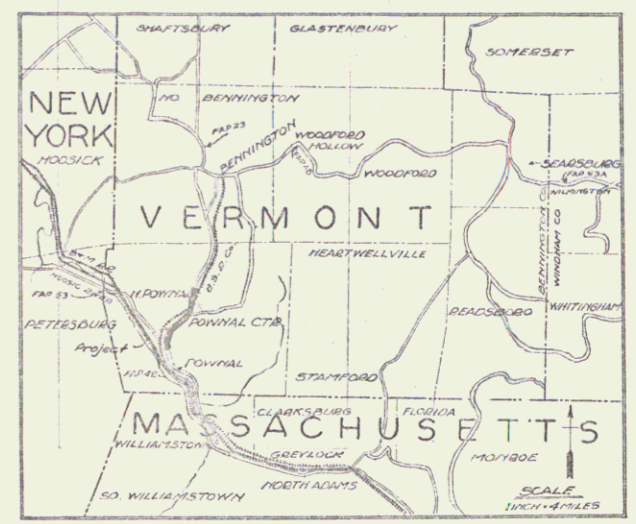

PLAN: 1 IN. = 50 FT.
SCALES: PROFILE HORIZ. 1 IN. = 50 FT.
VERT. 1 IN. = 10 FT.
CROSS SECTIONS 1 IN. = 5 FT.

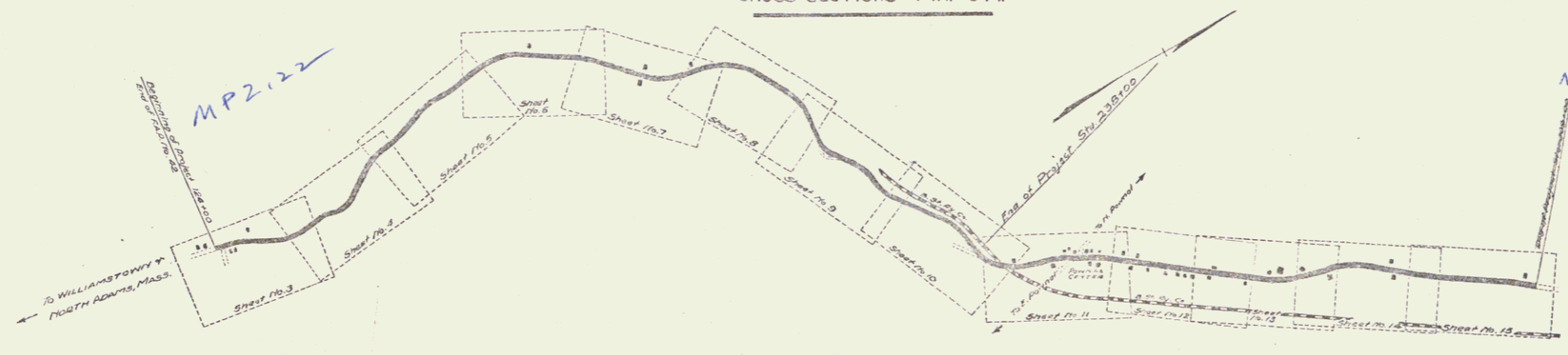

LAYOUT
1 IN. = 1000 FT.

CONVENTIONAL SIGNS

COUNTY LINE	-----	GROUND ELEVATION	DATUM	LINE
TOWN LINE	-----	GRADE ELEVATION	DATUM	LINE
FENCE LINE	-----			
STONE WALL	-----			
UNFENCED PROPERTY	-----			
GUARD RAIL	-----			
TRAVELED WAY	-----			
RAILROAD	-----			
RETAINING WALL	-----			
CENTER LINE	-----			
SURVEY LINE	-----			
CULVERT	-----			
DROP INLET	-----			
TROLLEY POLE	-----			
POWER POLE	-----			
TELEPHONE POLE	-----			
TREES	-----			
HEDGE	-----			

RIGHT-OF-WAY DIVISION
TOWN FILE
PERPETUAL
Town of Pownal
(To Be Returned To R.O.W. Division)
Former US 7

Approved
Chief Engineer
Submitted by OFFICE OF THE STATE HIGHWAY BOARD
Commissioner of Highways

1/1/25

Project No. F.A.P. 73A

SERIES F No 73A FILED
SHEET 1 OF 34

GUARD RAIL REQUIRED

ON LEFT
 Sta. 136+00 to Sta. 139+12 Length 312 ft.
 " 140+00 to " 142+80 " 280 "
 " 144+25 to " 145+21 " 96 "
 " 147+25 to " 151+00 " 375 "

ON RIGHT
 Sta. 139+89 to Sta. 139+12 Length 24 ft.
 " 140+50 to " 142+42 " 192 "
 " 144+25 to " 144+49 " 24 "

TOTAL THIS SHEET 1303 FT.

NEW CULVERTS REQUIRED

Sta. 139+00 15" Concrete Pipe 30 FT.
 Drop Inlet
 1-2 1/2-5 Concrete 2.4 cu. yds.
 Sta. 144+37 18" Concrete Pipe 23 FT.
 1-2 1/2-5 Concrete 2.5 cu. yds.

CULVERT REPAIRS REQUIRED

Sta. 141+33 Cattle Pass, Headwalls and Wings
 raised to hold fill.
 1-2 1/2-5 Concrete 11.0 cu. yd.
 Steel (Covels) 150 lbs.
 Sta. 141+70 Headwalls on Culvert raised to
 hold fill.
 1-2 1/2-5 Concrete 6 cu. yd.
 Steel (Covels) 55 lbs.

SUB BASE REQUIRED

Sta. 142+25 to Sta. 147+25 Length 500 ft.

FIELD MEASUREMENTS	PLANNING	DESIGN	CHECKING	TOTAL
1	1	1	1	4
SHEET TOTAL				4
PROJECT NO.				VT. 73A 11925
DATE				4 34

12-24
R.M. STEVENS

12-24
R.M. STEVENS

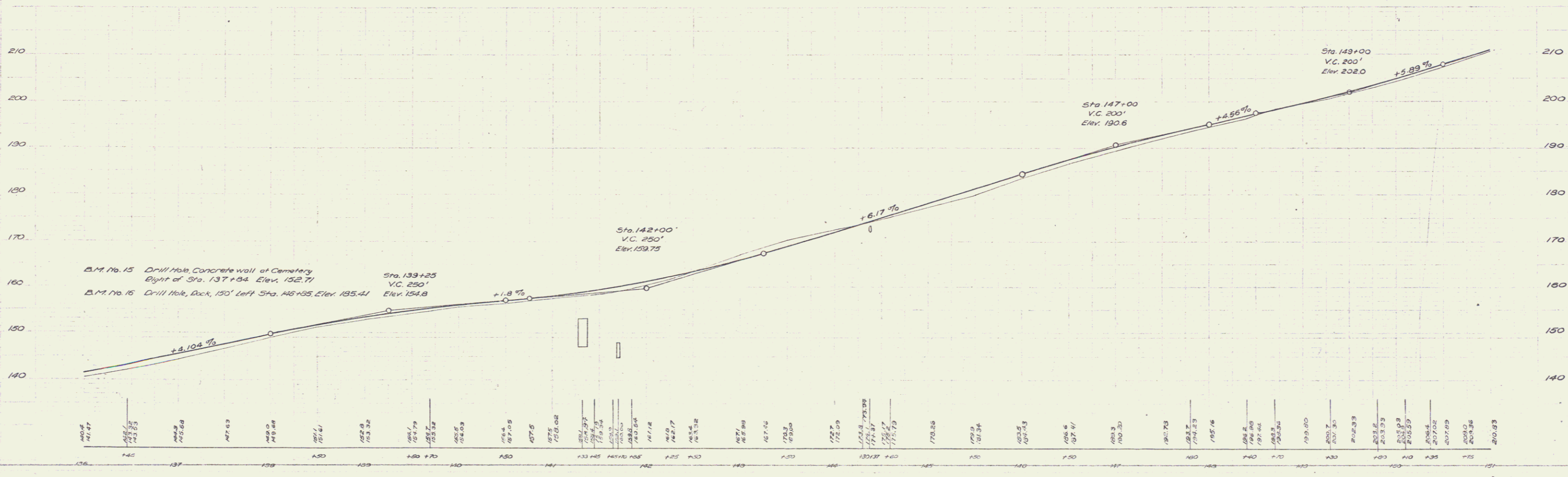
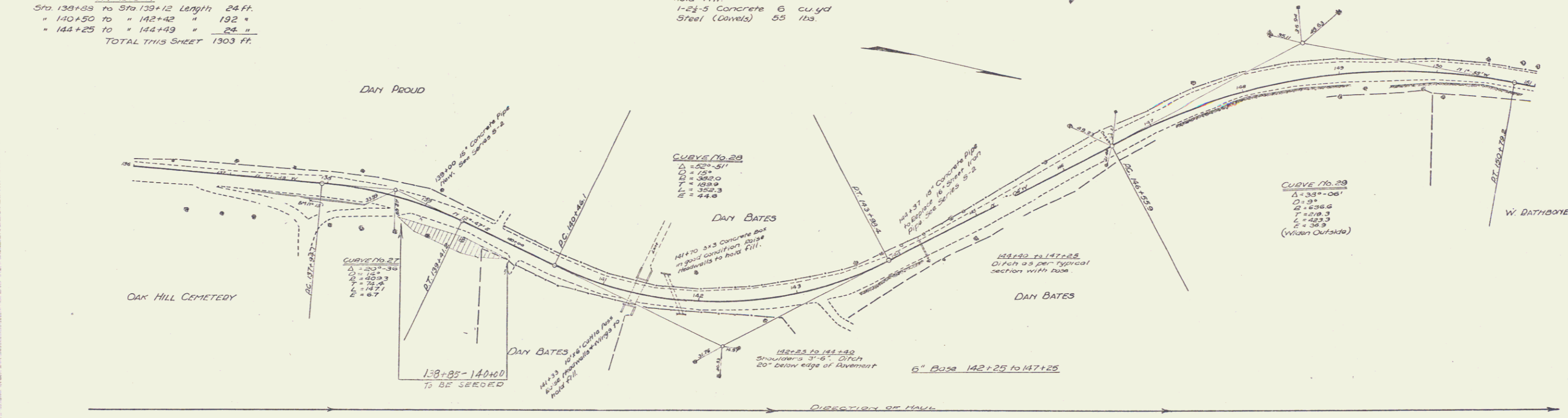

GUARD RAIL REQUIRED

OUTLET
 Sta. 151+00 to Sta. 166+00 Length 1500 ft.

QUILT
 Sta. 151+00 to Sta. 151+30 Length 24 ft.
 • 151+00 to " 156+13 " 24 "
 • 159+04 to " 160+08 " 24 "
 • 164+42 to " 164+66 " 24 "
 Total this sheet 1596 ft.

NEW CULVERTS REQUIRED

Sta. 151+18 24" Concrete Pipe 32 ft.
 Drop Inlet 1-2 1/2-5 Concrete 6.7 cu. yd.
 Sta. 156+01 18" Concrete Pipe 32 ft.
 1-2 1/2-5 Concrete 2.5 cu. yd.
 Sta. 159+96 18" Concrete Pipe 32 ft.
 1-2 1/2-5 Concrete 2.6 cu. yd.
 Sta. 164+54 18" Concrete Pipe 32 ft.
 1-2 1/2-5 Concrete 2.6 cu. yd.

AM Stevens 12-24
 AM Stevens 3-25

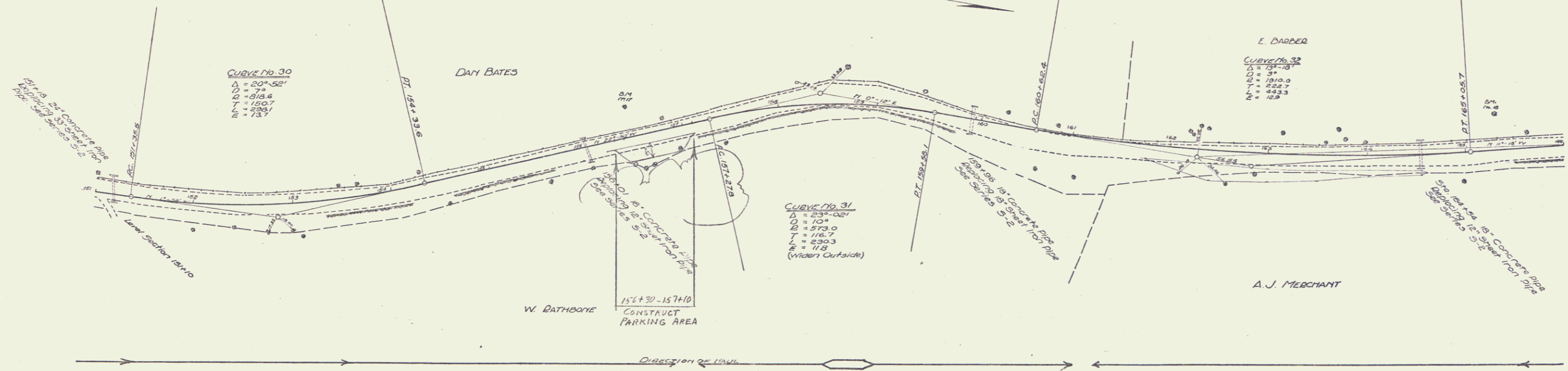

AM Stevens 12-24
 AM Stevens 3-25
 Z. Hayward 3-25

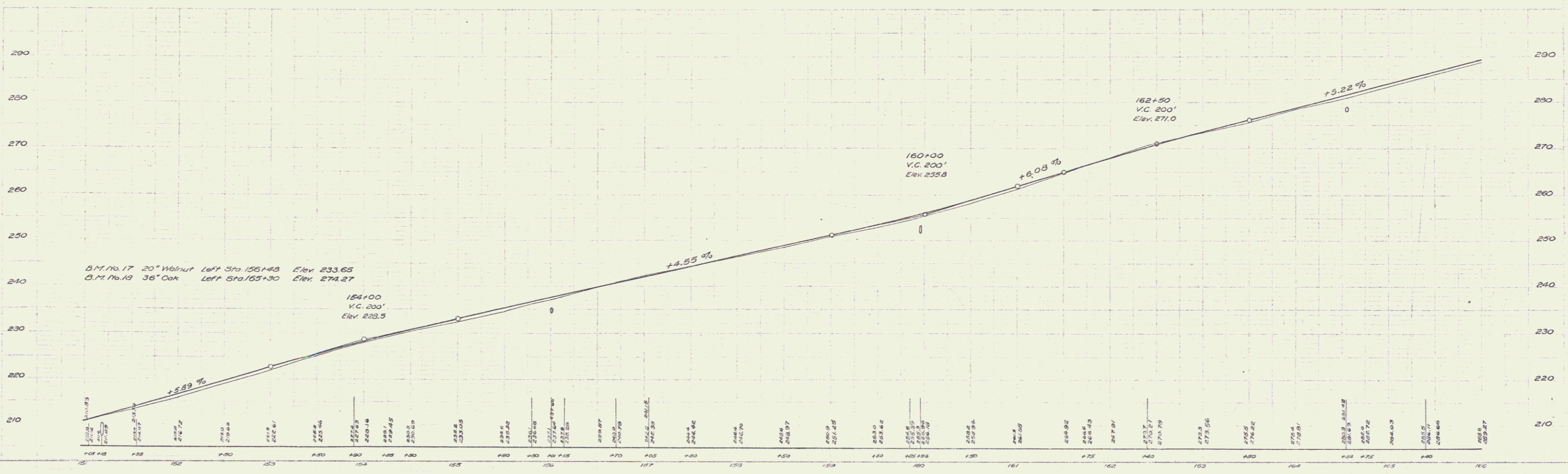

GUARD RAIL REQUIRED

ON LEFT

Sta 184+04 to Sta 184+23	Length 24 ft
" 187+24 to " 189+04	" 120 "
" 191+38 to " 192+12	" 24 "

ON RIGHT

Sta 184+04 to Sta 184+23	Length 24 ft
" 185+00 to " 185+24	" 24 "
" 191+35 to " 192+12	" 28 "

TOTAL THIS SHEET 280 ft.

NEW CULVERTS REQUIRED

Sta 184+16	15" Concrete Pipe	30 ft
" 184+16	1-2-3 Concrete	2.5 cu.yd
Sta 185+12	3'-3" Reinforced Concrete Box	4.1 cu.yd.
" 185+12	1-2-3 Concrete	13.0 cu.yd.
" 185+12	Reinforcing Steel	210 cu.yd.
Sta. 192+00	15" Concrete Pipe	30 ft.
" 192+00	1-2-3 Concrete	2.0 cu.yd.

SUB-BASE REQUIRED

Sta 182+00 to Sta 189+00	Length 610 ft
" 189+20 to " 192+00	" 280 "

(Above kind as per Note on Sheet 6.)

CONCRETE CURB AND GUTTER

Sta 182+45 to Sta 187+45	Length 100 ft.
" 187+45 to Sta 187+45	Length 100 ft.

1-2-4 Concrete 7.5 cu.yd.

Nothing

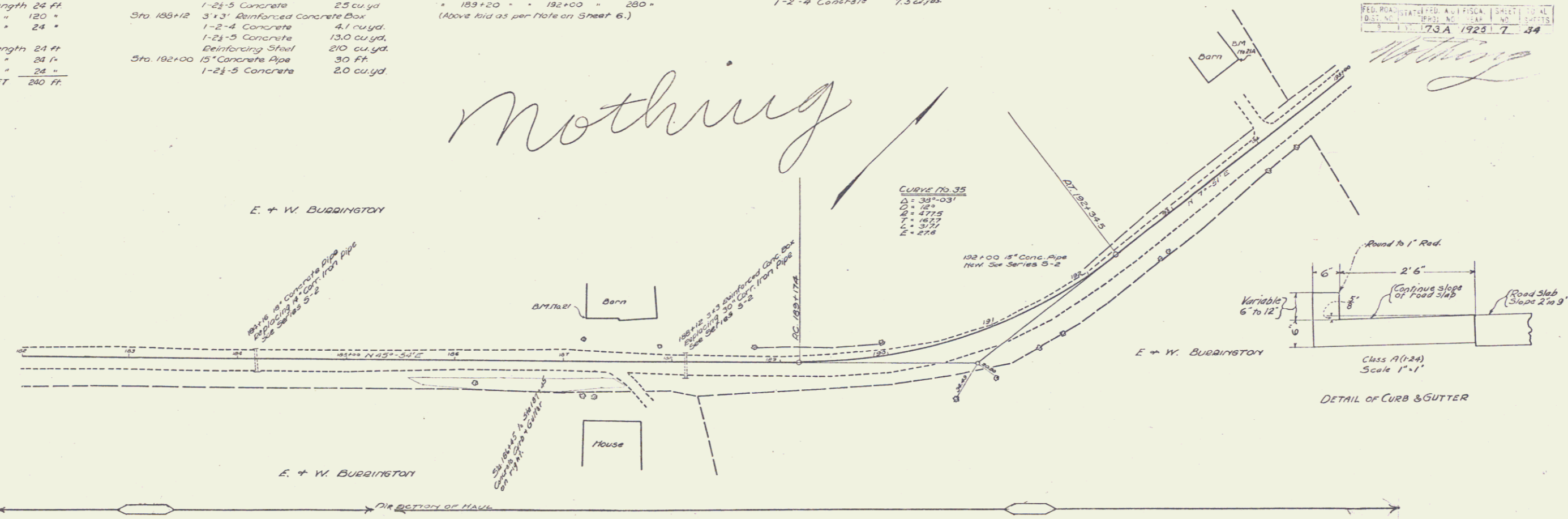

182+00 to 195+00
 Ditch on Right as per
 typical section with base
 unless otherwise specified.

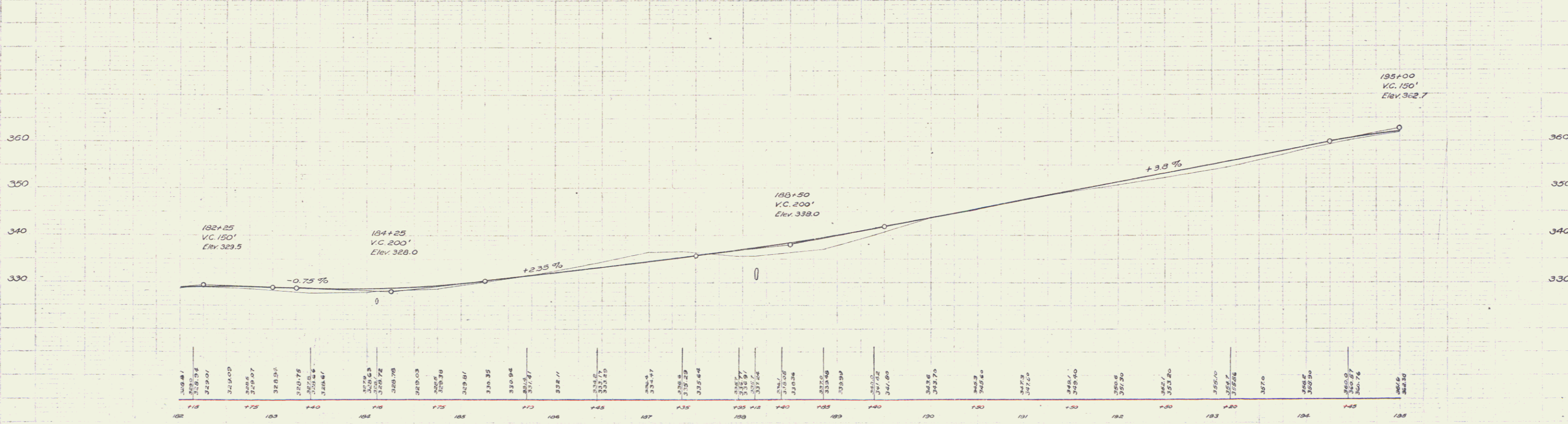

B.M. No. 21 Top of wall, S.E. Cor. of Barn, Left of Sta. 187+21 Elev. 336.05
 B.M. No. 21A Bottom of batter-board N.E. Cor. Barn, L. - - 194+33 Elev. 358.43

GUARD RAIL REQUIRED

ON LEFT	
Sta 195+56 to Sta 203+64	Length 808 ft.
" 207+02 " " 211+00 "	" 398 "
ON RIGHT	
Sta 196+63 to Sta 196+92	Length 24 ft.
" 200+56 " " 200+80 "	" 24 "
" 203+41 " " 203+65 "	" 24 "
" 207+90 " " 208+14 "	" 24 "
TOTAL THIS SHEET 1302 FT.	

NEW CULVERTS REQUIRED

Sta 196+00	15" Concrete Pipe	34 ft.
" 196+00	1-2-5 Concrete	20 cu yd.
Sta 200+63	15" Concrete Pipe	36 ft.
" 200+63	1-2-5 Concrete	20 cu yd.
Sta 203+53	15" Concrete Pipe	30 ft.
" 203+53	1-2-5 Concrete	18 cu yd.
Sta 208+02	15" Concrete Pipe	28 ft.
" 208+02	1-2-5 Concrete	20 cu yd.

SUB BASE REQUIRED
Sta. 195+00 to Sta. 204+00 Length 900 ft.
" 204+00 to " 211+00 " 700 "

STA 204+00-207+00
Construct 10' shoulder
for parking

FILE NO.	73A	DATE	1/25	SHEET NO.	34
----------	-----	------	------	-----------	----

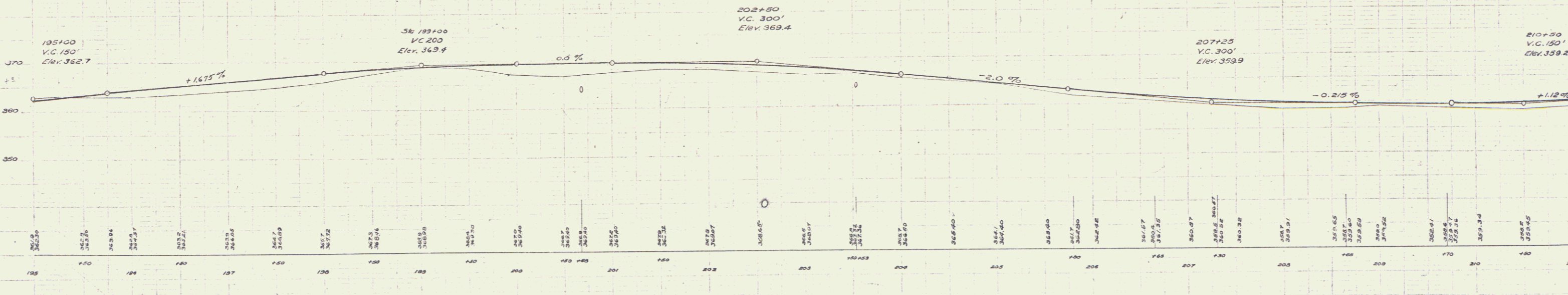
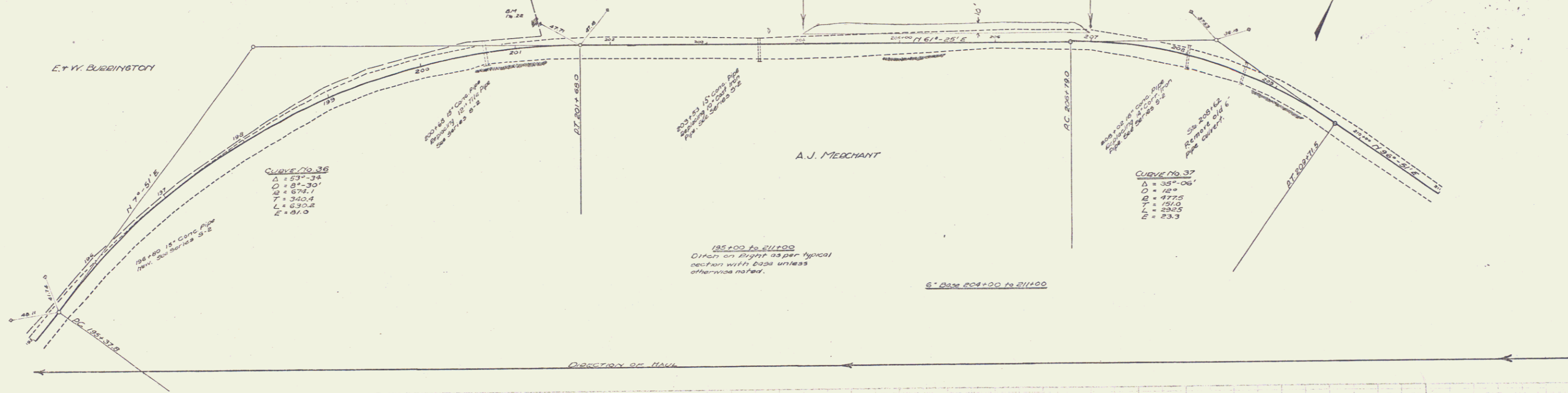

DT 196.02 Drill hole in Rock, Left of Sta 201+20 Elev. 358.02

P.M. STEVENS 12-24
P.M. STEVENS 5-25

P.M. STEVENS 5-25
P.M. STEVENS 3-23
L.H. HOWARD 3-23

GUARD RAIL REQUIRED

Sta 211+00 to 211+38	Length 38 ft
" 214+40 " 217+12	" 272 "
" 219+16 " 219+40	" 24 "
" 223+00 " 225+40	" 240 "
TOTAL THIS SHEET	866 FT

NEW CULVERTS REQUIRED

Sta 211+14	15" Concrete Pipe	34 ft.
" 214+5	Concrete	13 cu yd.
Sta. 219+35	24" Reinforced Concrete Box	
Drop Inlet with Grate		
1-2-4	Concrete	4.9 cu yd.
1-2-5	Concrete	12.5 cu yd.
Reinforcing Steel		230 lb.
Sta. 219+28	15" Concrete Pipe	32 ft.
Drop Inlet		
1-2-5	Concrete	2.5 cu yd.
Sta. 224+03	34" Reinforced Concrete Box	
1-2-4	Concrete	5.6 cu yd.
1-2-5	Concrete	21.7 cu yd.
Reinforcing Steel		295 lb.

SUB BASE REQUIRED

Sta 211+00 to Sta. 214+70	Length 370 ft.
" 216+50 " 223+10	" 660 "
" 225+30 " 227+00	" 170 "
(* Lay as per Note on Sheet 6)	
Sta 214+70 " 216+50	" 180 "

ROAD DISTRICT	AD	FISCAL SHEET	TOTAL SHEETS
73A	1925	9	37

Sheet 10
Holding

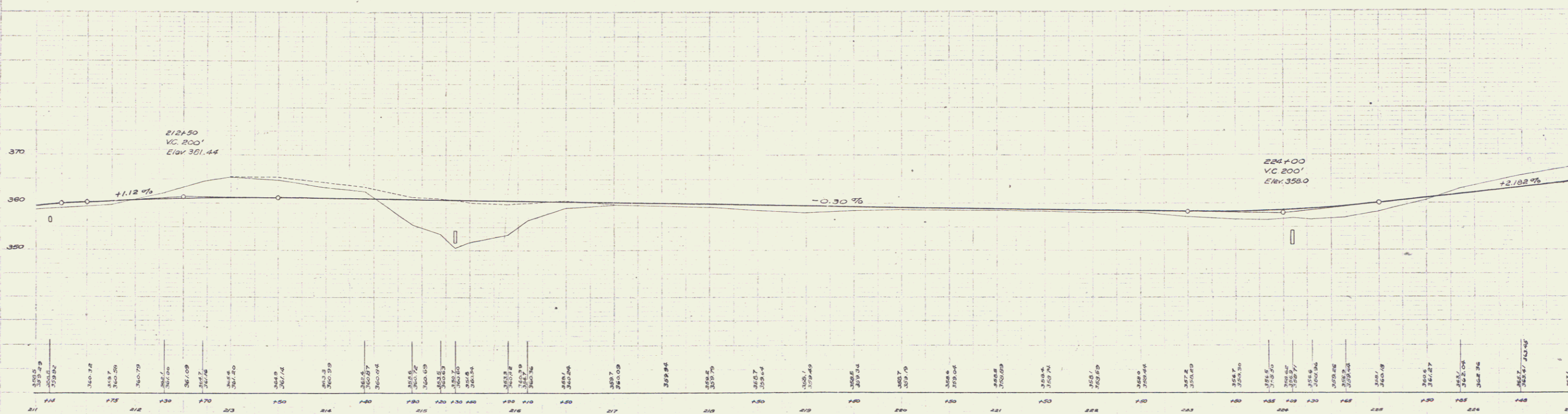
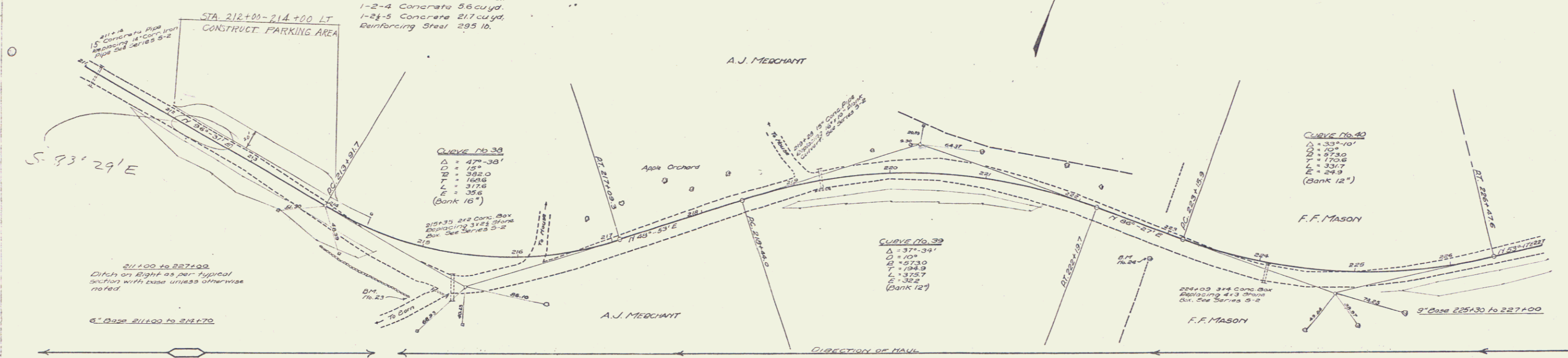

BM No. 23 Drill hole in Boulder, End of Stone wall, Left of Sta. 215+00 Elev. 367.69
 BM No. 24 12" Ash Right of Sta. 222+00 Elev. 363.01

R.M. STUBBS 12-24
A.M. DREW 3-25

R.M. STUBBS 12-24
A.M. DREW 3-25
Z.F. HOWARD 3-25

Series No. 73A
Sheet 9 of 37

