

GUARD RAIL REQUIRED

| ON RIGHT | | |
|-------------------------|--------------|--|
| Sta 43+73 to Sta 43+97 | 24 ft | |
| 47+37 - 47+97 | 40 - | |
| 54+11 - 54+35 | 24 - | |
| ON LEFT | | |
| Sta 44+58 to Sta 52+98 | 840 - | |
| 54+11 - 54+35 | 24 - | |
| Total this sheet | 952 - | |

NEW CULVERTS REQUIRED

| | | |
|-----------|---------------------------|-----------|
| Sta 43+05 | 18" Concrete pipe | 40 ft |
| 1-28-5 | Concrete | 1.5 cu yd |
| 47+77 | 4'x6' Reinforced concrete | |
| 1-2-4 | Concrete | 100 cu yd |
| 1-28-5 | Steel | 270 - |
| 54+23 | 18" Concrete pipe | 20 ft |
| 1-23-5 | Concrete | 0.8 cu yd |

| NO. | DATE | BY | SCALE | SHEET | TOTAL |
|-----|------|----|-----------|-------|-------|
| 9 | 17 | 92 | 1/4" = 1' | 6 | 41 |

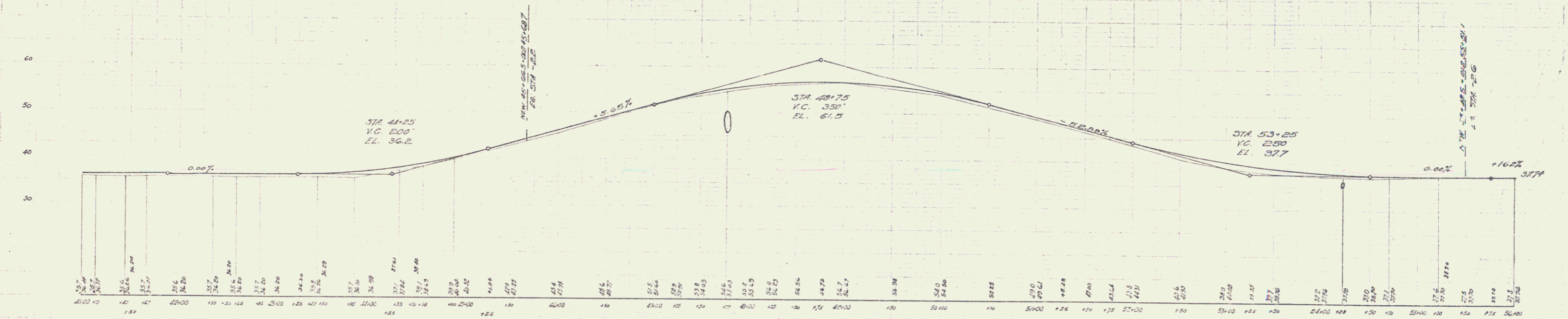
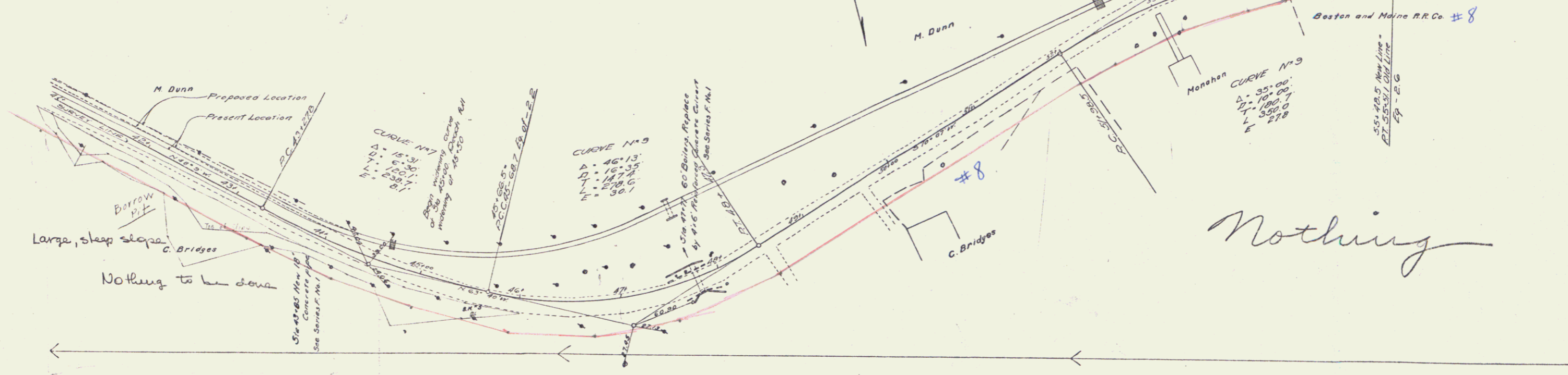

Series F. No. 11
Sheet 6 of 41
6