

RTE. US 7 CONV. CURVE DATA

Δ	91°36'00" Lt.
D	3445'00"
R	1527.83'
T	1557.31'
L	2429.33'
E	653.92'
Bank	14 7/8' Lt.
Pt.	N 148° 36.74'
Pt.	E 312,439.15'

FOR CONSTRUCTION NOTES
SEE SHEET NO 62

PROFILES
Rte. US 7 Conv. (Sheet No 55) 63
Ramp D (Sheet No 52)
Ramp E (Sheet No 54)
Ramp F (Sheet No 65)
Ramp G (Sheet No 73)

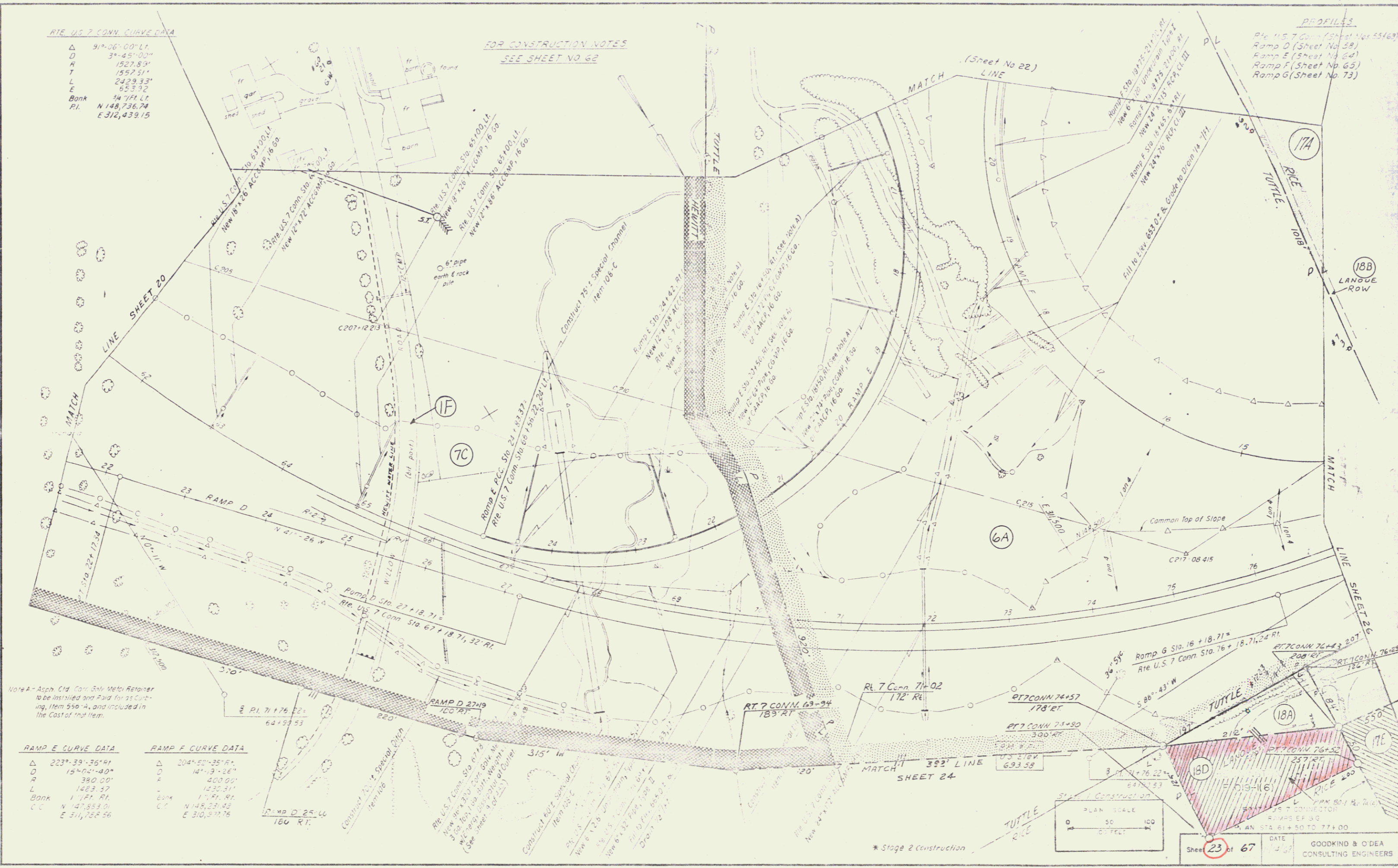

Note A - Asphalt Concrete Slab Retainer to be installed 300' prior to cutting, item 590-A, and included in the Cost of that item.

RAMP E CURVE DATA

Δ	223°38'36" Rt.
D	15404'40"
R	380.00'
L	1483.37'
Bank	1 7/8' Rt.
C.C.	N 47° 53' 01"
E	311,788.56'

RAMP F CURVE DATA

Δ	204°50'35" Rt.
D	14113'26"
R	400.00'
L	1420.31'
Bank	1 7/8' Rt.
C.C.	N 148° 23' 43"
E	310,971.76'

In Charge of
Checked by
Drawn by
Checked by

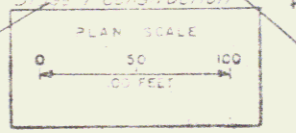

Sheet 23 of 67 DATE 4/2/67
GOODKIND & O'DEA CONSULTING ENGINEERS