

STATE OF VERMONT
DEPARTMENT OF HIGHWAYS

PROPOSED IMPROVEMENT

TOWN OF BENNINGTON
COUNTY OF BENNINGTON
US ROUTE 7 CONN.

ROW PLANS

LENGTH OF PROJECT - 3,765 FEET - 0.713 MILES

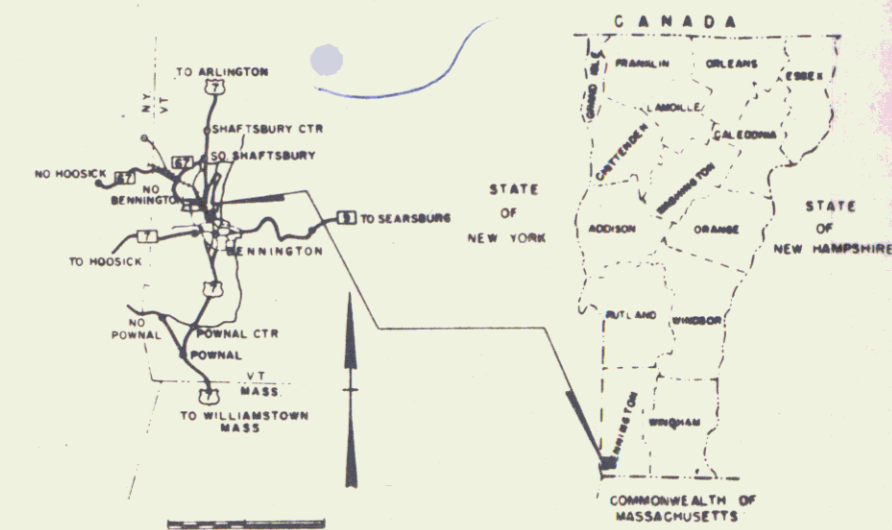

BEGIN ROW PROJ. F219-1(7)
STA. 9+00

END ROW PROJ. F219-1(7)
STA. 46+65

CONVENTIONAL SIGNS

ROAD LIMITS	---
LIMITED ACCESS	---
POINT OF ACCESS	X
LIMITS OF ACCESS	---
COUNTY LINE	---
TOWN LINE	---
FENCE LINE	---
STONE WALL	---
UNFENCED PROPERTY	---
GUARD RAIL	---
TRAVELED WAY	---
RAILROAD	---
RETAINING WALL	---
CENTER LINE	---
SURVEY LINE	---
CULVERT	---
DROP INLET	---
TROLLEY POLE	---
POWER POLE	---
TELEPHONE POLE	---
TREES	---
MEGARE	---
F.A. CONSTRUCTION IDENTIFICATION SIGNS	A

CONTROL SURVEY	---
BASE LINE	---
SLOPE RIGHTS	SR
GROUND ELEVATION	BATH
GRADE ELEVATION	---
CURVE DATA	---
DEFLECTION OF ANGLE	A
DEGREE OF CURVE	D
RADIUS OF CURVE	R
TANGENT DISTANCE	T
LENGTH OF CURVE	L
EXTERNAL DISTANCE	E
POINT OF INTERSECTION	PI
POINT OF CURVE	P.C.
POINT OF TANGENT	P.T.
POINT ON TANGENT	P.O.T.
POINT ON SUB-TANGENT	---
ROW LIMITS	---

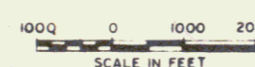
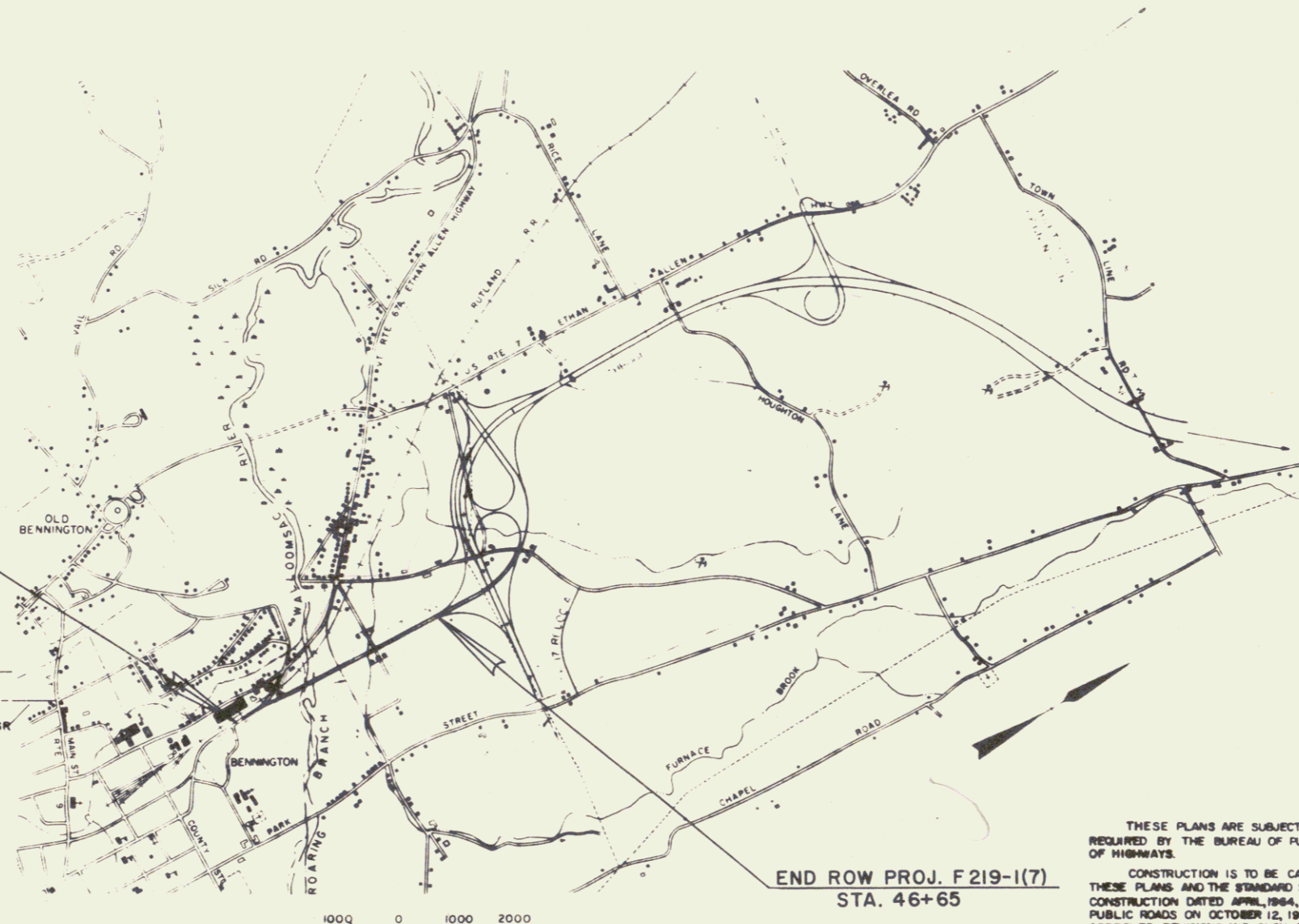

RIGHT-OF-WAY DIVISION
TOWN FILE
PERPETUAL
Town of 057 L.I.A.
(To Be Returned To R.O.W. Division)

THESE PLANS ARE SUBJECT TO SUCH REVISIONS AS MAY BE REQUIRED BY THE BUREAU OF PUBLIC ROADS OR THE COMMISSIONER OF HIGHWAYS.
CONSTRUCTION IS TO BE CARRIED ON IN ACCORDANCE WITH THESE PLANS AND THE STANDARD SPECIFICATIONS FOR HIGHWAY AND BRIDGE CONSTRUCTION DATED APRIL, 1964, AS APPROVED BY THE BUREAU OF PUBLIC ROADS ON OCTOBER 12, 1964, INCLUDING ALL SUBSEQUENT APPROVED REVISIONS AND SUCH REVISED SPECIFICATIONS AND SPECIAL PROVISIONS AS ARE INCORPORATED IN THESE PLANS.

DEPARTMENT OF COMMERCE BUREAU OF PUBLIC ROADS	
APPROVED	---
DIVISION ENGINEER	---
PROJECT	F NO. 219-1(7)
SHEET	18 OF 17 SHEETS

APPROVED ROW DIRECTOR DATE 5-26-70	APPROVED DISTRICT ENGINEER DATE 5-24-70	APPROVED CONSTRUCTION ENGINEER DATE 26 May 70	APPROVED BRIDGE ENGINEER DATE 5/24/70	APPROVED HIGHWAY ENGINEER DATE 5/26/70	APPROVED SECTION ENGINEER DATE 5/26/70	APPROVED CHIEF ENGINEER DATE 5/26/70
--	---	---	---	--	--	--

STATE OF VERMONT
DEPARTMENT OF HIGHWAYS
RIGHT-OF-WAY PLANS
ALPHABETICAL INDEX

GRANTOR	SHEET NO.	PARCEL NO.
A		
B		
BENNINGTON SCHOOL DISTRICT INC.	9,12	12
BIJUR LUBRICATING CORP	10	5
BOARD OF CHURCH EXTENSION & HOME MISSIONS OF THE CHURCH OF GOD	11	10 & 13
C		
CHARLESTOWN MILLS STORE OF BENNINGTON INC. (LESSEE)	11	10
D		
E		

GRANTOR	SHEET NO.	PARCEL NO.
F		
G		
GREENBERG, NORMAN H.	8	2
H		
I		
J		

GRANTOR	SHEET NO.	PARCEL NO.
K		
L		
M		
MOORE, HOWARD W. & AUXILLIA W.	11	9
N		
NORTHERN TERMINALS INC.	11	8
O		

GRANTOR	SHEET NO.	PARCEL NO.
P		
PETTENGILL, NED H.	11	7
Q		
R		
	8,11	4
S		
STATE OF VERMONT (VERMONT PUBLIC SERVICE BOARD)	8,11	4
T		
TATRO, RAYMOND E. & MARGARET	10	6
TOWN OF BENNINGTON	9	11
TRUSTEES OF THE SOLDIERS HOME IN VERMONT	8	1

GRANTOR	SHEET NO.	PARCEL NO.
U		
V		
VERMONT RAILWAY, INC. (LESSEE) VILLAGE OF BENNINGTON	8,11 8	4 14
W		
WILKINSON, CHARLES M.	8-11	3
X		
Y		
Z		

MADE BY: FRP DATE: 3-27-70
CHECKED BY: LWB DATE: 3-30-70

PROJECT: BENNINGTON
NO. F 219-1(7)
SHEET 4 OF 17

STATE OF VERMONT
DEPARTMENT OF HIGHWAYS
RIGHT-OF-WAY PLANS
DETAIL SHEET
1 OF 3

TABLE OF PROJECT PROPERTY ACQUISITION

PARCEL NO.	GRANTOR	SHEET NO.	BEGINNING STATION	ENDING STATION	TAKEN	REM.	RIGHTS	TITLE TAKEN	DATE	TOWN OR CITY RECORDED	BK.	PG.	REMARKS		
1	THE TRUSTEES OF THE SOLDIERS HOME IN VERMONT	8	9+00 CL	24+12 LT.	5.6 A±	89.4 A±							0.12 AC VILLAGE OF BENN. EASE. SIGN		
		8	15+65 LT. 18+60 RT	21+60 RT			CHANNEL (P) 0.35 A±								
2	GREENBERG, NORMAN H.	8	9+00 CL	15+97 LT.	10A±	0.9A±							0.16A± VILLAGE OF BENN. EASE. SIGN		
		8	11+00 LT.										SIGN		
		8	12+77 LT.										SIGN		
		8	12+77 LT.										SIGN		
		8	14+35 LT. 11+64 LT.											SIGN	
3A	WILKINSON, CHARLES M.	8-11	RT 7 CONN. 21+42 RT.	RT 7 CONN. 34+98 CL	11.3 A±			WD	3/11/70	BENNINGTON	0-188	54	ADVANCE ACQ. UNDER PROJ QF 219-1 (12)		
			RT 7 CONN. 33+86 LT.	RT 7 CONN. 34+17 LT.			CHANNEL (P) 450 SF±								
3B		10	T.R. 28 REL. 6+77 CL	T.R. 28 REL. 16+00 CL	2.2 A±								CHANNEL (P) 7600 S.F.±		
			T.R. 28 REL. 9+50 LT.	T.R. 28 REL. 13+65 LT.											
		T.R. 28 REL. 13+63 RT	T.R. 28 REL. 14+06 RT.			CHANNEL (P) 1200 S.F.±									
		T.R. 28 REL. 14+75 LT.				DRIVE (T)									
		TR 28 REL. 14+75 RT				DRIVE (T)									
		RT. 7 CONN. 21+42 RT.	T.R. 28 REL. 6+77 LT.			34.2 A±									
		T.R. 28 REL. 25+85 RT.	RT. 7 CONN. 34+98 LT.			5.8 A±									
		KOCHER DR. 12+00 CL	RT. 7 CONN. 34+98 RT.			12.2 A±									
		4A	STATE OF VERMONT (VERMONT PUBLIC SERVICE BOARD) LESSOR VERMONT RAILWAY INC. (LESSEE)	8	15+02 LT. 15+97 LT.	21+03 LT. 21+03 LT.	0.4 A±	N/A							REMOVE PAVEMENT (T) 1100 S.F.± VILLAGE OF BENN. EASE.
				4B	11	24+00 LT.	28+21 RT.								
		24+48 LT. 27+25 RT. 17+50 LT.	26+08 RT.										CULVERT (P) DRAINAGE (P) BILLBOARD		

TABLE OF REVISIONS

REVISION NO.	SHEET NO.	DESCRIPTION OF REVISION	DATE	MADE BY	APPROVED BY
1	8	Parcel #1 Added channel rights to this parcel between stations 18+60 Rt. & 21+60 Rt. Per change order # 1597	6-23-70	RCS	
2	8	Parcel #1 Change Or Sign Locations And Location Or Additional Signs Per Change Order # 1606	7-23-70	RCS	T.P.M.
3	6, 11, 14	Parcel #7 Reduce take by 0.4 A±. Revised R.O.W. plans. Per Change Order # 1654	8-27-70	KMD	T.P.M.
4	11	Parcel #7 Reduced remainder from 0.4A to 0.16A due to change in property line. Per Change Order # 1679	9-17-70	RCS	T.P.M.

LEGEND

NBB	DATE 3-26-70	PRESENT R.O.W.	SR	SR	SLOPE RIGHTS
LWB	DATE 3-26-70	TAKING WITHOUT ACCESS	P	P	PROPERTY LINE
		TAKING WITHOUT ACCESS ALONG PROPERTY LINE	T	T	TOP OF CUT
		TAKING WITH ACCESS	S	S	TOP OF SLOPE
		PERMANENT TAKE			
		TEMPORARY TAKE			

APPROVED *Thomas P. Maguire* DATE 5-26-70
CHIEF OF ACQUISITION
APPROVED *G. M. Lane* DATE 5-26-70
HIGHWAY ENGINEER
APPROVED *Thomas P. Maguire* DATE 5-26-70
DIRECTOR

PROJECT BENNINGTON
NO. F 219-1(7)
SHEET 5 OF 17

STATE OF VERMONT
DEPARTMENT OF HIGHWAYS
RIGHT-OF-WAY PLANS
DETAIL SHEET
2 OF 3

TABLE OF PROJECT PROPERTY ACQUISITION

NO.	GRANTOR	SHEET NO.	CLIPPING STATION	ENCLOSURE STATION	TRUCKING	ROW	RIGHTS	FILE TABLE	DATE	TOWN OR CITY RECORDED	BK.	PG.	REMARKS
5	BIJUR LUBRICATING CORP.	10	5+50 C	12+00 C	0.4A±	28.6A±							0.14A± TOWN OF BENN. EASE.
6	TATRO, RAYMOND E. & MARGARET M. (H&W)	10	5+50 C	6+77 C	3800 SQ.FT.	1.5A±							1800 S.F.± TOWN OF BENN. EASE.
7	PETTENGILL, NED H. (PETCO OIL CO.) (A&W - WARREN C. JENSEN) (BENNINGTON DAIRY QUEEN)	11	25+00 LT. 32+07 RT. 28+06 C 28+38 C 28+46 RT. 29+00 RT. 28+02 RT. 28+73 RT. 28+86 RT. 29+65 RT. 30+21 RT. 29+30 RT. 30+61 RT.	32+19 RT.	1.3A±	0.16A±							ALL R.T. & I. TO SHED GAS PUMPS & ISLAND GAS PUMPS & ISLAND GAS STATION GAS PUMPS & ISLAND UNDERGROUND GAS TANKS SIGN CARPORT BUILDING CARPORT SIGN BUILDING
8	NORTHERN TERMINALS INC.	11	34+02 RT. 32+56 RT. 32+07 RT. 32+07 RT. 32+25 RT.	34+79 LT.	650 SQ.FT.	0.3A±							90S.F.± VERMONT STATE EASE. 600 S.F.± TOWN OF BENN. EASE. GAS PUMP APRON REMOVE SHED (T) ALL R.T. & I. TO SHED
9	MOORE, HOWARD W. & AUXILLIA W. (H&W)	11	34+15 RT.	34+91 RT.	3400 SQ.FT.	0.6A±							1750 S.F.± TOWN OF BENN. EASE 650 S.F.± VERMONT ST. EASE.
10	THE BOARD OF CHURCH EXTENSION & HOME MISSIONS OF THE CHURCH OF GOD (LESSOR) CHARLESTOWN MILLS STORE OF BENNINGTON INC. (LESSEE)	11	34+00 LT. 33+02 LT. 33+79 LT. 34+55 LT.	34+77 LT. 34+04 LT.	2900 SQ.FT.	0.4A±							900 S.F.± TOWN OF BENN. EASE. SIGN SIGN

TABLE OF REVISIONS

REVISION NO.	SHEET NO.	DESCRIPTION OF REVISION	DATE	MADE BY	APPROVED BY

NBB DATE 3-26-70
LWB DATE 3-26-70

--- PRESENT R.O.W.
--- EXISTING WITHIN ACQUISITION
--- EXISTING WITHIN ACQUISITION
--- EXISTING WITHIN ACQUISITION
--- EXISTING WITHIN ACQUISITION

LEGEND

SR SH SLOPE RIGHTS
P L PROPERTY LINE
TOP OF CUT
TOE OF SLOPE

APPROVED *Thomas P. Hayes* DATE 5-26-70
CHIEF OF ACQUISITION
APPROVED *G. M. Lane* DATE 5/26/70
HIGHWAY ENGINEER
APPROVED *Sharon R. Jenkins* DATE 5-26-70
R.O.W. DIRECTOR

PROJECT BENNINGTON
NO. F 219-1(7)
SHEET 6 OF 17

STATE OF VERMONT
DEPARTMENT OF HIGHWAYS
RIGHT-OF-WAY PLANS
DETAIL SHEET
3 OF 3

TABLE OF PROJECT PROPERTY ACQUISITION

SHEET NO.	GRANTOR	LEGISLATIVE STATION	ENROLLMENT STATION	ACRES	REMARKS	TOWN OR CITY RECORDED	UN	PG
11A	TOWN OF BENNINGTON	34+98 LT.	34+98 RT.	N/A	N/A	R.T. & I. TO T.R.28		
11B		34+98 LT. 35+50 LT. 38+00 LT. 34+98 LT.	38+49 RT. 38+11 LT.	1.9A± 8.0A±	DRAINAGE (P) DRAINAGE (P)	REFER TO FOIS-(6) DETAIL SHEET FOR EASTERLY REMAINDER		
12	BENNINGTON SCHOOL DISTRICT INC.	37+51 RT. 38+00 LT. 42+00 LT. 45+00 LT.	46+65 LT.	6.9A±	DRAINAGE (P) DRAINAGE (P) DRAINAGE (P)			
		38+49 RT. 38+11 LT.	46+05 RT. 46+65 LT.	1.8A± 12.3A±		LOSS OF ACCESS(1.8A±)		
13	THE BOARD OF CHURCH EXTENSION & HOME MISSIONS OF THE CHURCH OF GOD	31+28 LT.	33+02 LT.	N/A	1.4 A±	SLOPE RIGHTS (T) 1750 SQ. FT.		
14	VILLAGE OF BENNINGTON RELINQUISHMENT RT. 7 TO TOWN OF BENNINGTON	9+00 E. T.R.28(W)CONN 11+50 E.	15+97 LT. T.R.28(W)CONN 17+03 E.	N/A	N/A	R.T. & I. TO US 7		

TABLE OF REVISIONS

REVISION NO.	SHEET NO.	DESCRIPTION OF REVISION	DATE	MADE BY	APPROVED BY

DATE BY NBB DATE 3-27-70
DATE BY LWB DATE 3-27-70

----- R.O.W.
----- SLOPE RIGHTS
----- PROPERTY LINE
----- TOP OF CUT
----- TOP OF SLOPE

LEGEND

SR-----SR----- SLOPE RIGHTS
----- P----- P----- PROPERTY LINE
----- C----- C----- TOP OF CUT
----- S----- S----- TOP OF SLOPE

APPROVED *Thomas P. Moore* DATE 5-26-70
CHIEF OF ACQUISITION
APPROVED *G.M. Lane* DATE 5/26/70
HIGHWAY ENGINEER
APPROVED *Thomas P. Moore* DATE 5-26-70
R. W. DIRECTOR

PROJECT BENNINGTON
NO. F 219-1(7)
SHEET 7 OF 17

BEGIN PROJECT F219-1(7)
STA. RT. 7 CONN. 9+00

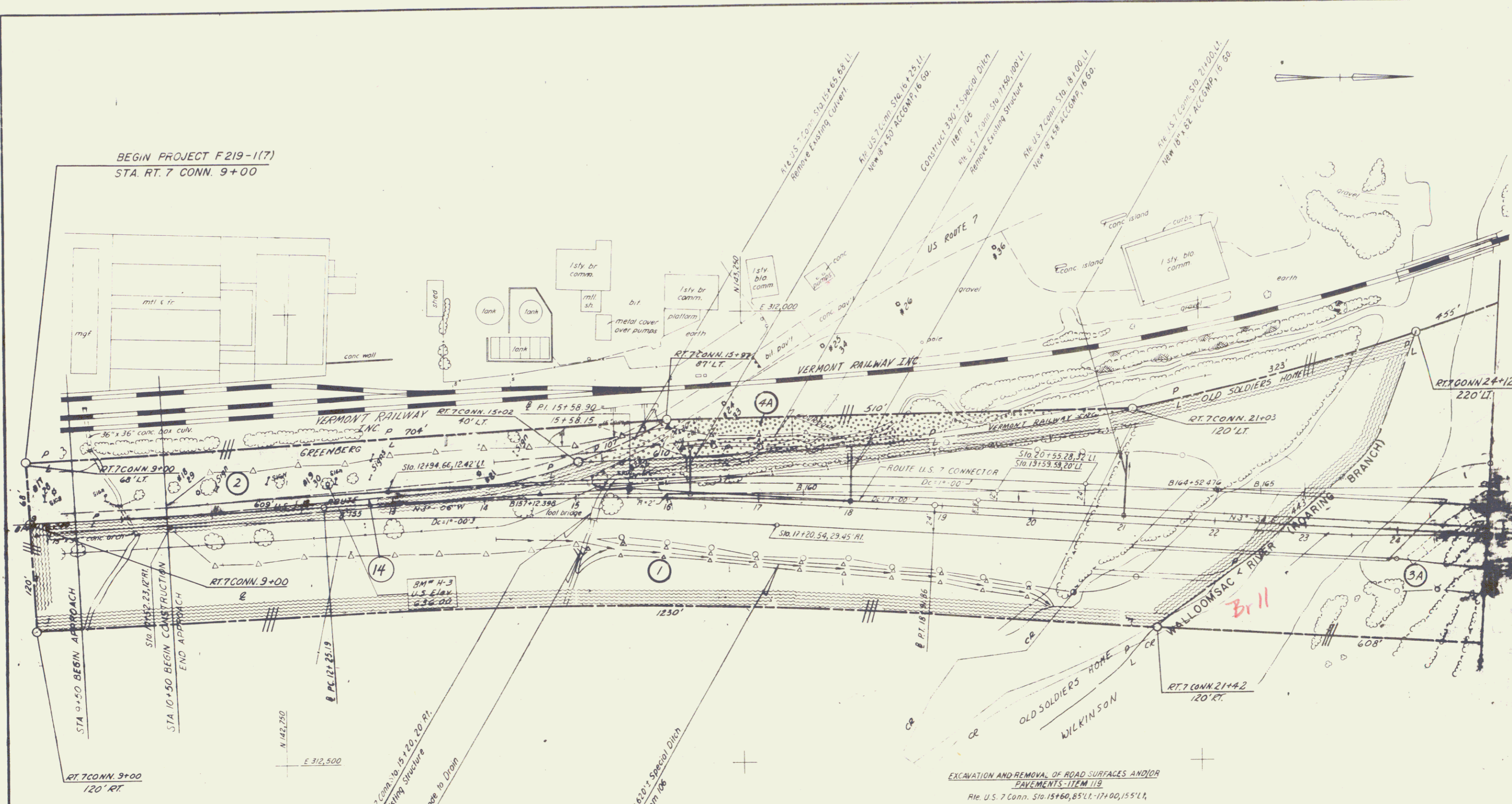

RT. 7 CONN. CURVE DATA

Δ	6°-40'-00" RI
D	1°-00'-00"
R	5729.58'
T	333.71'
L	666.67'
E	9.71'
Bank	14" / 1' RI
RI	N 143° 12' 36" E 312.95.88

BRIDGE RAILING - ITEM 572
Rte. U.S. 7 Conn. Sta. 18+68 - 20+93, RI
Rte. U.S. 7 Conn. Sta. 20+41.5 - 21+54, LI
Rte. U.S. 7 Conn. Sta. 24+10 - 25+00, RI
Rte. U.S. 7 Conn. Sta. 24+62 - 25+00, LI

PLANK GUARD RAIL - ITEM 540
Rte. U.S. 7 Conn. Sta. 17+00, 150' Lt.

JUTE MATTING - ITEM 623
Rte. U.S. 7 Conn. Sta. 11+00 - 16+00, LI
Rte. U.S. 7 Conn. Sta. 11+00 - 15+00, RI

REMOVAL & DISPOSAL OF PRESENT GUARD RAIL - ITEM 549
Rte. U.S. 7 Conn. Sta. 15+10 - 16+00, LI

EXCAVATION AND REMOVAL OF ROAD SURFACES AND/OR PAVEMENTS - ITEM 119
Rte. U.S. 7 Conn. Sta. 15+60, 85' LI - 17+00, 155' LI

STONE FILL FOR SLOPE PROTECTION (Light Type) - ITEM 512
Rte. U.S. 7 Conn. Sta. 16+00 - 18+00, LI
Rte. U.S. 7 Conn. Sta. 19+00 - 20+30, RI

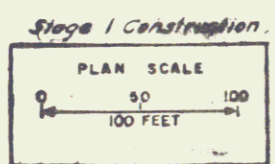

BENNINGTON
F 219-1(7)
ROUTE U.S. 7 CONNECTOR
PLAN STA. 10+50 TO 25+00

Sheet	8 of 17	DATE	
			GOODKIND & O'DEA CONSULTING ENGINEERS

In Charge of
A.J.P.
R.G.E.S.Y.
Checked by
W.L.G.R.
S.Y.E.M.B.

Begin State Highway

BEGIN PROJECT F 219-1(7)
STA. RT. 7 CONN. 9+00

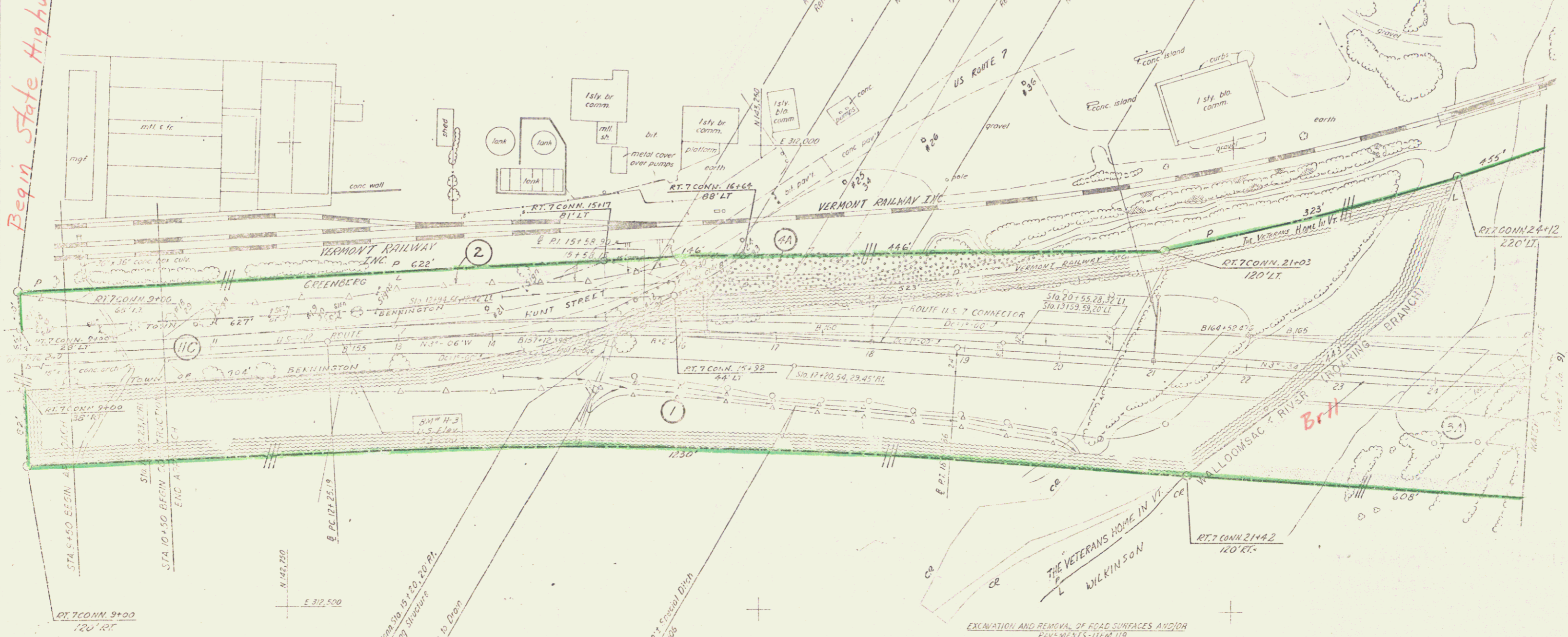

RT. 7 CONN. CURVE DATA

Δ	6° 40' 00" RI
D	1° 00' 00" RI
R	579.58'
T	333.71'
L	666.67'
E	9.71'
Point	N 14° 10' 00" W
PI	N 14° 10' 00" W
	E 312.195.88'

BRIDGE RAILING - ITEM 572
Rte. U.S. 7 Conn. Sta. 18+68 - 20+95, RI
Rte. U.S. 7 Conn. Sta. 20+45 - 21+54, LI
Rte. U.S. 7 Conn. Sta. 24+10 - 25+00, RI
Rte. U.S. 7 Conn. Sta. 24+62 - 25+00, LI

PLANK GUARD RAIL - ITEM 540
Rte. U.S. 7 Conn. Sta. 17+00 - 150' LI

JUTE MATTING - ITEM 623
Rte. U.S. 7 Conn. Sta. 11+00 - 16+00, LI
Rte. U.S. 7 Conn. Sta. 1+00 - 15+00, RI

REMOVAL & DISPOSAL OF PRESENT GUARD RAIL - ITEM 540
Rte. U.S. 7 Conn. Sta. 15+17 - 16+00, LI

EXCAVATION AND REMOVAL OF ROAD SURFACES AND/OR PAVEMENTS - ITEM 119
Rte. U.S. 7 Conn. Sta. 15+00, 65' LI - 17+00, 155' LI

STONE FILL FOR SLOPE PROTECTION (Light slope) - ITEM 512
Rte. U.S. 7 Conn. Sta. 16+00 - 18+00, LI
Rte. U.S. 7 Conn. Sta. 15+00 - 20+30, RI

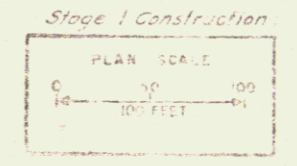

BENNINGTON
F 219-1(7)
ROUTE U.S. 7 CONNECTOR
PLAN STA. 10+50 TO 25+00

Sheet	BA-17	DATE	
WOODRICK & QUINN CONSULTING ENGINEERS			

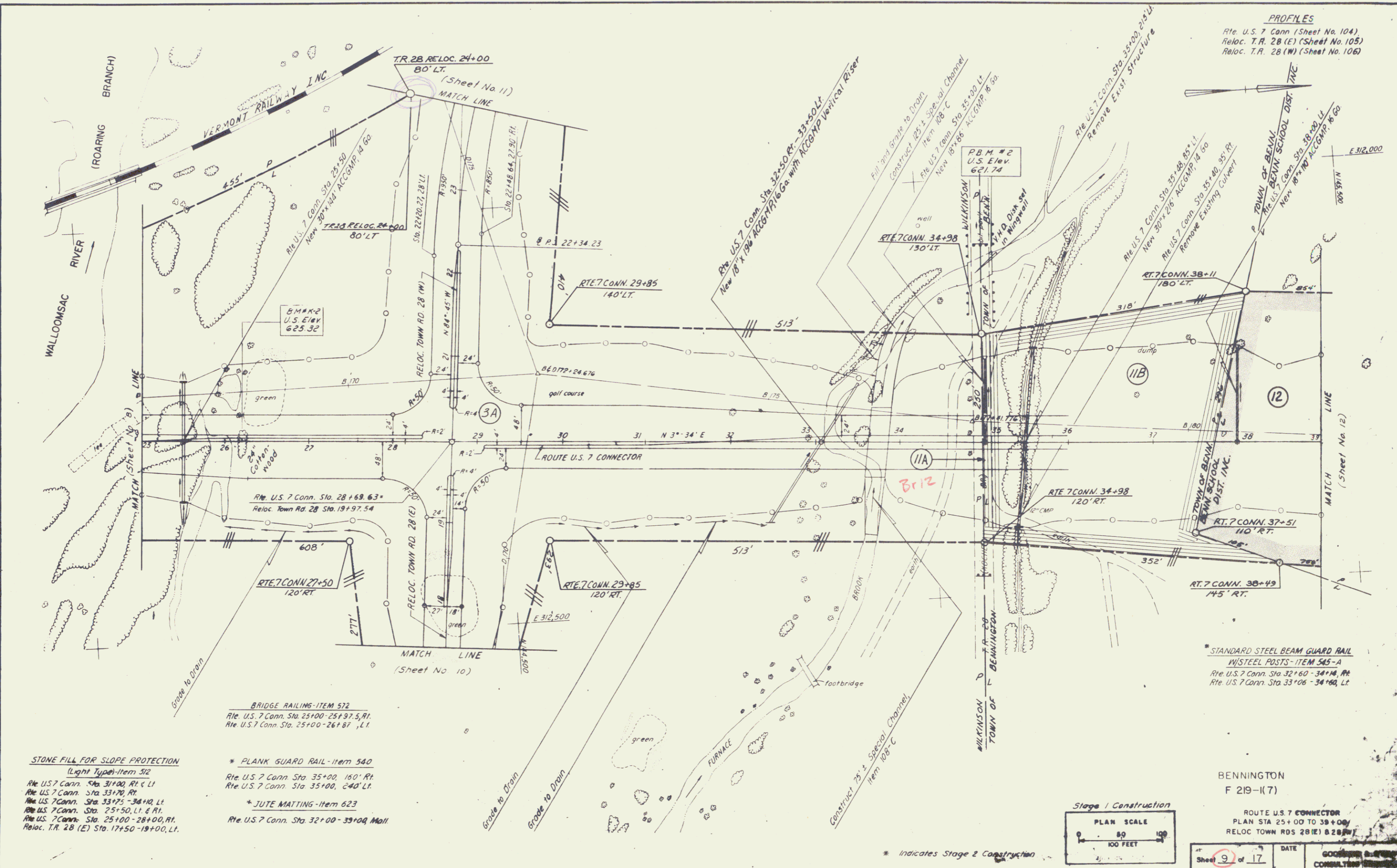

PROFILES
 Rte. U.S. 7 Conn (Sheet No. 104)
 Reloc. T.R. 28 (E) (Sheet No. 105)
 Reloc. T.R. 28 (W) (Sheet No. 106)

STANDARD STEEL BEAM GUARD RAIL
 IN STEEL POSTS - ITEM 545-A
 Rte. U.S. 7 Conn. Sta. 32+60 - 34+10, RR
 Rte. U.S. 7 Conn. Sta. 33+06 - 34+10, LT.

STONE FILL FOR SLOPE PROTECTION
 Light Type - Item 312
 Rte. U.S. 7 Conn. Sta. 31+00, RT & LT
 Rte. U.S. 7 Conn. Sta. 33+70, RT
 Rte. U.S. 7 Conn. Sta. 33+75 - 34+10, LT
 Rte. U.S. 7 Conn. Sta. 25+50, LT & RT
 Rte. U.S. 7 Conn. Sta. 25+00 - 28+00, RT
 Reloc. T.R. 28 (E) Sta. 19+50 - 19+00, LT.

BRIDGE RAILING - ITEM 532
 Rte. U.S. 7 Conn. Sta. 25+00 - 25+97.5, RT
 Rte. U.S. 7 Conn. Sta. 25+00 - 26+87, LT.

*** PLANK GUARD RAIL - Item 540**
 Rte. U.S. 7 Conn. Sta. 35+00, 150' RT
 Rte. U.S. 7 Conn. Sta. 35+00, 240' LT.

*** JUTE MATTING - Item 623**
 Rte. U.S. 7 Conn. Sta. 32+00 - 33+00, Mail

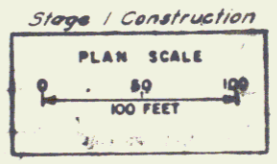

Sheet 9 of 17

DATE _____
 CONSULTING ENGINEER _____

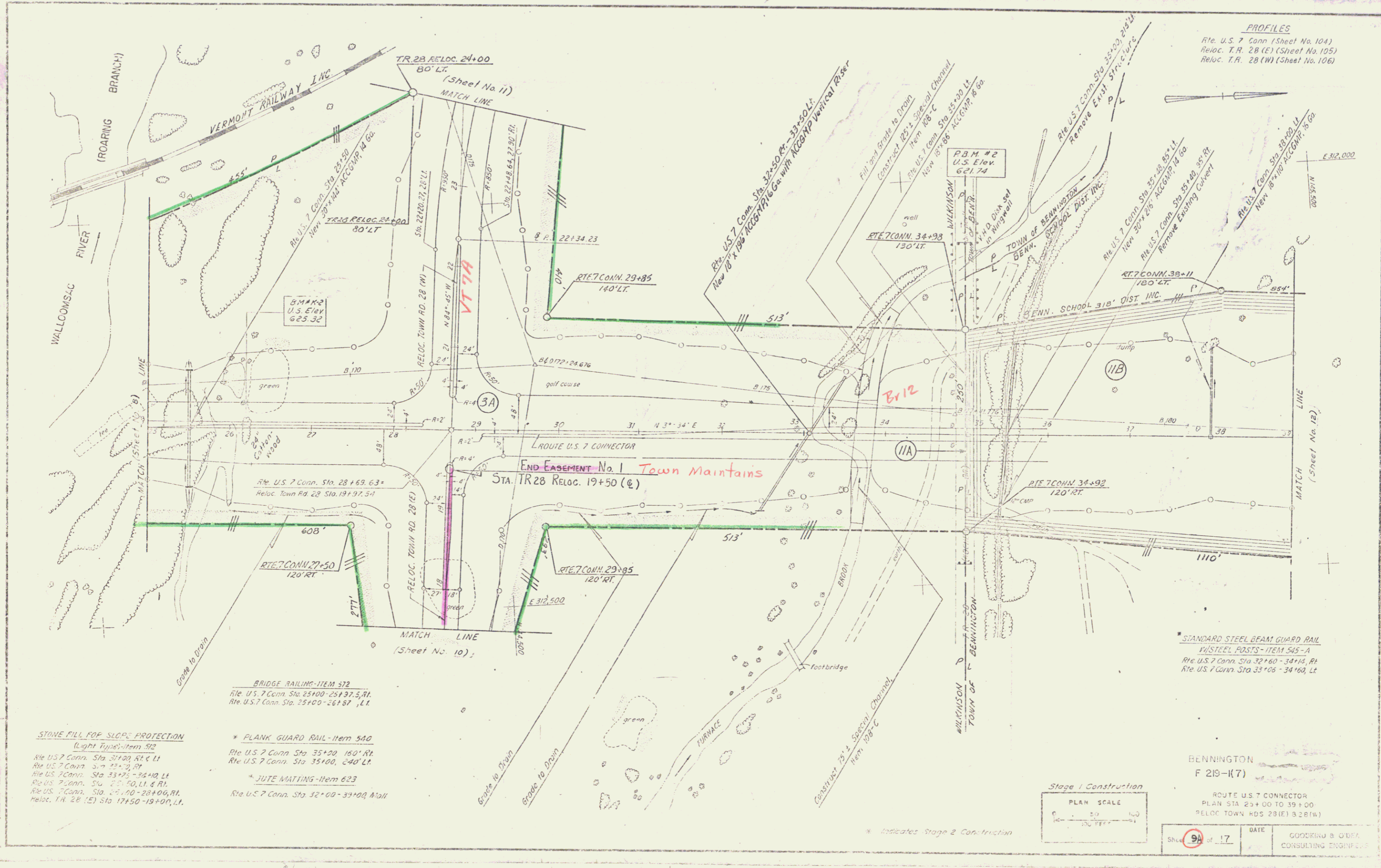

PROFILES
 Rte. U.S. 7 Conn. (Sheet No. 104)
 Reloc. T.R. 28 (E) (Sheet No. 105)
 Reloc. T.R. 28 (W) (Sheet No. 106)

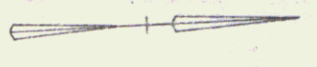

STONE FILL FOR SLOPE PROTECTION
 (Light Type)-Item 512
 Rte. U.S. 7 Conn. Sta. 31+00, Rt. & Lt.
 Rte. U.S. 7 Conn. Sta. 32+20, Rt.
 Rte. U.S. 7 Conn. Sta. 33+75 - 34+00, Lt.
 Rte. U.S. 7 Conn. Sta. 35+00, Lt. & Rt.
 Rte. U.S. 7 Conn. Sta. 27+00 - 28+00, Rt.
 Reloc. T.R. 28 (E) Sta. 17+50 - 19+00, Lt.

*** PLANK GUARD RAIL - Item 540**
 Rte. U.S. 7 Conn. Sta. 35+20 - 35+00, Rt.
 Rte. U.S. 7 Conn. Sta. 35+00, 240' Lt.
*** JUTE MATTING - Item 623**
 Rte. U.S. 7 Conn. Sta. 32+00 - 33+00, Match

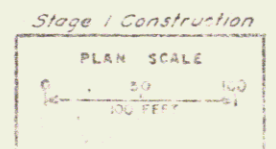

STANDARD STEEL BEAM GUARD RAIL
 W/STEEL POSTS - ITEM 545-A
 Rte. U.S. 7 Conn. Sta. 32+60 - 34+15, Rt.
 Rte. U.S. 7 Conn. Sta. 33+05 - 34+60, Lt.

BENNINGTON
 F 219-(K7)
 ROUTE U.S. 7 CONNECTOR
 PLAN STA. 23+00 TO 39+00
 RELOC. TOWN RDS 28(E) & 28(W)

Sheet **9A** of **17** DATE _____
 GOODKING & O'DEA
 CONSULTING ENGINEERS

DRIVE
LT. 14+75 RT. 14+75

STONE FILL FOR SLOPE PROTECTION
(Light Type) ITEM 512
Reloc. T.R. 28 (E) Sta. 9+55-12+55, LI
Reloc. T.R. 28 (E) Sta. 13+65-13+95, RI
Reloc. T.R. 28 (E) Sta. 12+25-17+50, L+

STANDARD STEEL BEAM GUARD RAIL
W/STEEL POSTS - ITEM 545-A
Reloc. T.R. 28 (E) Sta. 8+60-14+60, LI
Reloc. T.R. 28 (E) Sta. 12+60-14+14, RI

PLAN	NO. 1
NOTED	NO. 2
ALTERNATE CHECKED	NO. 3
BY	NO. 4
DATE	NO. 5
NO.	NO. 6

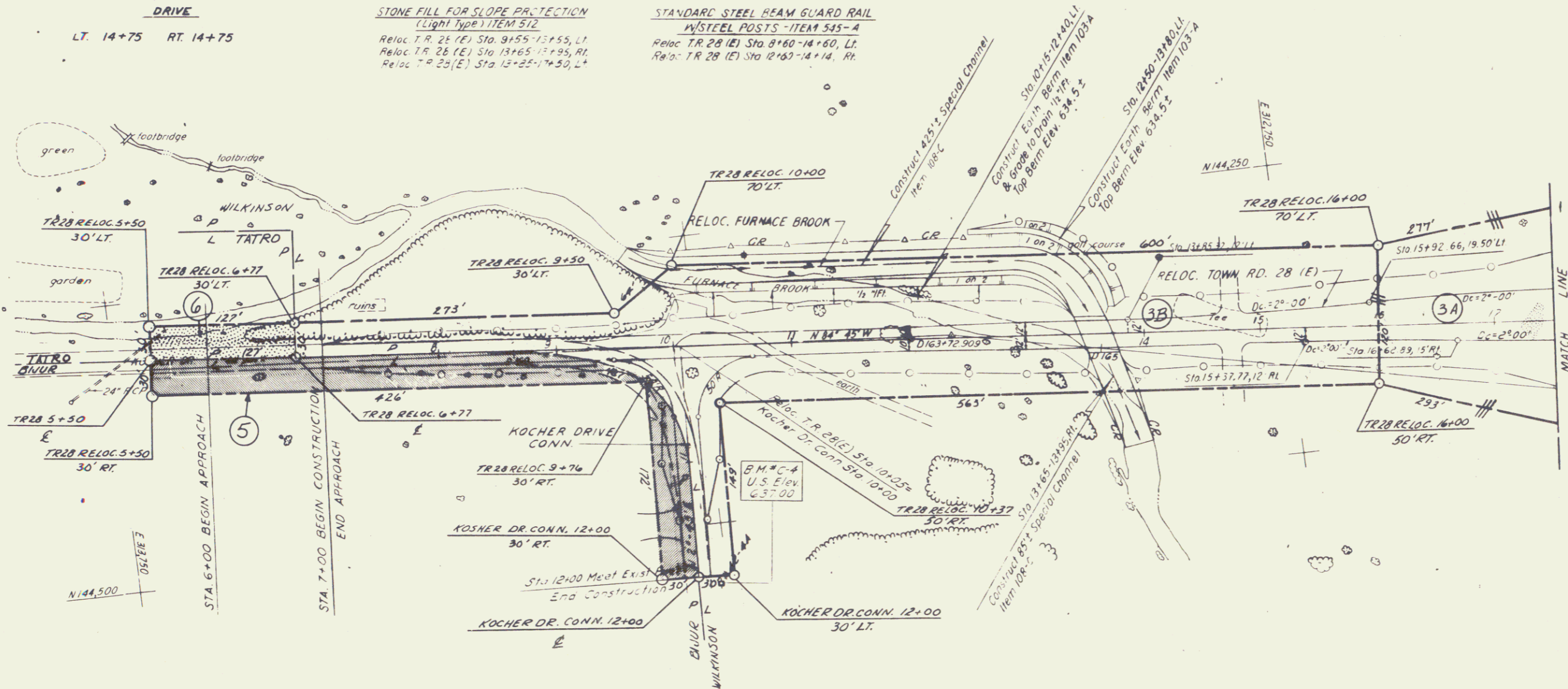

MATCH LINE
(Sheet No. 9)

RELOC. T.R. 28 (E)
PLAN STA. 7+00 TO 17+50

BENNINGTON
F 219-(17)

Sheet 10 of 17

11

NOTE: EXISTING ROW PLOTTED FROM HWY PROJECT BENNINGTON 'AP.23 CONT. 2 (1938)

NOTE: For Construction Notes See Sheet 126A

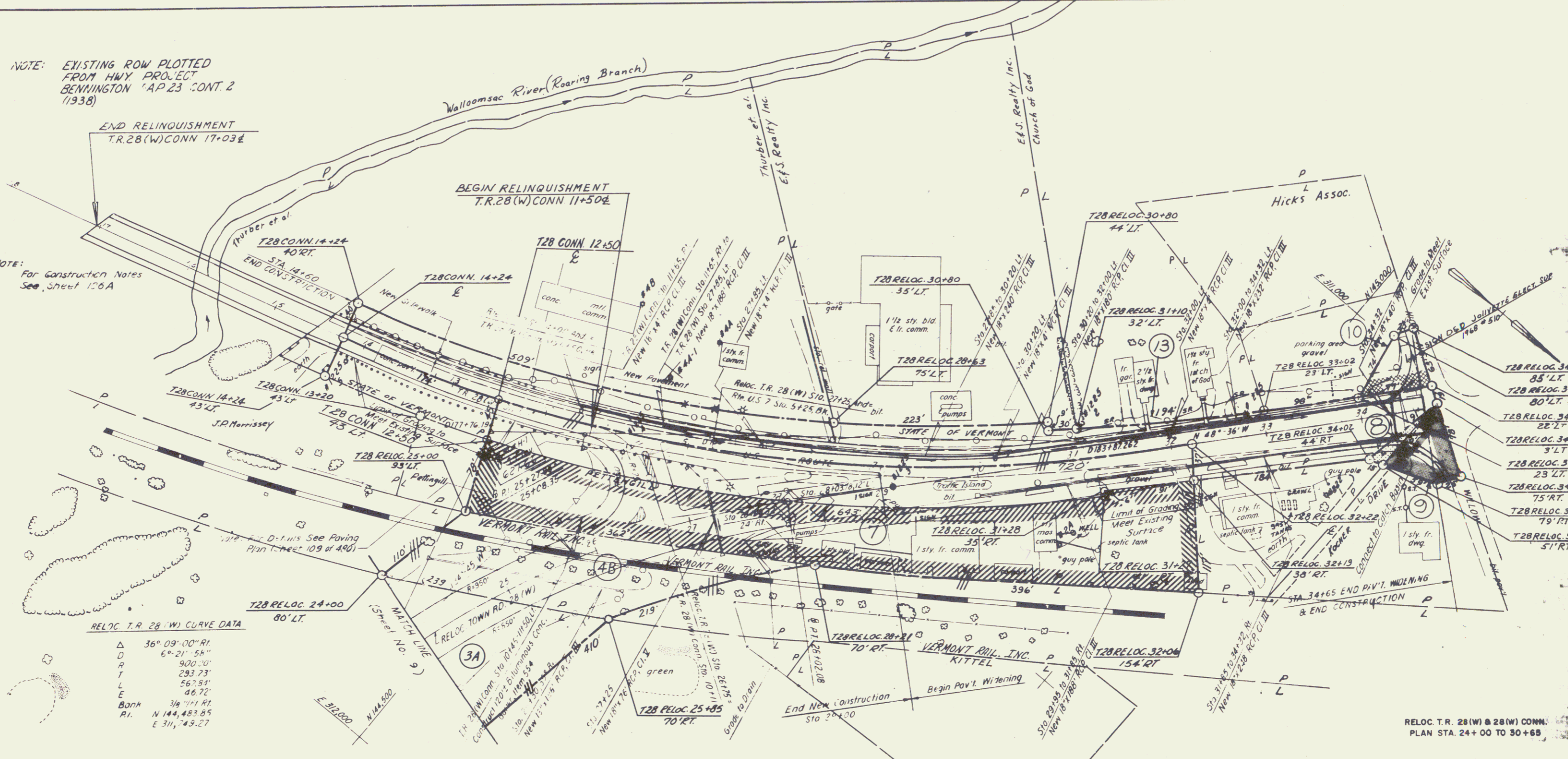

RELOC. T.R. 28 (W) CURVE DATA

Δ	36° 09' 00" RI
D	6° 21' 56"
R	900.00'
T	293.73'
L	56.78'
E	66.72'
BDOP	3/4 "1" RI
PI	N 144,483.85
	E 311,749.27

- 3A CHARLES M. WILKINSON
- 4B STATE OF VERMONT (LESSOR)
RUTLAND RAILROAD CORP (LESSEE)
- 7 NED H. PETTENGILL
- 8 NORTHERN TERMINALS INC.
- 9 HOWARD W. & AUXILLIA W. MOORE
- 10 CHARLESTOWN MILL STORE (LESSEE)

RELOC. T.R. 28(W) & 28(W) CONN.
PLAN STA. 24+00 TO 30+65

BENNINGTON
F 219-(17)

Sheet 11 of 17

NOTE: EXISTING ROW PLOTTED FROM HWY PROJECT BENNINGTON MAP 23 CONT 2 (1338)

END RELINQUISHMENT NO. 1
T.R. 28 (W) CONN 17+03 E

NOTES:
For Construction Notes
See Sheet 100A

DATE	BY	REVISION
10/1/77	J.P. HERRISSEY	REVISED
10/1/77	J.P. HERRISSEY	REVISED
10/1/77	J.P. HERRISSEY	REVISED
10/1/77	J.P. HERRISSEY	REVISED

RELOC T.R. 28 (W) CURVE DATA

A	167° 02' 00" RI
B	6° 21' 54" R
C	90° 00' 00" R
D	28° 27' 00" R
E	186° 15' 00" R
F	316° 04' 00" R
PI	N 144.25° E 55'
EA	E 311° 43.27'

- 3A CHARLES M. WILKINSON
- 4B STATE OF VERMONT (LESSOR)
RUTLAND RAILROAD CORP (LESSEE)
- 7 NED H. PETTENGILL
- 8 NORTHERN TERMINALS INC.
- 9 HOWARD W. & AUXILLIA W. MOORE
- 10 CHURCH OF GOD (LESSOR)
CHARLESTOWN HILL STORE (LESSEE)

Construct Commercial Drives

- 31+43 Lt
- 32+22 Lt
- 32+00 Lt
- 30+25 Rt
- 32+00 Rt
- 32+50 Rt

109 20

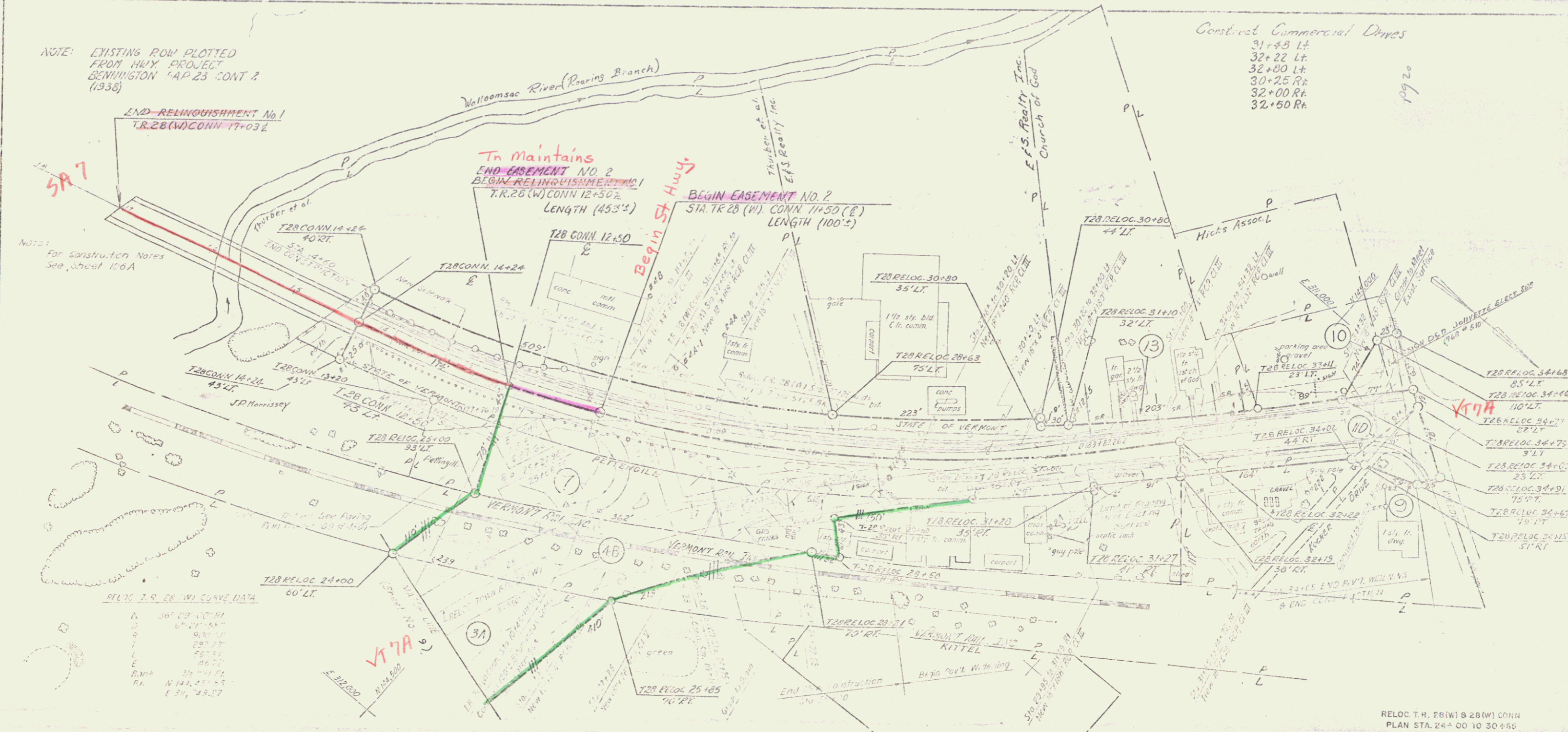

RELOC T.R. 28 (W) & 28 (W) CONN
PLAN STA. 24+00 TO 30+65

BENNINGTON
F 219-(17)

Sheet 11A of 17

14

***NOTE MATERIALS ITEM 553**

Rt. U.S. 7 Conn. Sta. 42+00 to 46+00, LT
 Rt. U.S. 7 Conn. Sta. 42+00 to 46+00, RT
 Ramp C Sta. 15+95 to 17+50, LT
 Ramp C Sta. 15+95 to 17+50, RT
 Ramp B Sta. 47+60 to 47+80, RT

Rt. U.S. 7 Conn. Sta. 42+00, LT
 Rt. U.S. 7 Conn. Sta. 42+00 to 46+00, RT
 Ramp C Sta. 15+95 to 17+50, LT
 Ramp C Sta. 15+95 to 17+50, RT
 Ramp B Sta. 47+60 to 47+80, RT

PROFILES

Rt. U.S. 7 Conn. (Sheet No. 54)
 Ramp B (Sheet No. 56)
 Ramp C (Sheet No. 57)

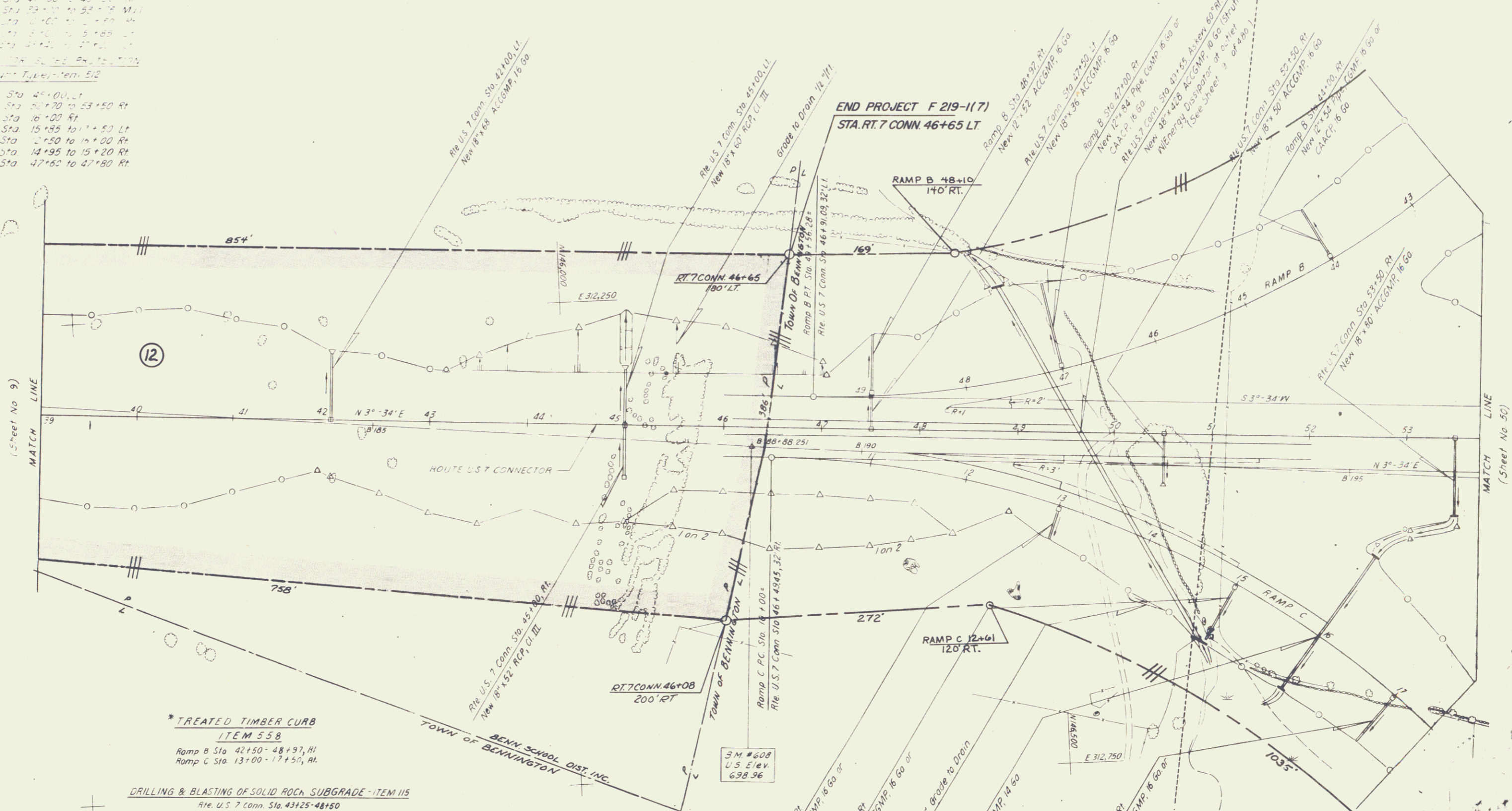

*** TREATED TIMBER CURB
ITEM 558**
 Ramp B Sta. 42+50 - 48+97, RT
 Ramp C Sta. 13+00 - 17+50, RT

DRILLING & BLASTING OF SOLID ROCK SUBGRADE - ITEM 115
 Rt. U.S. 7 Conn. Sta. 43+25 - 48+50
 Ramp C Sta. 10+00 - 12+25

*** THREE CABLE GUARD RAIL W/LIGHT
STEEL POSTS ITEM 538**
 Ramp B Sta. 42+50 - 44+08, LT
 Ramp B Sta. 42+50 - 49+56, RT
 Ramp C Sta. 11+95 - 17+50, RT

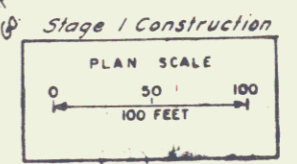

BENNINGTON, F 219-(17)
 ROUTE U.S. 7 CONNECTOR
 FROM STA. 38+00 TO 53+75
 RAMP B, B, C
 DATE: 12/17
 SHEET: 12 of 17

In Charge of: [Signature]
 Made by: [Signature]
 Checked by: [Signature]

* Indicates Stage 2 Construction

15

*JUTE MATTING - ITEM 523

Rte. U.S. 7 Conn. Sta. 41+30 to 46+50 Rt.
Rte. U.S. 7 Conn. Sta. 39+00 to 53+75 Mull.
Ramp C Sta. 10+00 to 12+50 Rt.
Ramp C Sta. 13+00 to 15+85 Lt.
Ramp B Sta. 43+40 to 47+00 Lt.

STONE FILL FOR SLOPE PROTECTION
(Light Type) - Item 512

Rte. U.S. 7 Conn. Sta. 45+00, Lt.
Rte. U.S. 7 Conn. Sta. 52+70 to 53+50 Rt.
Ramp C Sta. 16+00 Rt.
Ramp C Sta. 15+85 to 17+50 Lt.
Ramp C Sta. 12+50 to 14+00 Rt.
Ramp C Sta. 14+95 to 15+20 Rt.
Ramp B Sta. 47+60 to 47+80 Rt.

PROFILES

Rte. U.S. 7 Conn. (Sheet No. 54)
Ramp B (Sheet No. 56)
Ramp C (Sheet No. 57)

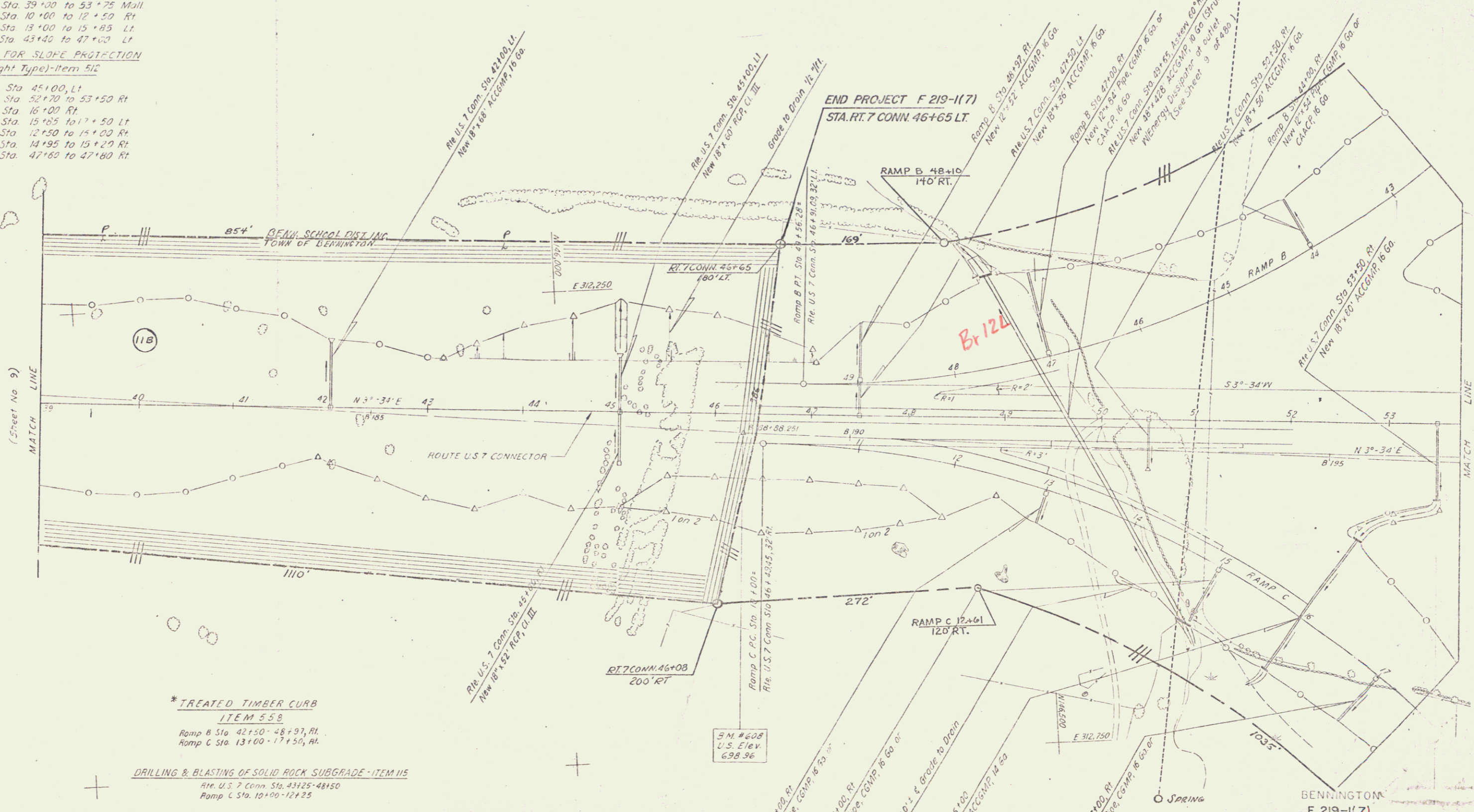

* TREATED TIMBER CURB
ITEM 558
Ramp B Sta. 42+50 - 48+97, Rt.
Ramp C Sta. 13+00 - 17+50, Rt.

DRILLING & BLASTING OF SOLID ROCK SUBGRADE - ITEM 115
Rte. U.S. 7 Conn. Sta. 43+25 - 48+50
Ramp C Sta. 10+00 - 12+25

* THREE CABLE GUARD RAIL W/ LIGHT
STEEL POSTS - ITEM 538
Ramp B Sta. 42+50 - 44+00, Lt.
Ramp B Sta. 42+50 - 43+50, Rt.
Ramp C Sta. 11+95 - 17+50, Rt.

S.M. #608
U.S. Elev.
698.36

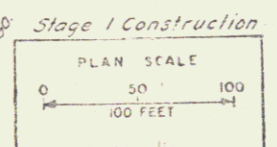

Sheet 12 of 17

DATE
GOODKIND & O'NEA
CONSULTING ENGINEERS

In Charge of
A. J. ...
Made by
L. C. ...
Checked by
S. T. E. B. B.