

Begin State Highway

BEGIN PROJECT F219-1(7)  
STA. RT. 7 CONN. 9+00

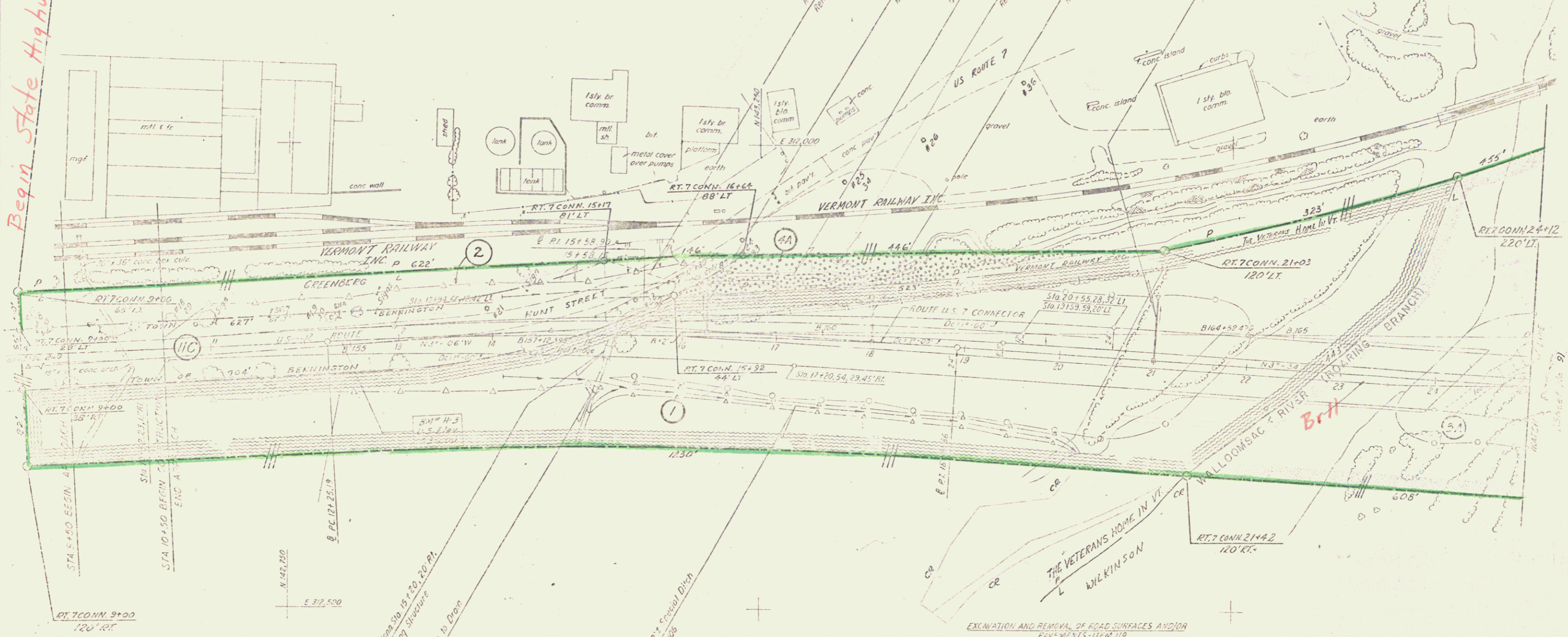

**RT. U.S. 7 CONN. CURVE DATA**

Δ	6° 40' 00" RI
D	1° 00' 00" RI
P	579.58'
T	333.71'
L	666.67'
E	9.71'
Point	N 14° 21' 55" W
PI	E 312.195.88'

**BRIDGE RAILING - ITEM 572**

Sta. U.S. 7 Conn. Sta. 18+68 - 20+95, RI  
Sta. U.S. 7 Conn. Sta. 20+15 - 21+54, LI  
Sta. U.S. 7 Conn. Sta. 24+10 - 25+00, RI  
Sta. U.S. 7 Conn. Sta. 24+62 - 25+00, LI

**PLANK GUARD RAIL - ITEM 540**

Sta. U.S. 7 Conn. Sta. 17+00 - 150' LI

**JUTE MATTING - ITEM 623**

Sta. U.S. 7 Conn. Sta. 11+00 - 16+00, LI  
Sta. U.S. 7 Conn. Sta. 1+00 - 15+00, RI

**REMOVAL & DISPOSAL OF PRESENT GUARD RAIL - ITEM 540**

Sta. U.S. 7 Conn. Sta. 15+10 - 16+00, LI

**EXCAVATION AND REMOVAL OF ROAD SURFACES AND/OR PAVEMENTS - ITEM 119**

Sta. U.S. 7 Conn. Sta. 15+60, 65' LI - 17+00, 155' LI

**STONE FILL FOR SLOPE PROTECTION (LIGHT SLOPE) - ITEM 512**

Sta. U.S. 7 Conn. Sta. 16+00 - 18+00, LI  
Sta. U.S. 7 Conn. Sta. 15+00 - 20+30, RI

**Stage I Construction**

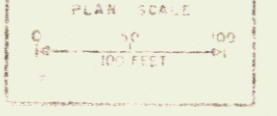

BENNINGTON  
F 219-1(7)

ROUTE U.S. 7 CONNECTOR  
PLAN STA. 10+50 TO 25+00

Sheet	8A	of	17
DATE			
WOODRICK & QUINN CONSULTING ENGINEERS			