

**INDEX OF SHEETS**

SHEET NO.	TITLE PAGE
"	BRIDGE STA. 35+20
"	" 1-PLAN & PROFILE
"	" 2-DETAILS OF REPAIRS
"	" 3-5B-2 TYPICAL DETAILS
"	" 4-5B-2 CROSS SECTIONS
"	BRIDGE STA. 62+11
"	" 12-PLAN & PROFILE
"	" 3-5B-2 TYPICAL DETAILS
"	" 4-5B-2 CROSS SECTIONS
"	" 5-5B-2 TYPICAL DETAILS
"	" 6-5B-2 " "
"	" 7-5B-2 " "
"	" 8-5B-2 SKEW ENDS
"	" 9-5B-2 CABLE GUARDRAIL
"	" 10-5B-2 SPECIAL DETAILS
"	" 11-STANDARD STRUCTURES SERIES-522
"	" 12-CROSS SECTIONS
"	TEMPORARY BRIDGE SHEET.

FED. ROAD DIST. NO.	STATE	FED. AID PROJ. NO.	FISCAL YEAR	SHEET NO.	TOTAL SHEETS
9	VT.	12-L	1951	20	20

**STATE OF VERMONT  
STATE HIGHWAY DEPARTMENT**

**PLAN AND PROFILE OF PROPOSED  
STATE HIGHWAY**  
STATE FEDERAL AID PROJECT

**TOWN OF DORSET**  
**RUTLAND-BENNINGTON ROAD**  
NEW FLOOR FOR BRIDGE STA. 35+20  
AND  
NEW BRIDGE STA. 62+11

Pin# 99R506  
Route: VT 7A

(ON F.A.P. NO. -12)

**SCALE**  
PLAN --- 1" = 20 FT.  
VERTICAL --- 1" = 20 FT.  
HORIZONTAL --- 1" = 20 FT.  
SECTIONS --- 1" = 5 FT.

STA 35+00 MP 0.530	STA 66+00 MP 1.174
STA 35+00 MP 0.441	STA 38+00 MP 1.023

APPROVED: AUG 31, 1951

CHIEF ENGINEER  
SUBMITTED BY ORDER OF THE STATE HIGHWAY BOARD

*W. Dargatzis*  
COMMISSIONER OF HIGHWAYS

**CONVENTIONAL SIGNS**

COUNTY LINE	RAILROAD
TOWN LINE	RETAINING WALL
FENCE LINE	CENTER LINE
STONE WALL	SURVEY LINE
UNFENCED PROPERTY	CULVERT
GUARD RAIL	DROP INLET
TRAVELED WAY	TROLLEY POLE
RAILROAD	POWER POLE
RETAINING WALL	TELEPHONE POLE
CENTER LINE	TREE
SURVEY LINE	HEDGE
CULVERT	
DROP INLET	
TROLLEY POLE	
POWER POLE	
TELEPHONE POLE	
TREE	
HEDGE	

**GROUND ELEVATION**

GROUND ELEVATION	BATHY	LINE
GRADE ELEVATION	BATHY	LINE

**CURVE DATA**

DEFLECTION ANGLE	Δ
DEGREE OF CURVE	D.
RADIUS OF CURVE	R.
TANGENT DISTANCE	T.
LENGTH OF CURVE	L.
EXTERNAL DISTANCE	E.
POINT OF INTERSECTION	P. I.
POINT OF CURVE	P. C.
POINT OF TANGENT	P. T.
POINT ON TANGENT	P. O. T.

RECOMMENDED  
DISTRICT ENGINEER  
BUREAU OF PUBLIC ROADS  
RECOMMENDED FOR APPROVAL  
CHIEF ENGINEER  
BUREAU OF PUBLIC ROADS  
APPROVED  
DIRECTOR - BUREAU OF PUBLIC ROADS

Project No. S.F.A 12L

SERIES 379 No. 12-L FILED  
SHEET 1 OF 20

DIST. # 1 PLAN 1

DIST. NO.	STATE	FISCAL YEAR	SHEET NO.	TOTAL SHEETS
8	VT	1924	1	5

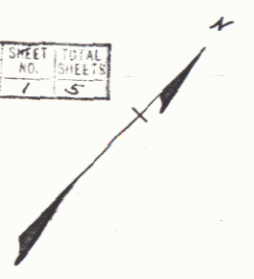

PLAN  
DATE  
BY  
CHECKED  
APPROVED

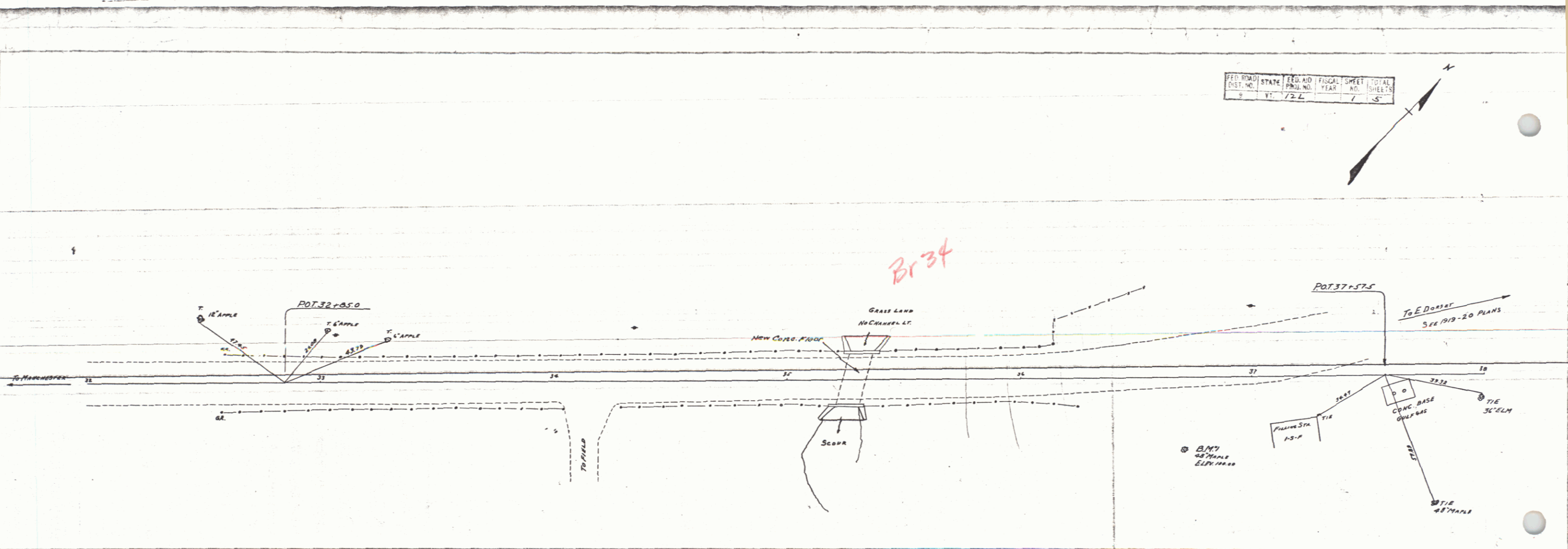

INDEX OF SHEETS  
SHEET NO. 1 - PLANS PROFILE  
" 2 - DETAILS OF REPAIRS  
" 3 - S.E. TYPICAL DETAILS  
" 4 - SCISS Sections.

PROFILE  
DATE  
BY  
CHECKED  
APPROVED

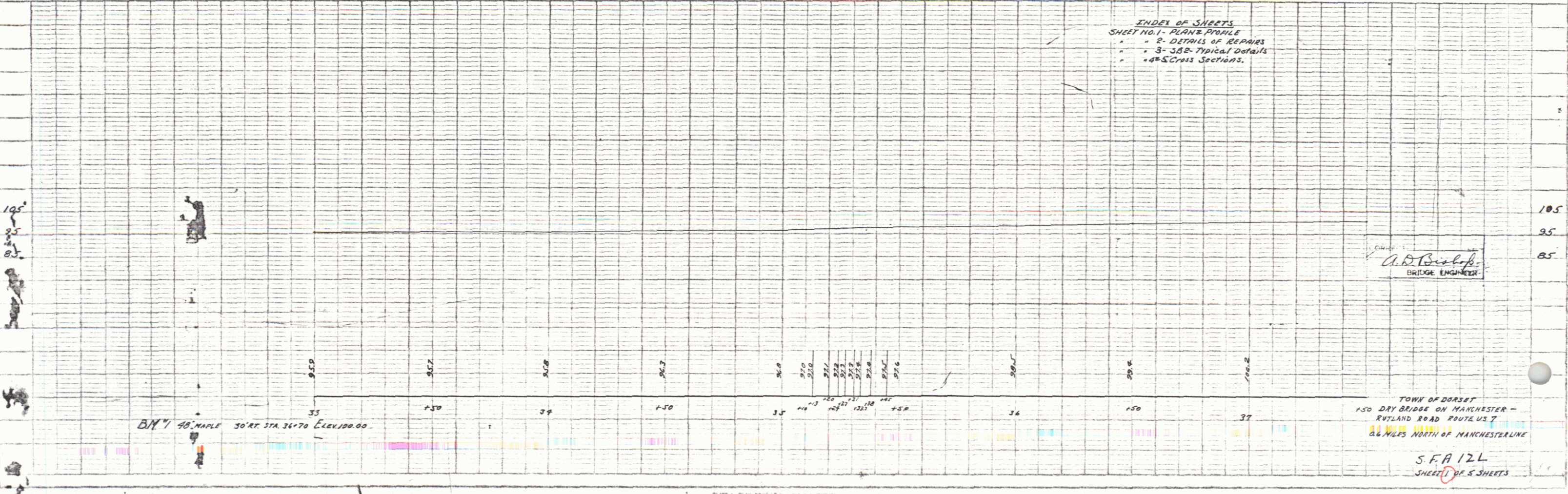

A. R. [Signature]  
BRIDGE ENGINEER

TOWN OF DORSET  
150 DRY BRIDGE ON MANCHESTER -  
RUTLAND ROAD ROUTE US 7  
0.6 MILES NORTH OF MANCHESTER LINE  
S.F.A. 12L  
SHEET 1 OF 5 SHEETS

PLATE 1, PLAN-PROFILE OF BRIDGE

**CABLE GUARD RAIL**  
 RT STA. 61+86.5 TO STA. 62+35.5 = 49 L.Ft.  
 LT. STA. 61+86.5 TO STA. 62+35.5 = 49 L.Ft.  
 4 Anchors @ 20 L.Ft. = 80 L.Ft.  
 TOTAL = 178 L.Ft.

Parcel	Kind of Instrument	Date of Grant	Grantor	Grantee	Recorded	Remarks
1007-1-1-1-1	G.C.D.	10-31-51	Hildred B. Whalen	St. 32	160	17-3-51 Br. Sta. 63+10

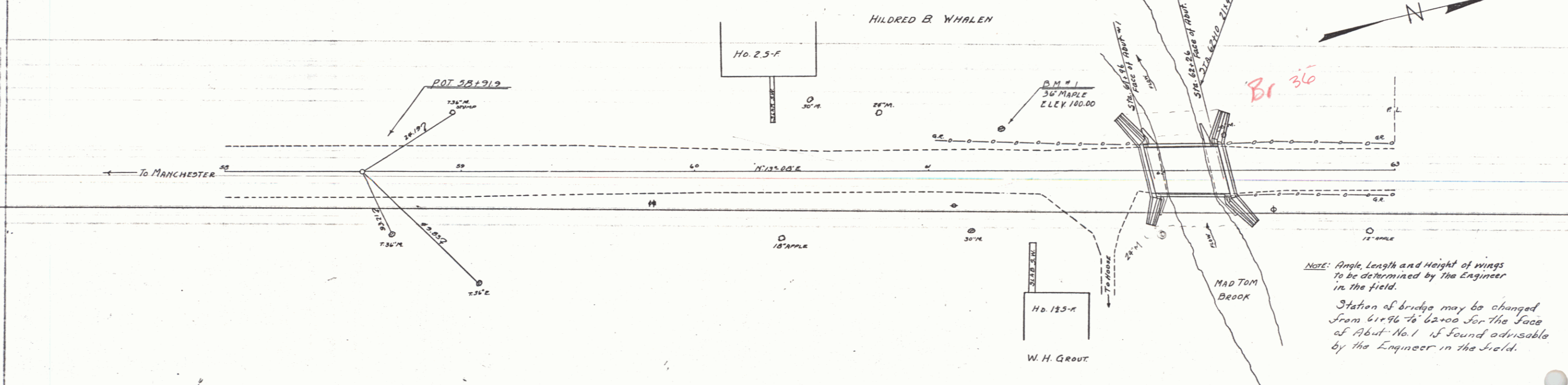

NOTE: Angle, Length and Height of wings to be determined by the Engineer in the field.  
 Station of bridge may be changed from 61+96 to 62+00 for the face of Abut. No. 1 if found advisable by the Engineer in the field.

**ESTIMATED QUANTITIES**

Item No. 15 Structure Excav.	340 cu. yds.
" " 33A - Conc. Class A'	37 "
" " 33C - " " C'	196 "
" " 34 - Reinforcing Steel	11,362 lbs.
" " 67 - Cable Guard Rail	178 L.Ft.
" " 68 - Timber Piling	2300 L.Ft. (to be used only in the field)
" " 55 - Temporary Bridge and mainfaining traffic T-13.	
" " 14 - Channel Excav.	500 cu. yds.

**INDEX OF SHEETS**

SHEET NO. 182 - PLAN & PROFILE	
" " 3 - 37B20 NO. 30 - 15" SKEW	
" " 4 - 37B21A - 15" SKEW - H=12	
" " 5 - 382 TYPICAL DETAILS	
" " 6 - 382A "	
" " 7 - 382B "	
" " 8 - 383 Skew ends	
" " 9 - 385 Standard Cable Rail	
" " 10 - 386 Special Details	
" " 11 - Standard Structures Series, S22	
" " 12-13 - Cross Sections	

**REFERENCES**

S82 - S202, S204, S220, S221, S206
S82A - S223, S227
S82B - S241
S8 6 - 3609
S2.8

NOTE: Present Superstructure shall be removed by the Contractor and shall be paid for as Structure Excavation. River Channel below bridge shall be excavated to a depth and width and a distance down stream from the new bridge as directed by the Engineer in the field.

NOTE: Piles will be used if found necessary upon completion of structure excavation and ordered by Engineer in the field.

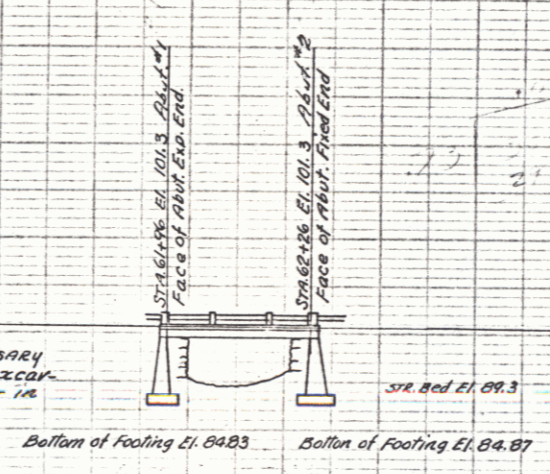

Approved: *H. S. Sargent*  
 CHIEF ENGINEER

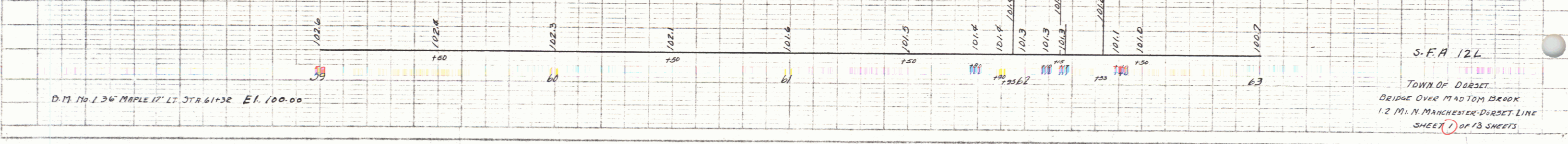

S.F.A. 12L  
 TOWN OF DORSET  
 BRIDGE OVER MAD TOM BROOK  
 1.2 MI. N. MANCHESTER-DORSET LINE  
 SHEET 7 OF 13 SHEETS

DIST. ROAD STATE FEED. ADJ. (FISCAL) SHEET NO. 124  
 DIST. NO. YEAR 2 13

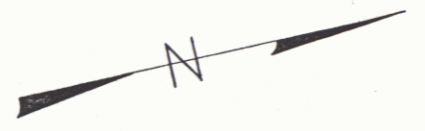

Mrs. SEYMOUR  
 No. 2-3-F

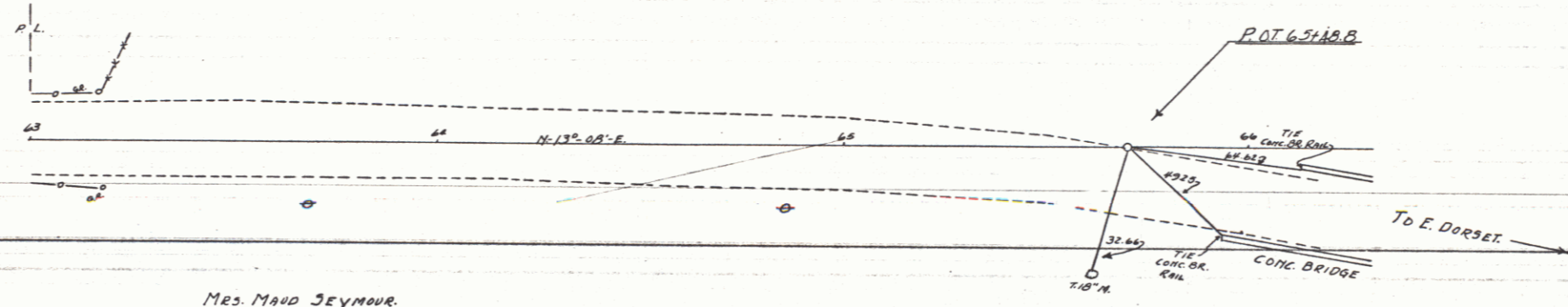

Mrs. MAUD SEYMOUR.

PLAN  
 DATE  
 DRAWN BY  
 CHECKED BY

PLAN  
 DATE  
 DRAWN BY  
 CHECKED BY

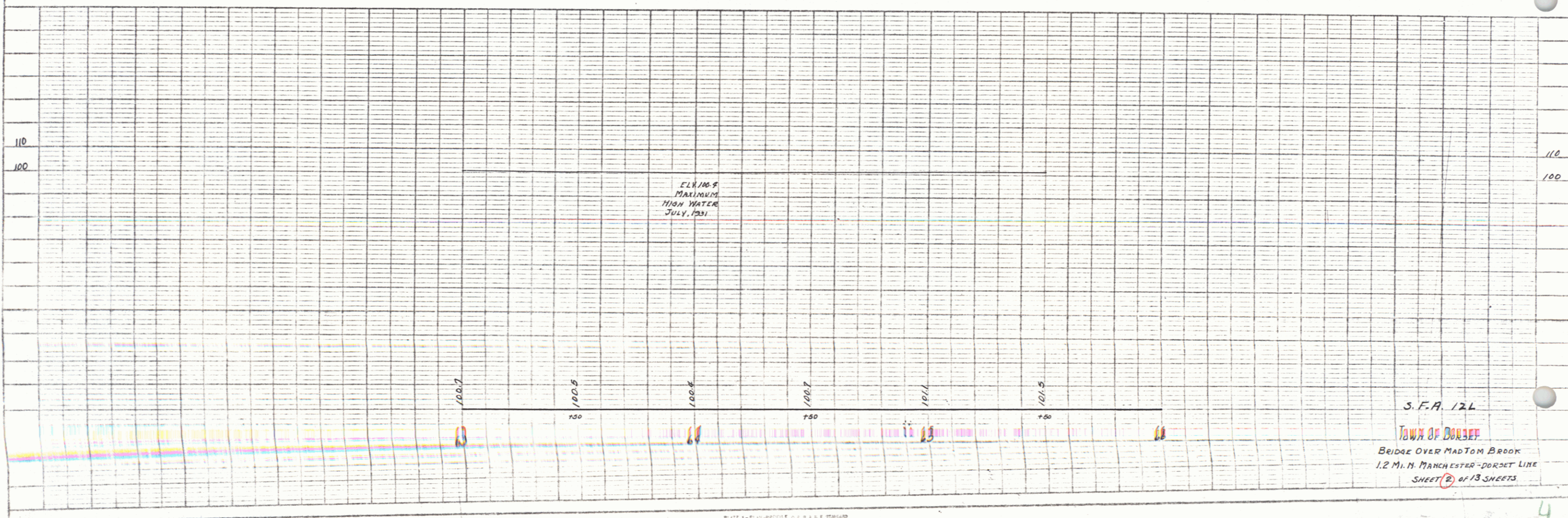

S. F. A. 124

TOWN OF DORSET  
 BRIDGE OVER MAD TOM BROOK  
 1.2 MI. N. MANCHESTER-DORSET LINE  
 SHEET (B) OF 13 SHEETS