

CABLE GUARD RAIL
 RT STA. 61+86.5 TO STA. 62+35.5 = 49 L.Ft.
 LT STA. 61+86.5 TO STA. 62+35.5 = 49 L.Ft.
 4 Anchors @ 20 L.Ft. = 80 L.Ft.
 TOTAL = 178 L.Ft.

Parcel	Kind of Instrument	Date of Grant	Grantor	Grantee	Recorded	Remarks
1007-1-1-1-1	G.C.D.	10-31-51	Hildred B. Whalen	St. 32	160	17-3-51 Br. Sta. 63+10

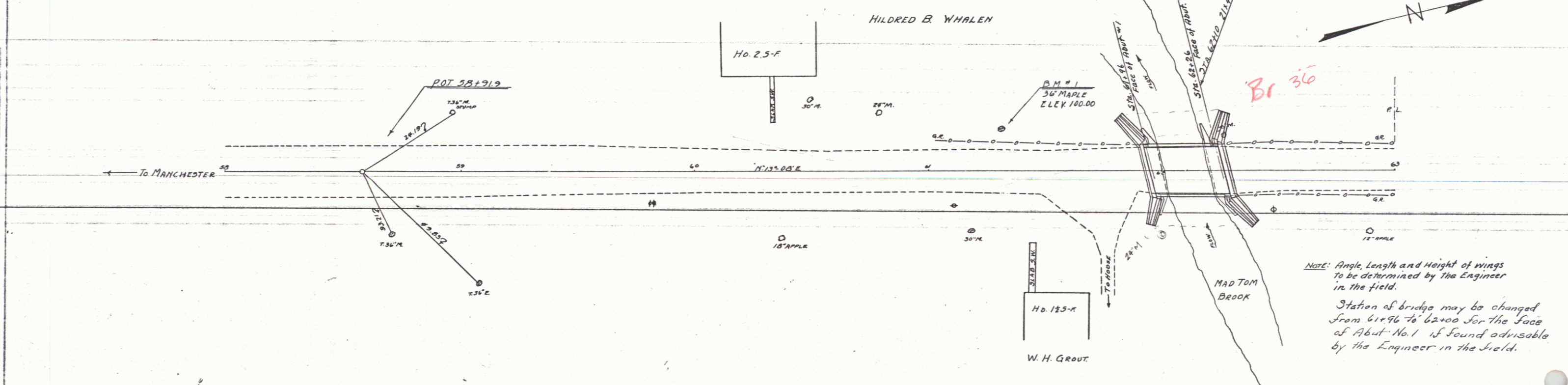

NOTE: Angle, Length and Height of wings to be determined by the Engineer in the field.
 Station of bridge may be changed from 61+96 to 62+00 for the face of Abut. No. 1 if found advisable by the Engineer in the field.

ESTIMATED QUANTITIES

Item No. 15 Structure Excav.	340 cu yds.
" " 33A - Conc. Class A'	37 "
" " 33C - " " C'	196 "
" " 34 - Reinforcing Steel	11,362 lbs.
" " 67 - Cable Guard Rail	178 L.Ft.
" " 68 - Timber Piling	2300 L.Ft. (to be used only in the field)
" " 55 - Temporary Bridge and mainfaining traffic T-13.	
" " 14 - Channel Excav.	500 cu yds.

INDEX OF SHEETS

SHEET NO. 182 - PLAN & PROFILE
" " 3 - 37' B20 NO. 30 - 15' SKEW
" " 4 - 37' B21 - 15' SKEW - H=12'
" " 5 - S22 Typical Details
" " 6 - S22A "
" " 7 - S22B "
" " 8 - S23 Skew ends
" " 9 - S25 Standard Cable Rail
" " 10 - S26 Special Details
" " 11 - Standard Structures Series S22
" " 12-13 - Cross Sections

REFERENCES

S22 - S202, S204, S220, S221, S206
S22A - S223, S227
S22B - S241
S26 - S269
S28

NOTE: Present Superstructure shall be removed by the Contractor and shall be paid for as Structure Excavation. River Channel below bridge shall be excavated to a depth and width and a distance down stream from the new bridge as directed by the Engineer in the field.

NOTE: Piles will be used if found necessary upon completion of structure excavation and ordered by Engineer in the field.

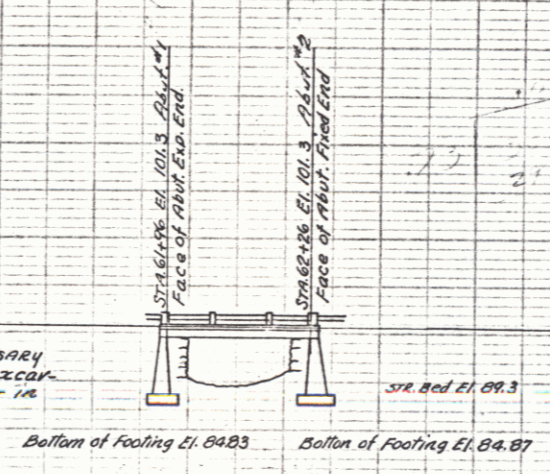

Approved: *H. E. Sargent*
 CHIEF ENGINEER

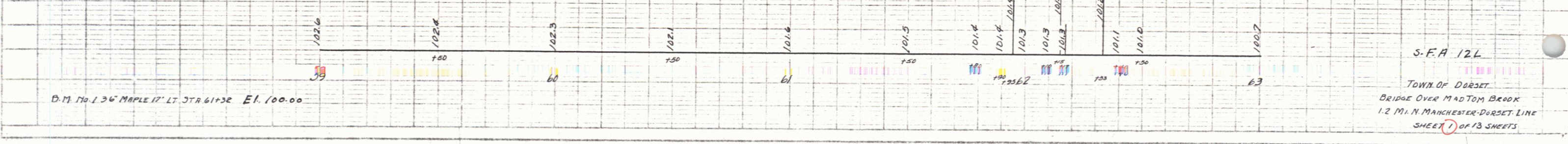

S.F.A. 12L
 TOWN OF DORSET
 BRIDGE OVER MAD TOM BROOK
 1.2 MI. N. MANCHESTER-DORSET LINE
 SHEET 7 OF 13 SHEETS