

GUARD RAIL REQUIRED ON LEFT

Sta 689+88 to Sta 690+12	Length 24 Ft.
693+56 - 693+80	24"
696+88 - 697+12	24"
ON RIGHT	
689+88 to Sta 690+12	24"
693+56 - 693+80	24"
696+88 - 697+12	24"
700+20 - 703+10	328"
TOTAL THIS SHEET	472 Ft.

STONE BASE REQUIRED
Sta. 701+00 to Sta 704+00 Length 300 Ft.

NEW CULVERTS REQUIRED
Sta 689+00 14" Con Iron Pipe 30 Ft
12" Concrete 10 cu yds.
Sta 697+00 18" Con Iron Pipe 26 Ft
12" Concrete 19 cu yds.

CULVERT REPAIRS REQUIRED
Sta 693+60 14" Con Iron Pipe 26 Ft
12" Concrete 10 cu yds.

FED. ROAD DIST. NO.	STATE	FED. AID PERCENT	PROJECT NO.	SHEET NO.	TOTAL SHEETS
8	VT	12	W-10-30	88	133

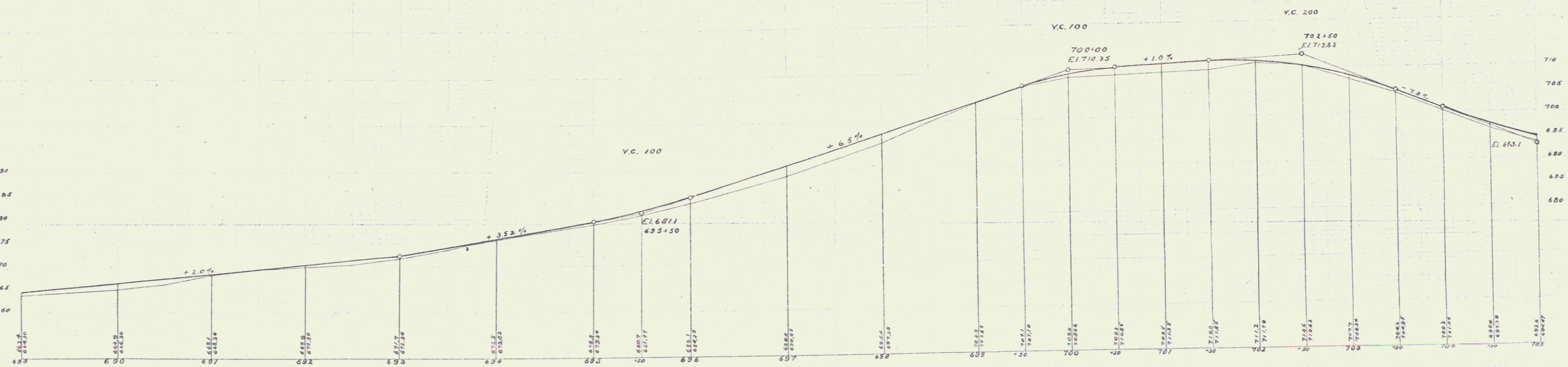
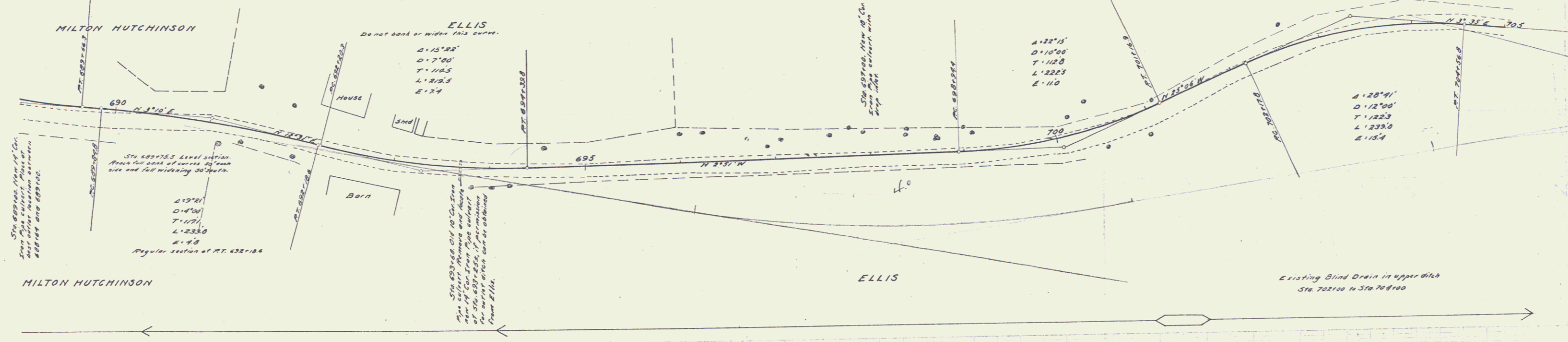

B.X. Spine in Maple right of 694+02, El. 681.34
B.X. Spine in Elm right of 700+00, El. 681.26

Series C. 48