

GUARD RAIL REQUIRED ON LEFT

Sta 580+50 to Sta 580+82 Length 32 ft.
580+50 - 580+52 - 24"
580+52 - 580+54 - 24"
580+54 - 580+56 - 24"
580+56 - 580+58 - 24"
580+58 - 580+60 - 24"
580+60 - 580+62 - 24"
580+62 - 580+64 - 24"
580+64 - 580+66 - 24"
580+66 - 580+68 - 24"
580+68 - 580+70 - 24"
580+70 - 580+72 - 24"
580+72 - 580+74 - 24"
580+74 - 580+76 - 24"
580+76 - 580+78 - 24"
580+78 - 580+80 - 24"
580+80 - 580+82 - 24"
TOTAL THIS SHEET 688 ft.

NEW CULVERTS REQUIRED

Sta 580+20 14" Cor. Iron Pipe 28 ft.
12" Concrete 17 cu yds.

CULVERT REPAIRS REQUIRED

Sta 580+70
12" Concrete 2.8 cu yds.
13" Steel 2.5 "
Steel 60 lbs.

Sta 595+73

12" Concrete 43 cu yds.
13" Steel 76 "
Steel 120 lbs.

FED. ROAD DIST. NO.	STATE	CON. NO.	FISCAL YEAR	SHEET NO.	TOTAL SHEETS
9	VT	12	1924	41	129

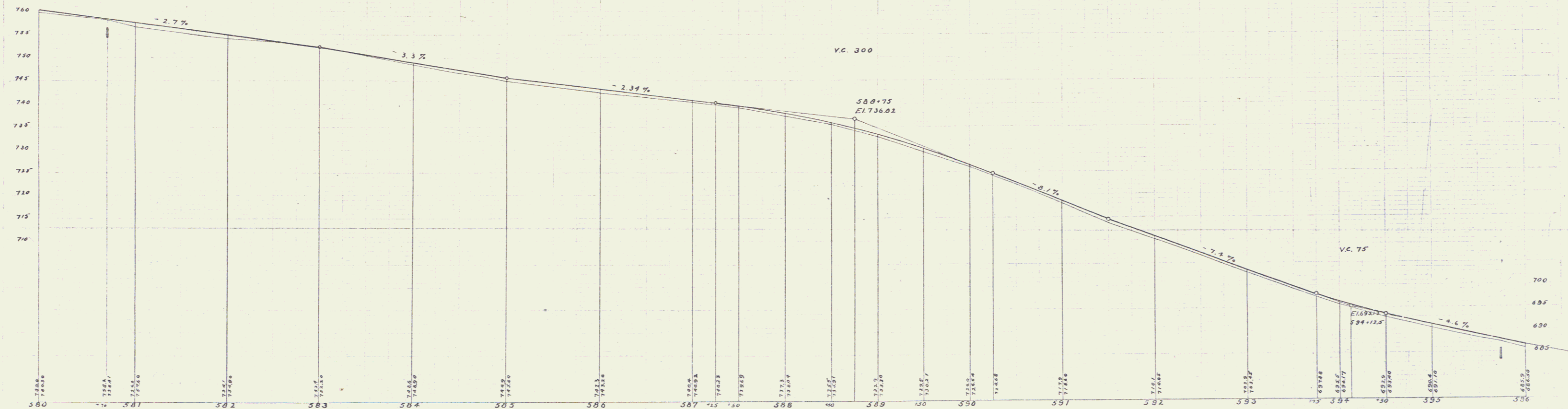
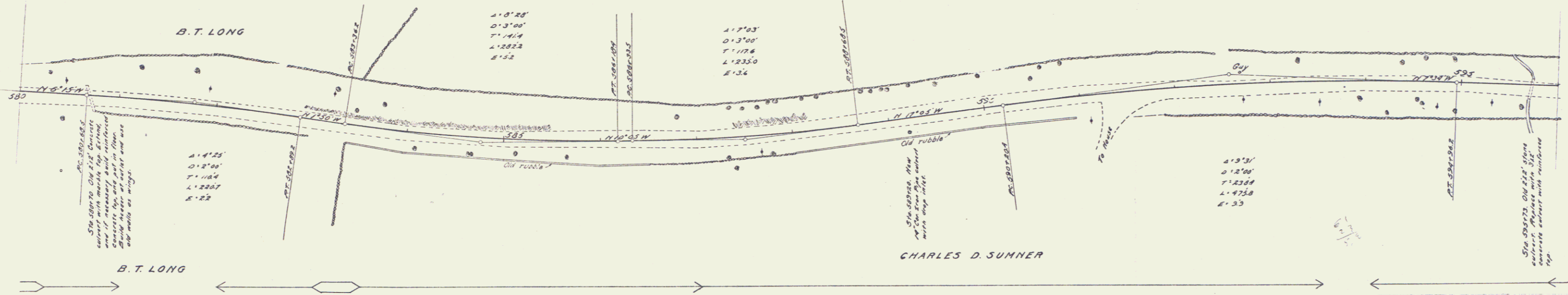

B.M. S.E. corner of Stone Gate Post Lot of 1870±20. Elev. 743.34
 B.M. 3/4 mile to history right of 591+53. Elev. 713.15

Drawn by [Signature] 1/24