

**GUARD RAIL REQUIRED ON LEFT**

Sta 530+82 to Sta 532+34 Length 152 Ft.
532+48 " 534+00 " 152 "
ON RIGHT
530+79 to Sta 532+39 " 160 "
532+53 " 534+00 " 147 "
ON LEFT
521+03 to Sta 521+27 " 24 "
TOTAL THIS SHEET 633 FT.

**CULVERT REPAIRS REQUIRED**

Sta 533+87	12" Concrete	15 cu yds.
	1'-3"	4.1 "
Sta 521+152	14" Cor Iron Pipe	38 Ft.
	12" Concrete	10 cu yds.

FED. ROAD DIST. NO.	STATE	FED. AID PROJ. NO.	FISCAL YEAR	SHEET NO.	TOTAL SHEETS
8	VT.	12	1934	37	133

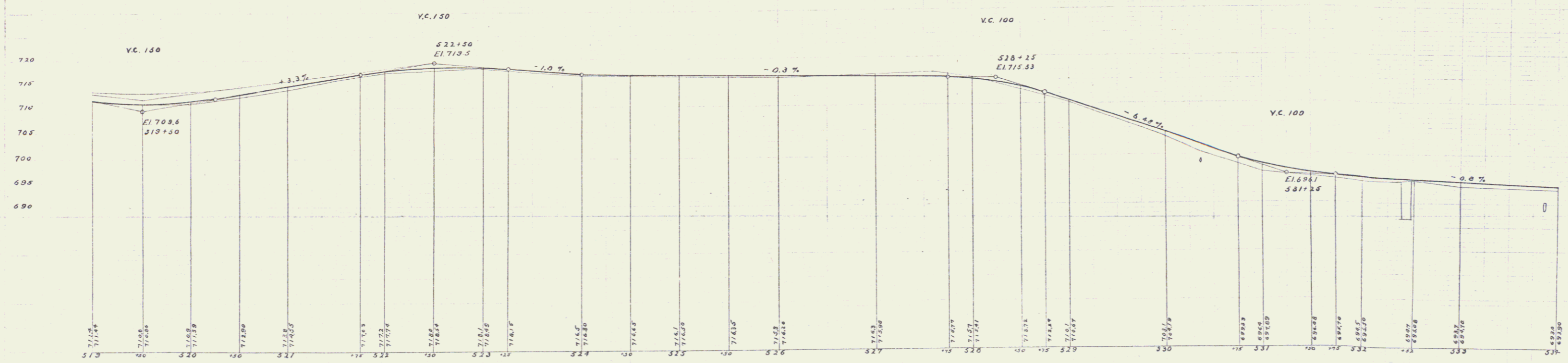
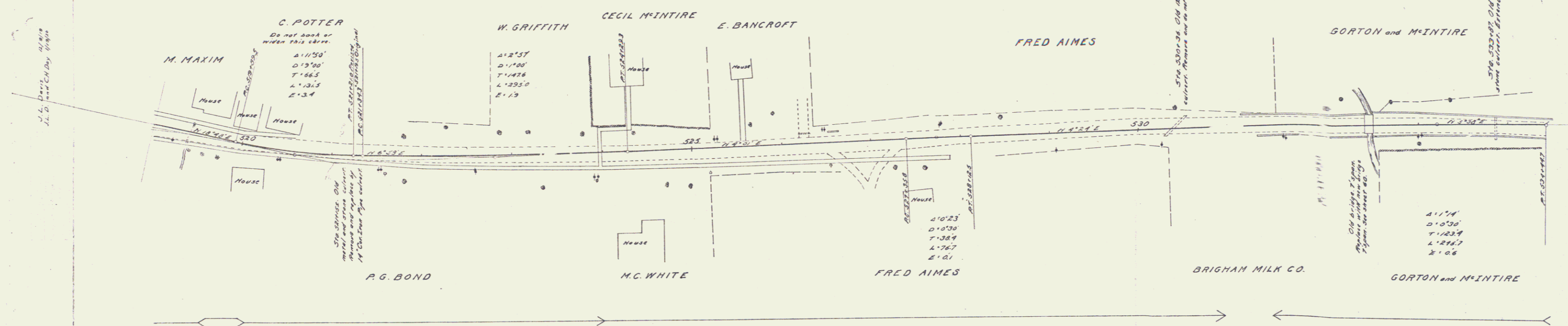

2.75 Stone Bound left of 525+22, Elev 715.00  
 3.75 Stone in Elm left of 531+83, Elev 693.34

36