

EDWARD F. GUNTHER
 PATRICK E. LENIHAN
 PHILIP J. GUNTHER

REMOVAL & DISPOSAL OF PRESENT GUARD RAIL
 LT 544+06-544+73
 RT 536+22-536+70
 544+02-544+82

PRESENT ROW PURCHASED FROM VERMONT MARBLE CO.
 WD 11-27-36 BK 33-PJ 426-DORSET L.R. WPGH 12A 1936
 APP SUR. STA. 529+00-544+00

THREE CABLE GUARD RAIL w/ STEEL POSTS
 Lt. 544+55-544+71
 Rt. 536+22-536+78
 544+55-544+71

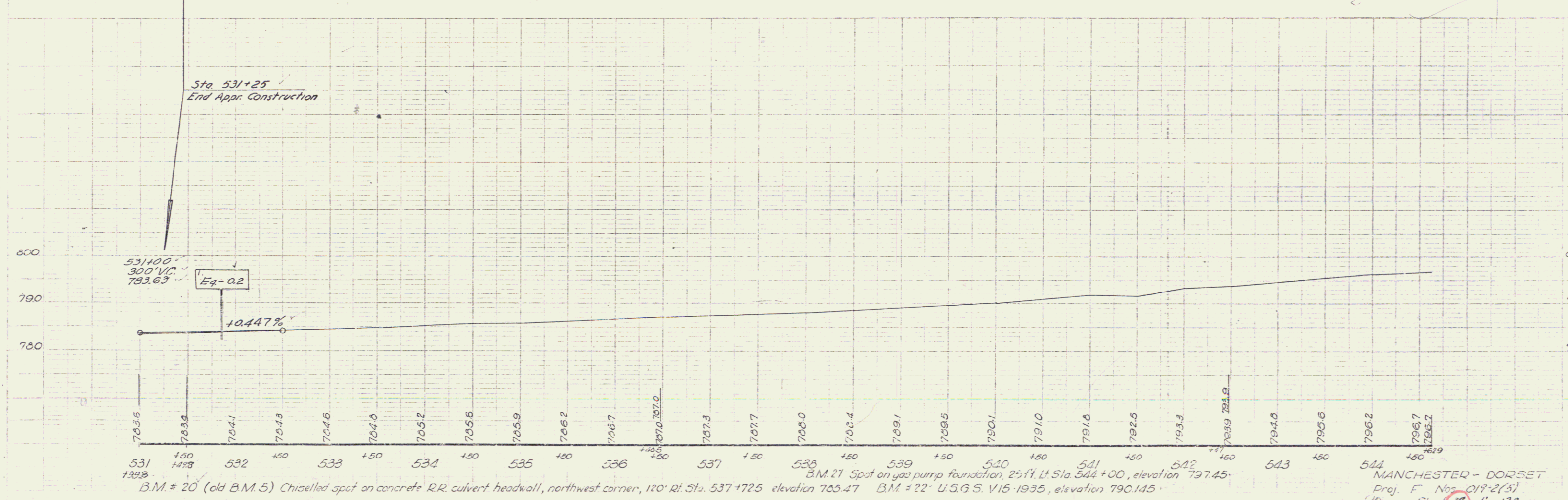
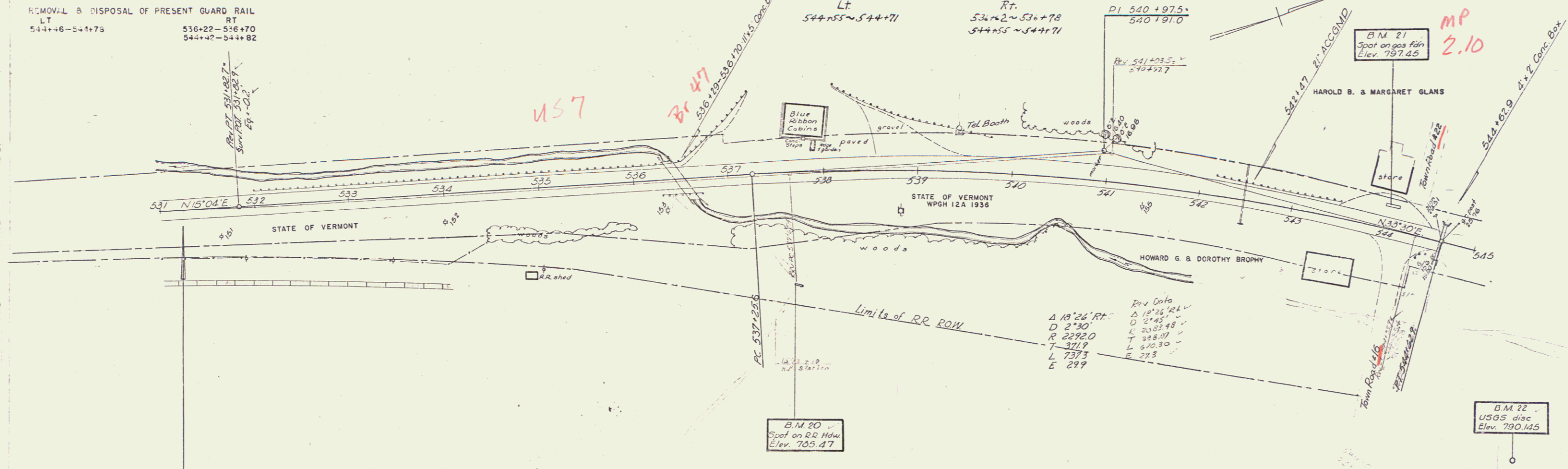

B.M. # 20 (old B.M. 5) Chiselled spot on concrete RR culvert headwall, northwest corner, 120' Rt. Sta. 537+72.5 elevation 703.47
 B.M. # 21 Spot on gas pump foundation, 25' ft. Lt. Sta. 544+00, elevation 797.45
 B.M. # 22 U.S.G.S. V.15-1935, elevation 790.145

MANCHESTER - DORSET
 Proj. F. No. 017-2(3)
 Sheet 17 of 138