

Wires - Cable Guard Rail - w/ Steel Posts
Stations 543 - 544
505+00 - 592+00 - 552+00

BM # 12
S.I.R. 12' Elm
Elev. 670.75

5° 55' L.H.
1°
D 5729.65
T 279.4
L 558.3
E 67
Bank 1/4' per ft

Removal & Disposal of Present Guard Rail
592+00 - 595+37 ft

LEONARD L. BRETON

12' - 10"

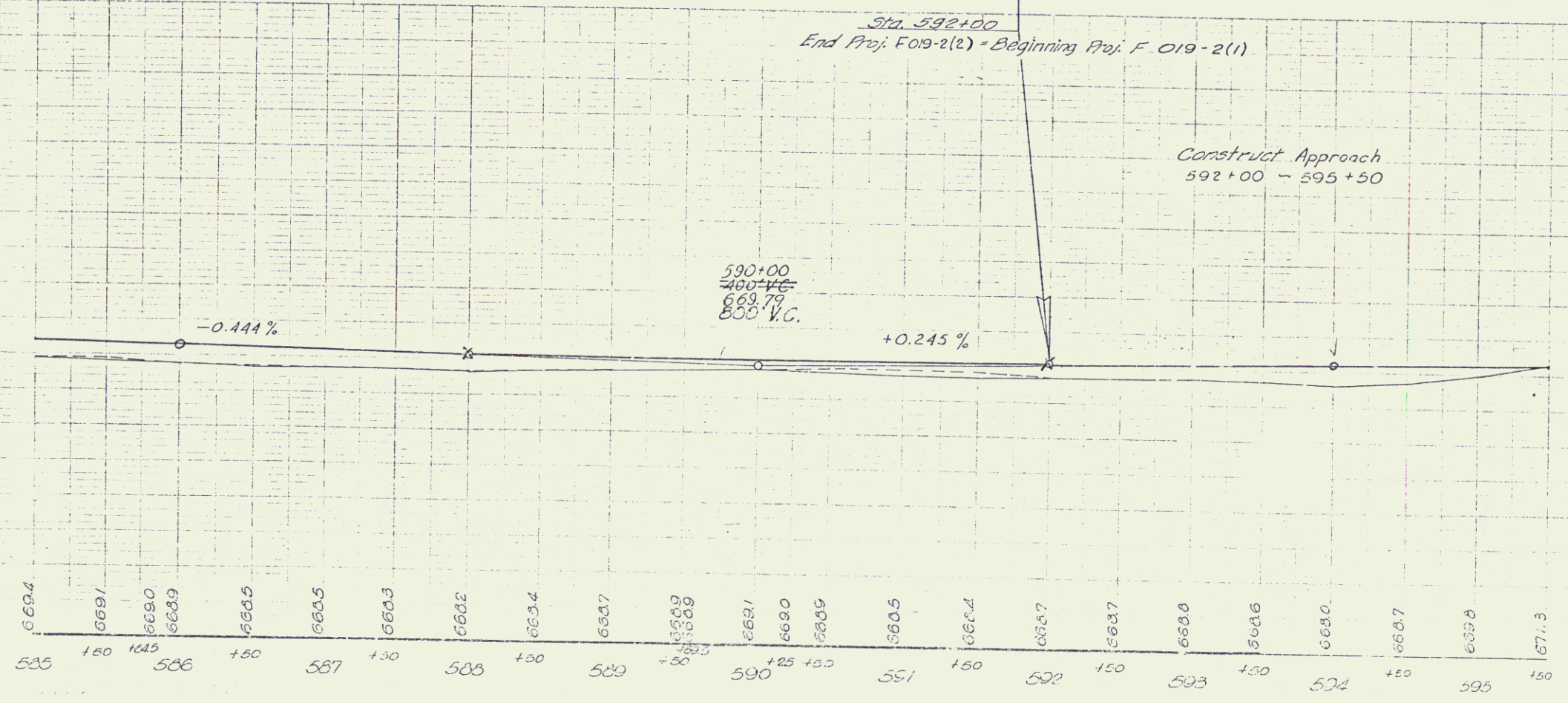
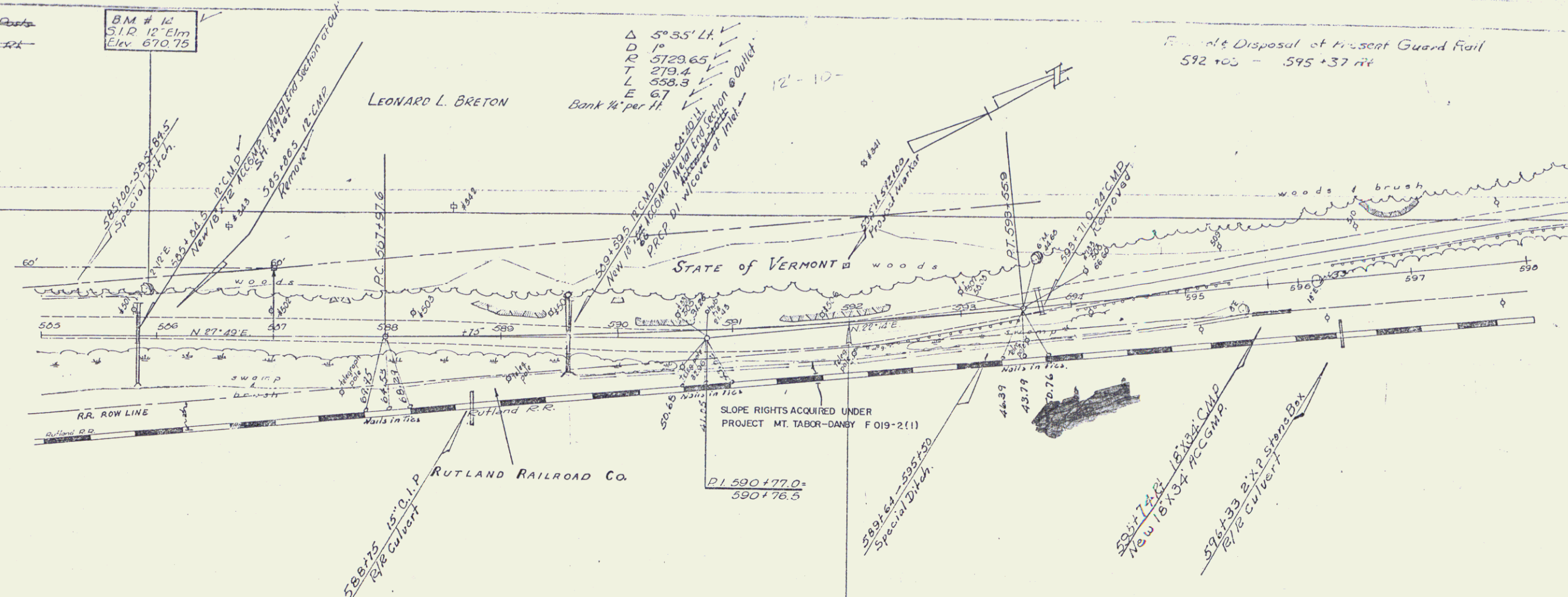

17
e