

SLEEDING, ITEM 611  
 CONN. FERT. ITEM 615  
 TOPSOIL, ITEM 621  
 \*15+00 - \*\*2+00 ISLAND  
 \*18+50 - \*\*20+00 RT.

GRANITE SLOPE EDGING  
 ITEM 556-A  
 \*16+00 - \*\*2+00

DRILLING & PLASTING OF SOLID  
 ROCK SUBGRADE, ITEM 114-MOD.  
 \*25+50 - \*\*14+00

CONSTRUCT PRIVES  
 \*29+22 RT.  
 \*10+76 RT.

THREE CABLE GUARD RAIL WITH  
 STEEL POSTS, ITEM 504  
 \*10+73 - \*\*21+77 RT.

RIPRAP FOR BANK PROTECTION  
 MODIFIED FOR CULVERT ENDS  
 ITEM 526  
 \*20+35 RT. & LT.

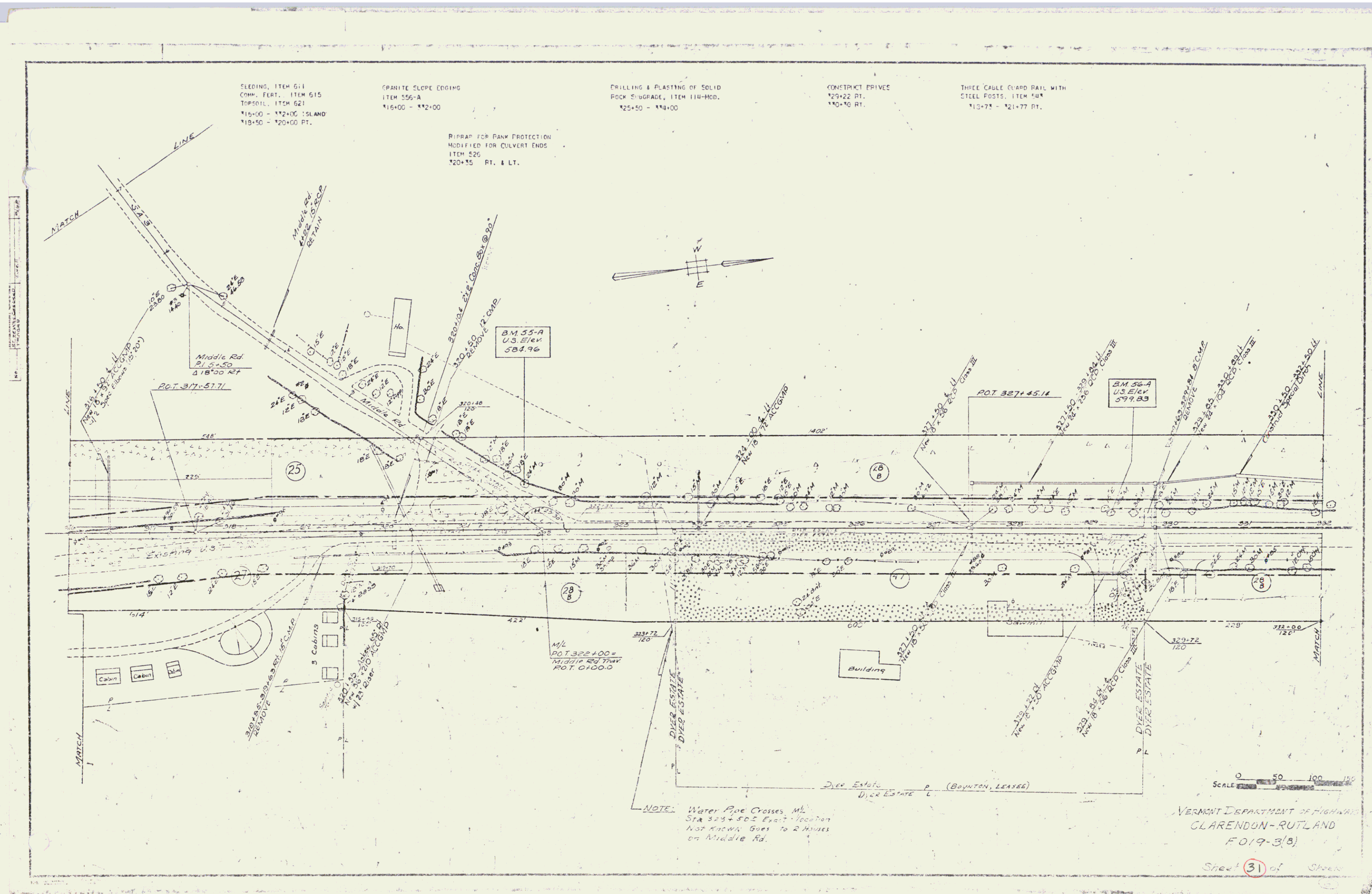

NOTE: Water Pipe Crosses Mt.  
 Sta 29+50.2 East location  
 Not known Goes to 2 Houses  
 on Middle Rd.

VERMONT DEPARTMENT OF HIGHWAYS  
 CLARENDON-RUTLAND  
 FO19-3(8)  
 Sheet 31 of 32