

SLIDING, ITEM 611
CONH. FEPT. FOR GRASSES, ITEM 615
TOPSOIL, ITEM 621
261+62-272+00

THREE CABLE GUARD RAIL W/STEEL POSTS, ITEM 514
267+06 - 272+50 LT.

CONSTRUCT DRIVES
18+50 LT.
20+50 LT.

PROPERTY LINE FENCE W/STEEL POSTS
ITEM 521-E
265+00 - 273+00 LT. & RT.

TREATED TIMBER CURB, ITEM 556
263+00-272+00 LT./

GRANITE SLOPE EDGING, ITEM 556-A
264+53 - 273+00 LT.
264+77 - 273+00 RT.
DRILLING & BLASTING OF SOLID
ROCK SUBGRADE, ITEM 114-A, MOD.
265+50 - 266+50
271+50 - 271+50

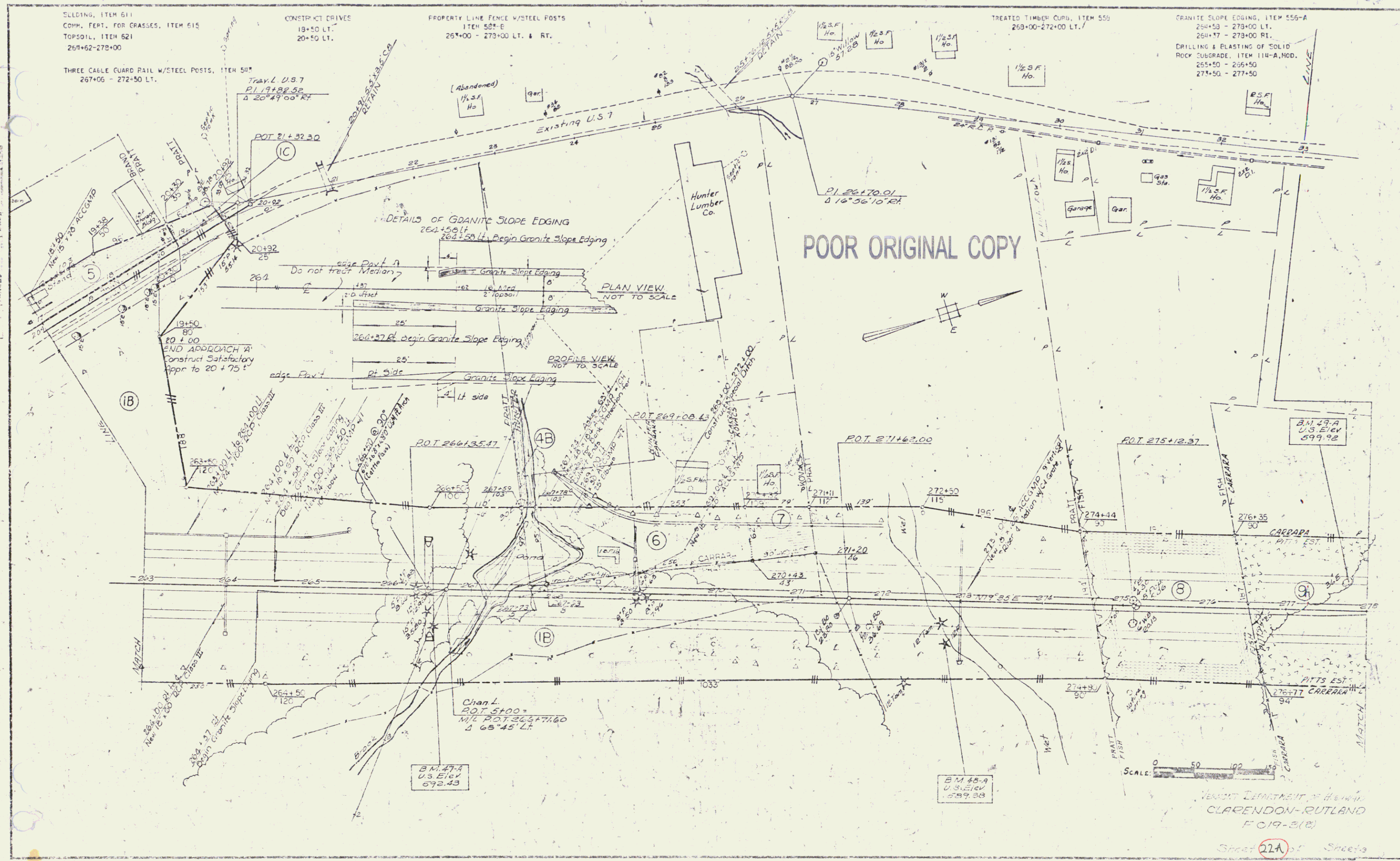

VERMONT DEPARTMENT OF HIGHWAYS
CLARENDON-RUTLAND
F.C.19-3(B)

Sheet 21A of 21A