

INDEX OF SHEETS

1	Title Page
2	Typical Details
3	Quantities/Items
4	Quantities/Grainage
5	Earthworks
6	Right-of-Way Detail
7	Plan and Profile
8	144"x224" O' Cor. Galv. Met. Pipe Details, Sta. 218+50 to 219+00 Lt.
9	Sign and delineator Location Sheet
10	Sign and Delineator Summary Sheet
11	Guide Signs-Design and Detail Sheet
12	Overlays Plywood Sign Assembly and Construction Details
13	Blank
14	Drilling and Blasting of solid Rock-Subgrade
15	4-1 Boring Logs
16	8-5 Slope Grading
17	8-8 Mass Construction
18	8-10 Elevation on a Slope
19	8-11 Slope Stabilization
20	8-12 General Gravel
21	BLANK
22	8-13 Estimate Terminal
23	8-14 Storage Lanes
24	8-15 Curb, Granite Stone Edging
25	8-16 Curb, Concrete Concrete
26	8-17 Curb, Rubble Masonry
27	8-18 Gutters and Jute Netting
28	8-19 Flushing Basins
29	8-20 Drive Inlets
30	8-21 Inlet Drains
31	8-22 Catch Basins
32	8-23 Gully Drop Inlets
33	8-24 4" Dia. Cor. Galv. Met. Pipe Vertical Riser
34	8-25 Barricades, Signs and Lights
35	8-26 U. S. Route Markers
36	8-27 State Route Markers and Auxiliary Markers
37	8-28 4" x 4" Regulatory Signs
38	8-29 8" x 10" Regulatory Signs
39	8-30 8" x 10" Regulatory Signs
40	8-31 Standard Sign Placement
41	8-32 Indicators, Hazard Markers and Stop Signs
42	8-33 Concrete Mounted Sign Support
43	8-34 Posts and Connections Identification Signs
44	8-35 4" x 4" Posts
45	8-36 4" x 4" Posts
46	8-37 4" x 4" Posts
47	8-38 4" x 4" Posts
48	8-39 4" x 4" Posts
49	8-40 4" x 4" Posts
50	8-41 Project and Boundary Markers
51	8-42 Property Line Fence
52	8-43 Steel Beam Guard Rail
53	8-44 Overhead Sign Support Detail Sheet
54	Blank
55	Cross Sections/Retaining
56	Cross Sections/Approach
57	Cross Sections/Culverts
58	Cross Sections/Culvert End at 218+00

STATE OF VERMONT
DEPARTMENT OF HIGHWAYS
PROPOSED IMPROVEMENT

TOWN OF CLARENDON
COUNTY OF RUTLAND
U.S.7-RUTLAND-BENNINGTON ROAD

BEGINNING AT A POINT 2.347 MILES SOUTH OF CLARENDON-RUTLAND TOWN LINE AND EXTENDING NORTHERLY 1.392 MILES.
LENGTH OF ROADWAY 7,350.0 FEET = 1.392 MILES
LENGTH OF PROJECT 7,350.0 FEET = 1.392 MILES

A.D.T. 1986	6400
A.D.T. 1986	10,300
D.H.V. 1986	1,370
D	60%
T	6%
V	60 MPH.

Pin# 99R499

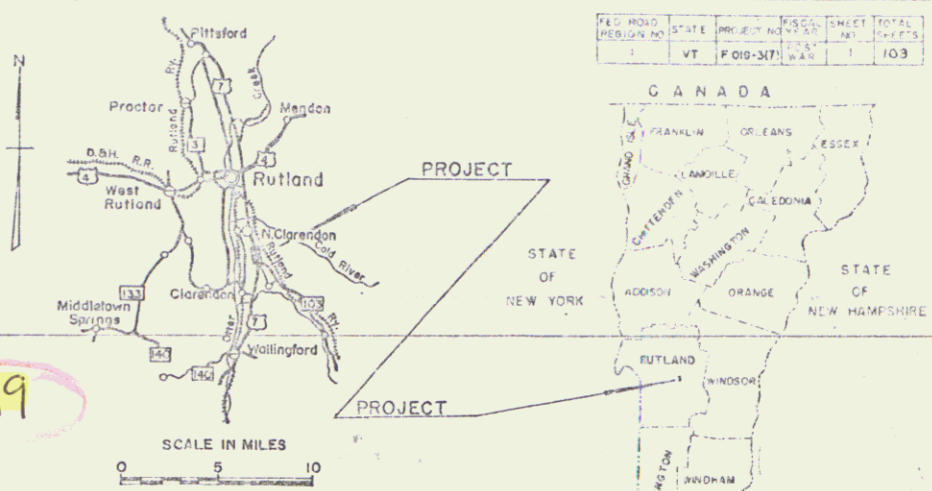

PROJECT NAME & NUMBER TYPE AREA
CLARENDON F 019-3(7) BIT. CONC. PAVT. 19,600 S.Y.
RECORD PLANS MATERIALS

SUBBASE GRAVEL & 0-4 CRUSHED GRAVEL - GAMMA PVT., CLARENDON, VT.
CRUSHED GRAVEL OR STONE PLANT MIXED BASE COURSE - VERMONT PAVING, INC., WALLINGFORD, VT.
GRAVEL - GAMMA - CLAYTON BROWNE PVT., N. CLARENDON, VT.
ASPHALT - HUBBARD - GIL & BROWN CO., EVERETT, MASS.
BITUMINOUS CONCRETE - THE PAVING, INC., WALLINGFORD, VT.
CONCRETE - G. L. & S. B. STONE BRICKS - CLARENDON, VT.
REINFORCING STEEL - BETHLEHEM STEEL CORP.
METAL CULVERT PIPE - NEW ENGLAND METAL CULVERT CO., WHITE RIVER JCT., VT.
PNEUMATIC CONCRETE PIPE - THE PIPE CORP., WALLINGFORD, VT.
CAL. TR. & B. ST. L. LEBLANC TOWNERY CO., DORCHESTER, MASS.
HIGHWAY LINE FENCE - GRANITE BLOCK EDGING & TRAFFIC SIGNS - NATIONAL FENCE & GRANITE CO., INC., CONCORD, N.H.
TRIPLE RAIL & STANDARD STEEL BEAM STANDARD STEEL RAIL & MARKER POSTS - S.T. SHAWWELLY & CO., ESSEX, Vt.

OVERHEAD TRAFFIC SIGN SUPPORT - UNION METAL MFG. CO., CANTON, OHIO
FLARED TIMBER CURB - CLARK BROAD RAIL, 1100 CANTON ST., NEW ENGLAND FENCE & WOOD TREATING CO., MELROSBURG, N.H.
CONTRACTOR - COOK-ROSS, INC. CONTRACT -
DORRINGTON, CO. DATED - 6/11/66
R.S. ENR - WILSON SANBORN STARTED - 8/16/66
REVISIONS - JAMES B. DAVIS & T.N. RUMNEY COMPLETED - 11/23/67
RECORD PLANS - A.S.S. & P.W. APPROVED - 11/23/67

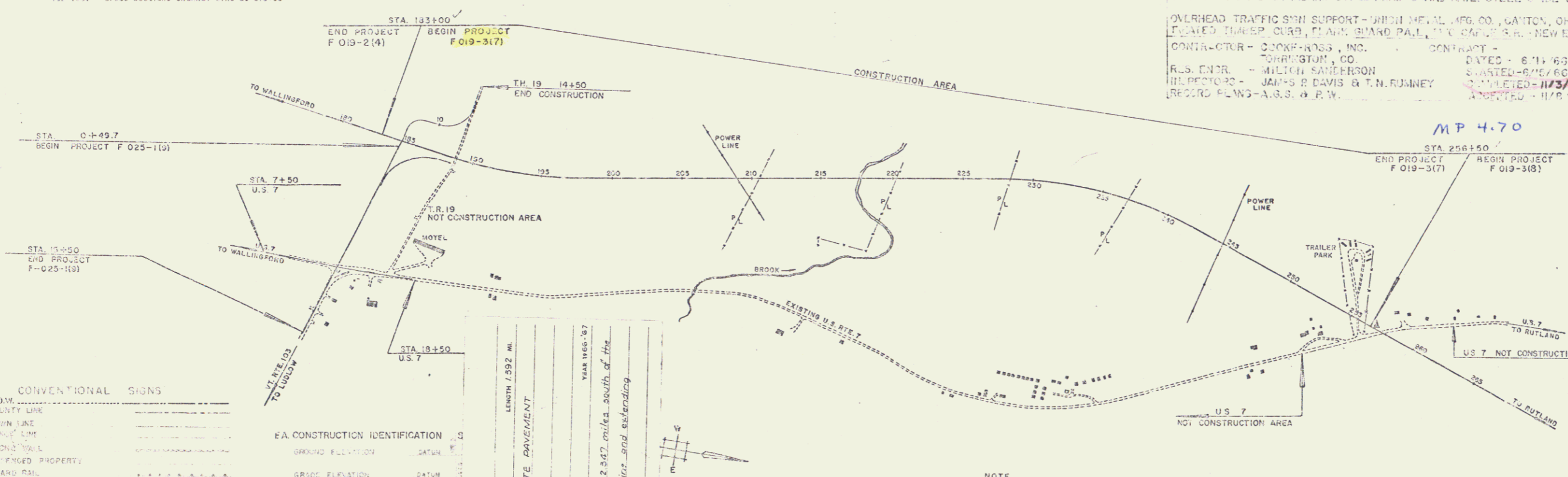

RIGHT-OF-WAY DIVISION
TOWN FILE
PERPETUAL
Town of U.S.7 LIA
(To Be Returned To R.O.W. Division)

CONVENTIONAL SIGNS

R.O.W.	County Line
1	Town Line
2	State Line
3	Unimproved Property
4	Shaded Rail
5	Travelled by Railroad
6	Retaining Wall
7	Center Line
8	Survey Line
9	Culvert
10	Water Pond
11	Water Fall
12	Water Mill
13	Telephone Pole
14	Wire
15	Blow Signal

FA CONSTRUCTION IDENTIFICATION

1	GROUND ELEVATION	DATA
2	GRID ELEVATION	DATA
3	CURVE DATA	REFLECTION OF ANGLE
4	REFLECTION OF ANGLE	SCENE OF CURVE
5	SCENE OF CURVE	RADIUS OF CURVE
6	RADIUS OF CURVE	TANGENT DISTANCE
7	TANGENT DISTANCE	LENGTH OF CURVE
8	LENGTH OF CURVE	EXTERNAL DISTANCE
9	EXTERNAL DISTANCE	POINT OF INTERSECTION
10	POINT OF INTERSECTION	POINT OF CURVE
11	POINT OF CURVE	POINT OF TANGENT
12	POINT OF TANGENT	POINT ON SUBTANGENT

SCALE IN FEET
400 800 1200

NOTE:
FOR ROW DETAILS, SEE P.O.W. PLANS FOR THIS PROJECT

THERE SHALL BE NO SUCH REVISIONS AS MAY BE REQUIRED BY THE BUREAU OF PUBLIC ROADS OR THE COMMISSIONER OF HIGHWAYS.

CONTRACTOR IS TO BE BOUND BY THESE PLANS AND THE STANDARD SPECIFICATIONS FOR HIGHWAY AND BRIDGE CONSTRUCTION DATED APRIL, 1954, AS APPROVED BY THE BUREAU OF PUBLIC ROADS ON OCT. 12, 1954, INCLUDING ALL SUBSEQUENT APPROVED REVISIONS AND SUCH REVISED SPECIFICATIONS AND SPECIAL PROVISIONS AS ARE INCORPORATED IN THESE PLANS.

DEPARTMENT OF HIGHWAYS
BUREAU OF PUBLIC ROADS

PROJECT F 019-3(7)
SHEET 103

DATE 12/23/63
DATE 11/21/63
DATE 11/21/63
DATE 11/21/63
DATE 11/21/63

Key: ADT 1986 - (000)
 DIV 1986 000
 Traffic Turning Movement
 at intersection of
 New U.S. 7 & New Vt. Rte 103
 Sta 184+64.1

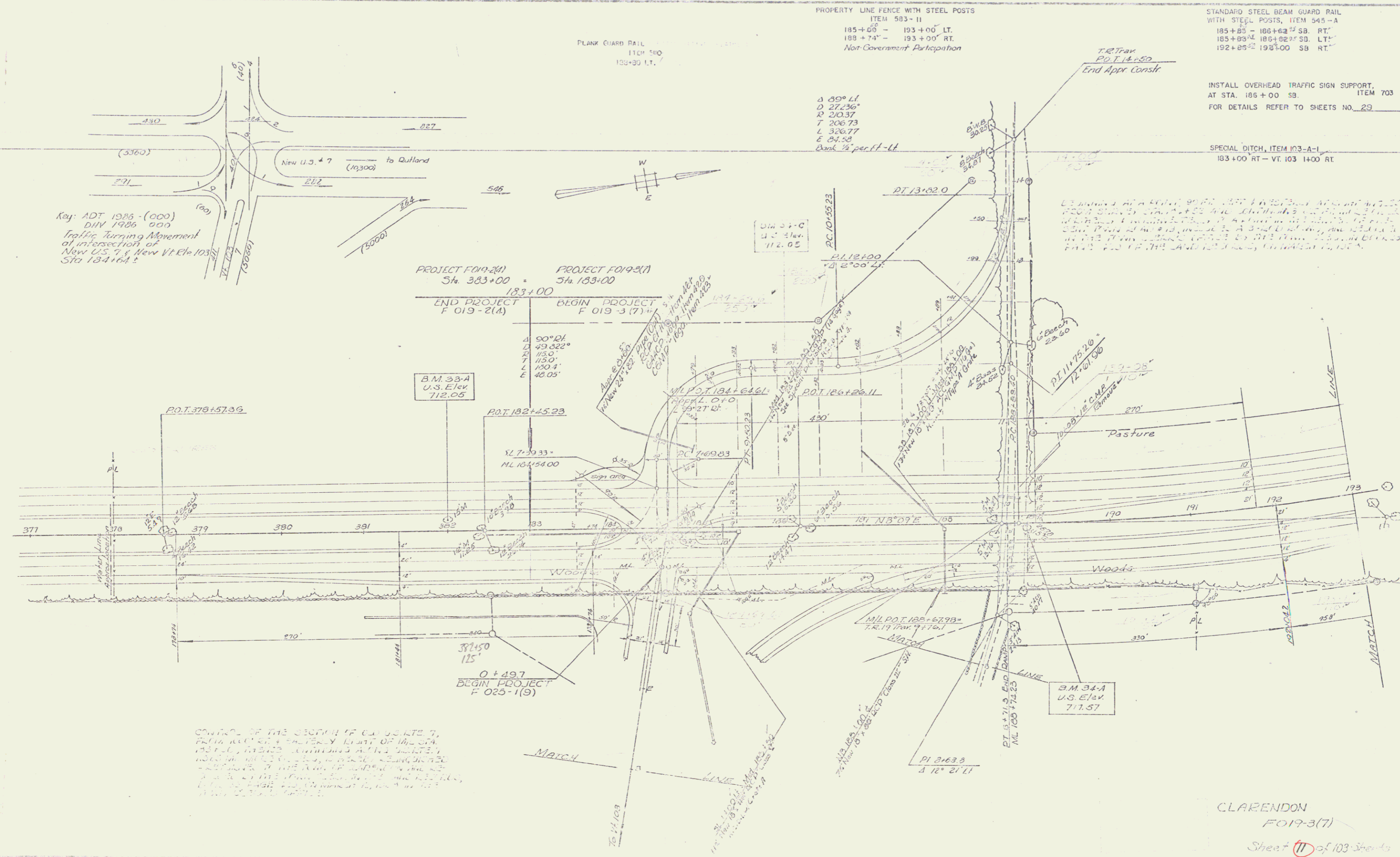

PROPERTY LINE FENCE WITH STEEL POSTS
 ITEM 593 - II
 185+05' - 193+00' LT.
 188+74' - 193+00' RT.
 Non-Government Participation

STANDARD STEEL BEAM GUARD RAIL
 WITH STEEL POSTS, ITEM 545 - A
 185+05' - 186+62' SB. RT.
 185+03' - 186+62' SB. LT.
 192+05' - 193+00' SB. RT.

INSTALL OVERHEAD TRAFFIC SIGN SUPPORT,
 AT STA. 186+00 SB. ITEM 703
 FOR DETAILS REFER TO SHEETS NO. 29

SPECIAL DITCH, ITEM 103-A-1
 183+00 RT - Vt. 103 14+00 RT

PROJECT FO19-2(A)
 Sta. 383+00 - 183+00
 END PROJECT F 019-2(A)

PROJECT FO19-3(A)
 Sta. 183+00 - 183+00
 BEGIN PROJECT F 019-3(7)

B.M. 33-A
 U.S. Elev
 712.05

B.M. 34-A
 U.S. Elev
 717.57

CONTRACTOR OF THIS SECTION OF CLARENDEON, VT.,
 FROM THE STATE OF VERMONT, COUNTY OF CLARENDEON,
 HAS BEEN ADVISED THAT THE STATE OF VERMONT
 HAS A CLAIM TO THE LAND SHOWN ON THIS PLAN
 AND THAT THE STATE OF VERMONT IS THE
 OWNER OF THE LAND SHOWN ON THIS PLAN.
 THE CONTRACTOR IS ADVISED THAT THE STATE
 OF VERMONT IS THE OWNER OF THE LAND
 SHOWN ON THIS PLAN AND THAT THE STATE
 OF VERMONT IS THE OWNER OF THE LAND
 SHOWN ON THIS PLAN.

CLARENDEON
 FO19-3(7)
 Sheet 11 of 103 Sheets

SUB-BASE OF SAND, ITEM 202
 NB 193+00-197+50
 NB 205+00-208+00
 SB 205+00-208+00

PROPERTY LINE FENCE WITH STEEL POSTS, ITEM 583 II MOD.
 193+00' - 196+94" LT
 197+06" - 207+74" LT
 207+78" - 208+00" LT
 193+00" - 196+94" RT
 197+06" - 208+00" RT
 Non-Government Participation

DRIVE GATE FOR PROPERTY LINE FENCE, 583 V
 197+00" LT
 207+800 LT
 197+00" RT
 Non-Government Participation

JUTE MATTING, ITEM 623
 197+00 - 199+00 MED.
 201+00 - 203+00 MED.
 205+50 - 207+00 MED.

CONSTRUCT DRIVE
 197+00 RT 8 LT
 207+20 LT
 EDW Bid Item
 Non-Government Participation

STANDARD STEEL BEAM GUARD RAIL
 WITH STEEL POSTS, ITEM 545-A
 193+00 - 193+65 SB RT
 194+35 - 195+14 NB RT
 198+06 - 198+85 SB LT

Curve Data
 Δ 17°45' LT
 D 2°00'
 R 2864.79'
 T 441.36'
 L 897.50'
 E 36.72'
 Bank 9/16" in 12'

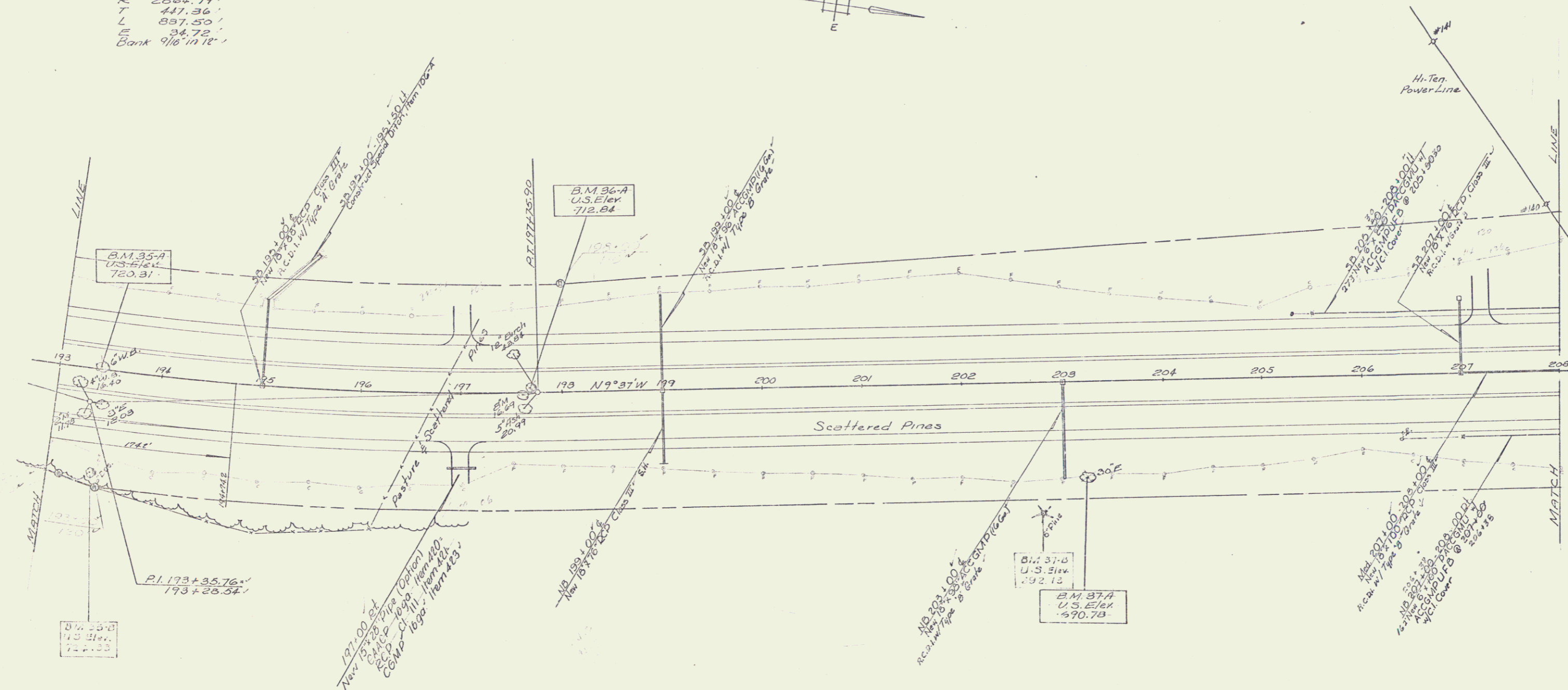
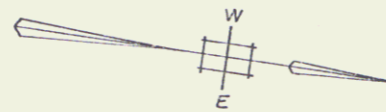

CLARENDON
 FO/9-3(7)
 Sheet 13 of 103 Sheets

JUTE MATTING, ITEM 623
 209+00 - 211+00 MED.
 212+50 - 214+00 MED.
 218+50 - 222+50 RT.

STONE FILL, FOR SLOPE PROTECTION (LIGHT TYPE)
 ITEM 512
 NB 216+50-217+55 RT.
 NB 217+35-218+50 RT.
 SB 216+40-219+15 LT.

THREE CABLE GUARD RAIL WITH STEEL POSTS
 ITEM 542
 SB 217+00-221+50 LT.
 NB 215+50-220+00 RT.
 SB 217+50

TREATED TIMBER CURB
 ITEM 553
 SB 217+00-221+50 LT.
 NB 217+00-221+50 RT.
 SB 216+50-219+50

SUB-BASE OF SAND, ITEM 202
 NB 208+00-215+00
 SB 208+00-218+00

PROPERTY LINE FENCE WITH STEEL POSTS
 ITEM 583 II MOD.
 208+00 - 219+20 LT.
 219+35 - 224+00 LT.
 208+00 - 209+44 RT.
 209+55 - 211+94 RT.
 212+06 - 217+70 RT. 223+88 RT.
 217+80 - 222+94 RT.
 223+06 - 224+00 RT.

DRIVE GATE FOR PROPERTY LINE FENCE
 ITEM 583 V
 209+50 RT.
 212+00 RT.
 223+00 RT.

CONSTRUCT DRIVE
 209+50 RT.
 212+00 RT.
 223+00 RT.
 EDW Bid Item

STANDARD STEEL BEAM GUARD RAIL WITH STEEL POSTS, ITEM 585-A
 210+70-211+55 SB LT.

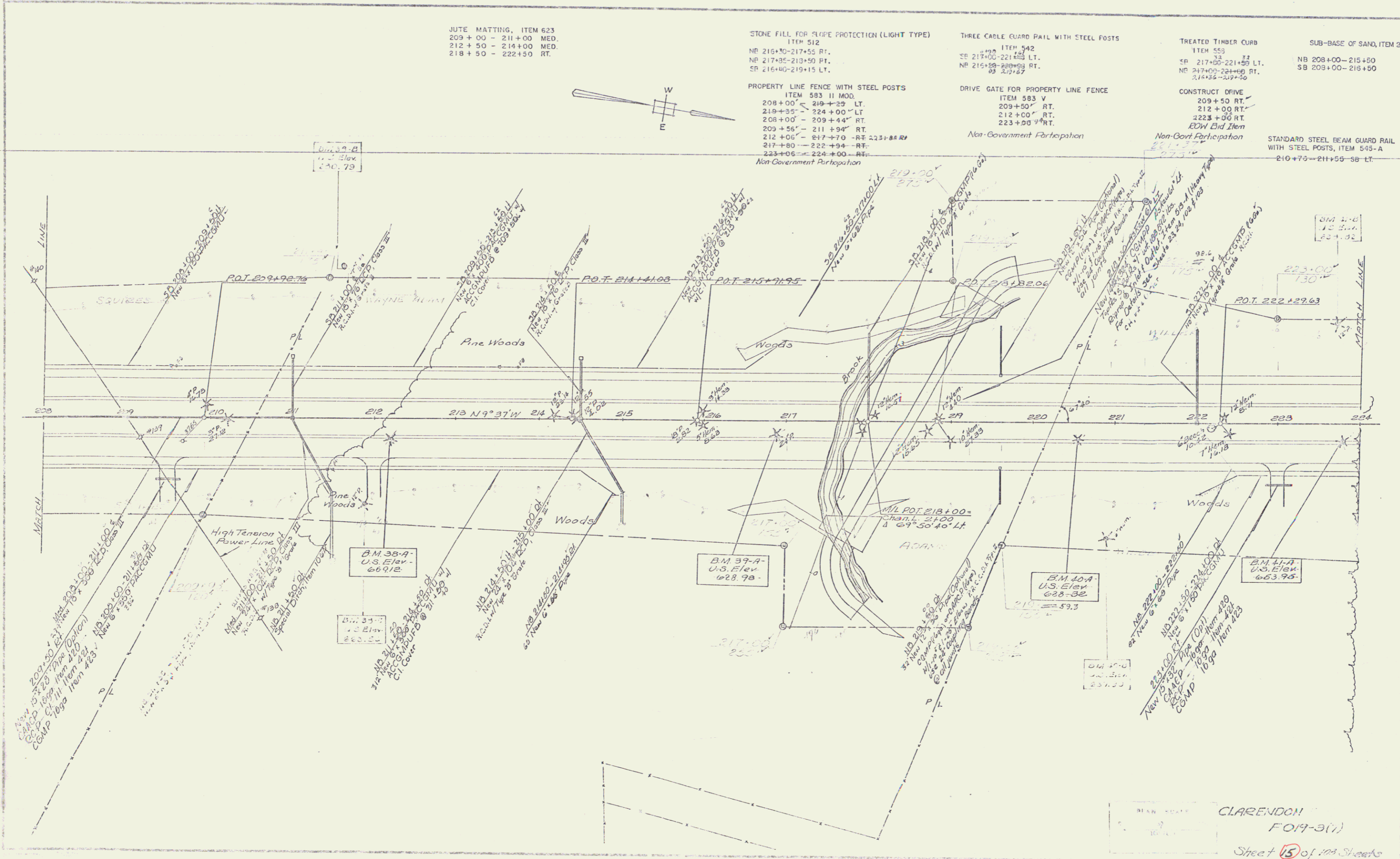
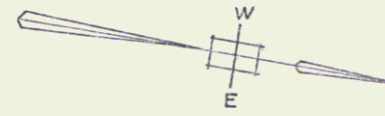

MATCH

MATCH LINE

LINE

LINE

CLARENDON
 FO19-3(1)
 Sheet 15 of 104 Sheets

THREE CABLE QUARD RAIL W/STEEL POSTS
ITEM 542
SP. 227+00-237+00 LT.

JUTE MATTING, ITEM 623
226 + 00 - 228 + 00 MED.
237 + 50 - 238 + 00 MED.

PROPERTY LINE FENCE WITH STEEL POSTS
ITEM 583 II MOD.
224 + 00' - 239 + 00' LT.
224 + 00' - 233 + 94' RT.
234 + 06' - 239 + 00' RT.
Non-Government Participation

DRIVE GATE FOR PROPERTY LINE FENCE
ITEM 583 V
234 + 00' RT.
Non-Government Participation

CONSTRUCT DRIVE
234 + 00' RT.
EDW Bid Item
Non-Government Participation

SUB-BASE OF SAND, ITEM 202
NB 227 + 50 - 234 + 50
SB 227 + 50 - 229 + 50
NB 238 + 50 - 239 + 00

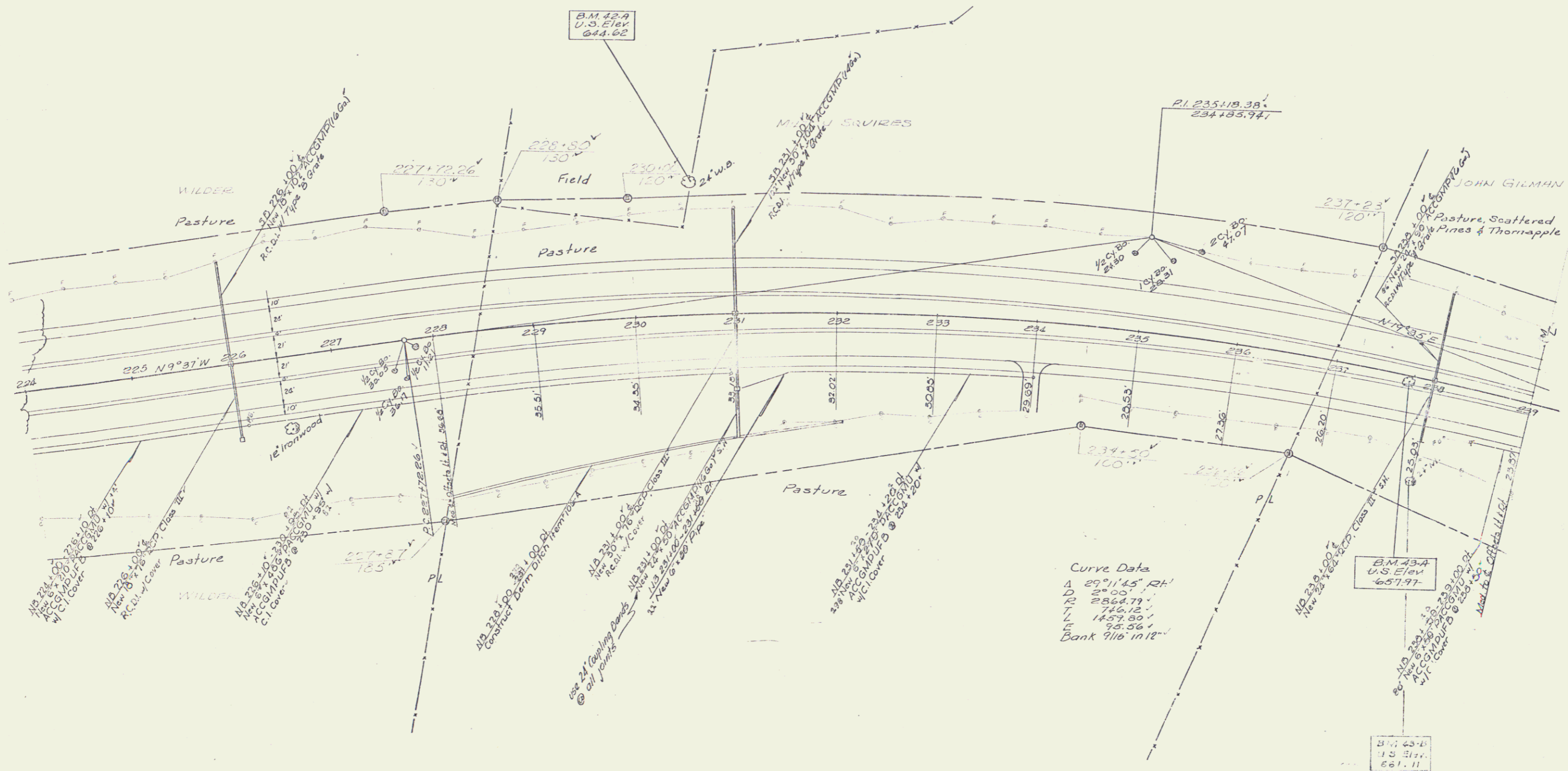
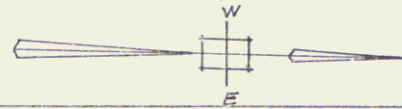

CLARENDON
FO19-3(7)
Sheet 17 of 103 Sheets

5

GRAVEL SLOPE EDGING - ITEM 556-A
279+74.34 TO 254+00 LT. & RT.

THREE CABLE GUARD RAIL W/STEEL POSTS
ITEM 542
SB 250+00 - 251+00 LT.
NB 249+94 - 252+50 RT.

BITUMINOUS CONCRETE SURFACE FOR
CUTTERS & TRAFFIC ISLANDS, ITEM 554
243+50 MED.

JUTE MATTING, ITEM 623.
242+50 - 243+50 MED.
244+50 - 246+00 MED.
249+00 - 251+50 RT.

PROPERTY LINE FENCE WITH STEEL POSTS
ITEM 583-11 MGD.
239+00 - 242+94 LT.
243+05 - 258+90 LT.
239+00 - 240+94 RT.
240+96 - 253+00 RT.
Non-Government Participation

STANDARD STEEL BEAM GUARD RAIL WITH STEEL POSTS, ITEM 545-A
NB 244+55 - 245+14 RT.
NB 253+35 - 254+00 LT.
SB 249+75 - 253+02 LT.

DRIVE GATE FOR PROPERTY LINE FENCE
ITEM 583 V
243+00 LT.
240+50 RT.
Non-Government Participation

CONSTRUCT DRIVE
243+00 LT.
240+50 RT.
253+00 RT. (Non-Govt. Part.)
Non-Government Participation
ECW Bid Item

SUB-BASE OF SAND, ITEM 202
NB 239+00 - 249+00
SB 239+50 - 249+00

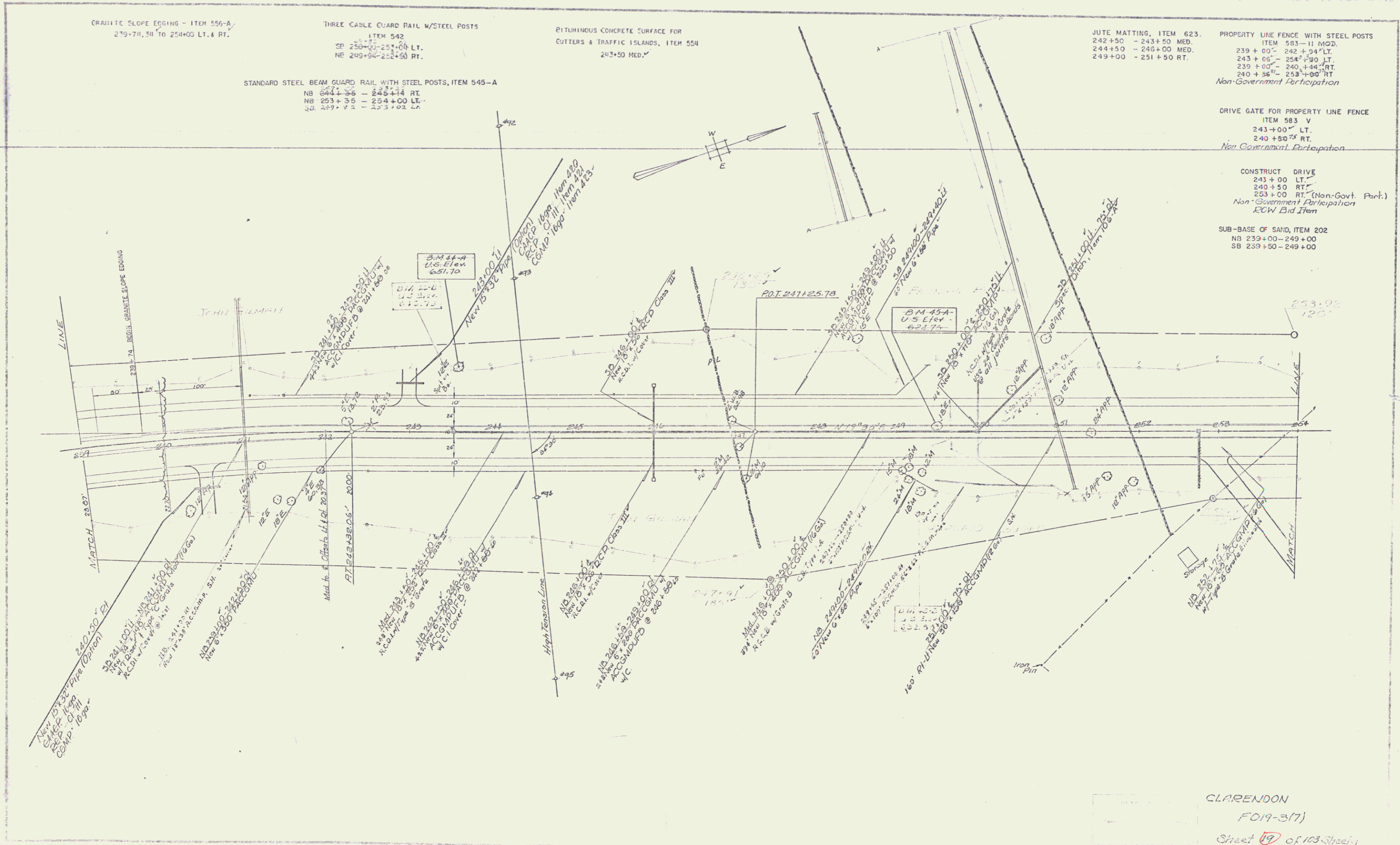

CLARENDON
FO19-3(7)
Sheet 19 of 103 Sheets

PROPERTY LINE FENCE WITH STEEL POSTS
ITEM 583 11 MOD.
254+00 - 256+60 LT.
Non-Government Participation

GRANITE SLOPE EDGING
ITEM 556-A
254+00-256+50

Bituminous Concrete Surface for
Gutters and Traffic Islands
via 286+30

For Record Plans 254-256+60 of 218 of
Project Starbuck-Ruffen AR 019-12(6)
STANDARD STEEL BEAM GUARD RAIL
WITH STEEL POSTS, ITEM 545-A
NB 254+00-254+14 RT

254+00
APRIL 1988

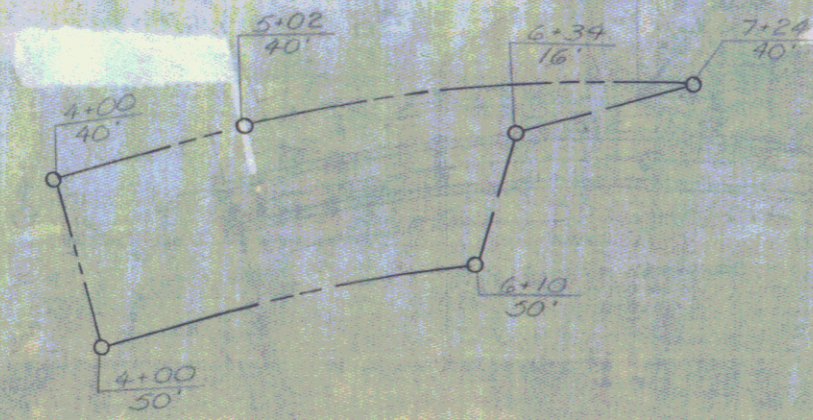

Q/M 46-01
U.S. Elev.
611.16

with Type B g.p.s.

254+48
54'

255+71
85'

256+10
127'

(21) 171
103