

SUB-BASE OF SAND, ITEM 202
 NB 193+00-197+50
 NB 205+00-208+00
 SB 205+00-208+00

PROPERTY LINE FENCE WITH STEEL POSTS, ITEM 583 II MOD.
 193+00' - 196+94" LT
 197+06" - 207+74" LT
 207+78" - 208+00" LT
 193+00" - 196+94" RT
 197+06" - 208+00" RT
 Non-Government Participation

DRIVE GATE FOR PROPERTY LINE FENCE, 583 V
 197+00" LT
 207+800 LT
 197+00" RT
 Non-Government Participation

JUTE MATTING, ITEM 623
 197+00 - 199+00 MED.
 201+00 - 203+00 MED.
 205+50 - 207+00 MED.

CONSTRUCT DRIVE
 197+00 RT 8 LT
 207+20 LT
 EOW Bid Item
 Non-Government Participation

STANDARD STEEL BEAM GUARD RAIL
 WITH STEEL POSTS, ITEM 545-A
 193+00 - 193+65 SB RT
 194+35 - 195+14 NB RT
 198+06 - 198+85 SB LT

Curve Data
 Δ 17°45' LT
 D 2°00' V
 R 2864.79'
 T 441.36'
 L 897.50'
 E 36.72'
 Bank 9/16" in 12'

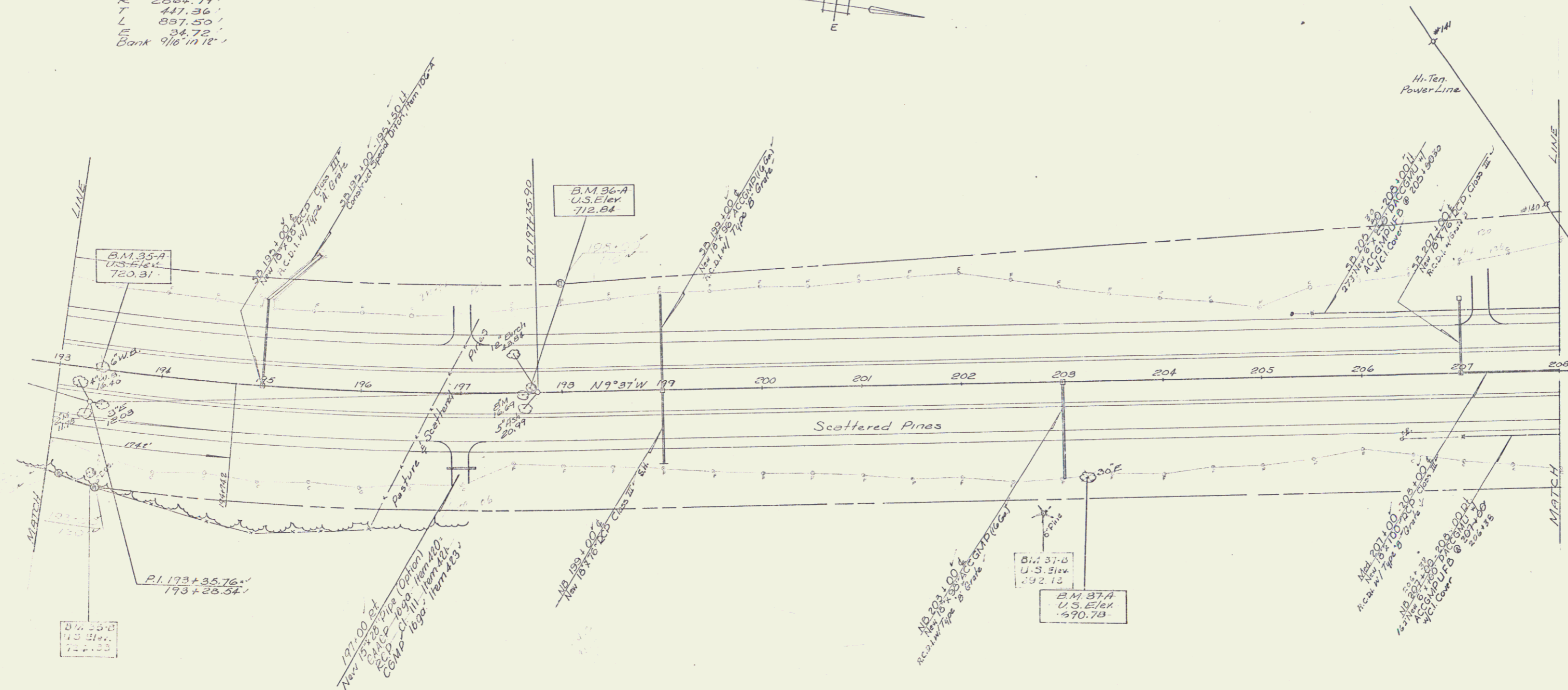
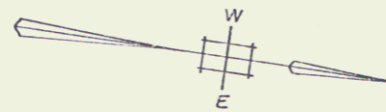

CLARENDON
 FO/9-3(7)
 Sheet 13 of 103 Sheets