

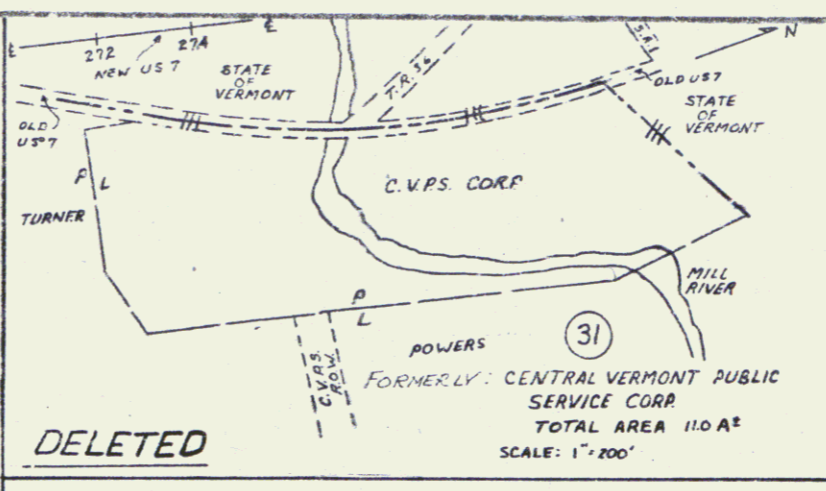

29  
 RUSSELL F. POWERS  
 TOTAL AREA 249.0A±

SCALE: 1" = 400'



DELETED

31  
 C.V.P.S. CORP.  
 FORMERLY: CENTRAL VERMONT PUBLIC SERVICE CORP.  
 TOTAL AREA 110 A±  
 SCALE: 1" = 200'

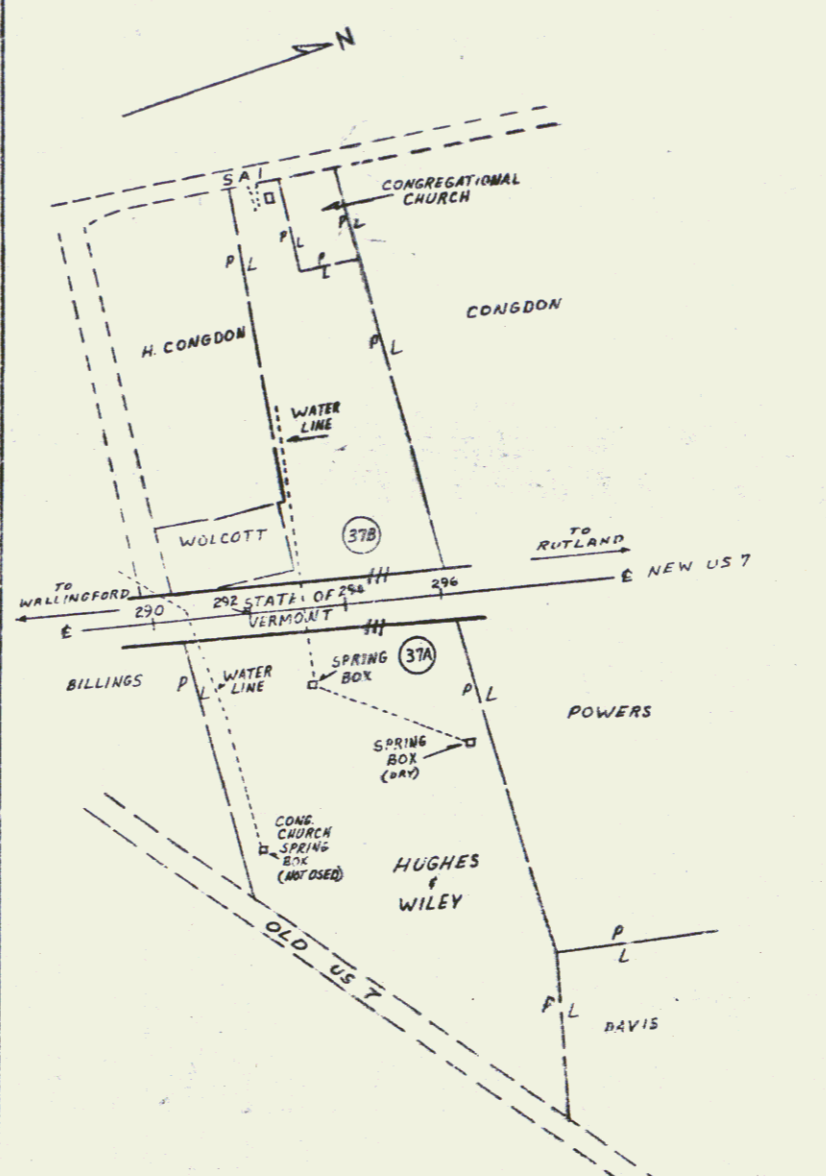

37  
 ELIZABETH R. HUGHES  
 &  
 CELIA R. (WILEY) SMITH  
 TOTAL AREA 16.0A±

SCALE: 1" = 200'

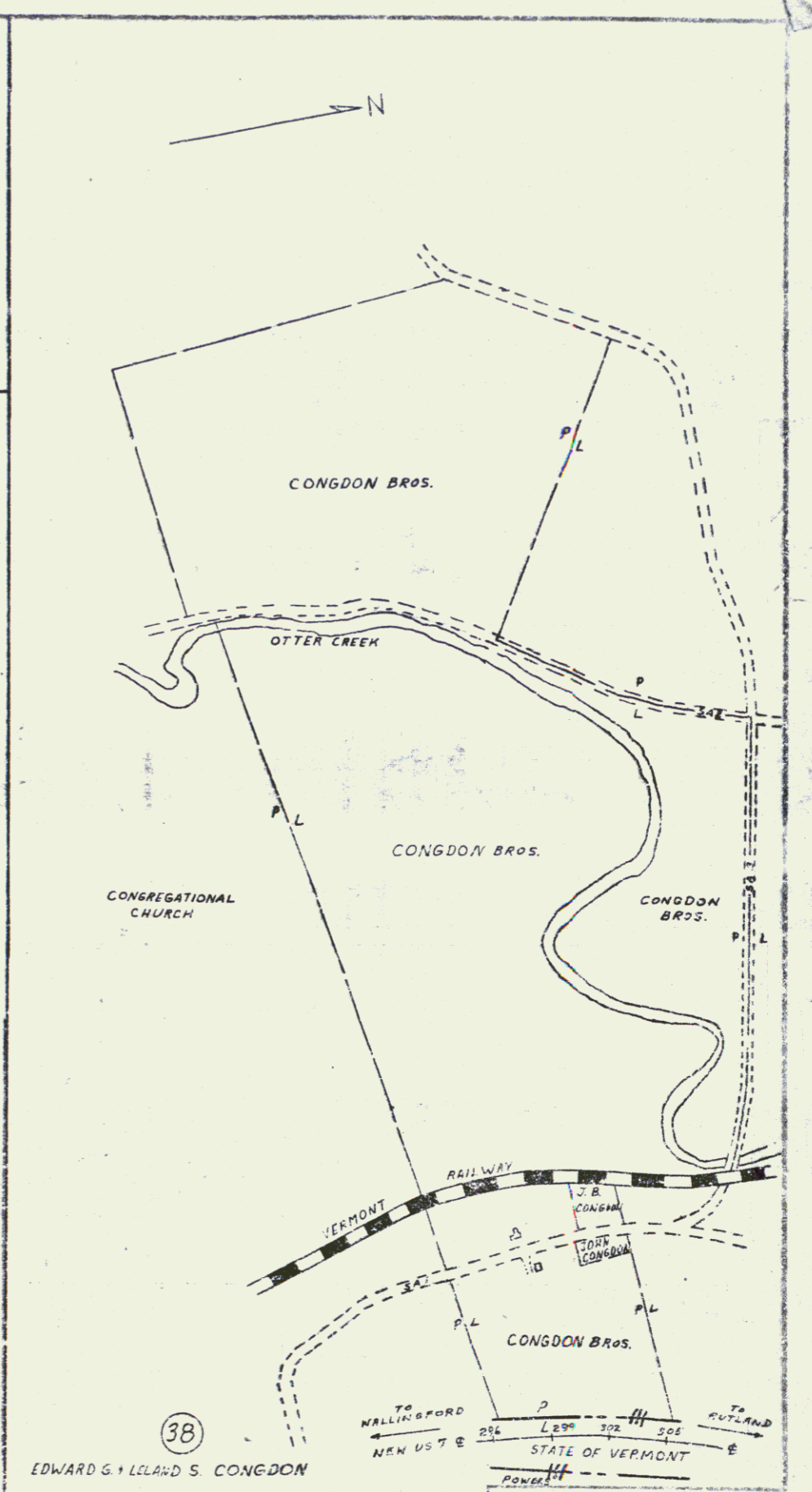

38  
 EDWARD G. & LELAND S. CONGDON  
 TOTAL AREA 243.0A±

SCALE: 1" = 400'

|                       |      |
|-----------------------|------|
| SURVEYED BY           | DATE |
| DRAWN BY              | DATE |
| TRACED BY             | DATE |
| WALLINGFORD-CLARENDON |      |
| APD19-2(50)           |      |
| 73 of 78              |      |