

SEEDING, ITEM 611  
 COMM. FERT., ITEM 615  
 TOPSOIL, ITEM 621  
 \*16+00 - \*12+00 ISLAND  
 \*18+50 - \*20+00 PT.

GRANITE SLOPE EDGING  
 ITEM 556-A  
 \*16+00 - \*12+00

DRILLING & FLASTING OF SOLID  
 ROCK SUBGRADE, ITEM 114-MOD.  
 \*12+50 - \*14+00

CONSTRUCT DRIVES  
 \*29+22 RT.  
 \*10+30 RT.

THREE CABLE GUARD RAIL WITH  
 STEEL POSTS, ITEM 50\*  
 \*13+73 - \*21+77 RT.

PIPAP FOR BANK PROTECTION  
 MODIFIED FOR CULVERT ENDS  
 ITEM 526  
 \*20+35 RT. & LT.

NOTE FROM PLANNING CHECKED BY FIELD NO. 11/2/8

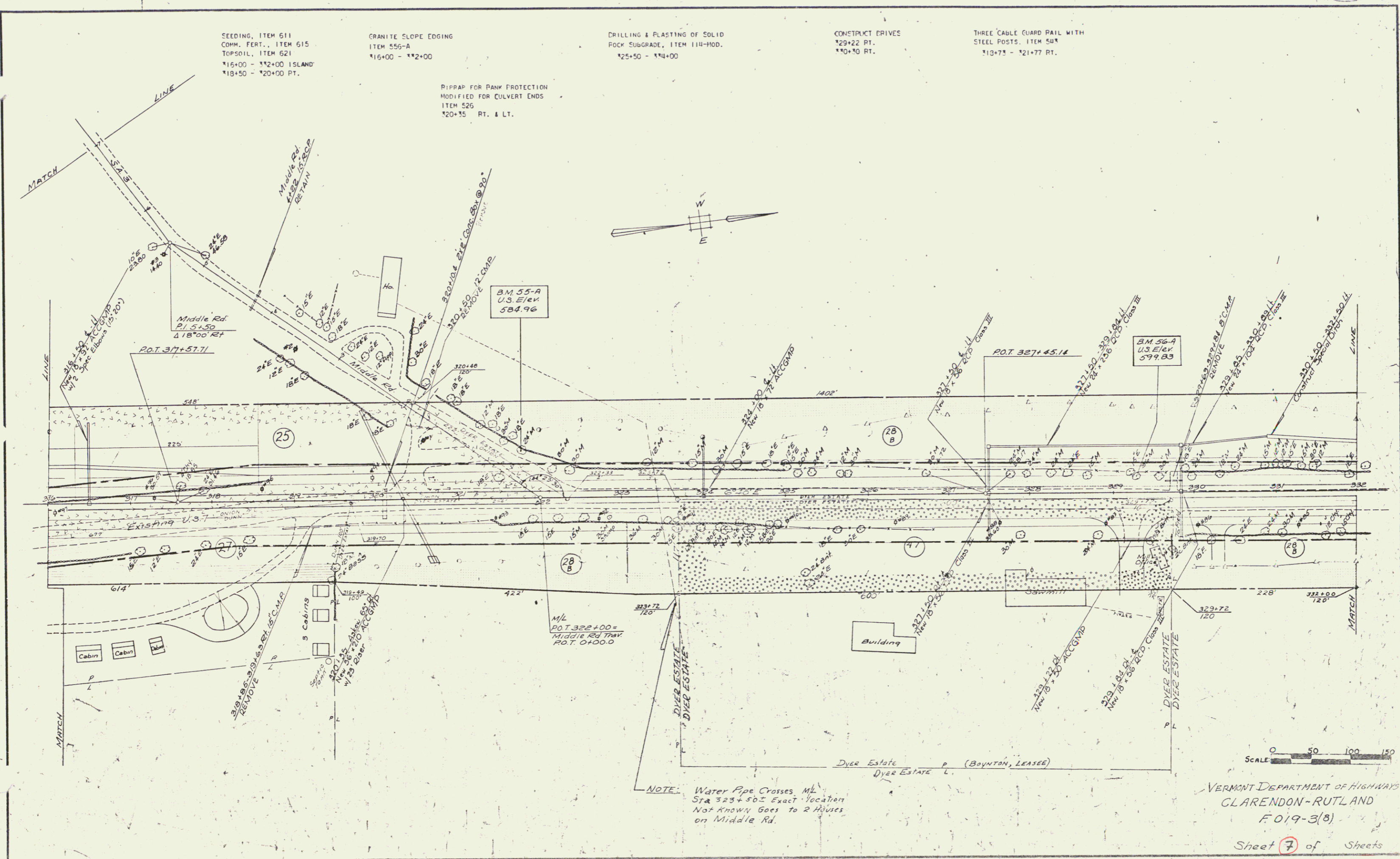

NOTE: Water Pipe Crosses ML  
 Sta 23+50. Exact location  
 Not known. Goes to 2 Houses  
 on Middle Rd.

VERMONT DEPARTMENT OF HIGHWAYS  
 CLARENDON-RUTLAND  
 F 019-3(B)  
 Sheet 7 of Sheets

FEB 25 1966 9