

STANDARD STEEL BEAM
GUARD RAIL w/ STEEL POSTS
163+00 - 163+32.2'

THREE CABLE GUARD RAIL
w/ STEEL POSTS
161+50 - 163+90 Lt
166+00 - 172+08 Lt
167+50 - 172+14 Lt.

CHARLES J.
RUTH R. TARBELL

BITUMINOUS CONCRETE
CURB Item.
167+50 - 172+08 Lt
170+00 - 172+08 Lt.

REMOVAL & DISPOSAL OF
PRESENT GUARD RAIL
ITEM 550
161+50 - 163+40 Lt
169+50 - 171+25 Lt

CONSTRUCT DRIVE
162+10 Lt

CONSTRUCT APPROACH
163+85 Lt
164+50 Lt

EXCAV & REMOVAL OF ROAD
SURFACE ON ROADWAY
ITEM 118A
166+50 Lt - 172+00 Lt

PLANK GUARD RAIL
ITEM 541-A
170+00 Lt
(Barricade)

ALUMINUM CHECKED
DATE: 1/25/80
BY: [Signature]

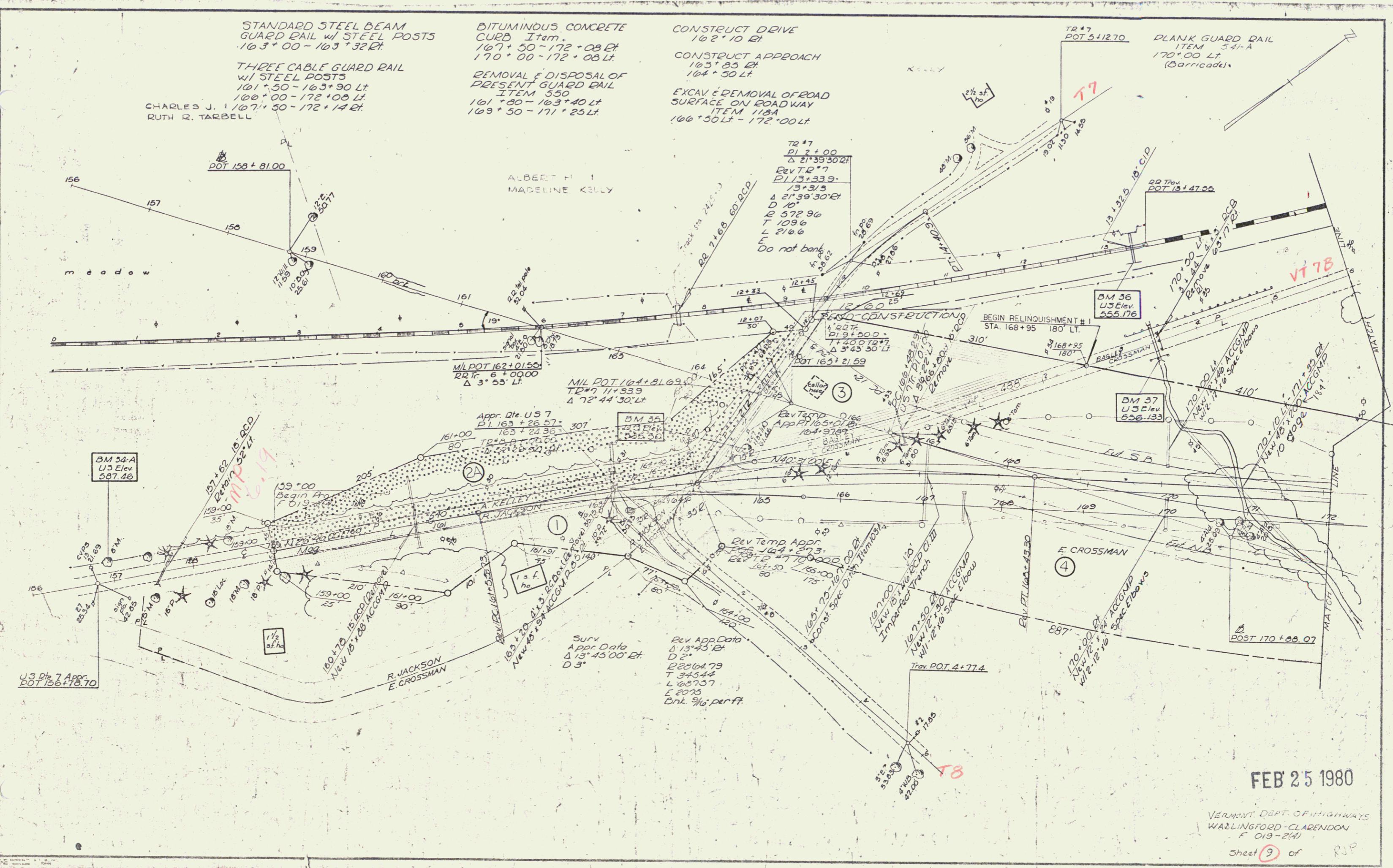

FEB 25 1980

VERMONT DEPT. OF HIGHWAYS
WALLINGFORD-CLARENDON
F 019-241
Sheet 9 of 10