

STATION	STATION	LT	RT	ANC	STATION	INLET	GR. TO	GR. TO	GR. TO
965+01	966+34	253'			973+70	34	26'	60'	29'
965+81	966+05		224'		973+00	34	24'	36'	10'
970+69	978+00	731'		2					
970+14	978+00		786'	2					
TOTAL		964'	1010'	4					

Bank 1/2" Per Foot
Widen 2' on Inside.
CURVE #2
A 68' 11" LT
D 3'
Y 16.8
X 43.1
Z 140

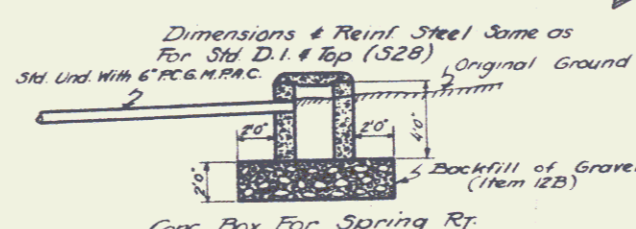

PARCEL	INSTRUMENT	DATE	GRANTOR	GRANTEE	RECORDED	REMARKS
A-B	N.O.	1-8-37	AULDAM J. HOPKINS	JANNEY	25 336	2-9-37

OVERPASS DATA	
TYPE	PROPOSED
SPANS	I-BEAM
CLEAR HEIGHT ABOVE TOP RAIL	19' 4"
LENGTH - OVERALL	232'
ROADWAY WIDTH	22'

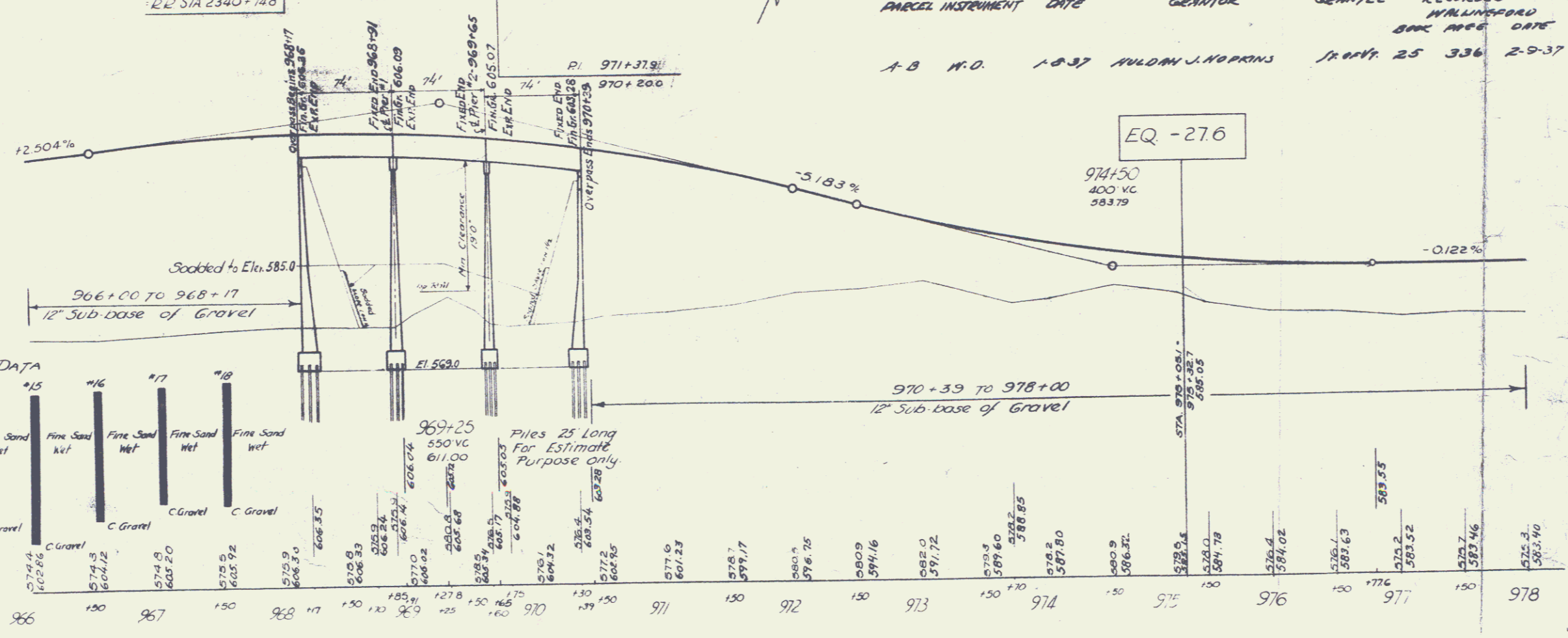
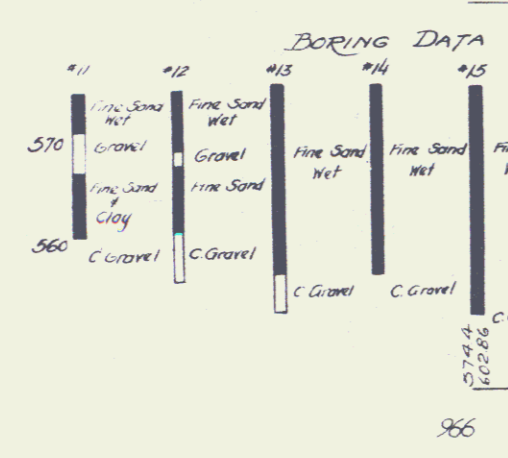

Series N'PGH
Sheet 5
156
48
3