

MM 0400 - MM 0410

PARCEL 1 0.09 A±  
SLOPE RIGHT (P)  
STA. 935+95 RT. — STA. 937+86 RT.

PARCEL 2 SLOPE RIGHT (P) 0.22 A±  
STA. 932+04 LT. — STA. 937+60 LT.  
CULVERT RIGHT (T) STA. 935+06 RT.  
CHANNEL (T) STA. 935+06 RT.

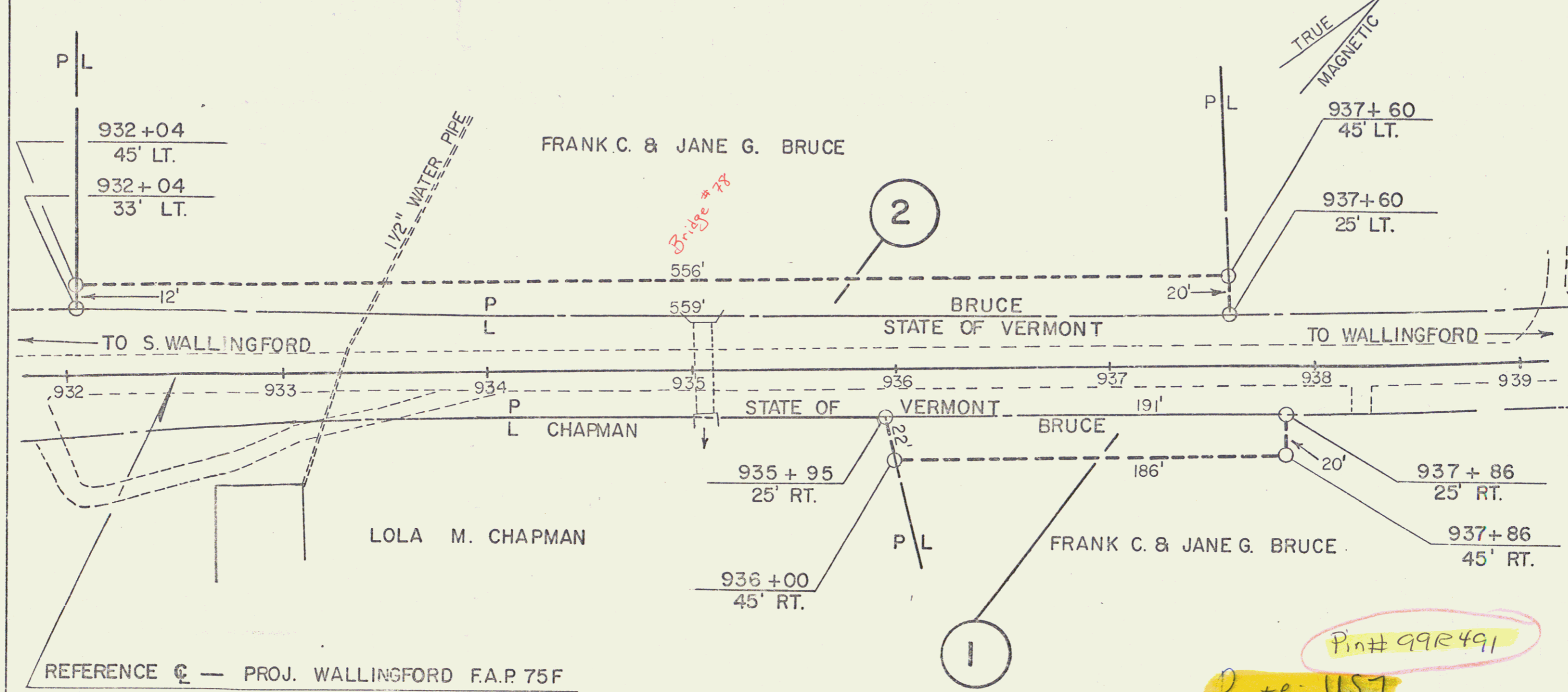

REFERENCE C — PROJ. WALLINGFORD F.A.P 75F

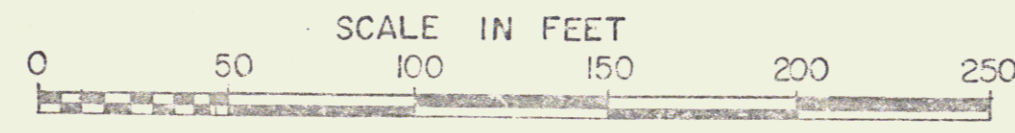

STATE OF VERMONT  
DEPT. OF HIGHWAYS

**TOWN OF WALLINGFORD**

PROJECT WALLINGFORD **BMA 6321** ①

APPROX. SCALE 1" = 50' DATE 5-10-74 DRAWN BY KMD

Pin# 99R491  
Route: US7