

DRIVE
689+25 RT.
696+00 LT.

BERM DITCH
684+00 - 685+50 Lt.

BITUMINOUS GROUTED
GUTTERS
690+71 Lt.

THREE CABLE GUARD RAIL
WITH STEEL POSTS
690+59 - 690+03 Lt. & Rt.
690+47 - 690+95 Lt. & Rt.

STEEL MARKER POSTS
696+32 Lt. & Rt. ✓

PARCEL 8
GRANTOR WILLIAM D. & MARY B. NICHOLS
STATIONS 696+83 - 698+67 (ORIGINAL)
TAKING 0.57 A ±
RIGHTS NONE
TITLE TAKEN: COND. 3/30/56
RECORDED: MT. TABOR-BK 15-PG 25-51

PLAN	DATE
REVISED	BY
ISSUED	DATE
LINKED	NO.
FILED	NO.

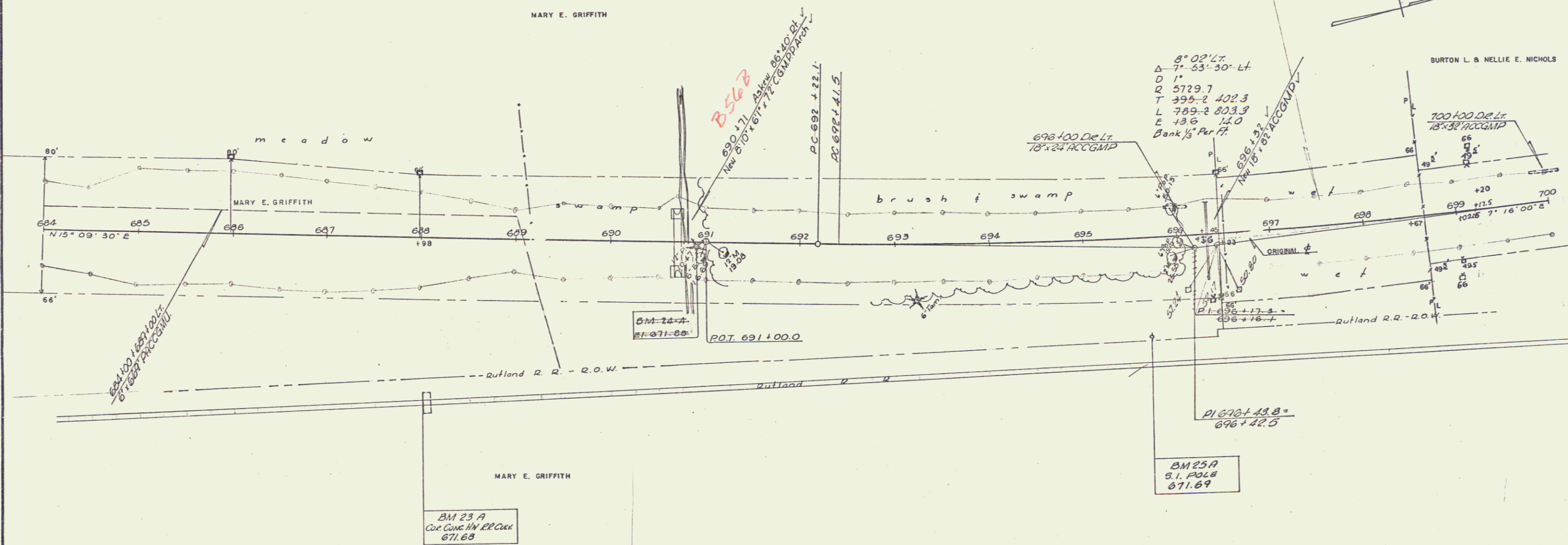

8° 02' Lt.
 Δ 7° 53' 30" Lt.
 D 1'
 R 5729.7
 T 999-2 402.3
 L 789-2 803.9
 E 13.6 11.0
 Bank 1/2 Per Ft.

BURTON L. & NELLIE E. NICHOLS
 700+00 De Lt
 18'-32' ACCUM
 66
 49
 20
 700
 699 +17.5
 102.8 2' 16' 00" E
 49.2
 49.5
 66

BM 23 A
 5.1. P.O.L.S.
 671.68

BM 25 A
 5.1. P.O.L.S.
 671.69

MT. TABOR - DANBY
 FO 19 - 2 (1)
 Sheet 20 of 188