

EXCAVATION & REMOVAL OF ROAD SURFACE ON ROADWAYS  
598+00-603+50 LT.

STEEL GUIDE POSTS  
594+00-595+00 RT 16" 5/8"

STEEL MARKER POSTS  
602+60 LT. & RT.

REMOVAL & DISPOSAL OF PRESENT GUARD RAIL  
596+30-598+63 LT.  
599+83-604+42 LT.

BITUMINOUS GROUTED GUTTERS  
602+60 RT.

DRIVE  
600+00 LT.

APPROACH  
603+50 LT.

LEONARD L. BRETON

FED. ROAD DIST. NO.	STATE	FED. AID YEAR	PROJECT YEAR	SHEET NO.	TOTAL SHEETS

Control of section of highway relinquished and returned to The Town of Mt. Tabor, beginning at a point in the center of the former State Highway, Route U.S. 7, said point being 120 feet left or westerly of survey station 604+00 of the established center line of highway Project F-019-2(1) (formerly F-12(5)), and continuing northerly 0.57 mile, more or less, to a point 40 feet left or westerly of survey station 634+15 of said established center line, and recorded in Mt. Tabor Land Records Book 15 Page 279.  
SEE SHEETS 13 & 14.

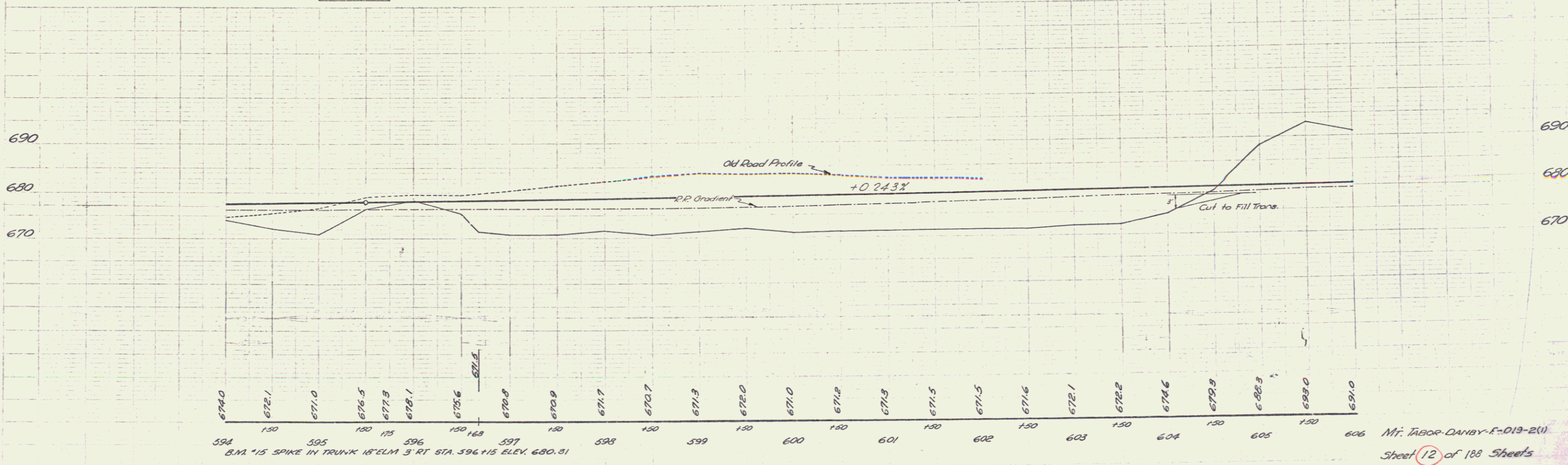
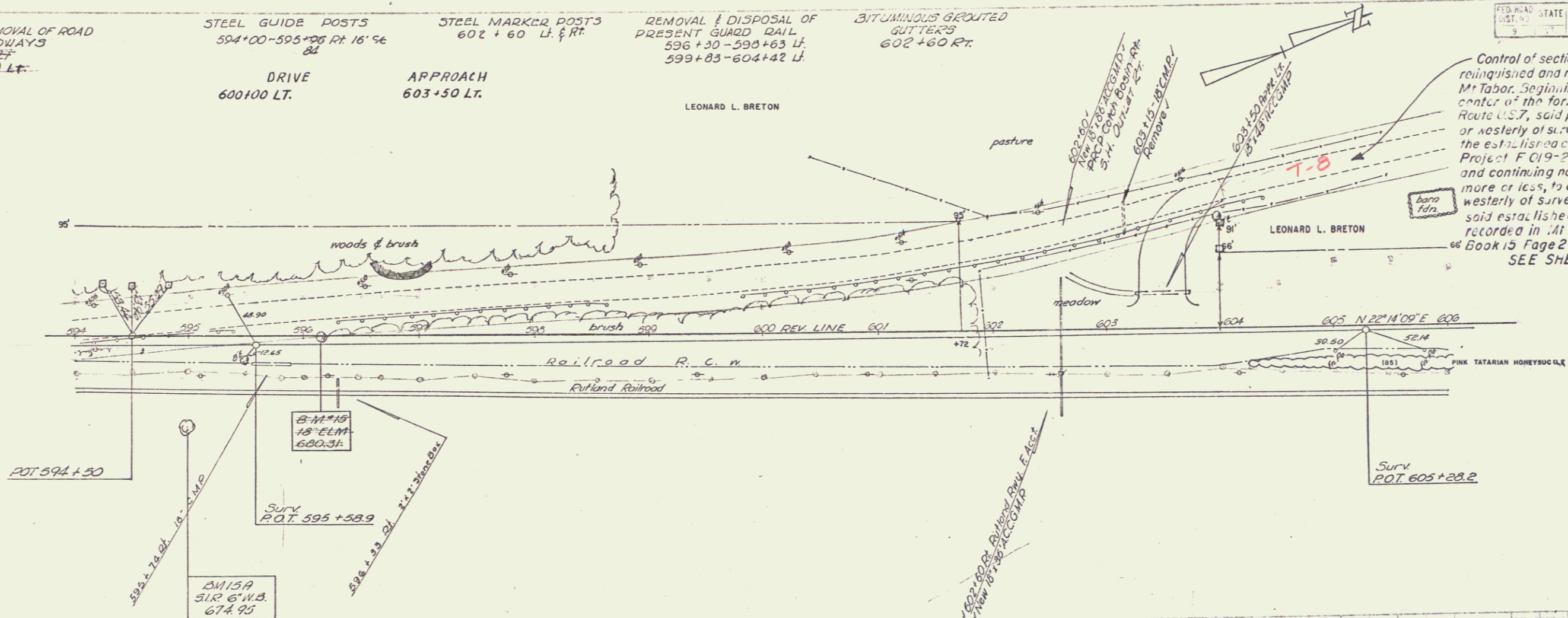

Mt. Tabor-Danby-F-019-2(1)  
Sheet 12 of 188 Sheets