

INDEX OF SHEETS

SHEET NO. 1	TITLE PAGE
2-3	TYPICAL CROSS-SECTION OF IMPROVEMENT - GARDENS, DRAINAGE, BASE, GUARD RAIL, & DOUBLE TRACK COAT OF REFINED TAR. ITEM 29.
4	TYPICAL SECT., MUCK REMOVAL BY FULL BURSTING.
5	BANKING & WIDENING TABLES.
6-13	PLAN & PROFILE
14	STANDARD STRUCTURE SHEET, S-28, PIPE CULVERTS.
15	9-30, GUARD RAIL.
16	9-300, STD. UND. BOUNDARY MKS., FED. AID MKS.
17	9-40, BARRICADES, SIGNS, & LIGHTS. (ROADWAY).
18	5-41, FOUNDAING OF SLOPES.
19	SB-11, DETAILS OF CABLE RAIL (BRIDGE).
20	SB-11, BARRICADES, SIGNS & LIGHTS (BRIDGE).
21	SCN-23, WINGS, 2x5' & 3x3' RC BOX.
22	SCN-24, DETAILS, 2x5, 3x3, 4x4, & 4x5' RC. BOXES.
23	SCN-4, WINGS FOR 4x4' RC. BOX.
24	25, DETAILS, CULV. EXTENSION, STA. 800+85.
26	9x7' RC. BOX, STA. 805+43.
27	8x6' RC. BOX, STA. 832+50.
28	4x5x5' RC. BOX, STA. 840+30 & 870+00.
29	CONC. CULVERT, STA. 860+00.
30	PLAN & PROFILE OF BROOK, STA. 831+50.
31-39	CROSS SECTION SHEETS
40-43	PLAN & PROFILE, "D", "J", "G", "I" LINES.
44-50	CROSS SECT. SHEETS, "D", "J", "G", "I" LINES.

STANDARD STRUCTURE SHEETS  
APPROVED BY THE CHIEF ENGINEER:  
S-28 JULY 11, 1933.  
S-30 AUG. 15, 1934.

STATE OF VERMONT  
STATE HIGHWAY DEPARTMENT

PLAN AND PROFILE OF PROPOSED  
STATE HIGHWAY

TOWN OF DANBY

MANCHESTER-RUTLAND ROAD

BEGINNING AT A POINT 1.5± MI. NORTH OF THE VILLAGE OF DANBY ON U.S. ROUTE 7 AND EXTENDING NORTHERLY 2.119 MI. TO THE DANBY-WALLINGFORD TOWN LINE

FEDERAL AID PROJECT	LENGTH OF ROADWAY 11169.06 FEET = 2.115 MILES	
	LENGTH OF BRIDGE 24.34 FEET = 0.004 MILES	
	LENGTH OF PROJECT 11192.90 FEET = 2.119 MILES	GOVERNMENT PARTICIPATION
SIDE ROADS	LENGTH OF "D" LINE 995.00 FEET = 0.188 MILES	
	LENGTH OF "J" LINE 240.00 FEET = 0.045 MILES	
	LENGTH OF "G" LINE 413.00 FEET = 0.078 MILES	
	LENGTH OF "I" LINE 317.00 FEET = 0.061 MILES	
	LENGTH OF SD. ROADS 1965.00 FEET = 0.372 MILES	NON-GOVERNMENT PARTICIPATION
	TOTAL LENGTH OF CONTRACT 13,157.90 FEET = 2.491 MILES	
	ON ROUTE U.S. 7 AND SIDE ROADS.	

Pin# 992484

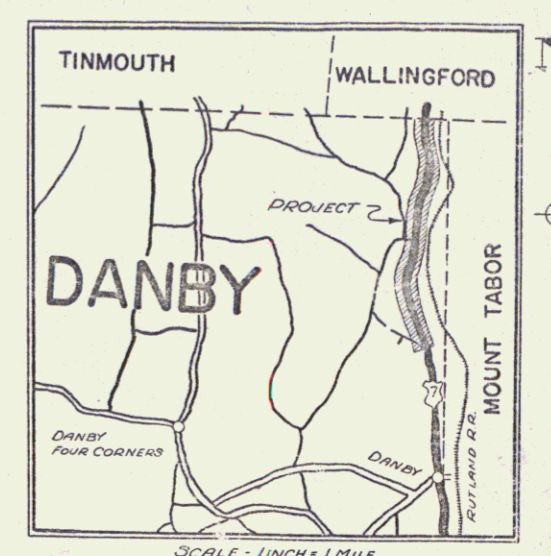

RECORD PLANS

By A.C. Birnie, Chas. Lewis  
5/22/41

RIGHT-OF-WAY DIVISION  
TOWN FILE

PERPETUAL  
Town of US7

(To Be Returned To R.O.W. Division)

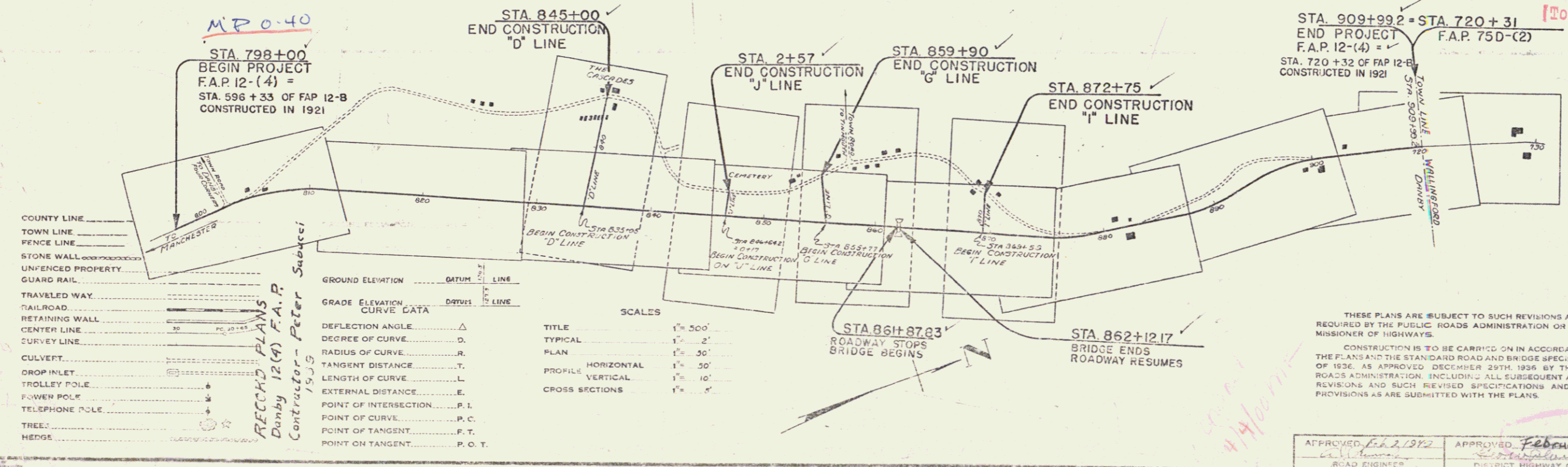

COUNTY LINE	.....
TOWN LINE	.....
FENCE LINE	.....
STONE WALL	.....
UNFENCED PROPERTY	.....
GUARD RAIL	.....
TRAVELED WAY	.....
RAILROAD	.....
RETAINING WALL	.....
CENTER LINE	.....
CURVEY LINE	.....
CULVERT	.....
DROP INLET	.....
TROLLEY POLE	.....
POWER POLE	.....
TELEPHONE POLE	.....
TREES	.....
HEDGES	.....

GROUND ELEVATION	.....	.....
GRADE ELEVATION	.....	.....
CURVE DATA	.....	.....
DEFLECTION ANGLE	.....	.....
DEGREE OF CURVE	.....	.....
RADIUS OF CURVE	.....	.....
TANGENT DISTANCE	.....	.....
LENGTH OF CURVE	.....	.....
EXTERNAL DISTANCE	.....	.....
POINT OF INTERSECTION	.....	.....
POINT OF CURVE	.....	.....
POINT OF TANGENT	.....	.....
POINT ON TANGENT	.....	.....

TITLE	1" = 50'
TYPICAL	1" = 2'
PLAN	1" = 30'
PROFILE HORIZONTAL	1" = 10'
PROFILE VERTICAL	1" = 2'
CROSS SECTIONS	1" = 2'

THESE PLANS ARE SUBJECT TO SUCH REVISIONS AS MAY BE REQUIRED BY THE PUBLIC ROADS ADMINISTRATION OR THE COMMISSIONER OF HIGHWAYS.  
CONSTRUCTION IS TO BE CARRIED ON IN ACCORDANCE WITH THE PLANS AND THE STANDARD ROAD AND BRIDGE SPECIFICATIONS OF 1936, AS APPROVED DECEMBER 29TH, 1936 BY THE PUBLIC ROADS ADMINISTRATION, INCLUDING ALL SUBSEQUENT APPROVED REVISIONS AND SUCH REVISED SPECIFICATIONS AND SPECIAL PROVISIONS AS ARE SUBMITTED WITH THE PLANS.

APPROVED: Feb 15, 1940  
ROAD ENGINEER  
APPROVED: February 1, 1940  
DISTRICT HIGHWAY COMMISSIONER  
SERIES F. 12(4) P. 12(4) P. 12(4)  
SHEET 1 OF 80

DIST. # 1 PLAN