

WOOD GUARD RAIL REQUIRED			
CULVERT STA	LEFT	RIGHT	
243+30	24	24	

NEW REIN. CONCRETE PIPE CULVERT REQUIRED				
STATION	DIAM.	LENG.	CONCL.	REIN. STEEL
243+30	15"	56'	2.3 CY.	33"

PLD ROAD DIST. (MI)	STATE	PLD. NO.	PLD. DATE	SHEET NO.	TOTAL SHEETS
9	VT.	109-A	7/93/1	132	

Parcel	Kind of Instrument	Date of Instrument	Grantor	Grantee	Recorded P.H.S. No.	Remarks
A	G.C.D.	2-26-32	ALBANE GREENE	St. of Vt.	A1 045	2-26-32
A'	"	5-16-32	Chas. H. Christian et al.	"	A1 267	5-19-32

STA 247+00  
 End Project BP 019-3-6632  
 SECTION No 2  
 END ROW PROJECT  
 BP 019-3-6632 SECT. #2  
 STA 247+00 25' LT.

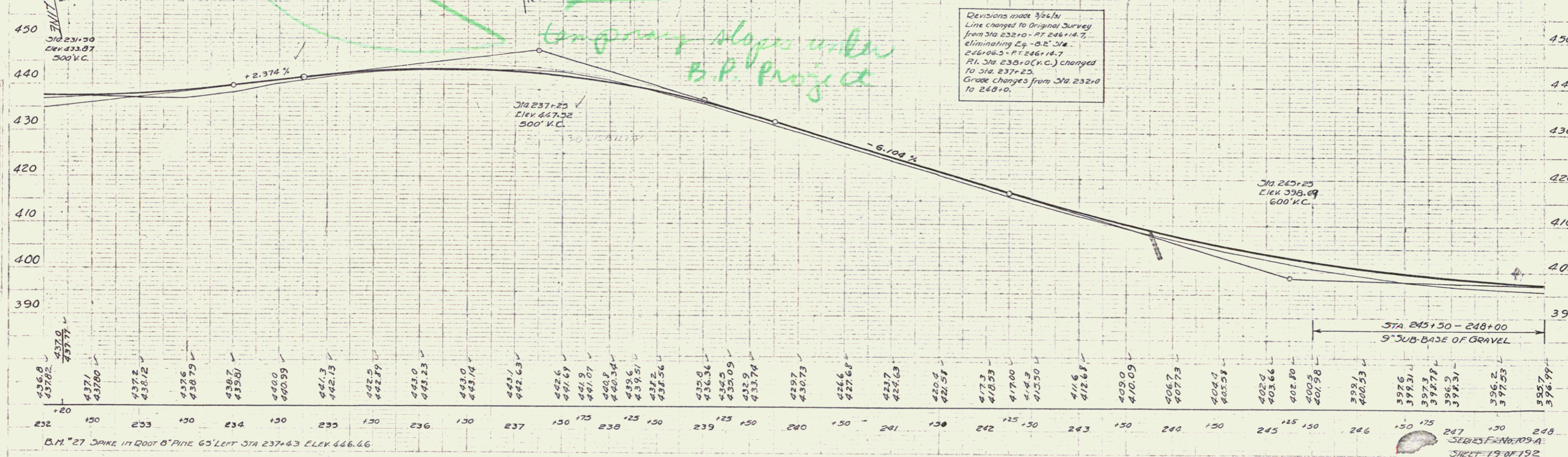
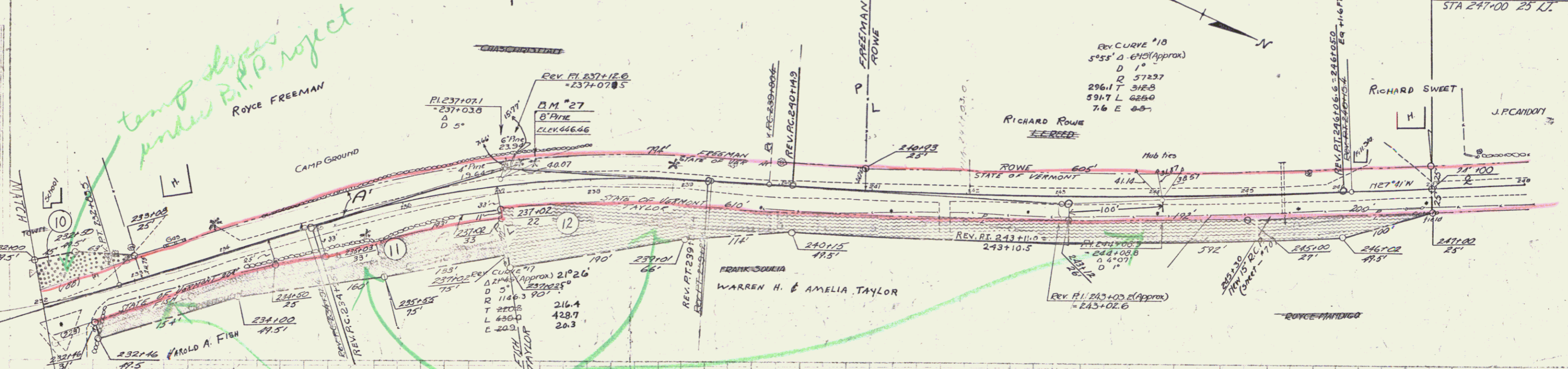

B.M. #27 SPIKE IN ROOT 6" PINE 65' LEFT STA 237+43 ELEV 446.66

Revisions made 3/5/51  
 Line changed to Original Survey  
 from Sta 232+10 - PT 246+14.7  
 eliminating Lg - 0.2' Sta.  
 246+06.5 - PT 246+14.7  
 Pt. Sta 230+0 (V.C.) changed  
 to Sta 237+25  
 Grade changes from Sta 232+0  
 to 248+0.

SHEET 7 OF 7  
 9