

WOOD GUARD RAIL REQUIRED				CABLE GUARD RAIL REQUIRED			
CULVERT STATION	LEFT RIGHT	STATION	LENG	SPACING	PIV LENGTH	STATION	LENG
145123	24	24	139100-140130 LT	190'	20'	139100-139140 RT	40'
150106	24	24	148150-152102 LT	352'	40'		392'

NEW REINFORCED CONCRETE PIPE CULVERTS REQUIRED			
STATION	DIAM	LENG	CONCRETE REINFORCING
139103	30"	44'	3.2 cy
150106	10"	44'	3.0 cy

CULVERT REPAIRS REQUIRED			
STATION	TYPE	EXTENSION	CONCRETE REINFORCING
145123	2125	7'0" RT	5.8 cy
			333 lbs

DRIVEWAY PIPE CULVERTS REQUIRED			
STATION	LENG	DIAM	LENG
150125	R	12"	24'
			2.3 cu yds

Found	Kind of	Date of	Quantity	Quantity	Recorded	Remarks
		Instrument				
A	C.C.D.	5-28-31	Hubbards-Saiter Staff	11	185	3-3-33 F. Hayward
A'	"	4-30-31	A.P. Leung	11	182	5-3-31
C&D	"	4-30-31	J. Kellogg	8	182	6-3-31 Rutland
D	"	12-30-31	W.H. Fish	8	115	

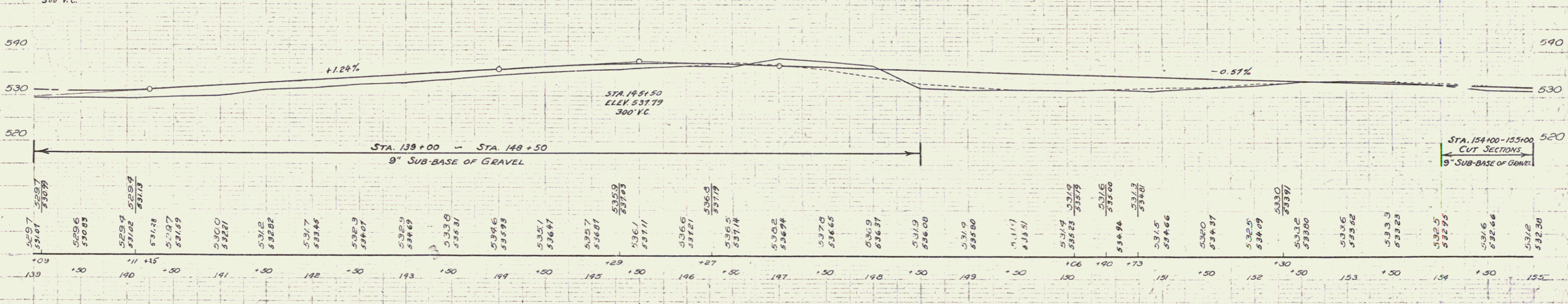
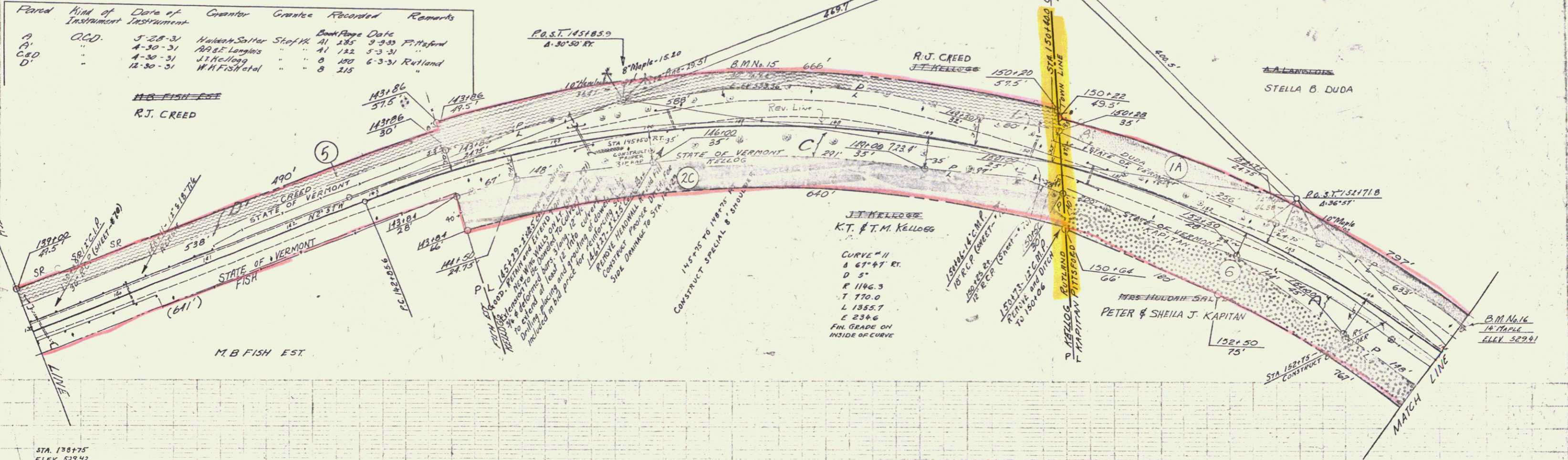

Station	Elevation	Station	Elevation	Station	Elevation
139+00	529.7	140+00	529.9	141+00	530.0
139+10	529.6	140+10	529.8	141+10	530.1
139+20	529.5	140+20	529.7	141+20	530.2
139+30	529.4	140+30	529.6	141+30	530.3
139+40	529.3	140+40	529.5	141+40	530.4
139+50	529.2	140+50	529.4	141+50	530.5
139+60	529.1	140+60	529.3	141+60	530.6
139+70	529.0	140+70	529.2	141+70	530.7
139+80	528.9	140+80	529.1	141+80	530.8
139+90	528.8	140+90	529.0	141+90	530.9
140+00	528.7	140+00	528.9	142+00	531.0
140+10	528.6	140+10	528.8	142+10	531.1
140+20	528.5	140+20	528.7	142+20	531.2
140+30	528.4	140+30	528.6	142+30	531.3
140+40	528.3	140+40	528.5	142+40	531.4
140+50	528.2	140+50	528.4	142+50	531.5
140+60	528.1	140+60	528.3	142+60	531.6
140+70	528.0	140+70	528.2	142+70	531.7
140+80	527.9	140+80	528.1	142+80	531.8
140+90	527.8	140+90	528.0	142+90	531.9
141+00	527.7	141+00	527.9	143+00	532.0
141+10	527.6	141+10	527.8	143+10	532.1
141+20	527.5	141+20	527.7	143+20	532.2
141+30	527.4	141+30	527.6	143+30	532.3
141+40	527.3	141+40	527.5	143+40	532.4
141+50	527.2	141+50	527.4	143+50	532.5
141+60	527.1	141+60	527.3	143+60	532.6
141+70	527.0	141+70	527.2	143+70	532.7
141+80	526.9	141+80	527.1	143+80	532.8
141+90	526.8	141+90	527.0	143+90	532.9
142+00	526.7	142+00	526.9	144+00	533.0
142+10	526.6	142+10	526.8	144+10	533.1
142+20	526.5	142+20	526.7	144+20	533.2
142+30	526.4	142+30	526.6	144+30	533.3
142+40	526.3	142+40	526.5	144+40	533.4
142+50	526.2	142+50	526.4	144+50	533.5
142+60	526.1	142+60	526.3	144+60	533.6
142+70	526.0	142+70	526.2	144+70	533.7
142+80	525.9	142+80	526.1	144+80	533.8
142+90	525.8	142+90	526.0	144+90	533.9
143+00	525.7	143+00	525.9	145+00	534.0
143+10	525.6	143+10	525.8	145+10	534.1
143+20	525.5	143+20	525.7	145+20	534.2
143+30	525.4	143+30	525.6	145+30	534.3
143+40	525.3	143+40	525.5	145+40	534.4
143+50	525.2	143+50	525.4	145+50	534.5
143+60	525.1	143+60	525.3	145+60	534.6
143+70	525.0	143+70	525.2	145+70	534.7
143+80	524.9	143+80	525.1	145+80	534.8
143+90	524.8	143+90	525.0	145+90	534.9
144+00	524.7	144+00	524.9	146+00	535.0
144+10	524.6	144+10	524.8	146+10	535.1
144+20	524.5	144+20	524.7	146+20	535.2
144+30	524.4	144+30	524.6	146+30	535.3
144+40	524.3	144+40	524.5	146+40	535.4
144+50	524.2	144+50	524.4	146+50	535.5
144+60	524.1	144+60	524.3	146+60	535.6
144+70	524.0	144+70	524.2	146+70	535.7
144+80	523.9	144+80	524.1	146+80	535.8
144+90	523.8	144+90	524.0	146+90	535.9
145+00	523.7	145+00	523.9	147+00	536.0
145+10	523.6	145+10	523.8	147+10	536.1
145+20	523.5	145+20	523.7	147+20	536.2
145+30	523.4	145+30	523.6	147+30	536.3
145+40	523.3	145+40	523.5	147+40	536.4
145+50	523.2	145+50	523.4	147+50	536.5
145+60	523.1	145+60	523.3	147+60	536.6
145+70	523.0	145+70	523.2	147+70	536.7
145+80	522.9	145+80	523.1	147+80	536.8
145+90	522.8	145+90	523.0	147+90	536.9
146+00	522.7	146+00	522.9	148+00	537.0
146+10	522.6	146+10	522.8	148+10	537.1
146+20	522.5	146+20	522.7	148+20	537.2
146+30	522.4	146+30	522.6	148+30	537.3
146+40	522.3	146+40	522.5	148+40	537.4
146+50	522.2	146+50	522.4	148+50	537.5
146+60	522.1	146+60	522.3	148+60	537.6
146+70	522.0	146+70	522.2	148+70	537.7
146+80	521.9	146+80	522.1	148+80	537.8
146+90	521.8	146+90	522.0	148+90	537.9
147+00	521.7	147+00	521.9	149+00	538.0
147+10	521.6	147+10	521.8	149+10	538.1
147+20	521.5	147+20	521.7	149+20	538.2
147+30	521.4	147+30	521.6	149+30	538.3
147+40	521.3	147+40	521.5	149+40	538.4
147+50	521.2	147+50	521.4	149+50	538.5
147+60	521.1	147+60	521.3	149+60	538.6
147+70	521.0	147+70	521.2	149+70	538.7
147+80	520.9	147+80	521.1	149+80	538.8
147+90	520.8	147+90	521.0	149+90	538.9
148+00	520.7	148+00	520.9	150+00	539.0
148+10	520.6	148+10	520.8	150+10	539.1
148+20	520.5	148+20	520.7	150+20	539.2
148+30	520.4	148+30	520.6	150+30	539.3
148+40	520.3	148+40	520.5	150+40	539.4
148+50	520.2	148+50	520.4	150+50	539.5
148+60	520.1	148+60	520.3	150+60	539.6
148+70	520.0	148+70	520.2	150+70	539.7
148+80	519.9	148+80	520.1	150+80	539.8
148+90	519.8	148+90	520.0	150+90	539.9
149+00	519.7	149+00	519.9	151+00	540.0
149+10	519.6	149+10	519.8	151+10	540.1
149+20	519.5	149+20	519.7	151+20	540.2
149+30	519.4	149+30	519.6	151+30	540.3
149+40	519.3	149+40	519.5	151+40	540.4
149+50	519.2	149+50	519.4	151+50	540.5
149+60	519.1	149+60	519.3	151+60	540.6
149+70	519.0	149+70	519.2	151+70	540.7
149+80	518.9	149+80	519.1	151+80	540.8
149+90	518.8	149+90	519.0	151+90	540.9
150+00	518.7	150+00	518.9	152+00	541.0
150+10	518.6	150+10	518.8	152+10	541.1
150+20	518.5	150+20	518.7	152+20	541.2
150+30	518.4	150+30	518.6	152+30	541.3
150+40	518.3	150+40	518.5	152+40	541.4
150+50	518.2	150+50	518.4	152+50	541.5
150+60	518.1	150+60	518.3	152+60	541.6
150+70	518.0	150+70	518.2	152+70	541.7
150+80	517.9	150+80	518.1	152+80	541.8
150+90	517.8	150+90	518.0	152+90	541.9
151+00	517.7	151+00	517.9	153+00	542.0
151+10	517.6	151+10	517.8	153+10	542.1
151+20	517.5	151+20	517.7	153+20	542.2
151+30	517.4	151+30	517.6	153+30	542.3
151+40	517.3	151+40	517.5	153+40	542.4
151+50	517.2	151+50	517.4	153+50	542.5
151+60	517.1	151+60	517.3	153+60	542.6
151+70	517.0	151+70	517.2	153+70	542.7
151+80	516.9	151+80	517.1	153+80	542.8
151+90	516.8	151+90	517.0	153+90	542.9
152+00	516.7	152+00	516.9	154+00	543.0
152+10	516.6	152+10	516.8	154+10	543.1
152+20	516.5	152+20	516.7	154+20	543.2
152+30	516.4	152+30	516.6	154+30	543.3
152+40	516.3	152+40	516.5	154+40	543.4
152+50	516.2	152+50	516.4	154+50	543.5
152+60	516.1	152+60	516.3	154+60	543.6
152+70	516.0	152+70	516.2	154+70	543.7
152+80	515.9	152+80	516.1	154+80	543.8
152+90	515.8	152+90	516.0	154+90	543.9
153+00	515.7	153+00	515.9	155+00	544.0
153+10	515.6	153+10	515.8		
153+20	515.5	153+20	515.7		
153+30	515.4	153+30	515.6		
153+40	515.3	153+40	515.5		
153+50	515.2	153+50	515.4		
153+60	515.1	153+60	515.3		
153+70	515.0	153+70	515.2		
153+80	514.9	153+80	515.1		
153+90	514.8	153+90	515.0		
154+00	514.7	154+00	514.9		
154+10	514.6	154+10	514.8		
154+20	514.5	154+20	514.7		
154+30	514.4	154+30	514.6		
154+40	514.3	154+40	514.5		
154+50	514.2	154+50	514.4		
154+60	514.1	154+60	514.3		
154+70	514.0	154+70	514.2		
15					