

**WOOD GUARD RAIL REQUIRED**  
 CULVERT STATION LEFT RIGHT  
 922+52 24' 24'

**NEW REIN. CONCRETE PIPE CULVERTS REQUIRED**  
 STATION DIAM. LENG. CONC. A CONC. C REIN. STEEL  
 922+52 15' 36' 2.3 cy 33 lbs.

**DOWNWAY PIPE CULVERTS REQUIRED**  
 60" CONC. PIPE  
 Station L x R (Dist) Length Concrete Outside  
 928+40 12' 40' 2.5

FED. ROAD DIST. NO.	STATE	FED. AID FISCAL YEAR	SHEET NO.	TOTAL SHEETS
9	VT.	1991	65	192

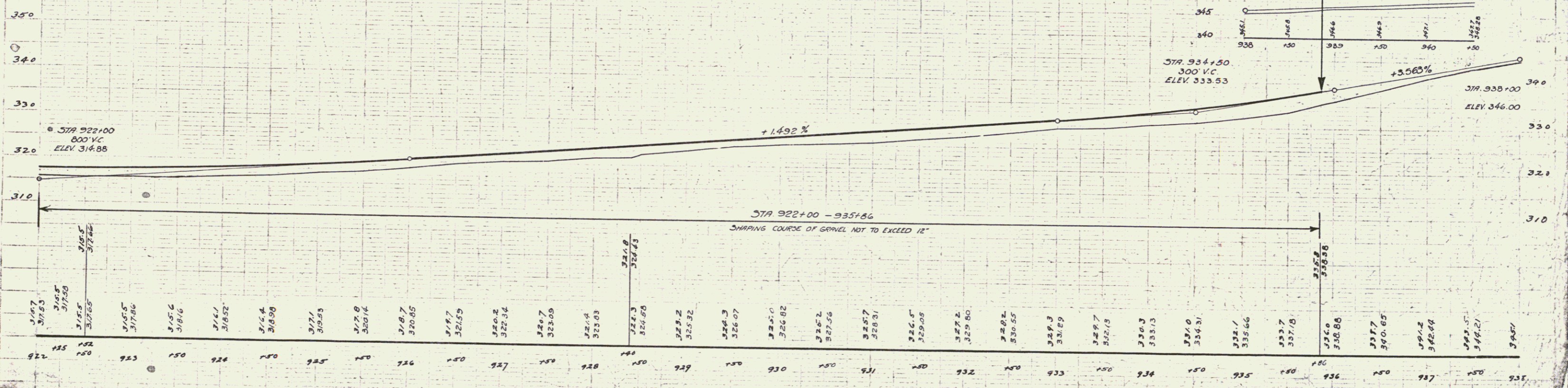
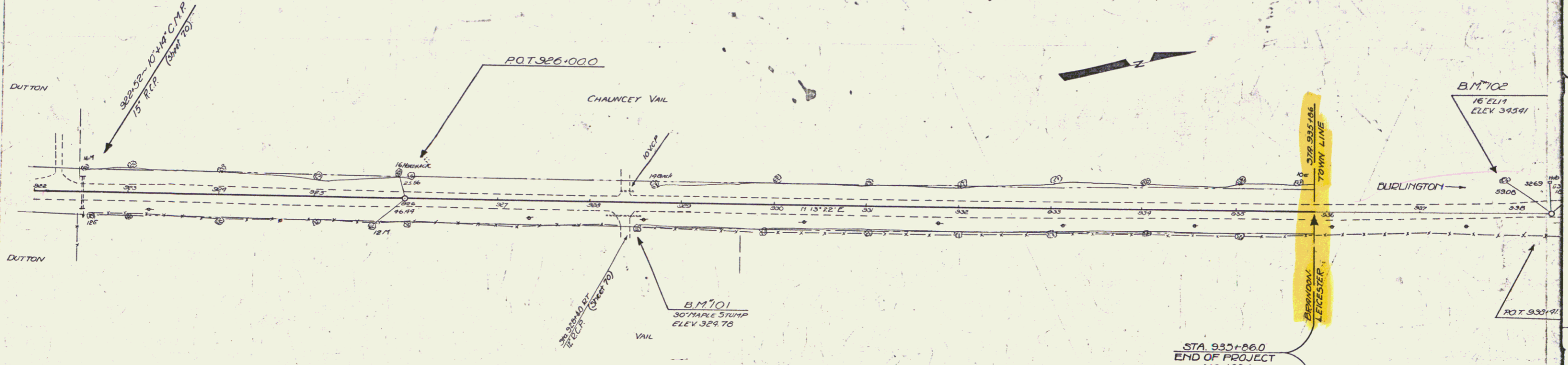

922	923	924	925	926	927	928	929	930	931	932	933	934	935	936	937	938	939	940
314.85	315.5	316.2	316.9	317.6	318.3	319.0	319.7	320.4	321.1	321.8	322.5	323.2	323.9	324.6	325.3	326.0	326.7	327.4

\* 10' SPIKE IN TOP 30' MAPLE STUMP 23' RT. 926+50 ELEV 324.79  
 ROOT 16' ELM 33' LT. 937+92 ELEV 395.91

67