

WOOD GUARD RAIL REQUIRED

CULVERT STATION	LEFT	RIGHT
697+67	24'	24'

CABLE GUARD RAIL REQUIRED

STATIONS	LONG	CONCRETE	ANY LIGHT
686+00-687+00	124'	20'	144'
686+00-687+24	Rt. 124'	20'	144'
692+50-696+00	Lt. 352'	40'	352'

NEW REIN. CONCRETE PIPE CULVERTS REQUIRED

STATION	DURM	LENG.	CONC. P.	CONC. C.	REIN. STEEL
697+67	24'	48'	2.4 cy.	-	54 lbs.

DRIVEWAY PIPE CULVERTS REQUIRED

STATION	LONG	DURM	LENG.	CEMENT	RUBBL	MASONRY
699+15	Rt. 18'	24'	3.3 cy.	-	-	-
690+68	Lt. 12'	24'	2.3 cy.	-	-	-

GRAUTED COBBLE GUTTER REQUIRED

STATIONS	L+R	WIDTH	LENGTH	AREA
686+00-687+80	Lt.	4'-0"	180'	80 sq. yds.
686+00-687+80	Rt.	4'-0"	180'	80 sq. yds.

FED. ROAD DIST. NO. STATE PROJ. NO. YEAR SHEET NO. TOTAL SHEETS
 9 VT. 109-A 1931 49 192

Parcel	Kind of Instrument	Date of Instrument	Grantor	Grantee	Recorded Division	Remarks
A'	G.C.O.	4-29-31	A. J. & A. M. Wiers	St. of R.	Book Page Date	64 119 5-1-31
A''	"	7-15-32	J. H. & L. W. Searcy	"	"	64 121 7-28-32

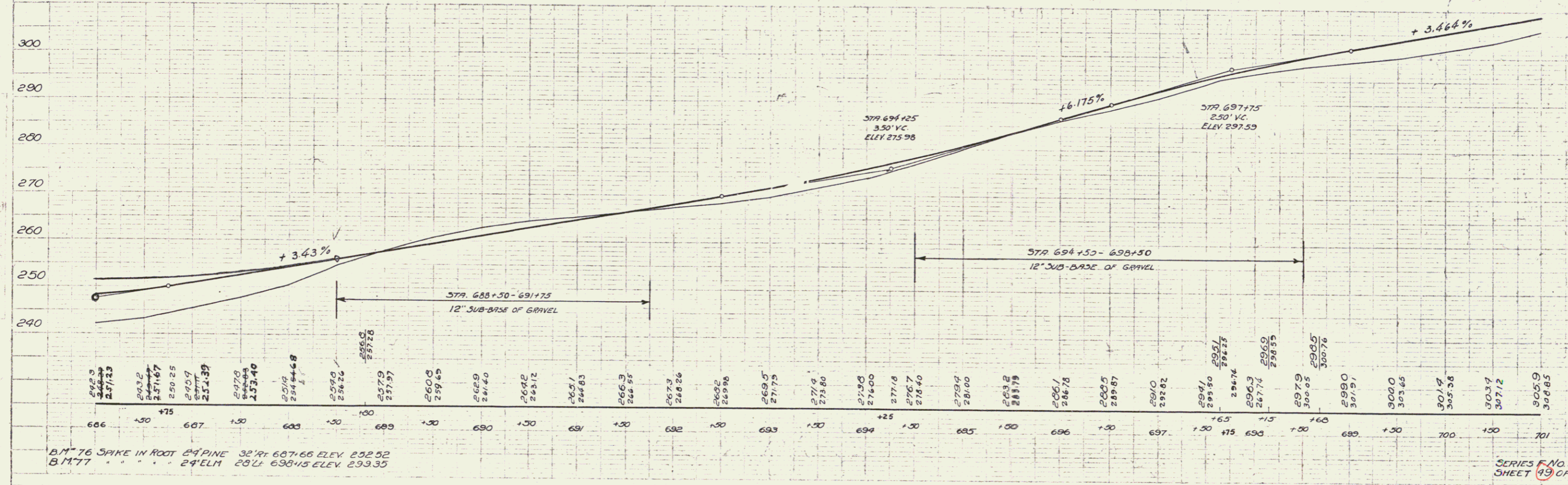
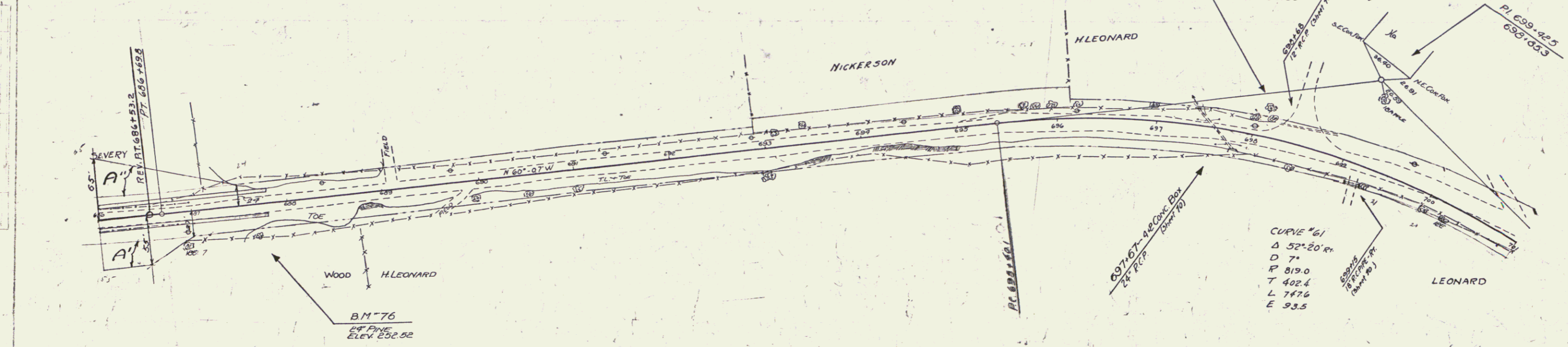

B.M. 76 SPIKE IN ROOT 24 PINE 32' RT. 687+66 ELEV. 252.52
 B.M. 77 " " " 24' ELM 28' LT. 698+15 ELEV. 299.35

SERIES F No. 109-A
 SHEET 49 OF 192

51