

WOOD GUARD RAIL REQUIRED

CULVERT STATION	LEFT	RIGHT
597+37	24'	24'

CABLE GUARD RAIL REQUIRED

STATIONS	LENS	QUANTITY	PIV LENGTH
60125-605151 LT	376'	40'	416'
60175-605151 RT	376'	40'	416'

NEW REINF CONCRETE PIPE CULVERTS REQUIRED

STATION	DIAM	LENS	CONC. P.	CONC. C.	REINF. STEEL
597+37	18"	40'	3.0%		33 lbs
603+53	30"	60'	3.2%		58 lbs

DRIVEWAY PIPE CULVERTS REQUIRED

STATION	DIAM	LENS	CEMENT FLORE MASONRY
595+25	12"	24'	2.3 cy
609+00	15"	36'	2.7 cy

RD ROAD DIST. NO. STATE PROJ. NO. YEAR
3 VT 109A 1951 43 192

Parcel	Kind of Instrument	Date of Instrument	Grantor	Grantee	Recorded	Remarks
R.E.B.	O.C.D.	6-19-31	Chas. J. E. Dodge Sr. of Yk		Book Page Date	
R.E.B.	"	6-19-31	Mr. A.H. Kimberley		64 1375 6-23-31	

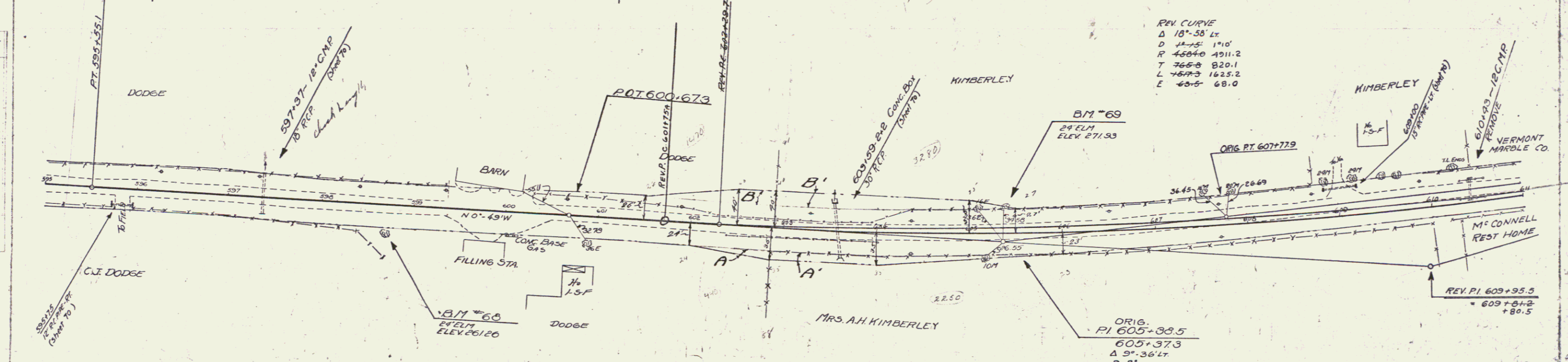

REV CURVE
 Δ 18°-58' Lt
 D 12-15' 1°10'
 R 45040 1911.2
 T 765.8 820.1
 L 767.3 1625.2
 E 68.5 68.0

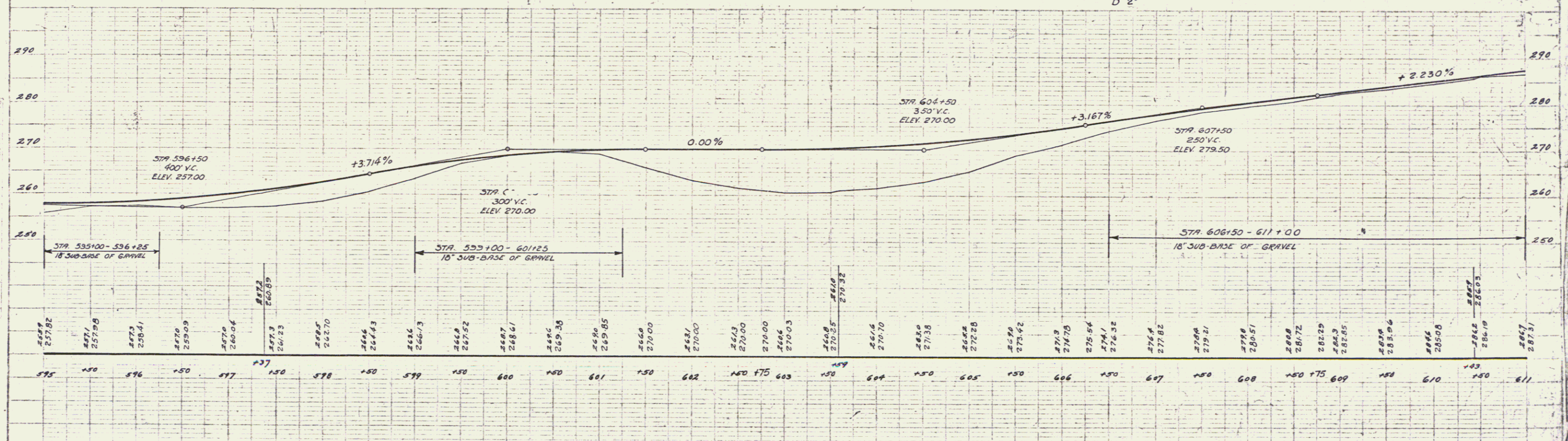

B.M. 66 SPIKE IN ROOT 24" ELM 26 FT 598.70 ELEV. 261.26
 B.M. 69 " " " " " " 25 FT 605.37 ELEV. 271.93

SERIES No 109A
 SHEET 43 OF 192

45