

STATE	109-A	1931	9	192
FED. ROAD DIST. NO.	109B	1931	6	21

WOOD GUMPI PAIL REQUIRED
 CULVERT STATION LEFT RIGHT
 81+03 24' 24'

NEW REIN. CONCRETE PIPE CULVERT REQUIRED
 STATION DIA. LENG. CONC. CONC. REIN. STEEL
 01+03 10' 40' 3.0cy 33lb.

CURVE #8
 Δ 12°.47' LT.
 D 2"
 R 2864.9
 T 320.9
 L 639.2
 E 17.9

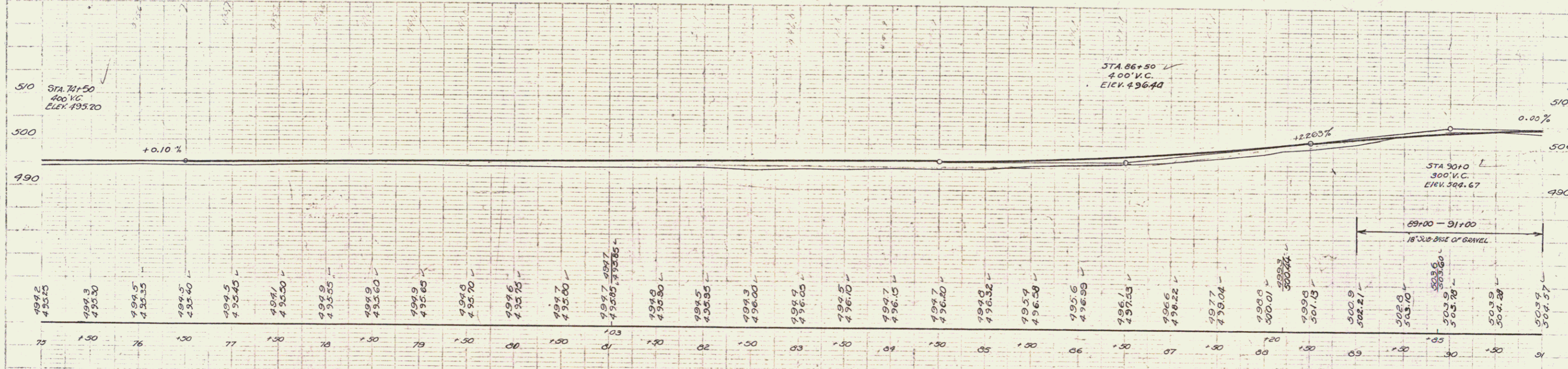
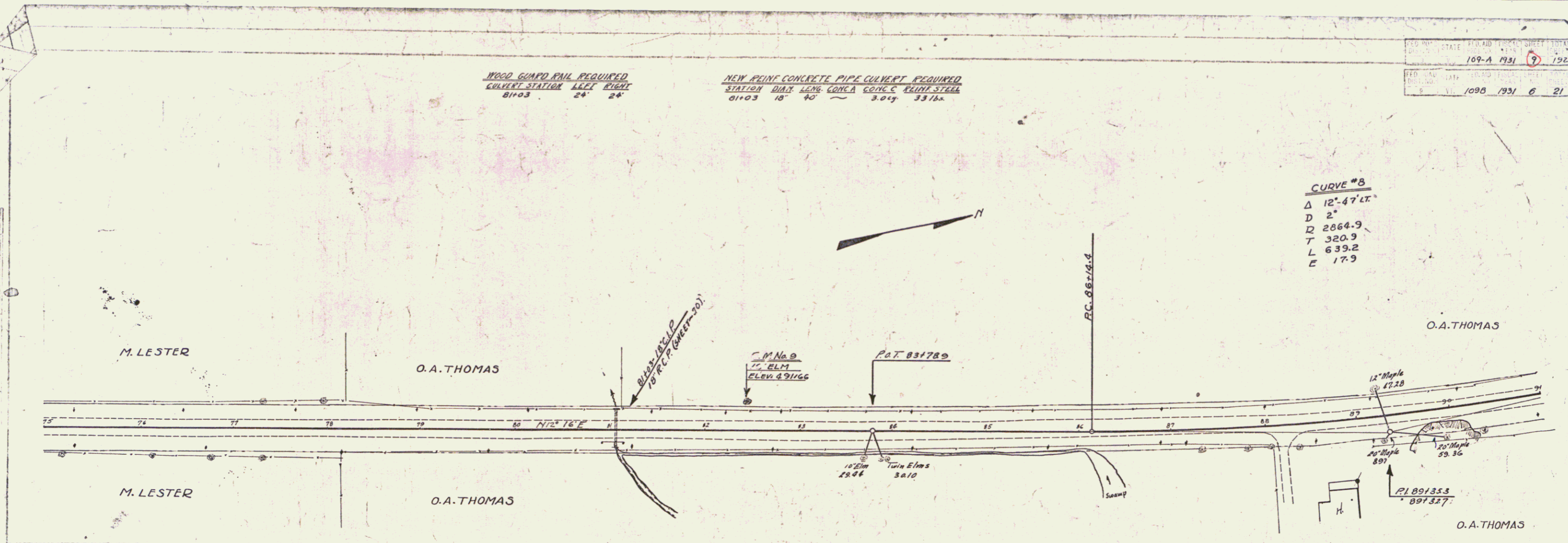

SPIKE IN ROOT OF
 B.M. #9 16' ELM 29' LT. STA 82+47 ELEV 491.66

GRADE REVISION 6-1-51
 ORIG. P.I. 30+00+00 400' V.C. Elev. 425.04
 REV. P.I. 30+00+00 400' V.C. Elev. 426.40

SERIES F-10 109A SHEET 9 OF 192
 SERIES F-16 109-B SHEET 6 OF 21