

- SHEETS TO BE USED FOR BRIDGE**
- 3.B.20 No. 40 Superstructure (3 Spans)
 - Abutment Details
 - S.P. No. 3 Standard Piers
 - S.P. No. 4 " " " " 15° Skew - N-192 - WITH PILES
 - Shaping Details for Piers
 - S.B. No. 2 Typical Details: S202; S203; S204; S205; S220; S221
 - S.B. No. 2A " " " " S223; S227
 - S.B. No. 2B " " " " S221
 - S.B. No. 3 Skew Ends 15° Skew
 - S.B. No. 5 Cable Rail
 - S.B. No. 6 Special Details S609
 - S.B. No. 8 Approach Slab Details (Omit gutter on upper side)

SUMMARY OF BRIDGE QUANTITIES

ITEM	DESCRIPTION	QUANTITY	UNIT
14	Channel Excavation	400	Cu. Yds.
15	Structure Excavation	220	Cu. Yds.
33A	Concrete Class 'A'	711.0	Cu. Yds.
33B	Concrete Class 'B'	44.0	Cu. Yds.
33C	Concrete Class 'C'	146.4	Cu. Yds.
34	Reinforcing Steel	5471	Lbs.
62	Pile Rip for Bank Protection	80	Cu. Yds.
67	Cable Guard Rail	250	Lin. Ft.
68	Timber Piling	1920	Lin. Ft.
	Maintaining Traffic and removing present bridge		Lump Sum.

CABLE GUARD RAIL REQUIRED

STA	STA	LEAD	LENGTH	CONSTANT	TOTAL LENGTH
64+64	66+72.5	L	20'	20'	220 FT.
67+34	66+78.5	R	142'	20'	162'
68+01	70+81	L	250'	20'	300'
68+07	69+51	R	142'	20'	162'
					TOTAL 856 L.F.

GROUTED COBBLE GUTTER REQUIRED

STA	LEAD	LENGTH	WIDTH	AREA
66+65	R	362'	4'	16.34
67+05	R	362'	4'	16.34
				TOTAL 32.68
				ALLOWED FOR OVERWASH 48.34

Parcel

Instrument	Date of Instrument	Grantor	Grantee	Recorded	Relevant
A	1-29-32	JR & AP Babbitt	Sta of Pt A	140	7-11-32
A	7-27-32	Milo Lester	" " " " B	220	7-27-32

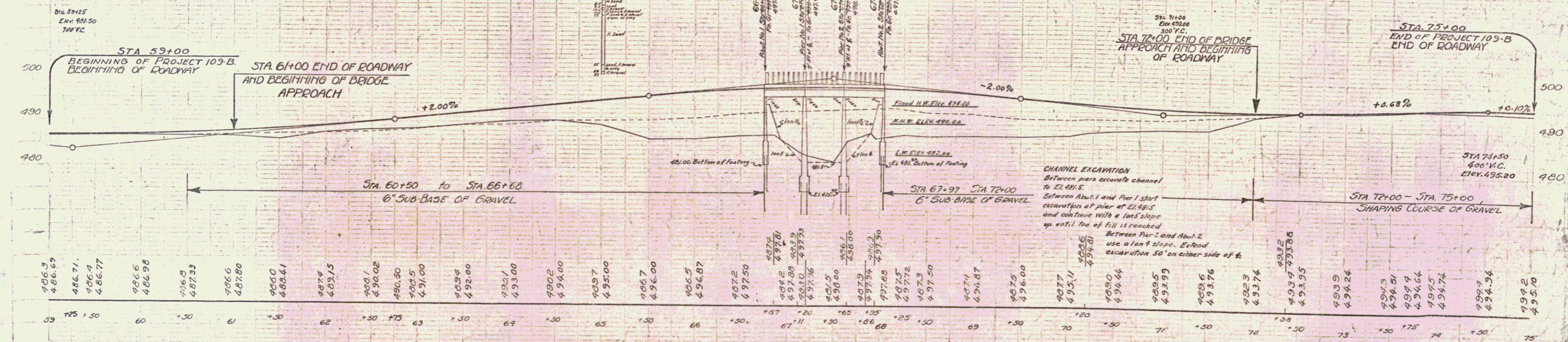
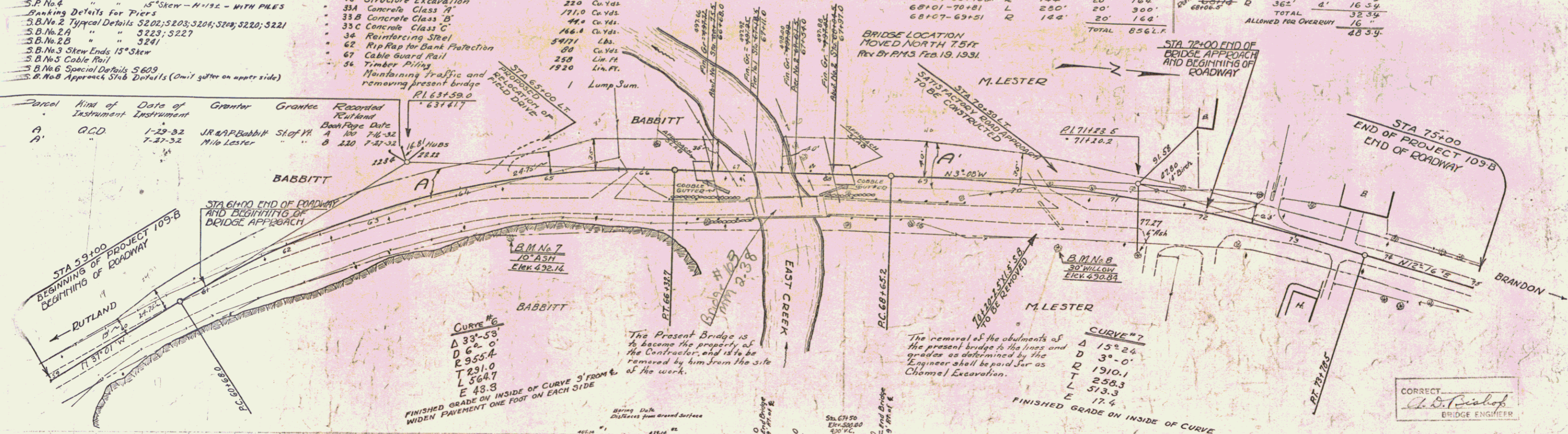

B.M. #7 Spike in 10" Ash 60' R. Sta. 64+45 Elev. 492.14
 B.M. #8 Spike in 30" Willow 64' R. Sta. 70+47 Elev. 490.84

Rutland 5