

**BITUMINOUS CONCRETE CURB, TYPE B**  
 350+23.2R - 350+68.2R (55' RT.)

**CONSTRUCT COMMERCIAL DRIVES**  
 351+24.1L, US-7  
 1+06 RT. SEWARD ROAD

**VERTICAL GRANITE CURB**  
 348+48.2R - 348+78.2R (30' R.)  
 350+32.2R - 350+47.2R  
 351+24.1L (Island - See Drive @ 351+24.1L)  
 352+67.1L - 353+00.1L (Drive @ 353+33.1L)

**PORTLAND CEMENT CONCRETE SIDEWALK - 5ft x 5in.**  
 350+66.1L - 350+93.1L  
 351+55.1L - 353+48.1L

Parcel No. 1  
 JOENA S. SEWARD  
 349+74.1L  
 CURVERT (P)  
 DRAINAGE (P)  
 RECORDED BK. Pg.

Parcel No. 2  
 JOENA S. SEWARD, LESSOR  
 B.F. RUTLAND, INC., LESSEE  
 351+24.1L DRIVE PERMIT (P)  
 DRIVE RELEASE DATED  
 DRIVE PERMIT DATED  
 350+12.1L REMOVE DRIVE (P)  
 352+19.9 - 353+23.1L REMOVE  
 EXIT DRIVE (P)  
 349+74.1L - 351+24.1L CURVERT (P)  
 RECORDED BK. Pg.

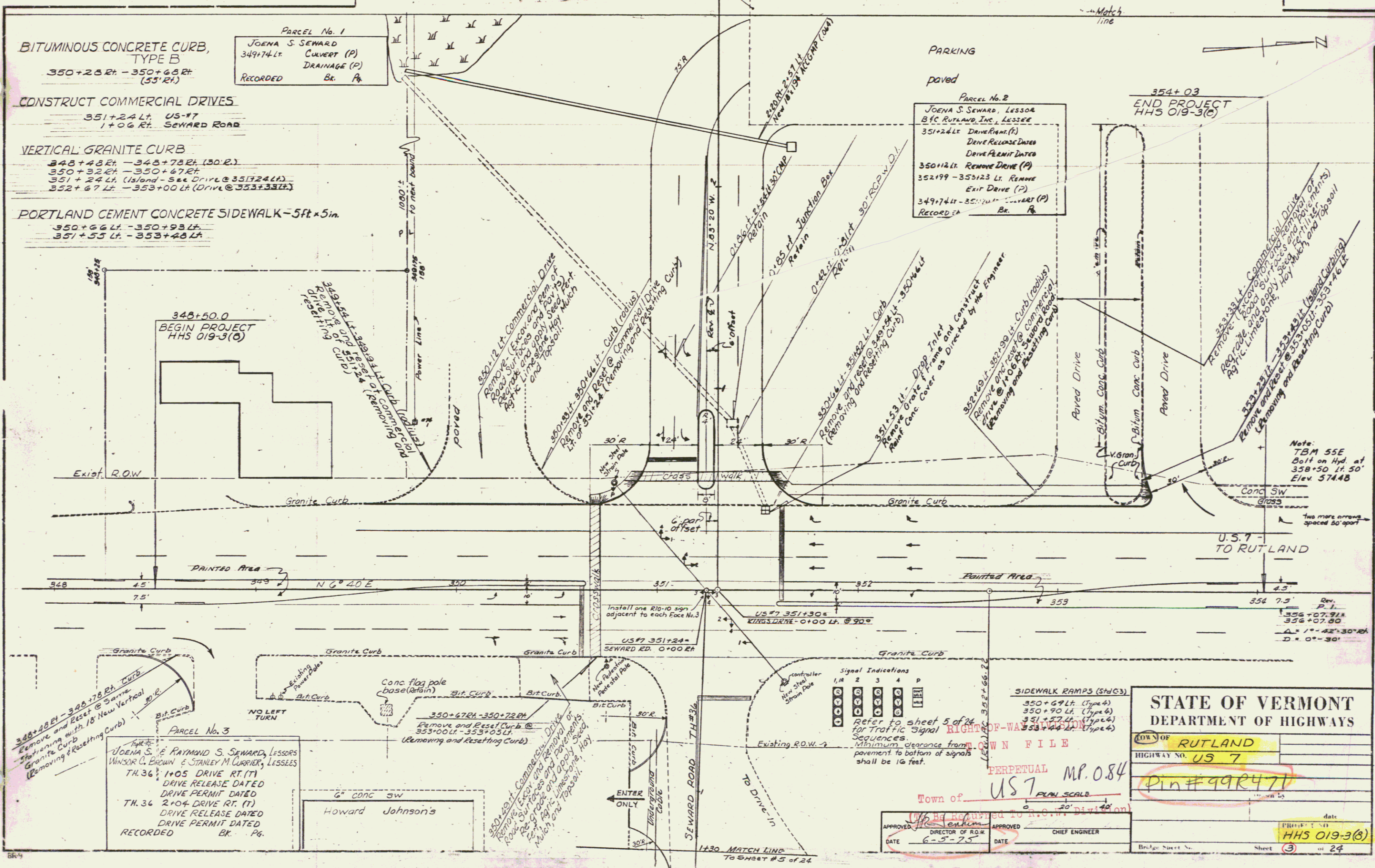

Parcel No. 3  
 JOENA S. & RAYMOND S. SEWARD, LESSORS  
 WINSON G. BROWN & STANLEY M. CURRIER, LESSEES  
 TH. 36, 1+05 DRIVE RT. (T)  
 DRIVE RELEASE DATED  
 DRIVE PERMIT DATED  
 TH. 36, 2+04 DRIVE RT. (T)  
 DRIVE RELEASE DATED  
 DRIVE PERMIT DATED  
 RECORDED BK. Pg.

**STATE OF VERMONT**  
**DEPARTMENT OF HIGHWAYS**

TOWN OF **RUTLAND**  
 HIGHWAY NO. **US 7**

**RIGHT-OF-WAY**  
 PERPETUAL  
 TOWN OF **US 7**  
 PLAN SCALE **1" = 40'**  
 DATE **6-5-75**

PROJECT NO. **HHS 019-3(6)**  
 SHEET **(3)** OF **24**

Note:  
 TBM 55E  
 Bolt on Hyd. at  
 358+50 Lt. 50'  
 Elev 574.48

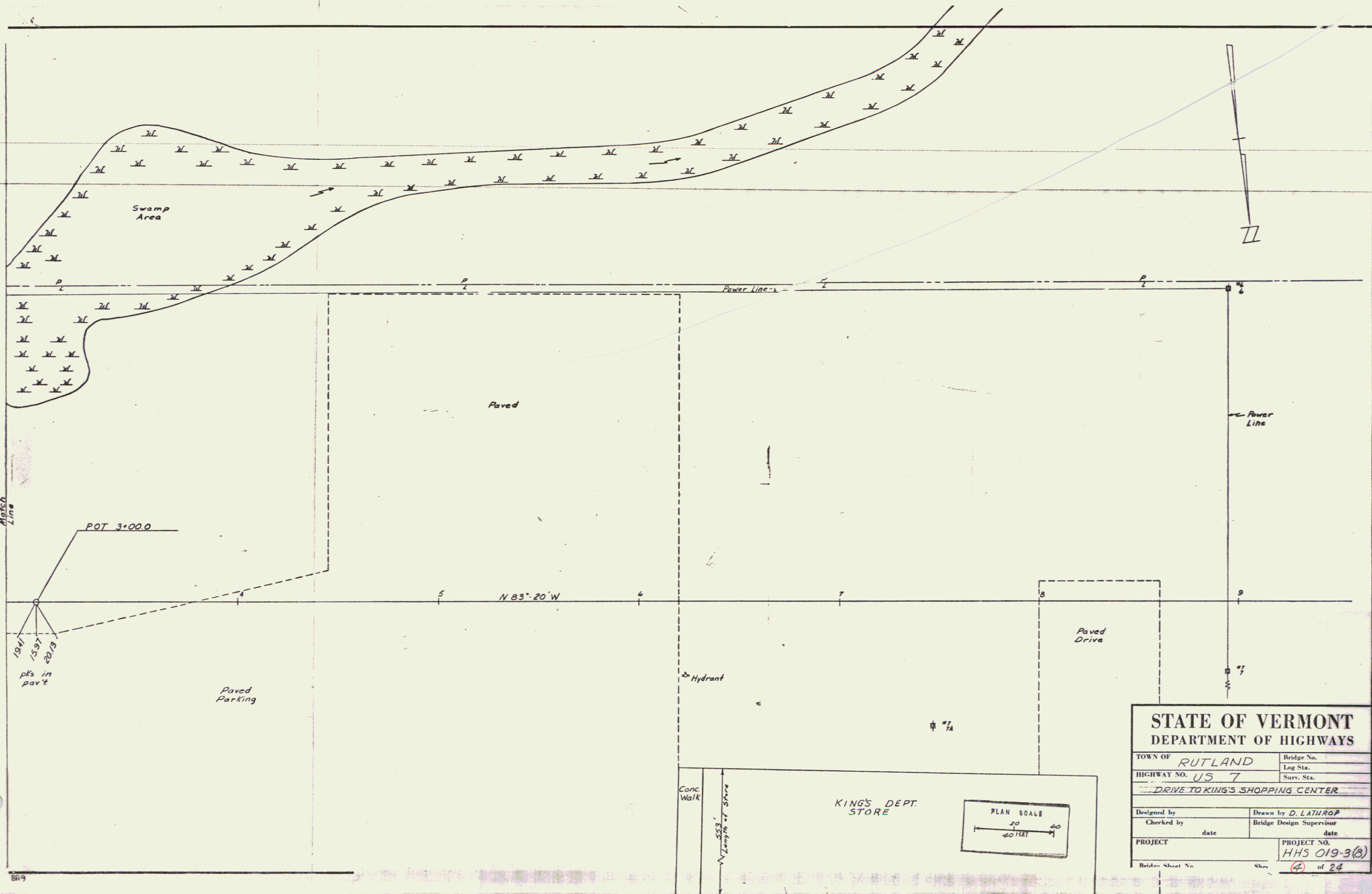

STATE OF VERMONT DEPARTMENT OF HIGHWAYS	
TOWN OF <u>RUTLAND</u>	Bridge No.
HIGHWAY NO. <u>US 7</u>	Log Sta.
<u>DRIVE TO KING'S SHOPPING CENTER</u>	
Designed by	Drawn by <u>D. LATHROP</u>
Checked by	Bridge Design Supervisor
date	date
PROJECT	PROJECT NO. <u>HHS 019-3(3)</u>
Bridge Sheet No.	Sheet <u>4</u> of <u>24</u>

