

SOD REMOVAL - ITEM 101-A  
1284+00 - 1293+20

CONSTRUCT DRIVES  
1288+42 L<sup>1</sup>/<sub>2</sub> CORNER  
1292+74 L<sup>1</sup>/<sub>2</sub> CORNER  
1295+87 L<sup>1</sup>/<sub>2</sub> CORNER  
1299+00 L<sup>1</sup>/<sub>2</sub> CORNER

CONSTRUCT APPROACH  
1289+64 R<sup>1</sup>/<sub>2</sub> V

PAVEMENT REMOVAL - ITEM 101-A  
1284+00 - 1292+50

THREE CABLE GUARD RAIL  
WITH STEEL POSTS  
1290+02 L<sup>1</sup>/<sub>2</sub> - 1290+98 L<sup>1</sup>/<sub>2</sub>  
0+25 L<sup>1</sup>/<sub>2</sub>, T.R. 9 - 1291+00 R<sup>1</sup>/<sub>2</sub>

DRAWN: Andy J. Brown  
 CHECKED: W.D.  
 DATE: 11/24/59

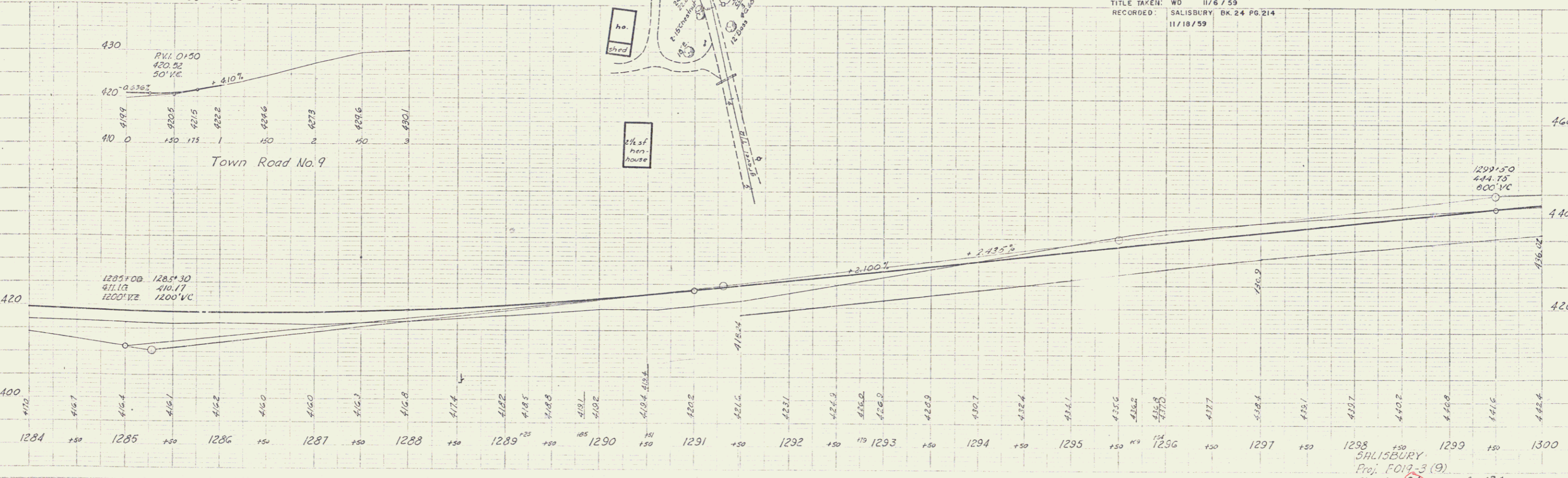
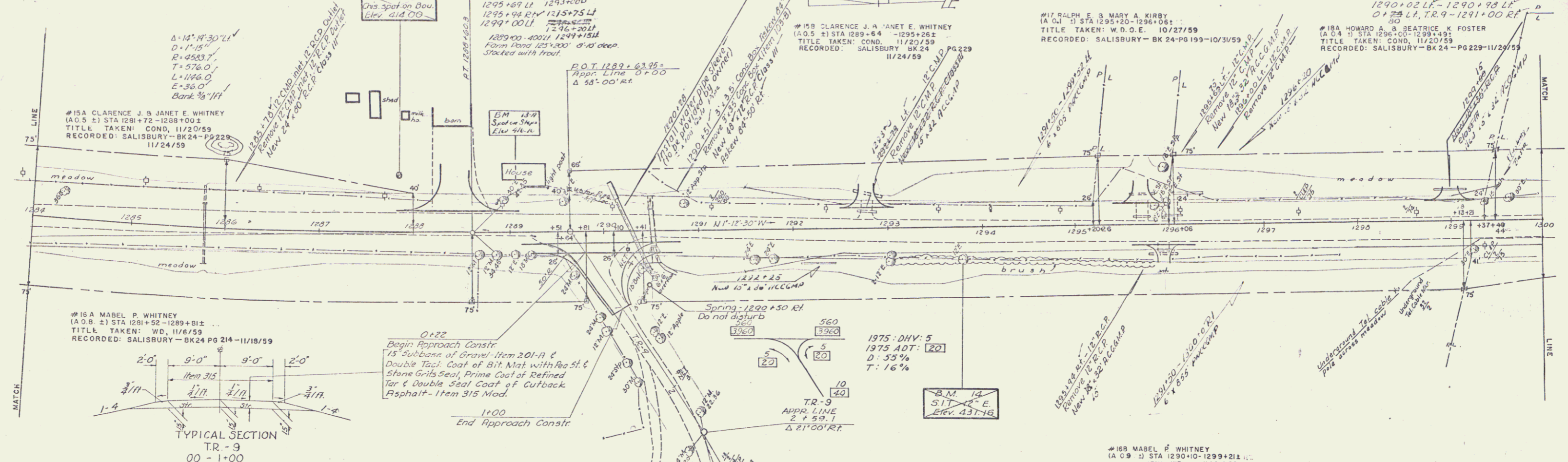

SALISBURY  
Proj. F019-3(9)  
Sheet 26 of 134