

U.S. Rte 7

INDEX OF SHEETS	
SHEET NO. 1	TITLE PAGE
2-3	TYPICAL CROSS-SECTION OF IMPROVEMENT (COAT OF REFINED TAR WITH PEA STONE SEAL ITEM 29A)
4	TYPICAL SECTION - ROADSIDE IMPROVEMENT ITEMS
5	BANKING AND WIDENING TABLES
6-8	PLAN AND PROFILE
14	STANDARD STRUCTURE SHEET S-28 PIPE CULVERTS
15	" " " " S-30 WOOD GUARD RAIL
16	" " " " THREE STRAND CABLE GUARD RAIL
17	" " " " S-30A STANDARD UNDERDRAIN; BOUNDARY MARKERS; F & A MARKERS
18	" " " " S-40 BARRICADES, SIGNS AND LIGHTS
19	" " " " S-41 TYPICAL GRADING CROSS SECTIONS
20	BRIDGE STATION 1104+40 - 1105+48 ABUTMENT DETAILS
21	" " " " PIER DETAILS
22	STANDARD STRUCTURE SHEET SIB-30 SUPERSTRUCTURE DETAILS
23	" " " " SIB-5P CURB AND RAIL DETAILS
24	" " " " SIB-23 DETAILS "C" DETAILS
25	" " " " STA 1133+00 - S X 6 R.C. BOX
26	" " " " DETAILS 4 1/2 X 6, 5 X 7 R.C. BOX
27	" " " " SC-2-4 4X5, R.C. BOX
28	" " " " SCW 4X5 R.C. BOX
29-72	CROSS SECTIONS

STANDARD STRUCTURE SHEETS APPROVED
BY THE CHIEF ENGINEER
S-28 APRIL 26, 1941
S-30 MAY 12, 1941
S-30A APRIL 19, 1941

STATE OF VERMONT
STATE HIGHWAY DEPARTMENT

PLAN AND PROFILE OF PROPOSED
STATE HIGHWAY

FEDERAL AID PROJECT

TOWNS OF LEICESTER AND SALISBURY

ROUTE U.S. 7 *Proj# 91R465*

BEGINNING 0.69 MILE SOUTH OF THE LEICESTER-SALISBURY
TOWN LINE AND EXTENDING NORTHERLY 1.814 MILES.

LENGTH OF ROADWAY = 9471.2 FEET = 1.794 MILES
LENGTH OF BRIDGE = 108.0 FEET = 0.020 MILE
LENGTH OF CONTRACT = 9579.2 FEET = 1.814 MILES

DATE	BY	REVISION
9	VT	91R465 72

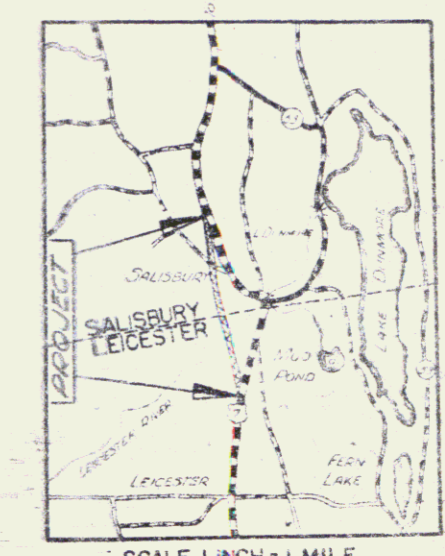

RECORD PLANS

REFERENCE SHEET
FOR PROJECT 2MA 6718
SHEET 7 OF 17

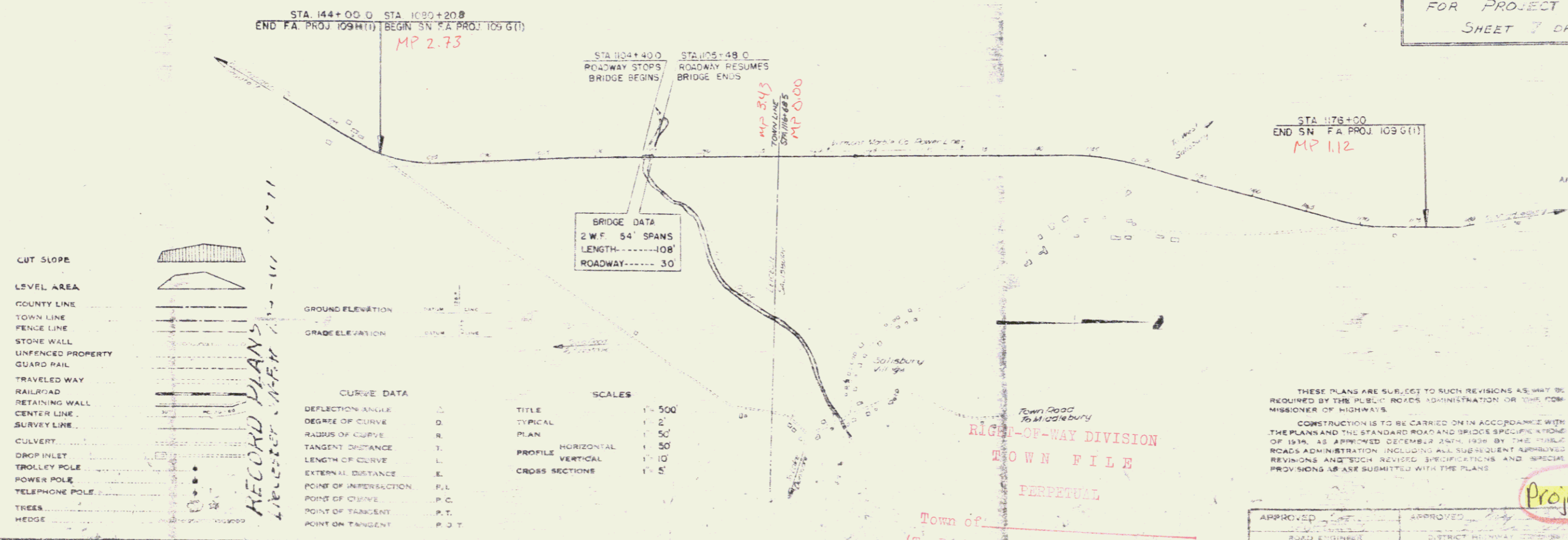

APPROVED: *[Signature]*
MAY 17, 1941
COMMISSIONER OF HIGHWAYS

MAY 19 1988

RIDGE-OF-WAY DIVISION
TOWN FILE
PERPETUAL

THESE PLANS ARE SUBJECT TO SUCH REVISIONS AS MAY BE
REQUIRED BY THE PUBLIC ROADS ADMINISTRATION OR THE COM-
MISSIONER OF HIGHWAYS.
CONSTRUCTION IS TO BE CARRIED ON IN ACCORDANCE WITH
THE PLANS AND THE STANDARD ROAD AND BRIDGE SPECIFICATIONS
OF 1934, AS APPROVED DECEMBER 28TH, 1938 BY THE PUBLIC
ROADS ADMINISTRATION INCLUDING ALL SUBSEQUENT APPROVED
REVISIONS AND SUCH REVISED SPECIFICATIONS AND SPECIAL
PROVISIONS AS ARE SUBMITTED WITH THE PLANS.

Project No. SNEAPI09GCI

APPROVED	APPROVED	APPROVED
ROAD ENGINEER	DISTRICT ENGINEER	SHE