

INDEX OF SHEETS

SHEET NO.	TITLE PAGE
1	TITLE PAGE
2	TYPICAL SECTIONS OF IMPROVEMENT - DOUBLE TACK COAT OF CUTBACK ASPHALT W/PEASTONE
3	QUANTITY SHEET, ITEMS
4	QUANTITY SHEET, DRAINAGE
5-6	EARTHWORK SHEETS
7-11	PLAN & PROFILE
12	STANDARD BRIDGE SHEET SB-20-56 DETAILS FOR WF BEAM BRIDGES
13	STANDARD BRIDGE SHEET SB-22-58 DETAILS OF SLAB & PIERS
14-15	STANDARD BRIDGE SHEET SCB-30-56 (49-59-49 SPAN)
16	STANDARD BRIDGE SHEET SB-AS-50-57 (MOD) DETAILS OF APPROACH SLABS
17-18	STANDARD BRIDGE SHEET SB-50-57 DETAILS OF BRIDGE RAILING & CURB
19	STANDARD BRIDGE SHEET BS-56-2 BARRICADES, SIGN & LIGHTS (BRIDGE)
20	ROADWAY STANDARD SHEET RS 56-1 BARRICADES
21	ROADWAY STANDARD SHEET RS 56-2 REINF. CONC. DROP INLETS
22	ROADWAY STANDARD SHEET RS 56-3 MARKERS
23	ROADWAY STANDARD SHEET RS 56-4 DRAINAGE
24	ROADWAY STANDARD SHEET RS 56-6 TYPICAL SLOPE GRADING
25	ROADWAY STANDARD SHEET RS 56-11 THREE CABLE GUARD RAIL W/STEEL POSTS
26	ROADWAY STANDARD SHEET RS 56-12 BARRICADES, SIGN & LIGHTS (ROADWAY)
27	ROADWAY STANDARD SHEET RS 56-14 PRECAST R.C.P. DROP INLETS
28	ROADWAY STANDARD SHEET A-61 DRILLING & BLASTING OF SOILD ROCK SUBGRADE
29	ROADWAY STANDARD SHEET G-4 STEEL MARKER POSTS
30	BRIDGE SHEET 79+75 GENERAL PLAN
31	BRIDGE SHEET 79+75 BORINGS
32	BRIDGE SHEET 79+75 PLAN & ELEVATION
33	BRIDGE SHEET 79+75 ABUTMENT NO. 1 & NO. 2
34	BRIDGE SHEET 79+75 APPROACH SLABS
35	BRIDGE SHEET 79+75 PIERS "A" & "B"
36	BRIDGE SHEET 79+75 STRUCTURAL PLAN & DETAIL
37	BRIDGE SHEET 79+75 REINFORCING SCHEDULE
38-73	CROSS SECTIONS
74-77	CHANNEL SECTIONS BRIDGE AT 79+75

STATE OF VERMONT
DEPARTMENT OF HIGHWAYS
PROPOSED IMPROVEMENT

TOWN OF FERRISBURG
COUNTY OF ADDISON
U.S. ROUTE 7
CHARLOTTE-VERGENNES ROAD

BEGINNING AT A POINT 2,990 FEET FROM THE VERGENNES-FERRISBURG TOWN LINE AND EXTENDING NORTHERLY 6,800.0 FEET.
LENGTH OF ROADWAY 6,643.0 FEET + 1.258 MILES.
LENGTH OF BRIDGE 157.0 FEET + 0.030 MILES
LENGTH OF PROJECT 6,800.0 FEET + 1.288 MILES
DESIGN DESIGNATION
ADT (1955) 2750-3270
ADT (1975) 4400-8240
DHV (1975) 575-665
D - 59%
T - 7 1/2%
V-80 MPH.

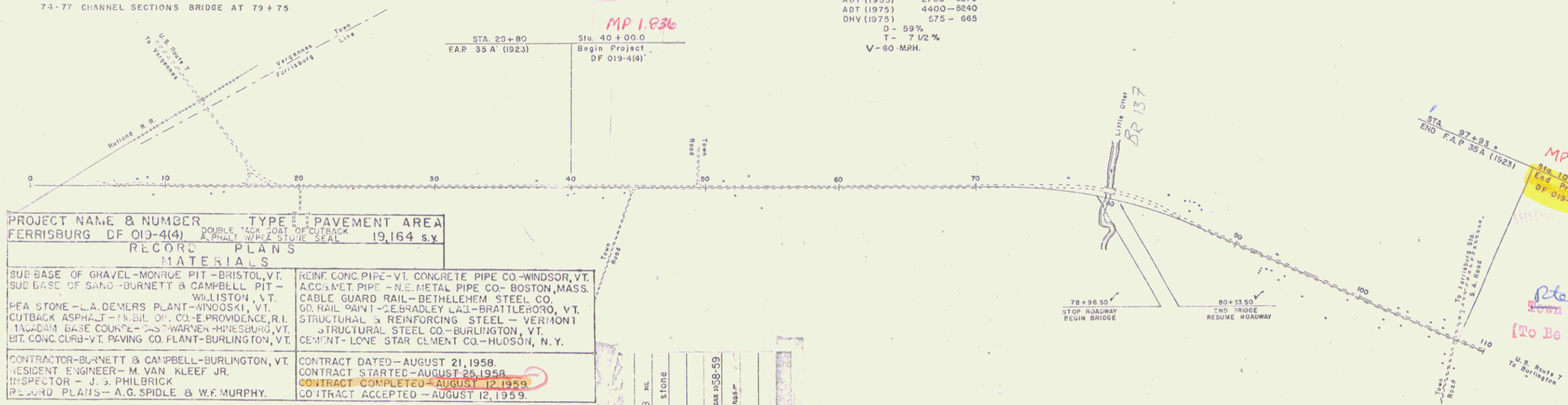
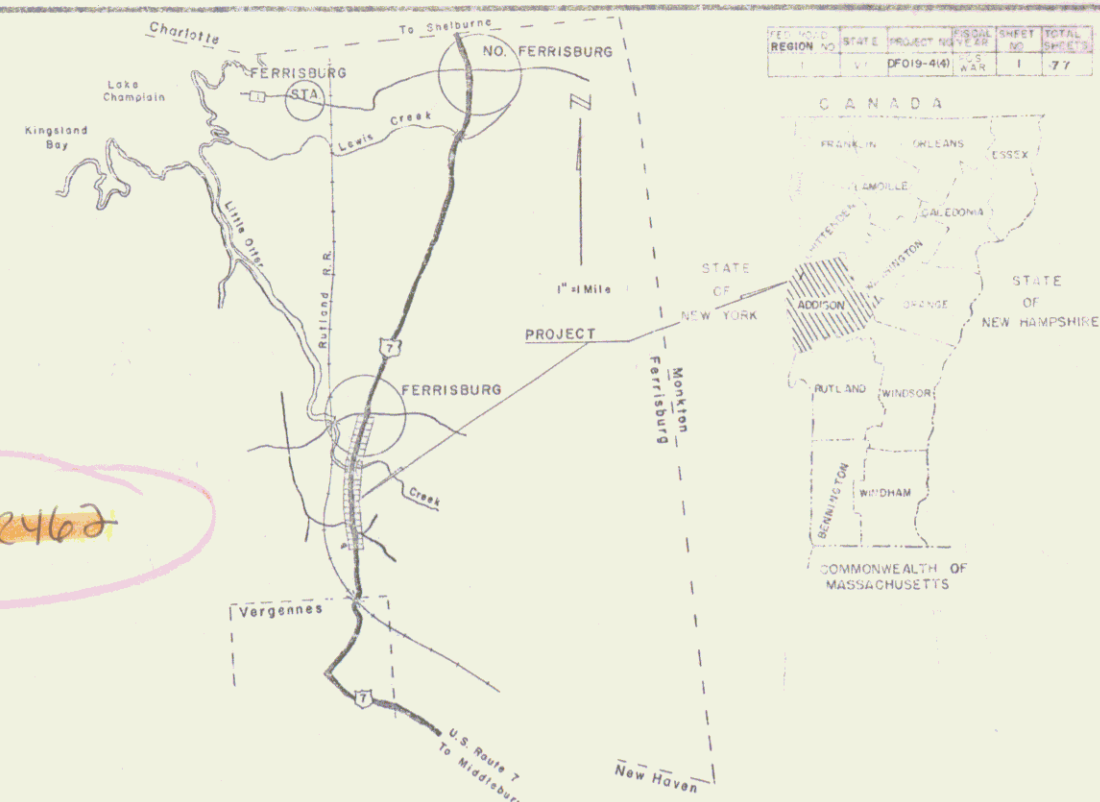

PROJECT NAME & NUMBER	FERRISBURG DF 019-4(4)
TYPE	DOUBLE TACK COAT OF CUTBACK ASPHALT W/PEASTONE
PAVEMENT AREA	19,164 s.y.

RECORD PLANS MATERIALS

SUB BASE OF GRAVEL-MONROE PIT-BRISTOL, VT.	REINF. CONC. PIPE-VI. CONCRETE PIPE CO-WINDSOR, VT.
SUB BASE OF SAND-BURNETT & CAMPBELL PIT-WILLISTON, VT.	ACCUM. MET. PIPE-NE. METAL PIPE CO-BOSTON, MASS.
PEA STONE-L.A. DEMERS PLANT-WINDSOR, VT.	CABLE GUARD RAIL-BEITHEHEM STEEL CO.
CUTBACK ASPHALT-F.R. DILLON CO.-E. PROVIDENCE, R.I.	GR. NAIL PAINT-GE. BRADLEY LAB-BRATTLEBORO, VT.
MAG-DRAIN BASE COURSE-2-37 WARNER, FERRISBURG, VT.	STRUCTURAL & REINFORCING STEEL-VERMONT STRUCTURAL STEEL CO-BURLINGTON, VT.
BIT. CONC. CURB-VT. PAVING CO. PLANT-BURLINGTON, VT.	CEMENT-LONE STAR CEMENT CO.-HUDSON, N. Y.

CONTRACTOR-BURNETT & CAMPBELL-BURLINGTON, VT.	CONTRACT DATED-AUGUST 21, 1958.
RESIDENT ENGINEER-M. VAN KLEEF JR.	CONTRACT STARTED-AUGUST 25, 1958.
INSPECTOR-J. S. PHILBRICK	CONTRACT COMPLETED-AUGUST 12, 1959.
RECORD PLANS-A.G. SPIDLE & W.F. MURPHY.	CONTRACT ACCEPTED-AUGUST 12, 1959.

CONVENTIONAL SIGNS

COUNTY LINE	-----
TOWN LINE	-----
FORMER LINE	-----
STONE WALL	-----
UNFENCED PROPERTY	-----
GUARD RAIL	-----
TRAVELLED WAY	-----
RAILROAD	-----
RETAINING WALL	-----
CENTER LINE	-----
SURVEY LINE	-----
CULVERT	-----
DROP INLET	-----
TROLLEY POLE	-----
POWER POLE	-----
TELEPHONE POLE	-----
TREES	-----
WEDGES	-----

TITLE
TYPICAL
PLAN
PROFILE HORIZONTAL
VERTICAL
CROSS-SECTIONS

PROJECT
FERRISBURG
SHEET NO. 1288
DATE
JULY 25, 1958

CONTRACTOR
BURNETT & CAMPBELL
BURLINGTON, VERMONT
YEAR 1958-59
Location Beginning at a point 2,990 feet from the Vergennes-Ferrisburg Town Line and extending northerly 6,800 feet.

APPROVED [Signature] DATE July 25, 1958
APPROVED [Signature] DATE July 22, 1958
APPROVED [Signature] DATE July 22, 1958
APPROVED [Signature] DATE July 22, 1958
APPROVED [Signature] DATE July 22, 1958

THESE PLANS ARE SUBJECT TO SUCH REVISIONS AS MAY BE REQUIRED BY THE BUREAU OF PUBLIC ROADS ON THE COMMISSIONER OF HIGHWAYS
CONSTRUCTION IS TO BE CARRIED OUT IN ACCORDANCE WITH THE PLANS AND THE STANDARD SPECIFICATIONS FOR HIGHWAY & BRIDGE CONSTRUCTION OF JANUARY 1956, SUBMITTED TO THE BUREAU OF PUBLIC ROADS FOR APPROVAL ON APRIL 9, 1956 INCLUDING ALL SUBSEQUENT APPROVED REVISIONS & SUCH REVISED SPECIFICATIONS & SPECIAL PROVISIONS AS ARE SUBMITTED WITH THE PLANS.

DEPARTMENT OF COMMERCE
BUREAU OF PUBLIC ROADS

APPROVED _____
DIVISION ENGINEER _____
SHEET 1 OF 77
SHEETS 77
REGISTERED PROFESSIONAL ENGINEER
50, BURLINGTON, VERMONT

RIGHT-OF-WAY DIVISION
TOWN FILE
PERPETUAL
Town of Ferrisburg
U.S. 7
(To Be Returned To R.O.W. Division)

STEARNS R. JENKINS
US 7

INDEX OF SHEETS

SHEET NO.	TITLE PAGE
1	TITLE PAGE
2	TYPICAL CROSS-SECTION OF IMPROVEMENT 3" BITUMINOUS CONCRETE PAVEMENT AND QUANTITY SHEET.

PROJECT NAME & NUMBER FERRISBURG F 019-4(5)	TYPE BIT. CONC. PAVT	PAVEMENT AREA 10,443 S.Y.
RECORD PLANS		
MATERIALS		
CRUSHED GRAVEL - HINESBURG SAND & GRAVEL CO. - HINESBURG, VERMONT.	PEA STONE - DEMERS QUARRY - WINDSKI, VERMONT.	REFINED TAR - KOPPERS CO. - EVERETT, MASS.
CUTBACK ASPHALT - ESSO STANDARD OIL CO. - EVERETT, MASS.	ASPHALT 85/100 PEN. - MOBIL OIL CO. - ALBANY, NEW YORK.	BITUMINOUS CONCRETE - VERMONT PAVING CO. INC. - WILLISTON, VERMONT.
CONTRACTOR - VERMONT PAVING CO. INC.	CONTRACT DATED - AUGUST 21, 1959.	CONTRACT STARTED - SEPTEMBER 2, 1959.
DESIGN ENGINEER - R. J. FUNK.	CONTRACT COMPLETED - OCTOBER 8, 1959.	CONTRACT ACCEPTED - OCTOBER 8, 1959.
RECORD PLANS - H. A. HEALD		

STATE OF VERMONT
DEPARTMENT OF HIGHWAYS

PROPOSED IMPROVEMENT

FEDERAL AID PROJECT

TOWN OF FERRISBURG
COUNTY OF ADDISON
U.S. ROUTE 7
CHARLOTTE-VERGENNES ROAD

BEGINNING AT A POINT 2,999.0 FEET NORTH OF THE VERGENNES-FERRISBURG TOWN LINE AND EXTENDING NORTHERLY 6,800.0 FEET.

LENGTH OF PROJECT 6,800.0 FEET = 1.288 MILES

DESIGNATION	ADT (1955)	ADT (1975)	DHV (1975)
D	2750 - 3270	4400 - 5240	575 - 665
T	59%	7 1/2%	
V	60 M.P.H.		

REGION	STATE	PROJECT NO.	SHEET NO.	TOTAL SHEETS
VT	F 019-4(5)	434	1	2

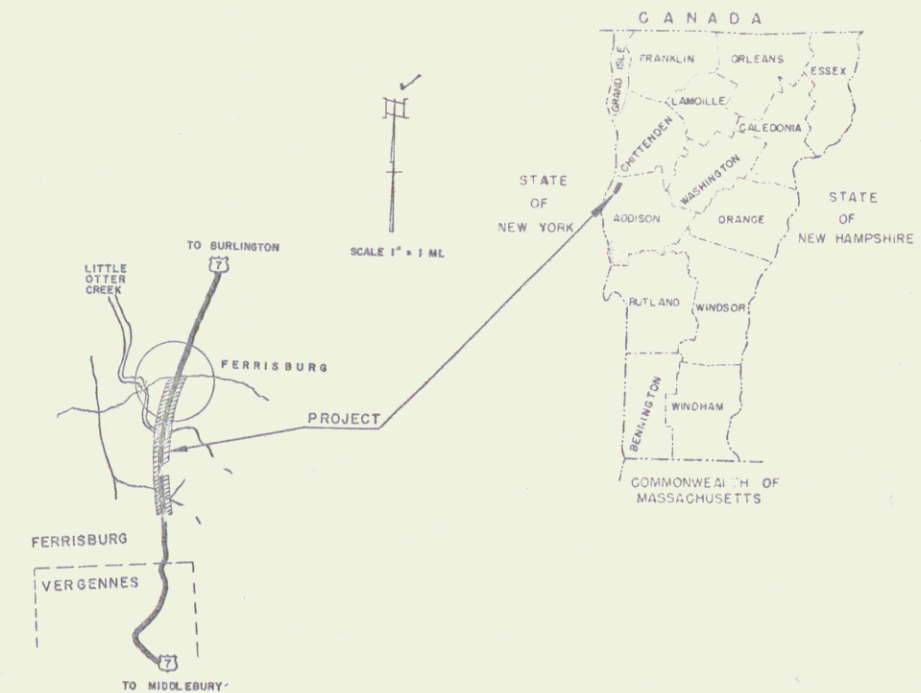

RIGHT-OF-WAY DIVISION
TOWN FILE

PERPETUAL

Town of U.S.7
(To Be Returned To R.O.W. Division)

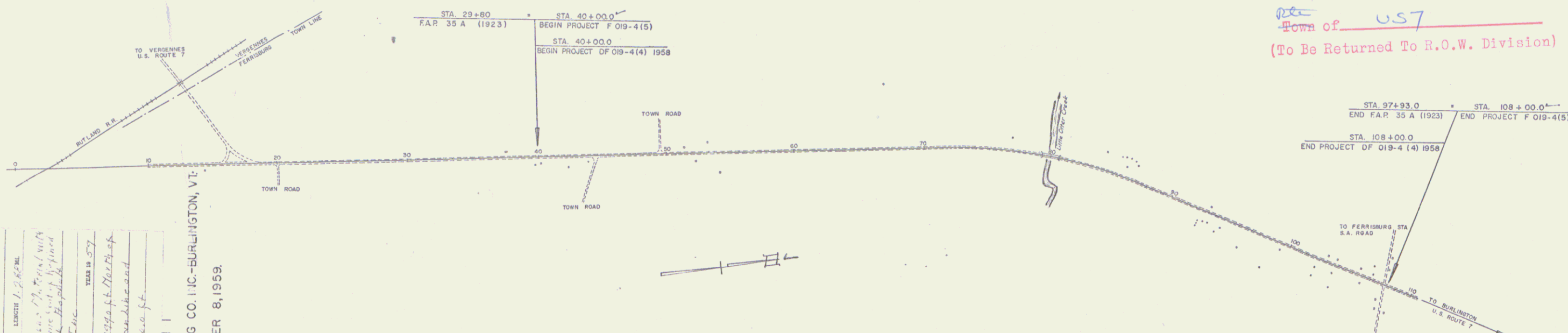

ITEM	QUANTITY	UNIT
COUNTY		
TOWN		
FENCE		
STONE		
UNFEND		
GUARD		
TRAVEL		
RAILRO		
RETAIN		
CENTER		
SURVEY		
GULVER		
DROP		
TROLLE		
POWER		
TELEPH		
TREES		
HDGE		

ITEM	QUANTITY	UNIT
GROUND ELEVATION		DATUM
GRADE ELEVATION		DATUM
CURVE DATA		
DEFLECTION OF ANGLE	Δ	
DEGREE OF CURVE	D	
RADIUS OF CURVE	R	
TANGENT DISTANCE	T	
LENGTH OF CURVE	L	
EXTERNAL DISTANCE	E	
POINT OF INTERSECTION	P.I.	
POINT OF CURVE	P.C.	
POINT OF TANGENT	P.T.	
POINT ON TANGENT	P.O.T.	
POINT ON SUB-TANGENT	P.O.S.T.	

SCALE	PLAN	PROFILE	CROSS-SECTIONS
1" = 400'	1" = 5'	1" = 1"	1" = 1"

THESE PLANS ARE SUBJECT TO SUCH REVISIONS AS MAY BE REQUIRED BY THE BUREAU OF PUBLIC ROADS OR THE COMMISSIONER OF HIGHWAYS.

CONSTRUCTION IS TO BE CARRIED ON IN ACCORDANCE WITH THE PLANS AND THE STANDARD SPECIFICATIONS FOR HIGHWAY AND BRIDGE CONSTRUCTION OF JANUARY 1958 SUBMITTED TO THE BUREAU OF PUBLIC ROADS AS APPROVED JULY 5, 1958, INCLUDING ALL SUBSEQUENT APPROVED REVISIONS AND SUCH REVISED SPECIFICATIONS AND SPECIAL PROVISIONS AS ARE SUBMITTED WITH THE PLANS.

NOTES: ANY FURTHER INFORMATION CONCERNING FINAL QUANTITIES, AMOUNTS OR OTHER DETAILS RELATIVE TO THIS PROJECT MAY BE FOUND IN EITHER THE FIELD BOOKS OR THE ESTIMATE FILE.

APPROVED	APPROVED	APPROVED	APPROVED	APPROVED	APPROVED
SECONDARY ENGINEER	CONSTRUCTION ENGINEER	BRIDGE ENGINEER	DESIGNER	HIGHWAY ENGINEER	CHECKER
	<i>E. H. Hickney</i>		<i>Walter Smith</i>	<i>E. M. Leno</i>	<i>R. E. Johnson</i>
DATE	DATE <u>July 27, 1959</u>	DATE	DATE <u>July 13, 1959</u>	DATE <u>July 27, 1959</u>	DATE <u>July 27, 1959</u>

DEPARTMENT OF COMMERCE BUREAU OF PUBLIC ROADS		
APPROVED	ENGINEER	DATE
PROJECT	F	NO 019-4 (5)
SHEET	1A	OF 2 SHEETS

WESTER-MARTIN, INC.
8-57

WESTER-MARTIN, INC.
8-57

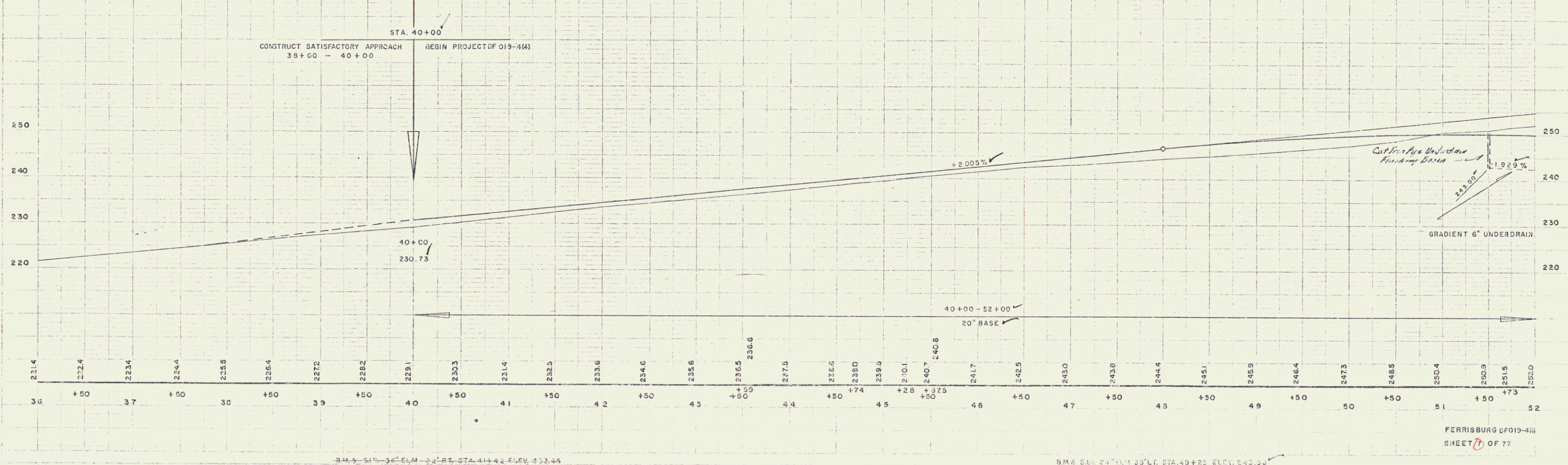
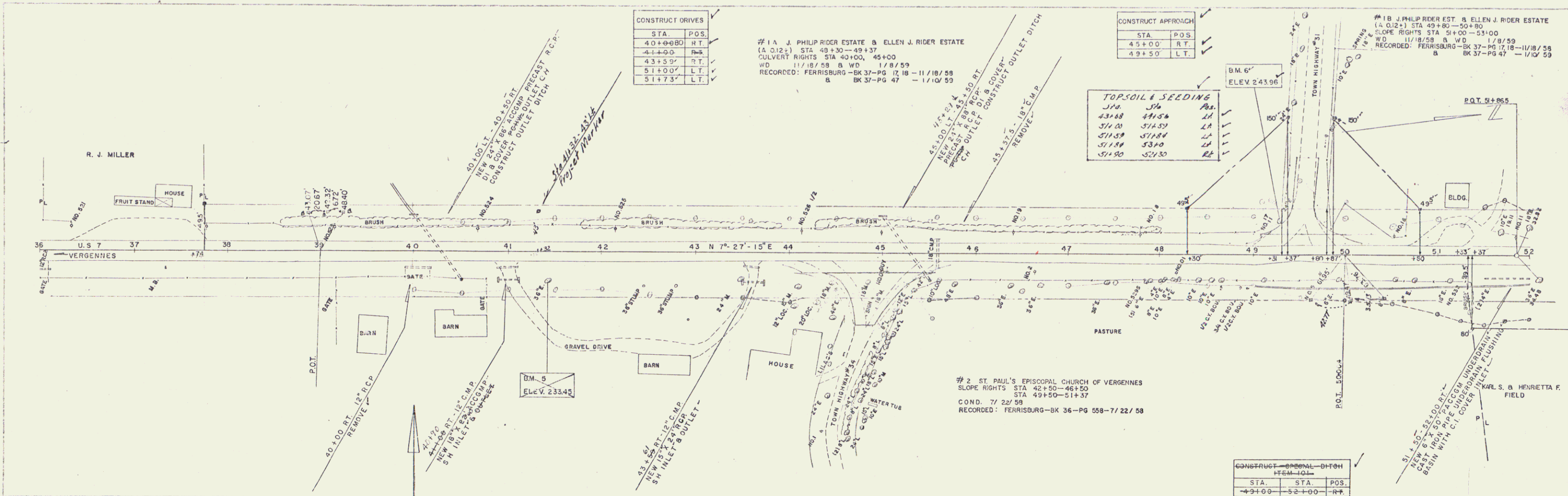

BM 5 36+50 - 36+50 ELEV. 233.44

BM 6 51+73 - 51+73 ELEV. 245.93

FERRISBURG OF 019-444
SHEET 7 OF 77

PARCEL INSTRUMENT DATE GRANTOR GRANTEE RECORDED FERRISBURG BOCK PAGE DATE REMARKS

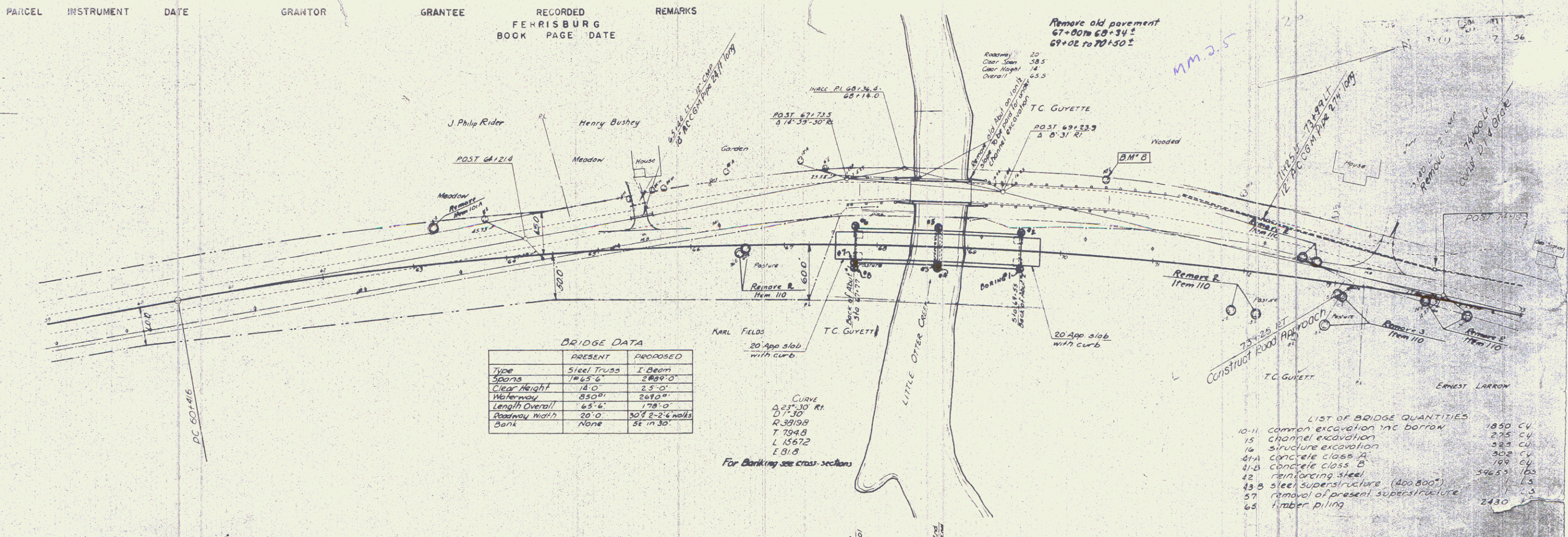

BRIDGE DATA

	PRESENT	PROPOSED
Type	Steel Truss	I-Beam
Spans	7x15'-6"	2x30'-0"
Clear Height	18'-0"	23'-0"
Highway	85.0'	24.0'
Length Overall	125'-6"	178'-0"
Roadway Width	20'-0"	30'-0" 2-2'-6" walks
Bank	None	5' in 30'

CURVE
 $\Delta 23.10$ RT
 $D 7.30$
 $R 39.99$
 $T 79.49$
 $L 156.72$
 $E 0.0$
 For Banking see cross-sections

- LIST OF BRIDGE QUANTITIES
- 10-11 common excavation inc borrow 1850 CY
 - 15 channel excavation 275 CY
 - 16 structure excavation 383 CY
 - 41A concrete class B 302 CY
 - 41B concrete class B 199 CY
 - 42 reinforcing steel 546.5 lbs
 - 43B steel superstructure (200,800') 13
 - 57 removal of present superstructure 3
 - 65 timber piling 2430 L

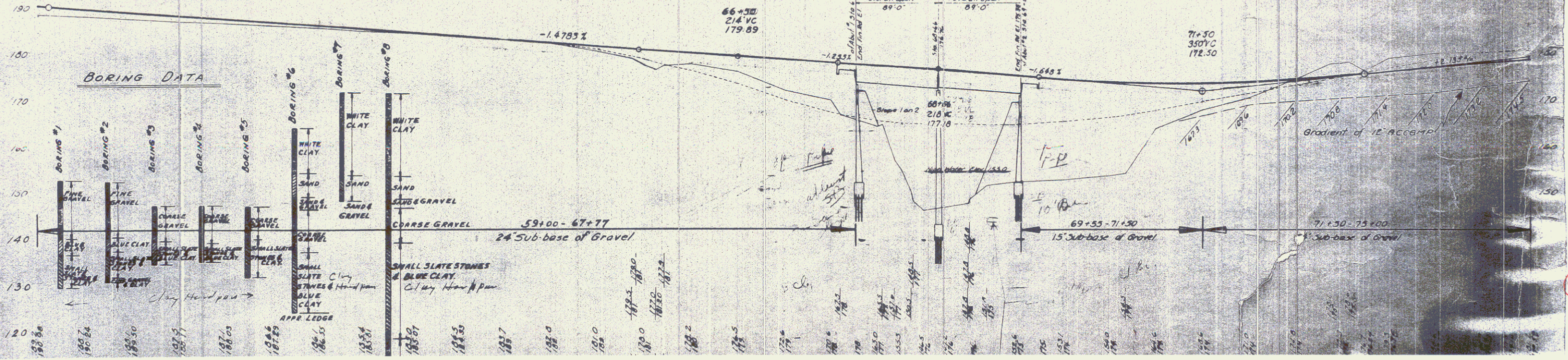

9A

6

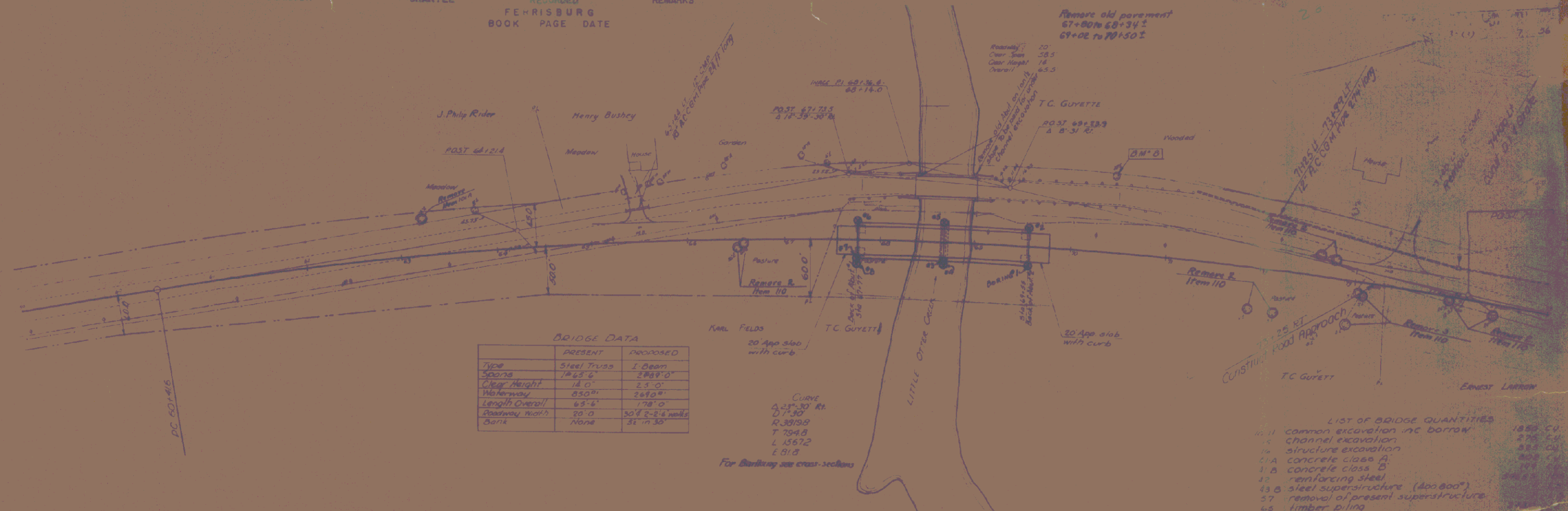

BRIDGE DATA

	PRESENT	PROPOSED
Type	Steel Truss	I Beam
Spans	7x65' 6"	2x88' 0"
Clear Height	14' 0"	23' 0"
Waterway	250' 0"	260' 0"
Length Overall	625' 0"	178' 0"
Passway Width	20' 0"	30' 0" 2-2.4' wide
Banks	None	31' 7" 30"

- LIST OF BRIDGE QUANTITIES
- 10-1 common excavation inc borrow 1850 cu
 - 4 channel excavation 275 cu
 - 16 structure excavation 850 cu
 - 51A concrete class A 185 cu
 - 11A concrete class B 800 cu
 - 15 reinforcing steel 185 cu
 - 43 steel superstructure (400 800") 185 cu
 - 57 removal of present superstructure 275 cu
 - 45 timber piling 275 cu



WESTER-MARTIN, INC. 12-27-58

WESTER-MARTIN, INC. 12-27-58

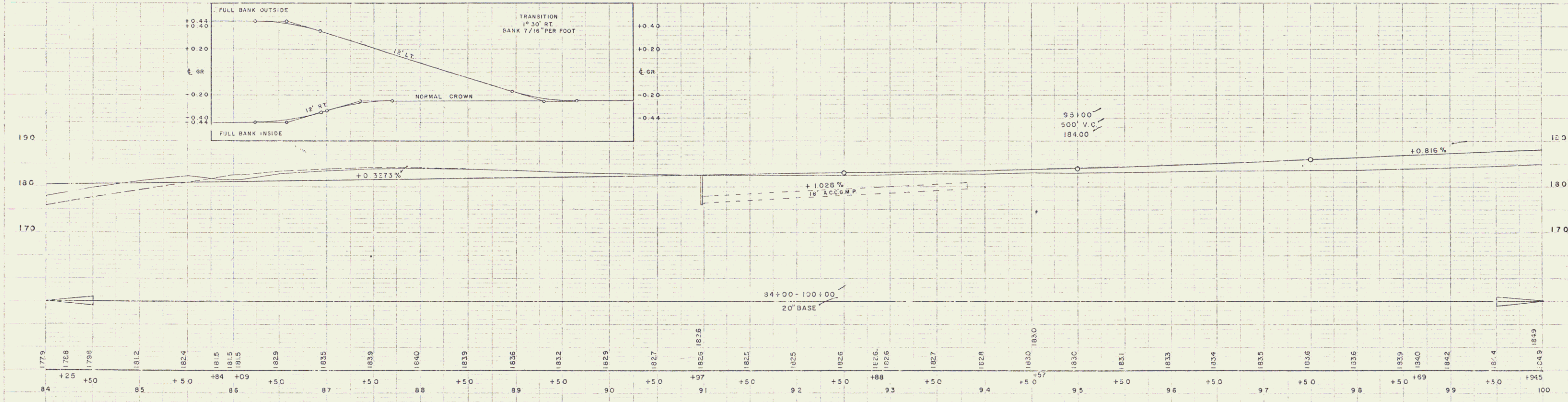
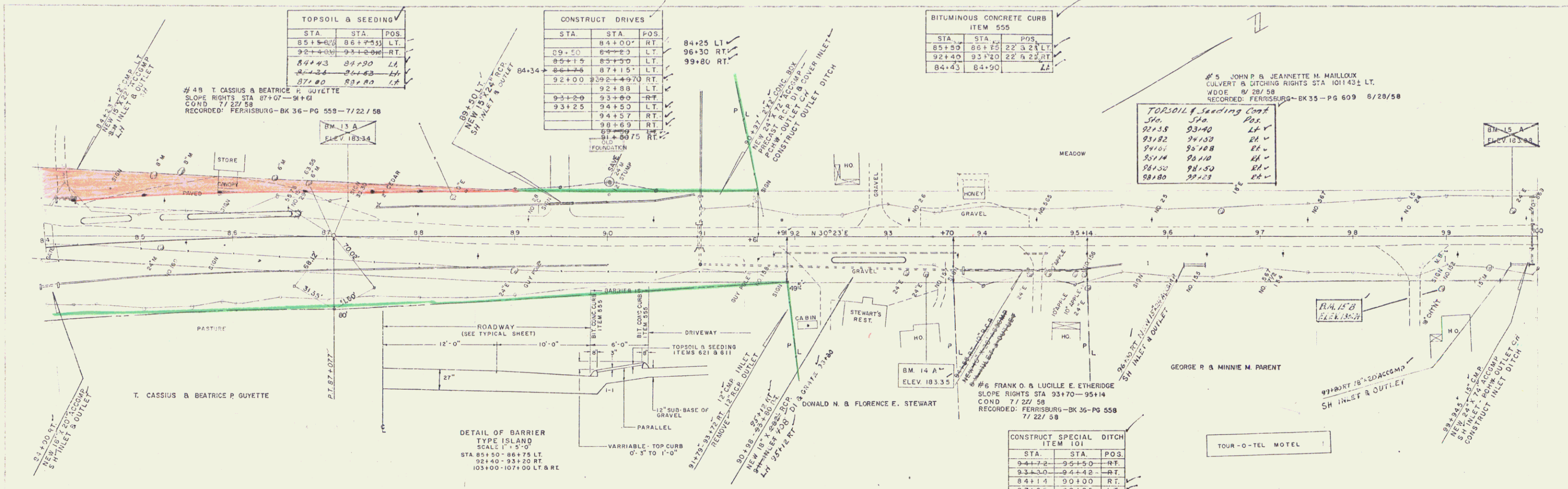

BM 13A 2 1/2' ELEV 183.34

BM 14A 1 R 2 1/2' ELEV 183.35

FERRISBURG OF 019-4(4)
SHEET 10 OF 77
B.M. 15-B SURV. Chestnut Sta 98+13 ELEV. 185.91

4A T. CASSIUS & BEATRICE P. GUYETTE
 STA. U.S. 7 78+00 100' RT. - STA. U.S. 7 91+91 50' RT.
 1.76 ACRES ± COND. 7/22/58
 RECORDED: FERRISBURG, BOOK 36, PAGE 558, 7/22/58

4B T. CASSIUS & BEATRICE P. GUYETTE
 STA. U.S. 7 87+07 - STA. U.S. 7 91+61
 SLOPE RTS. COND. 7/22/58
 RECORDED: FERRISBURG, BOOK 36, PAGE 558, 7/22/58

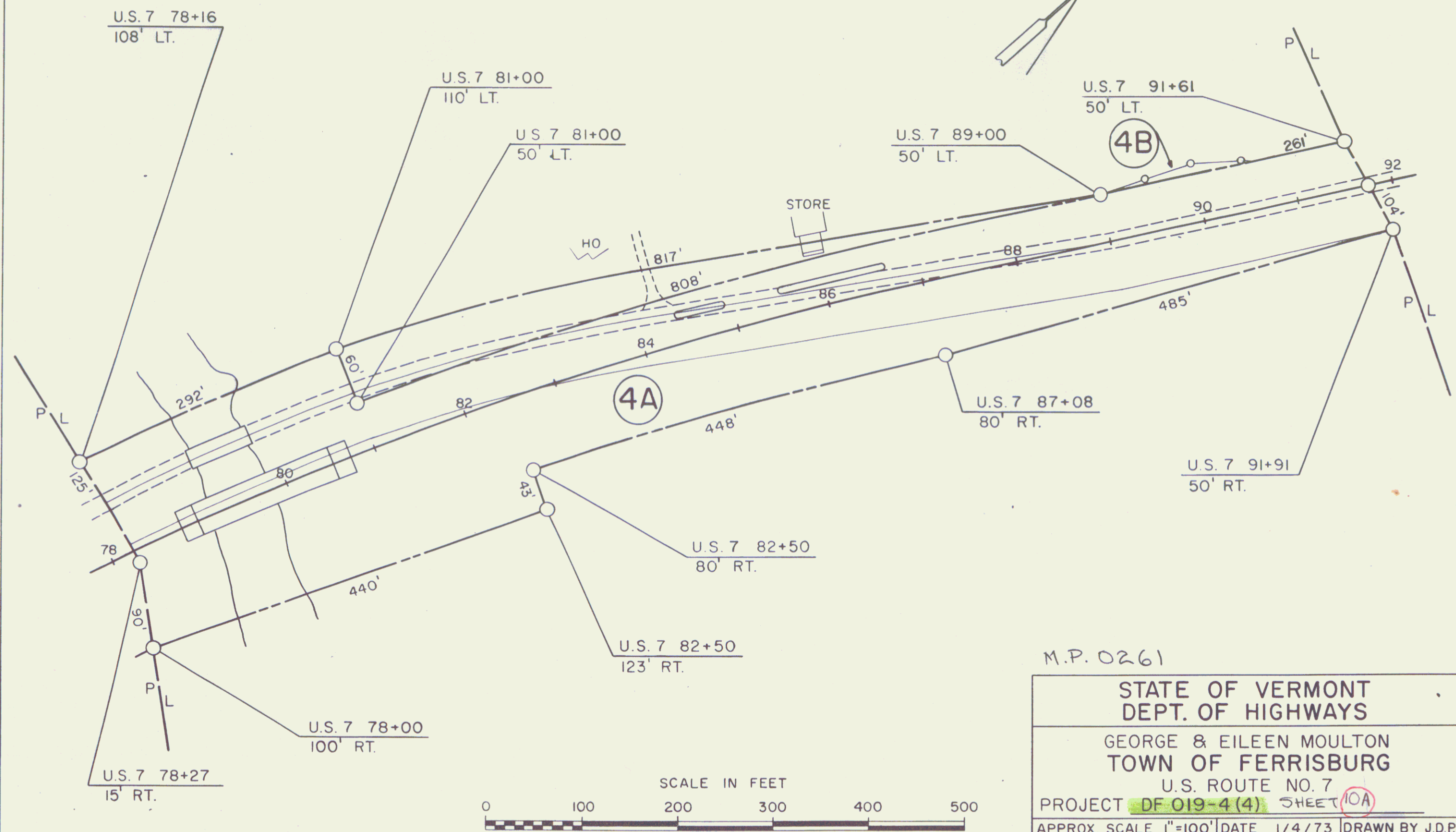

CONSTRUCT DRIVES	STA	STA	POS
	102+70	103+115	RT
	103+15	103+50	RT
	103+35	104+30	LT
	103+50	104+80	RT
	104+70	105+15	LT
	105+50	107+00	RT
	107+10	107+40	RT
	108+00	108+16	RT

CONSTRUCT APPROACH	LT. & RT.
107+99.7 RT	108+00

TOPSOIL & SEEDING	STA	STA	POS
	103+50	103+50	LT
	103+50	104+50	RT
	103+50	104+50	RT
	104+35	104+35	LT
	104+35	105+35	RT
	105+15	106+05	LT
	106+15	107+10	RT
	107+29	107+52	LT
	107+40	108+05	RT
	107+87	108+75	LT
	108+40	108+75	RT
	107+33	108+30	RT
	108+50	108+75	RT

BITUMINOUS CONCRETE CURB	ITEM 555	STA	STA	POS
		103+13	103+43	22' & 28' LT
		103+50	104+50	22' & 28' RT
		104+13	104+43	22' & 28' LT
		104+13	104+43	22' & 28' RT
		104+85	105+15	22' & 28' RT
		106+13	107+10	22' & 28' RT
		107+13	107+43	22' & 28' RT
		107+40	108+45	RT
		108+40	108+75	LT
		108+40	108+75	RT

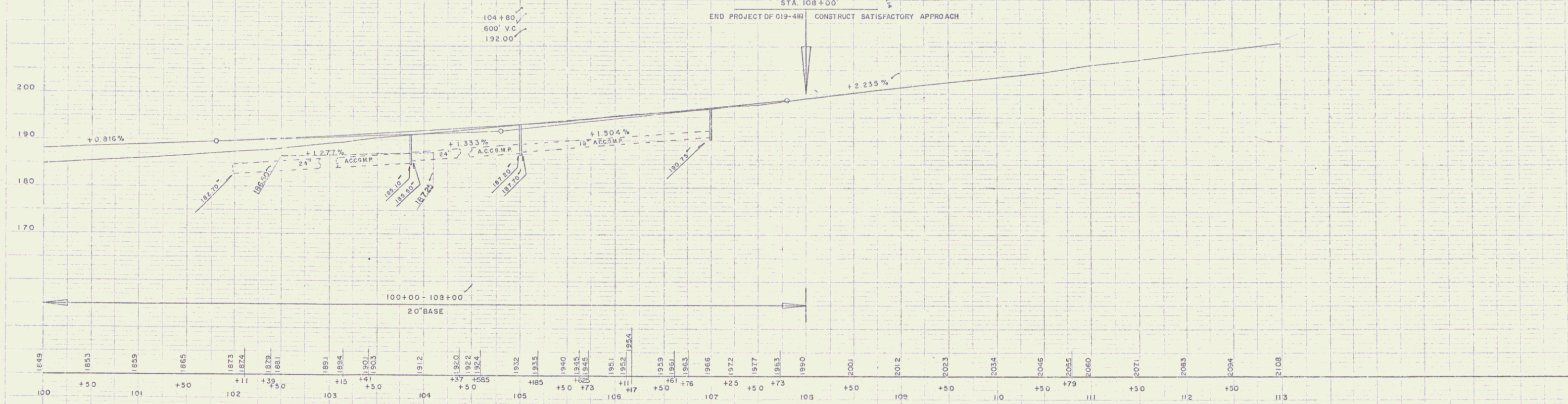
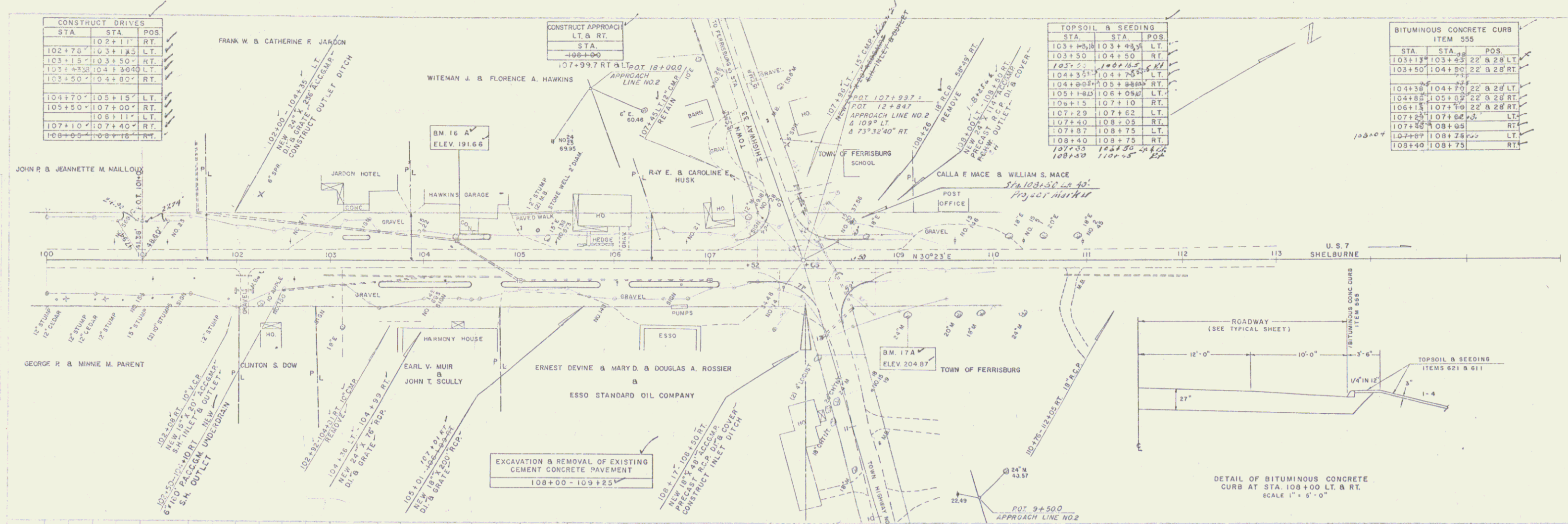

WEBSTER-MARTIN, INC.
12-57
WEBSTER-MARTIN, INC.

WEBSTER-MARTIN, INC.
12-57
WEBSTER-MARTIN, INC.

FERRISBURG 019-4W
SHEET 11 OF 77

10