

CONSTRUCT DRIVES	STA	STA	POS
	102+70	103+115	RT
	103+15	103+50	RT
	103+35	104+30	LT
	103+50	104+80	RT
	104+70	105+15	LT
	105+50	107+00	RT
	107+10	107+40	RT
	108+00	108+16	RT

CONSTRUCT APPROACH	LT. & RT.
107+99.7 RT	108+00

TOPSOIL & SEEDING	STA	STA	POS
	103+50	103+50	LT
	103+50	104+50	RT
	103+50	104+50	RT
	104+35	104+35	LT
	104+35	105+35	RT
	105+15	106+05	LT
	106+15	107+10	RT
	107+29	107+52	LT
	107+40	108+05	RT
	107+87	108+75	LT
	108+40	108+75	RT
	107+33	108+30	RT
	108+50	108+75	RT

BITUMINOUS CONCRETE CURB	ITEM 555	STA	STA	POS
		103+13	103+43	22' @ 28' LT
		103+50	104+50	22' @ 28' RT
		104+13	104+43	22' @ 28' LT
		104+13	104+43	22' @ 28' RT
		104+85	105+15	22' @ 28' RT
		106+13	107+10	22' @ 28' RT
		107+13	107+43	22' @ 28' RT
		107+40	108+45	RT
		108+40	108+75	LT
		108+40	108+75	RT

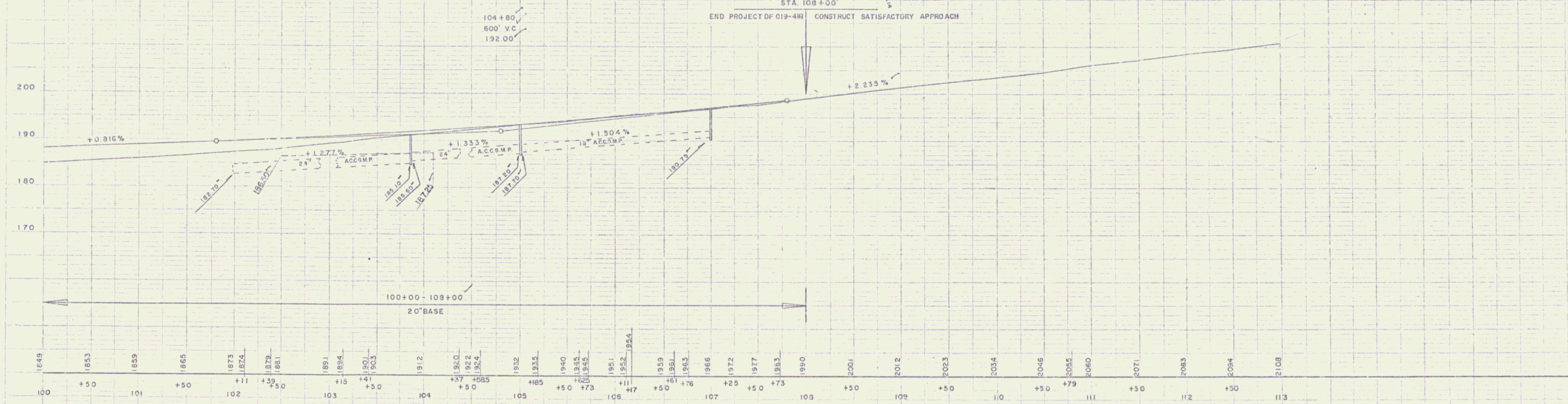
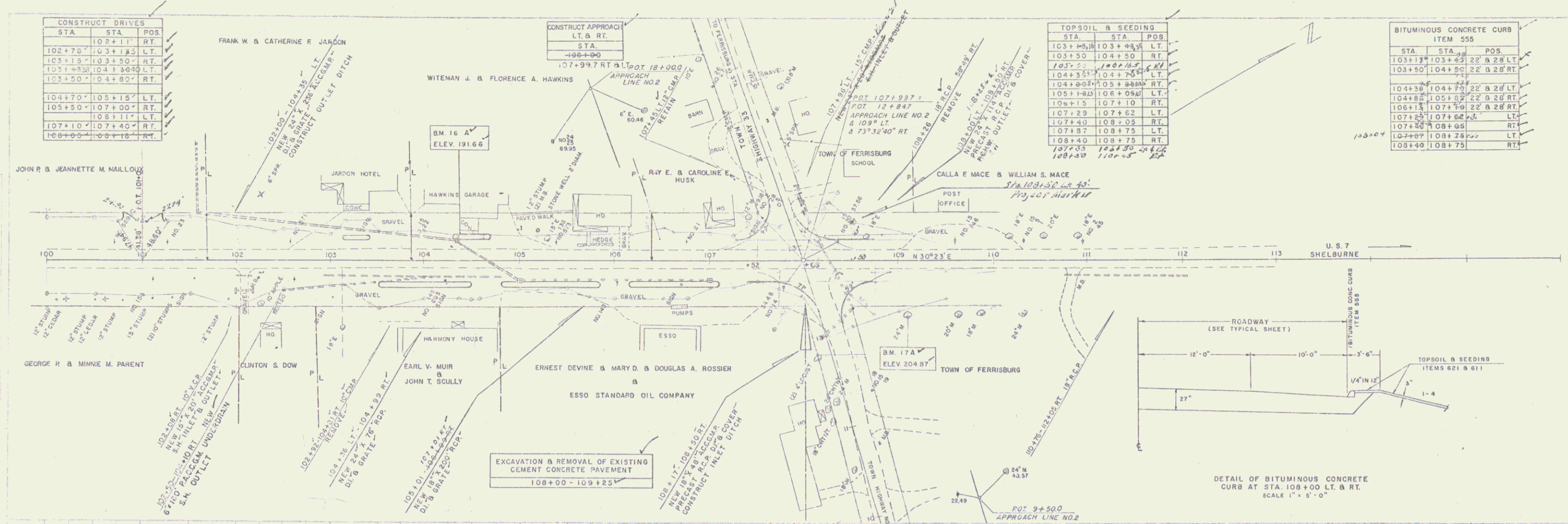

WEBSTER-MARTIN, INC.  
12-57  
WEBSTER-MARTIN, INC.

WEBSTER-MARTIN, INC.  
12-57  
WEBSTER-MARTIN, INC.

FERRISBURG PD 19-4W  
SHEET 11 OF 77

10