

FED. ROAD DIST. NO.	STATE	FISCAL YEAR	SHEET NO.	TOTAL SHEETS
8	VT	1938	16	46

(cont.)

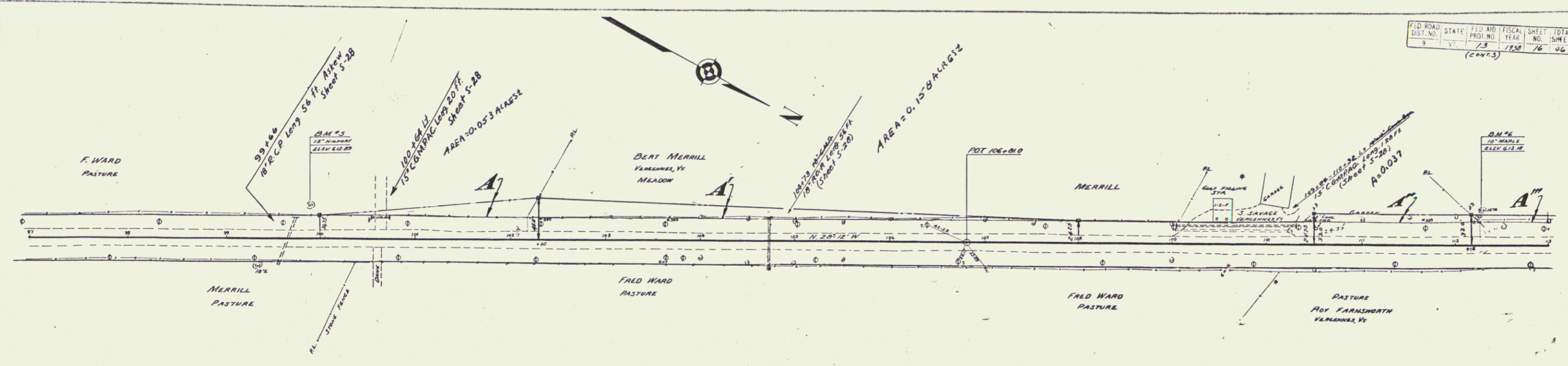

PARCEL	INSTRUMENT	DATE	GRANTOR	GRANTEE	RECORDED	REMARKS
A	G.C.D.	8-6-37	F.C. WARD	ST. OF VT.	24	NEW HAVEN DATE 9-13-37
A'	G.C.D.	7-26-37	B.S. STELLA MERRILL	-	24	666 7-30-37
A''	G.C.D.	7-26-37	BERNARD SEYMOUR SAUSAGE	-	24	662 7-30-37 COL. STA. 95109
A'''	G.C.D.	7-23-37	ROY E. FARNSWORTH	-	24	660 7-30-37
					24	663 7-30-37

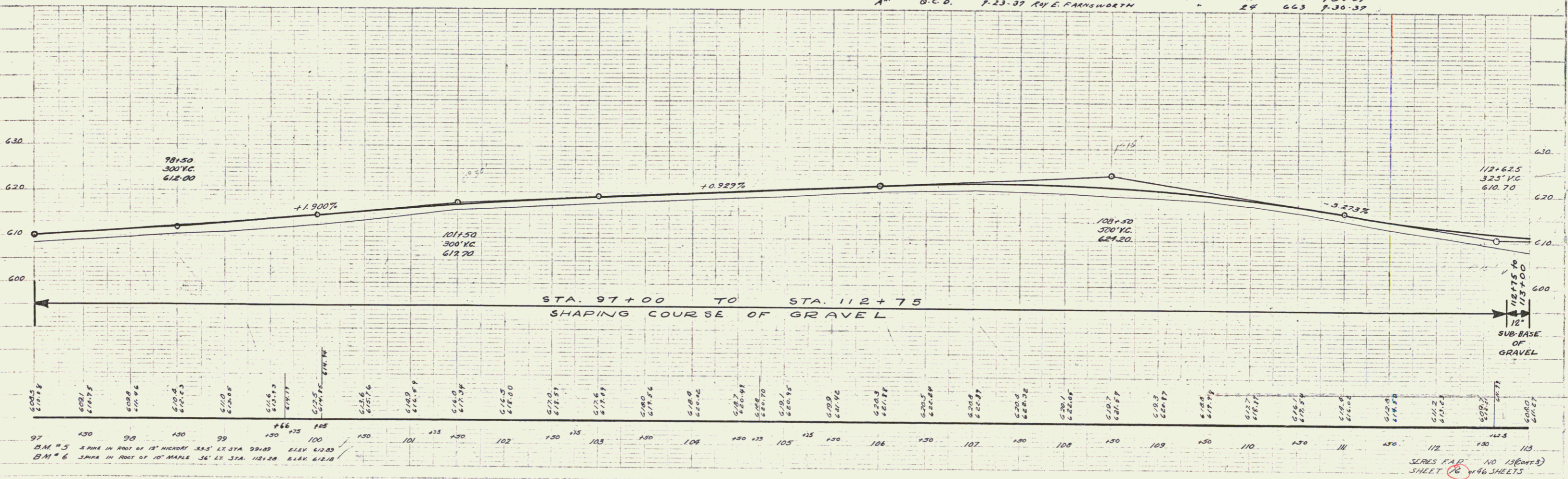

STATION	ELEVATION	STATION	ELEVATION
97	600.00	100	612.70
98	605.00	101	614.00
99	610.00	102	615.00
100	615.00	103	616.00
101	618.00	104	617.00
102	619.00	105	618.00
103	620.00	106	619.00
104	621.00	107	620.00
105	622.00	108	621.00
106	623.00	109	622.00
107	624.20	110	623.00
108	625.00	111	624.00
109	626.00	112	625.00
110	627.00	113	626.00
111	628.00		
112	629.00		
113	630.00		

SERIES F.A.P. NO. 13 (cont.)  
SHEET 16 OF 46 SHEETS