

STEEL GUIDE POSTS 345+0
 Station - Station Side U.S.
 3440 - 3514 Lf 7
 4115 - 4454 Lf 15

STEEL WIRE POSTS 345+0
 Station Lf. Rf.
 35+70 1 1
 38+0 1 1

THREE CABLE GUARD RAIL
 WITH STEEL POSTS-ITEM 543
 35+97 35+08 - 37+01 Rf
 35+00 - 37+20 Lf

Bench Mark Nos
 R.R. spike in
 12" Poplar
 Elev. 282.59
 Sta. 38+55
 125' Lf

BIT GROUTED STONE GUTTER-ITEM 553
 34+00 - 35+22 Rf 35+15
 32+86 - 40+00 RE 34+0 - 34+15 Lf
 34+05 - 45+25 Lf. SRE 43+80 - 45+07 Lf
 45+25 - 50+00 Rf 1 ft
 STONE FILL FOR SLOPE PROTECTION-ITEM 522
 36+43 - 37+03 Rf
 39+71 - 40+31 Rf

500 REMOVAL-ITEM 101-A
 34+40 - 34+80

CONSTRUCT DRIVES
 45+25 Lf
 34+15 Rf, 46+56 Rf.
 EDMUND L. B. AURELIA M. KELTON

BOUNDARY MxRS. Item 507
 Station Offset Lf. Rf.
 47+22 110'
 47+22 110'

#10 LEGRAND H. GORHAM
 (A-4-90) STA 37+58 - 47+91
 CHANNEL RIGHTS STA 35+48 - 44+30 47+85
 - SEE #1A

Curve Data
 A=23' 11" 11'
 D=17' 30" 15'
 K=148.78 75'
 T=113.88 57'
 L=232.54'
 E=106.00'
 Bank 1/2" per ft

PLAN	DATE	BY	CHECKED
PROJ. NO.	DATE	BY	CHECKED
REV. NO.	DATE	BY	CHECKED
REV. NO.	DATE	BY	CHECKED

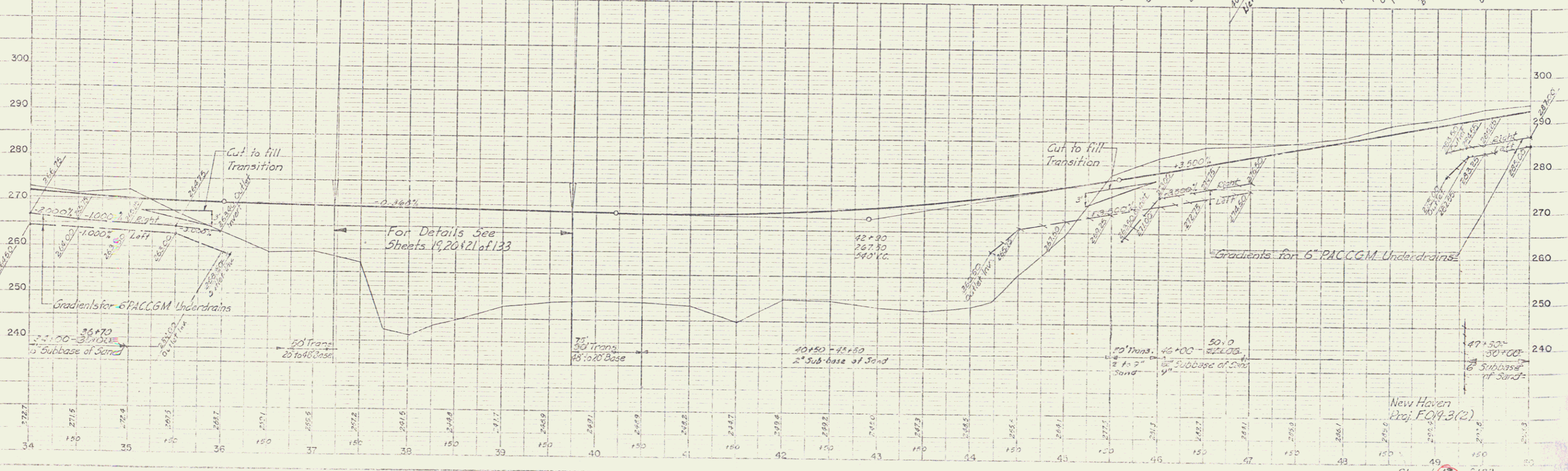
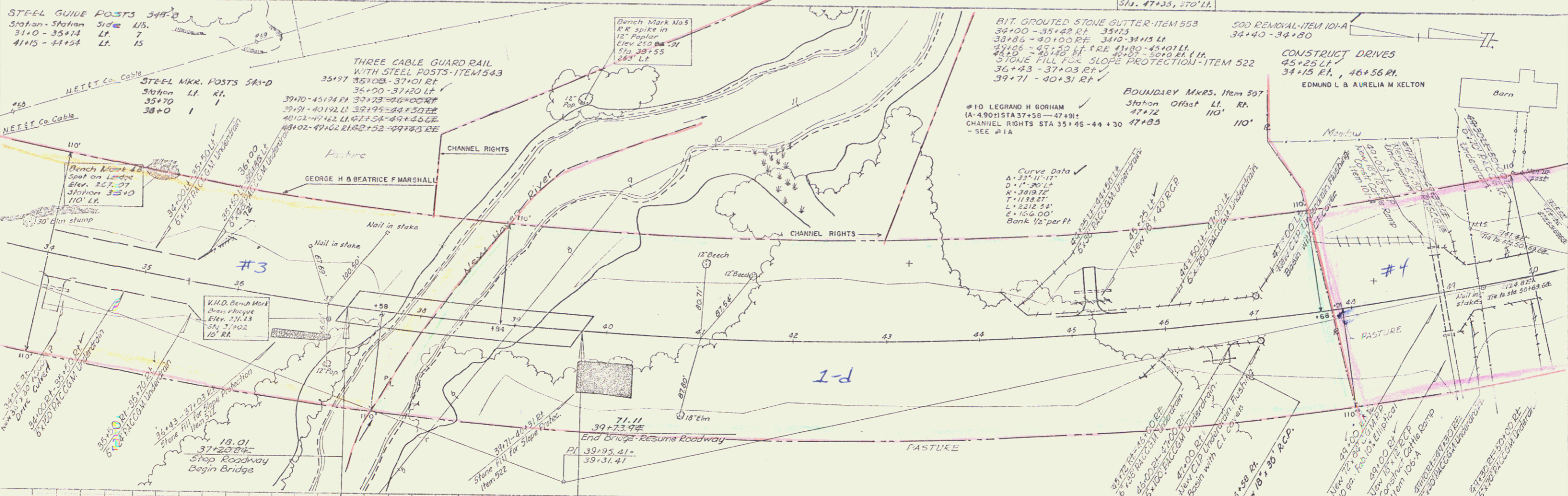

New Haven
 Proj. FQ9-3(2)

Sheet 13 of 13

4