

WOOD BURIED RAIL REQUIRED  
 RIGHT  
 STA 123+88 TO 124+12 LENGTH 24 FT.  
 LEFT  
 STA 124+10 TO 124+34 LENGTH 24 FT.  
 TOTAL THIS SHEET 48 FT.

NEW CULVERTS REQUIRED  
 STA 124+12 18" REIN. CONCRETE PIPE 40' LONG<sup>76</sup>.  
 CLASS A (1-2-4) CONCRETE 1.7 CY.  
 REINFORCING STEEL 600 LB.

DATE	BY	CHKD	APP'D
11/27	W.E.W.		

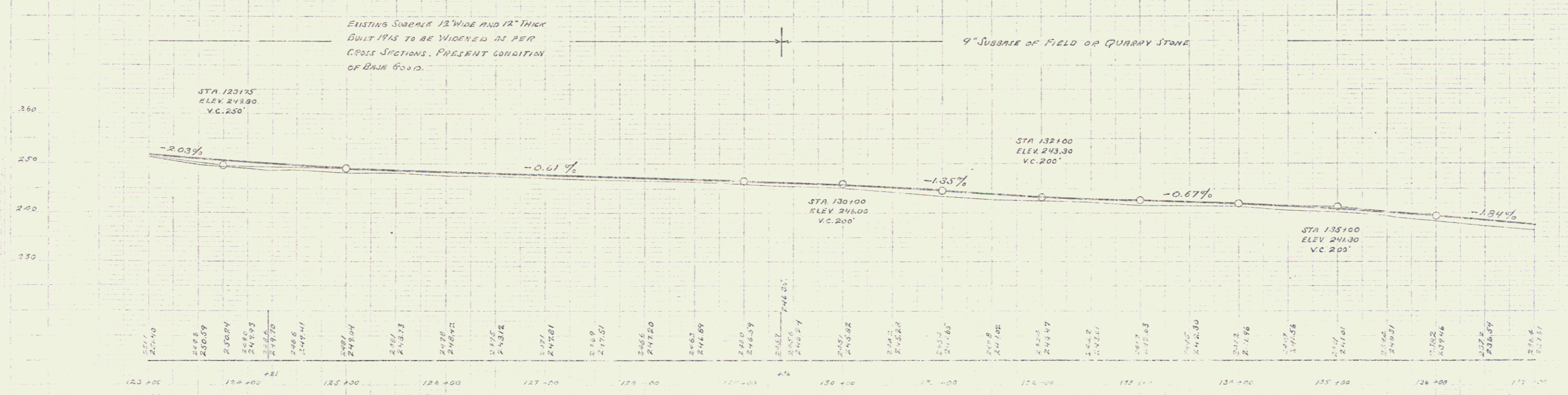
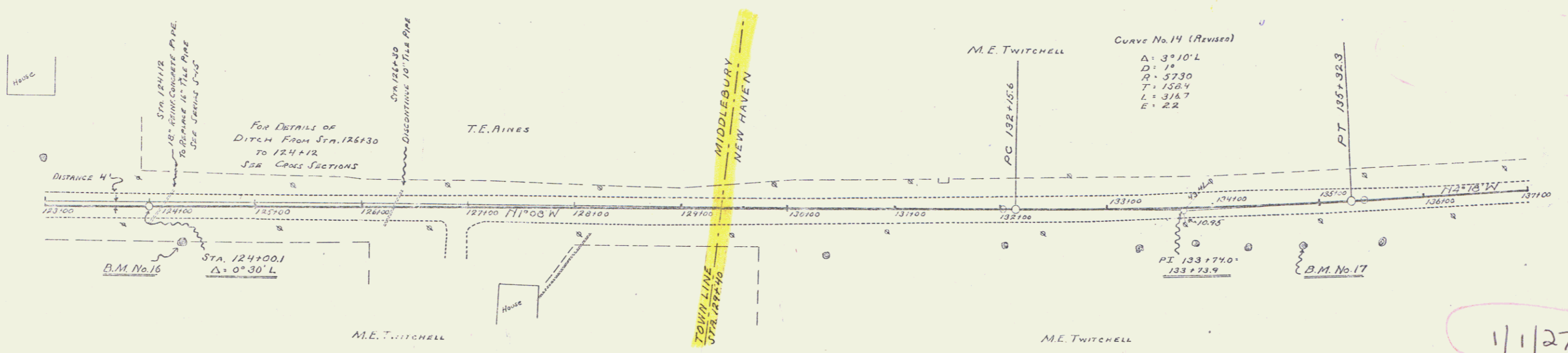

NO. 16 RIGHT STA 124+12 SPIKE IN POINT OF THREE FEET ELEVATION 240.45  
 NO. 17 RIGHT STA 134+05 SPIKE IN 4" ELM. ELEVATION 239.81

11/27

Sheet 0662

10