

Wood Guard Rail Required  
 Right  
 STA 17+26 TO 17+50 LENGTH 24 FT.  
 STA 19+42 TO 19+66 LENGTH 24 FT.  
 TOTAL THIS SHEET 48 FT.

**NOTE**  
 PAMPHLET K ITEM 48 AND 49  
 BIDS AS RECEIVED ARE TO BE FOR REINFORCED  
 CONCRETE PIPE OR CAST IRON PIPE

COBBLE BUTTER REQUIRED  
 STA 17+80 TO 18+10 145.9 YDS.

**NEW CULVERTS REQUIRED**

STA 17+38	24" REINF. CONCRETE PIPE	LENGTH 44 FT.
	CLASS A (1-2-4) CONCRETE	1.6 CY
	CLASS B (1-2-5) CONCRETE	2.1 CY
	REINFORCING STEEL	135 LBS.
STA 19+31	24" REINF. CONCRETE PIPE	LENGTH 60 FT.
	CLASS B (1-2-5) CONCRETE	5.4 CY
	REINFORCING STEEL	50 LBS.
STA 25+00	18" REINF. CONCRETE PIPE	LENGTH 48 FT.
	CLASS A (1-2-4) CONCRETE	8.0 CY
	CLASS B (1-2-5) CONCRETE	1.4 CY
	REINFORCING STEEL	163 LBS.

**NEW CULVERTS REQUIRED**  
 STA 21+55 RIGHT 12" COBBLER METAL PIPE LENGTH 32 FT.  
 CLASS B (1-2-5) CONCRETE 1.5 CY  
 REINFORCING STEEL 33 LBS.

**CULVERTS REQUIRING REPAIRS**  
 STA 23+35 NEW HEADWALL DRIVE CULVERT  
 CLASS B (1-2-5) CONCRETE 1.5 CY  
 REINFORCING STEEL 33 LBS.

Existing Pavement up to Sta. 16+90  
 is Bituminous Macadam built in 1906.  
 Pavement 15.5' wide. Condition of present good.

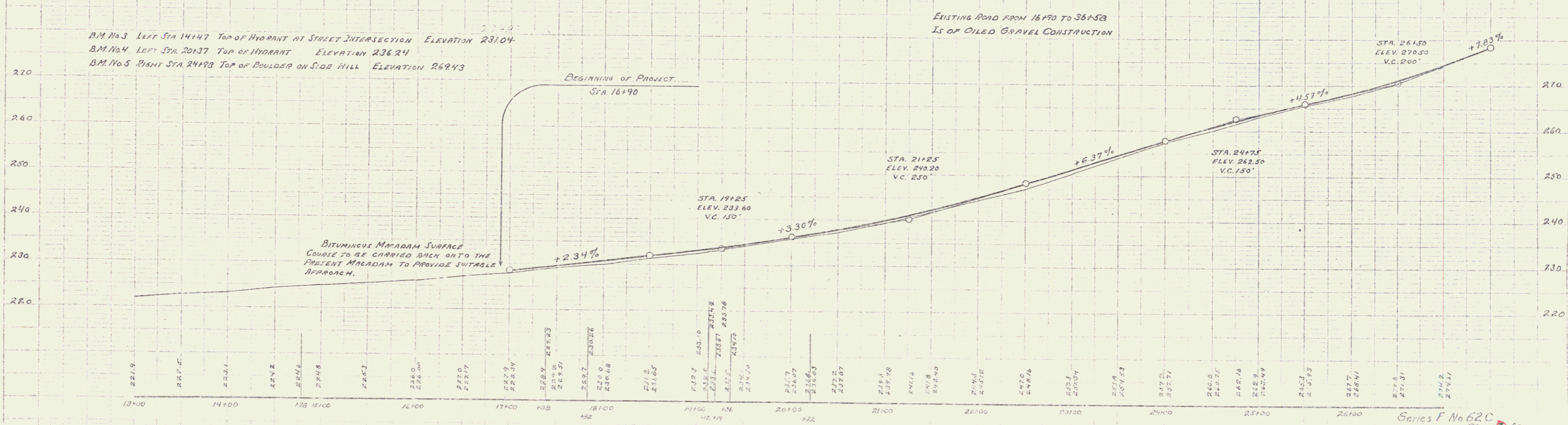
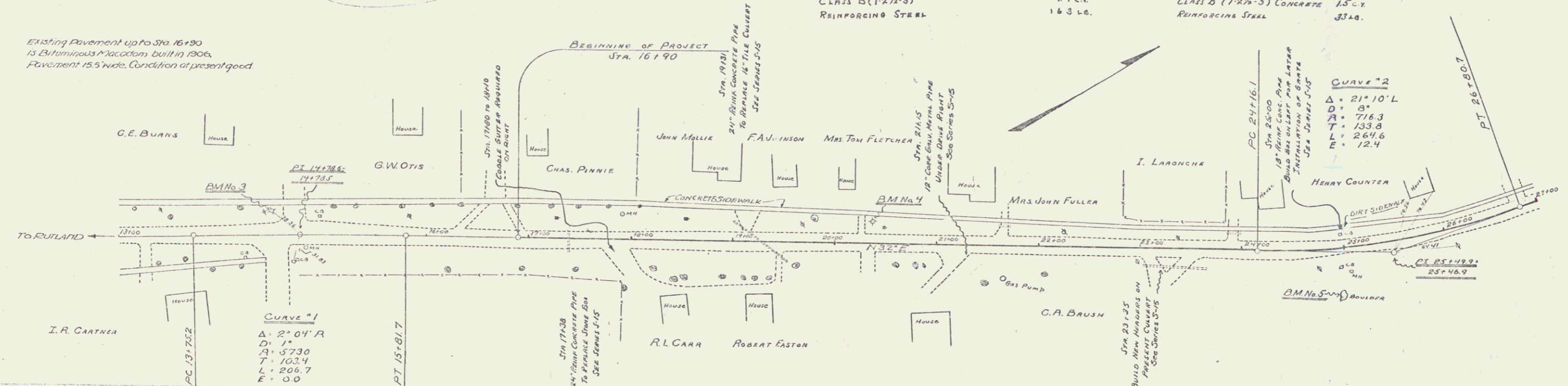

Series F No 62C  
 27+00 Street 5152