

CULVERT REMAINS REQUIRED

24" dia. concrete box culvert
with new floor & blind
Class A concrete
Manhole street 270

DRIVEWAY CULVERT REMAINS REQUIRED

12" dia. concrete box culvert
with new floor & blind
Class A concrete
Manhole street 270

SLIP SHOT OF GAMPAL REQUIRED

See station to 113+00
Sub base of grade
600' x 11'

12" dia. concrete box culvert
with new floor & blind
Class A concrete
Manhole street 270

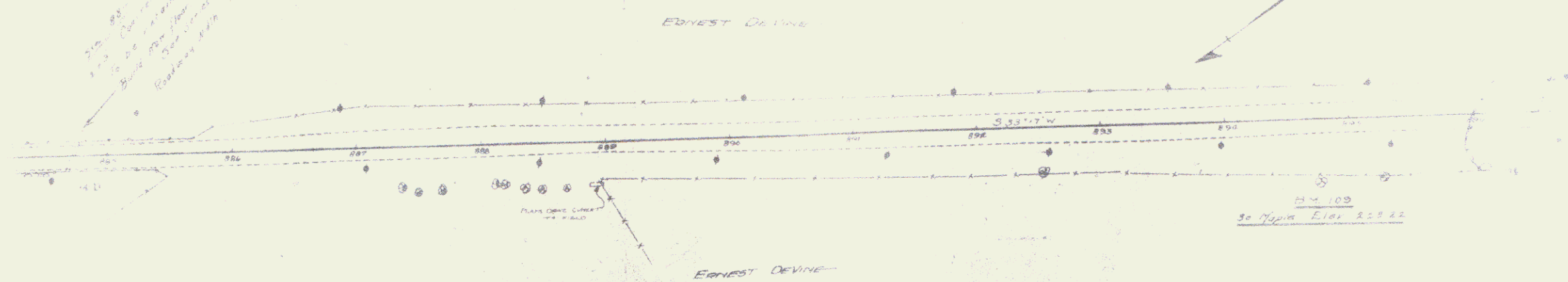

Profile view diagram showing a grid with stationing and elevation data. The diagram includes a road profile line and a grid for plotting elevations. A note on the right side reads 'Sub base of grade'.