

INDEX OF SHEETS

SHEET NO.	TITLE PAGE
1	TITLE PAGE
2	TYPICAL CROSS-SECTION OF IMPROVEMENT
3	PLAN AND PROFILE STA. 0+00 - 14+00
4	" " " " 14+00 - 28+00
5	" " " " 28+00 - 42+00
6	" " " " 42+00 - 56+00
7	" " " " 56+00 - 70+00
8	" " " " 70+00 - 84+00
9	" " " " 84+00 - 37+93.4'
10	BRIDGE STA. 69+30.0 - MASONRY
11	" " " " STEEL SUPERSTRUCTURE
12-18	CROSS SECTIONS

FED. ROAD DIST. NO.	STATE	FED. AID PROJ. NO.	TOTAL SHEETS	SHEET NO.
3	VT		18	1

STATE OF VERMONT  
 STATE HIGHWAY DEPARTMENT

PLAN AND PROFILE OF PROPOSED  
 STATE HIGHWAY  
 FEDERAL AID PROJECT

**TOWN OF FERRISBURG**  
 RUTLAND --- BURLINGTON ROAD  
 FROM VERGENNES LINE TO DEPOT ROAD IN  
 FERRISBURG VILLAGE

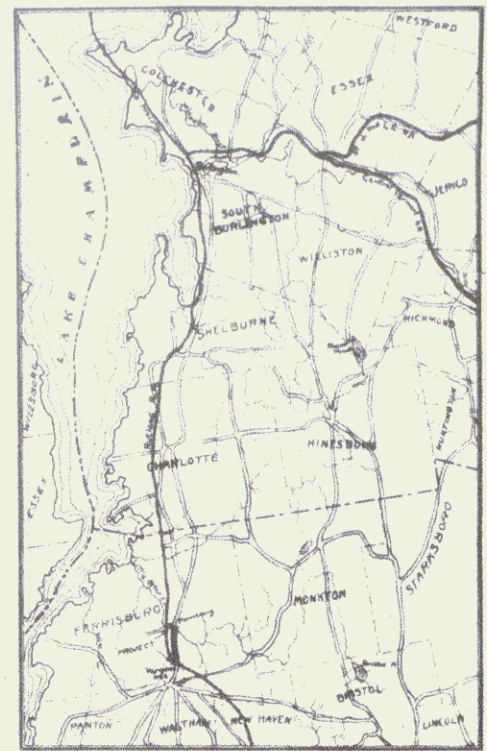

SCALES { PLAN 1 in = 50 ft  
 PROFILE 1 in = 50 ft Vert 1 in = 10 ft  
 CROSS-SECTIONS 1 in = 50 ft

~ RECORD PLANS ~

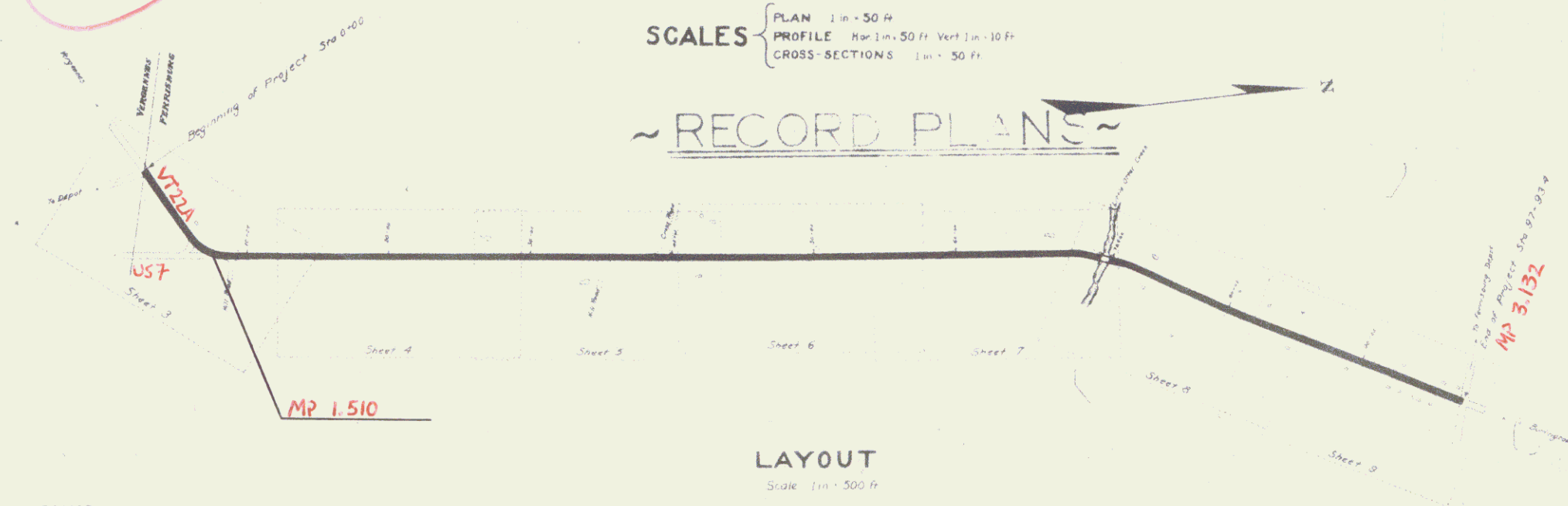

LAYOUT  
 Scale 1 in = 500 ft

CONVENTIONAL SIGNS

- GROUND ELEVATION *DATA* *LINE*
- GRADE ELEVATION *DATA* *LINE*
- CURVE DATA
- DEFLECTION ANGLE Δ
- DEGREE OF CURVE D
- RADIUS OF CURVE R
- TANGENT DISTANCE T

Pin # 992442  
 Route US7  
 Project F 35  
 Date 1/1/1921

SUBMITTED BY ORDER OF THE STATE HIGHWAY BOARD

CHIEF ENGINEER

RECOMMENDED BY *Sam H. Allen*  
 DISTRICT ENGINEER  
 BUREAU OF PUBLIC ROADS

RECOMMENDED FOR APPROVAL

CHIEF ENGINEER - BUREAU OF PUBLIC ROADS

APPROVED

Sheet ①

**GUARD RAIL REQUIRED**  
 ON LEFT Sta. 11+88 To 12+12 Length 24ft  
 ON RIGHT Sta. 11+88 To 12+12 Length 24ft  
**TOTAL THIS SHEET 48ft.**

**NEW CULVERTS REQUIRED**  
 Sta. 12+00 18" Cor. Iron Pipe 28ft  
 1-2 1/2-5 Concrete 15 cu. yd.

**SUB BASE REQUIRED**  
 Sta. 0+00 To 14+00 Length 1400 ft.

NO.	DATE	BY	REVISION	TOTAL SHEETS
9	UT	35	1921	3

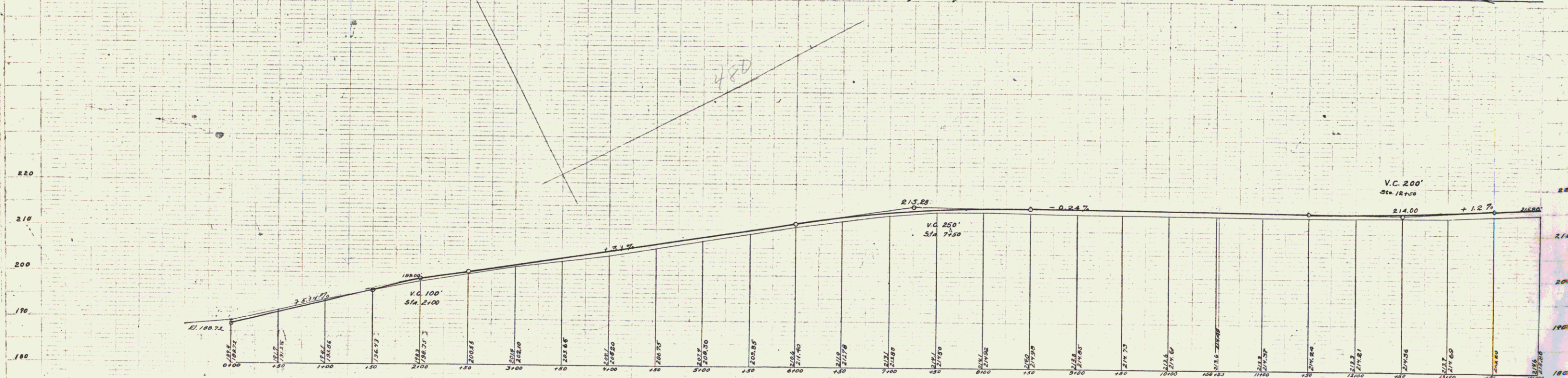
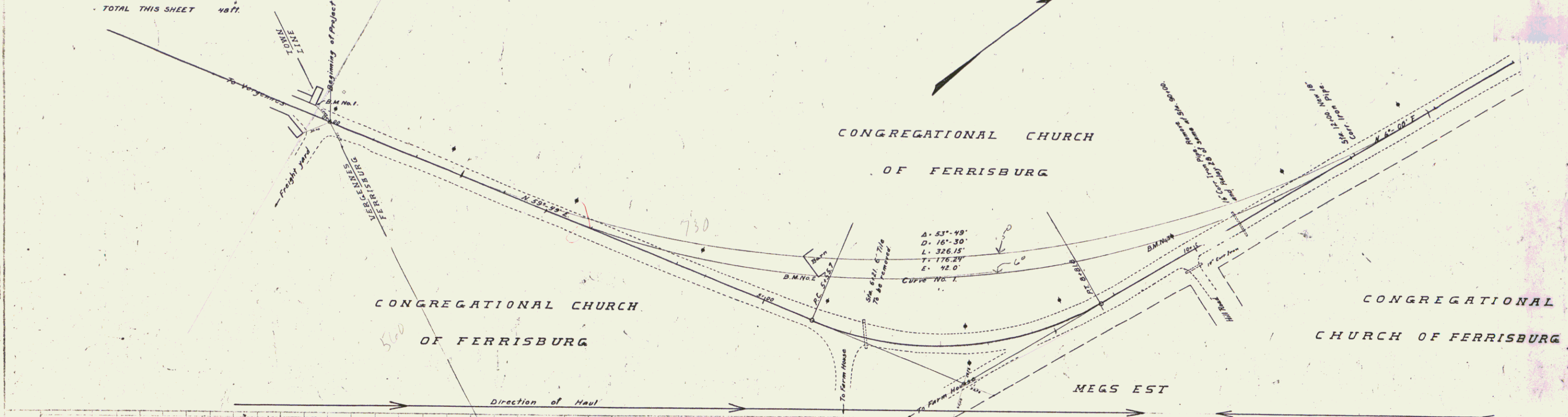

B.M. No. 1 S.E. Corner Flat Section of N. Abutment to Underpass. Sta. -0+20 Elev. - 190.30'  
 B.M. No. 2 Top of Stone under S.E. Corner of Old Barn Sta. 5+44 Elev. - 206.57'  
 B.M. No. 3 Spike in W. Side of Telephone Pole Sta. 5+85 Elev. - 212.69'

Sheet 3 of 10  
 Series F, No. 35

20











**GUARD RAIL REQUIRED ON LEFT**  
 Sta. 89+88 To 90+12 Length 24 ft.  
**ON RIGHT**  
 Sta. 89+88 To 90+12 Length 24 ft.  
**TOTAL THIS SHEET 48 ft.**

**CULVERT REPAIRS REQUIRED**  
 Sta. 90+00  
 1-2 1/2 Concrete 1.5 cu. yd.  
**RELAYING PIPE CULVERTS**  
 Sta. 90+00 16" Corr. Iron Pipe 28 ft.

**SUB BASE REQUIRED**  
 Sta. 84+00 To 97+53 Length 1333 ft.

FEDERAL OFFICE	STATE	FEDERAL FISCAL YEAR	STATE FISCAL YEAR	NO.	TOTAL SHEETS
9	VT	35	1921	9	18

PLAN  
 M. E. BIRKETT  
 G. L. HAY  
 L. J. HAY  
 W. E. BIRKETT

M. E. BIRKETT  
 G. L. HAY  
 L. J. HAY  
 W. E. BIRKETT

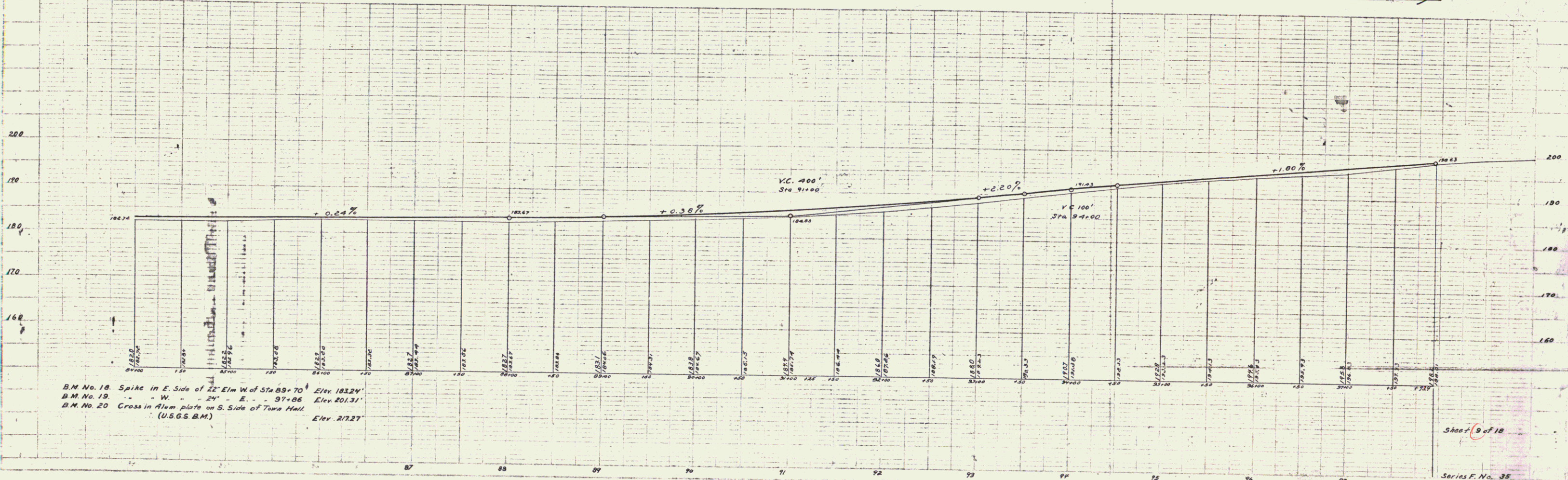
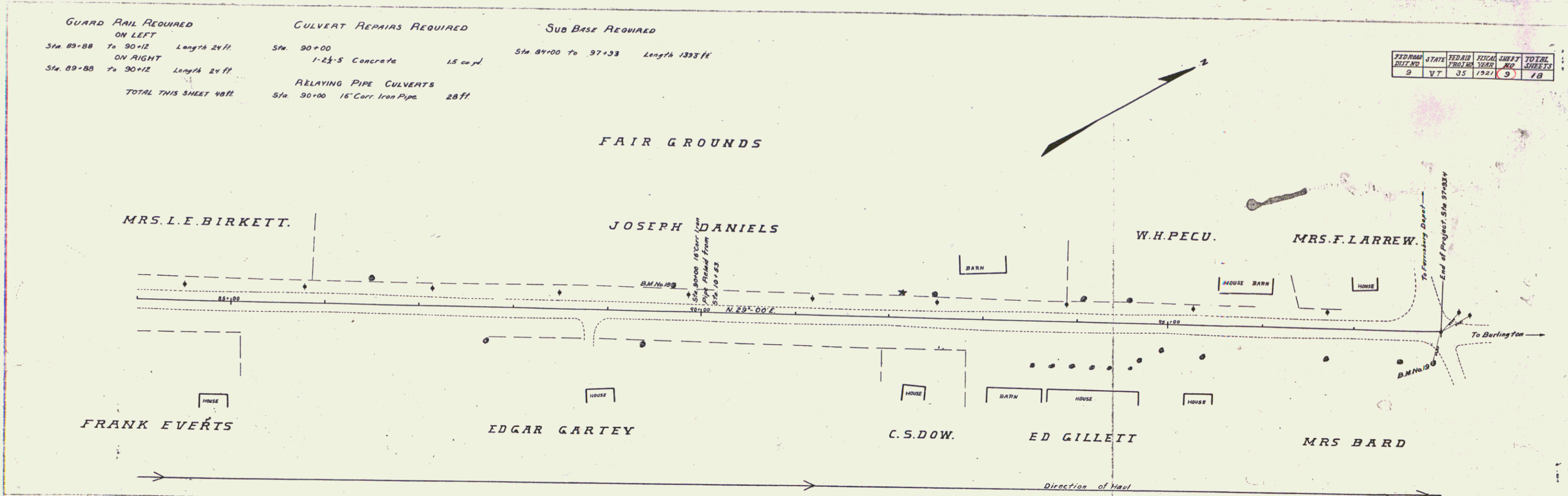

B.M. No. 18. Spike in E. Side of 22 Elm W. of Sta. 89+70 Elev. 182.24  
 B.M. No. 19. " " W. " " 24 " E. " " 97+86 Elev. 201.31  
 B.M. No. 20. Cross in Alum plate on S. Side of Town Hall Elev. 272.27  
 (U.S.G.S. B.M.)

Sheet 9 of 18  
 Series F. No. 35

8