

INDEX OF SHEETS

SHEET NO.	TITLE PAGE
1	TYPICAL CROSS-SECTION OF IMPROVEMENT BITUMINOUS CONCRETE PAVEMENT, ITEM 351
2	BANKING AND WIDENING TABLES
3	QUANTITY SHEET-SUMMARY
4	QUANTITY SHEETS-DRAINAGE
5	QUANTITY SHEETS-EARTHWORK
6-22	PLAN AND PROFILE
23-24	12" x 10" BOX CULVERTS
25-27	CHANNEL SECTIONS
28	STANDARD STRUCTURE SHEET S-40 BARRICADES, SIGNS AND LIGHTS
29	S-41 ROUNDING OF SLOPES
30	S-42 15" x 18" GULVERTS
31	S-43 18" x 24" GULVERTS
32	S-44 24" x 36" GULVERTS
33	S-45 36" x 48" GULVERTS
34	S-46 48" x 72" GULVERTS
35	S-47 72" x 96" GULVERTS
36	S-48 96" x 144" GULVERTS
37	S-49 144" x 216" GULVERTS
38	S-50 216" x 324" GULVERTS
39	S-51 324" x 486" GULVERTS
40	S-52 486" x 729" GULVERTS
41	S-53 729" x 1098" GULVERTS
42	S-54 1098" x 1647" GULVERTS
43	S-55 1647" x 2470" GULVERTS
44	S-56 2470" x 3705" GULVERTS
45	S-57 3705" x 5557" GULVERTS
46	S-58 5557" x 8336" GULVERTS
47	S-59 8336" x 12504" GULVERTS
48	S-60 12504" x 18756" GULVERTS
49	S-61 18756" x 28134" GULVERTS
50	S-62 28134" x 42201" GULVERTS
51	S-63 42201" x 63301" GULVERTS
52	S-64 63301" x 94952" GULVERTS
53	S-65 94952" x 142428" GULVERTS
54	S-66 142428" x 213642" GULVERTS
55	S-67 213642" x 320463" GULVERTS
56	S-68 320463" x 480695" GULVERTS
57	S-69 480695" x 721042" GULVERTS
58	S-70 721042" x 1081563" GULVERTS
59	S-71 1081563" x 1622345" GULVERTS
60	S-72 1622345" x 2433518" GULVERTS
61	S-73 2433518" x 3650277" GULVERTS
62	S-74 3650277" x 5475416" GULVERTS
63	S-75 5475416" x 8213124" GULVERTS
64	S-76 8213124" x 12319686" GULVERTS
65	S-77 12319686" x 18479529" GULVERTS
66	S-78 18479529" x 27719294" GULVERTS
67	S-79 27719294" x 41578941" GULVERTS
68	S-80 41578941" x 62368411" GULVERTS
69	S-81 62368411" x 93552617" GULVERTS
70	S-82 93552617" x 140328926" GULVERTS
71	S-83 140328926" x 210493389" GULVERTS
72	S-84 210493389" x 315740084" GULVERTS
73	S-85 315740084" x 473610126" GULVERTS
74	S-86 473610126" x 710415189" GULVERTS
75	S-87 710415189" x 1065622784" GULVERTS
76	S-88 1065622784" x 1598434176" GULVERTS
77	S-89 1598434176" x 2397651264" GULVERTS
78	S-90 2397651264" x 3596476896" GULVERTS
79	S-91 3596476896" x 5394715328" GULVERTS
80	S-92 5394715328" x 8092372992" GULVERTS
81	S-93 8092372992" x 12138559488" GULVERTS
82	S-94 12138559488" x 18207839232" GULVERTS
83	S-95 18207839232" x 27311758848" GULVERTS
84	S-96 27311758848" x 40967638784" GULVERTS
85	S-97 40967638784" x 61451458176" GULVERTS
86	S-98 61451458176" x 92177187264" GULVERTS
87	S-99 92177187264" x 138265780864" GULVERTS
88	S-100 138265780864" x 207398671328" GULVERTS
89	S-101 207398671328" x 311098007040" GULVERTS
90	S-102 311098007040" x 466647010560" GULVERTS
91	S-103 466647010560" x 699970515840" GULVERTS
92	S-104 699970515840" x 1054905773760" GULVERTS
93	S-105 1054905773760" x 1582358660608" GULVERTS
94	S-106 1582358660608" x 2373537990912" GULVERTS
95	S-107 2373537990912" x 3560211986368" GULVERTS
96	S-108 3560211986368" x 5340317979536" GULVERTS
97	S-109 5340317979536" x 8010466968304" GULVERTS
98	S-110 8010466968304" x 12015700452416" GULVERTS
99	S-111 12015700452416" x 18023550678624" GULVERTS
100	S-112 18023550678624" x 27035326017936" GULVERTS
101	S-113 27035326017936" x 40552989026904" GULVERTS
102	S-114 40552989026904" x 60829483540352" GULVERTS
103	S-115 60829483540352" x 91244225310528" GULVERTS
104	S-116 91244225310528" x 136866337965792" GULVERTS
105	S-117 136866337965792" x 205299506948672" GULVERTS
106	S-118 205299506948672" x 307948760423008" GULVERTS
107	S-119 307948760423008" x 4619231406344128" GULVERTS
108	S-120 4619231406344128" x 6928847109516192" GULVERTS
109	S-121 6928847109516192" x 10393270664274272" GULVERTS
110	S-122 10393270664274272" x 15589906006411408" GULVERTS
111	S-123 15589906006411408" x 233848590096171136" GULVERTS
112	S-124 233848590096171136" x 350772885144256704" GULVERTS
113	S-125 350772885144256704" x 526159327716385056" GULVERTS
114	S-126 526159327716385056" x 789239041574577536" GULVERTS
115	S-127 789239041574577536" x 1183858562361866304" GULVERTS
116	S-128 1183858562361866304" x 1775787843542799360" GULVERTS
117	S-129 1775787843542799360" x 2663681765314199040" GULVERTS
118	S-130 2663681765314199040" x 3995522647971298560" GULVERTS
119	S-131 3995522647971298560" x 5993283971956947840" GULVERTS
120	S-132 5993283971956947840" x 8989925907935421696" GULVERTS
121	S-133 8989925907935421696" x 13484888861903132544" GULVERTS
122	S-134 13484888861903132544" x 20227333292854698816" GULVERTS
123	S-135 20227333292854698816" x 30340999939282048128" GULVERTS
124	S-136 30340999939282048128" x 45511499908923072192" GULVERTS
125	S-137 45511499908923072192" x 682672498633846072832" GULVERTS
126	S-138 682672498633846072832" x 1024008747950769109248" GULVERTS
127	S-139 1024008747950769109248" x 1536013121926153613920" GULVERTS
128	S-140 1536013121926153613920" x 23040196828892304199040" GULVERTS
129	S-141 23040196828892304199040" x 34560296243338456298176" GULVERTS
130	S-142 34560296243338456298176" x 51840444362907684439296" GULVERTS
131	S-143 51840444362907684439296" x 77760666544361526658944" GULVERTS
132	S-144 77760666544361526658944" x 116640999816542289937920" GULVERTS
133	S-145 116640999816542289937920" x 174961499724813434906880" GULVERTS
134	S-146 174961499724813434906880" x 262442249587220152360320" GULVERTS
135	S-147 262442249587220152360320" x 393663374380830228540480" GULVERTS
136	S-148 393663374380830228540480" x 590495061571245342816704" GULVERTS
137	S-149 590495061571245342816704" x 875737592356868014225024" GULVERTS
138	S-150 875737592356868014225024" x 1313606388535302021337536" GULVERTS
139	S-151 1313606388535302021337536" x 1970409582802953032006304" GULVERTS
140	S-152 1970409582802953032006304" x 2955614374204429548009472" GULVERTS
141	S-153 2955614374204429548009472" x 4433421561106643322014112" GULVERTS
142	S-154 4433421561106643322014112" x 6650132341659964983021168" GULVERTS
143	S-155 6650132341659964983021168" x 9975198512489947474531712" GULVERTS
144	S-156 9975198512489947474531712" x 14962797768734921211797504" GULVERTS
145	S-157 14962797768734921211797504" x 22444196653102381717695040" GULVERTS
146	S-158 22444196653102381717695040" x 33666294979653572576542592" GULVERTS
147	S-159 33666294979653572576542592" x 50501442469480358863813888" GULVERTS
148	S-160 50501442469480358863813888" x 75752163704220538295720832" GULVERTS
149	S-161 75752163704220538295720832" x 113628245556330807443581248" GULVERTS
150	S-162 113628245556330807443581248" x 170442368334496211165371904" GULVERTS
151	S-163 170442368334496211165371904" x 255663552501744316748052736" GULVERTS
152	S-164 255663552501744316748052736" x 383495328752616465122078144" GULVERTS
153	S-165 383495328752616465122078144" x 575243003128924697683117248" GULVERTS
154	S-166 575243003128924697683117248" x 862864504693387046524675840" GULVERTS
155	S-167 862864504693387046524675840" x 1294296757039080569787013760" GULVERTS
156	S-168 1294296757039080569787013760" x 1941445135558120854680520960" GULVERTS
157	S-169 1941445135558120854680520960" x 2912167703337181282020781440" GULVERTS
158	S-170 2912167703337181282020781440" x 4368251555005771923031172480" GULVERTS
159	S-171 4368251555005771923031172480" x 655237733250865788454675840" GULVERTS
160	S-172 655237733250865788454675840" x 982851599876298682682013760" GULVERTS
161	S-173 982851599876298682682013760" x 1474277399814448024023027360" GULVERTS
162	S-174 1474277399814448024023027360" x 221141609972167203603447040" GULVERTS
163	S-175 221141609972167203603447040" x 331712414958250805405170560" GULVERTS
164	S-176 331712414958250805405170560" x 4975686224373762081082858240" GULVERTS
165	S-177 4975686224373762081082858240" x 7463529336560643121624286720" GULVERTS
166	S-178 7463529336560643121624286720" x 11195293904840964682436430080" GULVERTS
167	S-179 11195293904840964682436430080" x 167929408572614470236546485760" GULVERTS
168	S-180 167929408572614470236546485760" x 251894112858921905354819728640" GULVERTS
169	S-181 251894112858921905354819728640" x 37783816928837280803227960320" GULVERTS
170	S-182 37783816928837280803227960320" x 56177625393255921204841940480" GULVERTS
171	S-183 56177625393255921204841940480" x 842664380898838738072629127360" GULVERTS
172	S-184 842664380898838738072629127360" x 1264016571348258106808943710720" GULVERTS
173	S-185 1264016571348258106808943710720" x 1896024857022387150213415566080" GULVERTS
174	S-186 1896024857022387150213415566080" x 2844037285533580620320122340480" GULVERTS
175	S-187 2844037285533580620320122340480" x 4266054828300370930480183510720" GULVERTS
176	S-188 4266054828300370930480183510720" x 640808224205054539072027521600" GULVERTS
177	S-189 640808224205054539072027521600" x 9612123363075818086080412825600" GULVERTS
178	S-190 9612123363075818086080412825600" x 14418185044613727129120618038400" GULVERTS
179	S-191 14418185044613727129120618038400" x 2162727756692059069368091705600" GULVERTS
180	S-192 2162727756692059069368091705600" x 32440916350380881040552833683200" GULVERTS
181	S-193 32440916350380881040552833683200" x 4866137452557132160833025072000" GULVERTS
182	S-194 4866137452557132160833025072000" x 72992061788356992412496376083200" GULVERTS
183	S-195 72992061788356992412496376083200" x 10948809268253548861874456460800" GULVERTS
184	S-196 10948809268253548861874456460800" x 16423213902380322892811684691200" GULVERTS
185	S-197 16423213902380322892811684691200" x 24634820853570484339217526387200" GULVERTS
186	S-198 24634820853570484339217526387200" x 36952231280355726508826289580800" GULVERTS
187	S-199 36952231280355726508826289580800" x 55428346920553589763239434371200" GULVERTS
188	S-200 55428346920553589763239434371200" x 831425203808303846448591515571200" GULVERTS
189	S-201 831425203808303846448591515571200" x 124713780571245576967288727335040" GULVERTS
190	S-202 124713780571245576967288727335040" x 187070670856868364800853091002240" GULVERTS
191	S-203 187070670856868364800853091002240" x 280606006285292547201279636503360" GULVERTS
192	S-204 280606006285292547201279636503360" x 420909009427938820801919454755040" GULVERTS
193	S-205 420909009427938820801919454755040" x 6313635141419082304028791821325440" GULVERTS
194	S-206 6313635141419082304028791821325440" x 9470452711128623360043187231937280" GULVERTS
195	S-207 9470452711128623360043187231937280" x 1420567906669293504006478109279040" GULVERTS
196	S-208 1420567906669293504006478109279040" x 2130851859903940204809717163918080" GULVERTS
197	S-209 2130851859903940204809717163918080" x 3196277789855910307214575745877120" GULVERTS
198	S-210 3196277789855910307214575745877120" x 4794416684783864460821863618815360" GULVERTS
199	S-211 4794416684783864460821863618815360" x 7191625027175796691232795428222720" GULVERTS



CONTRACT DRIVE

LEFT	RIGHT
281+00 - 282+00	281+00 - 281+50
282+00 - 283+00	281+50 - 282+00
283+00 - 284+00	282+00 - 282+50
284+00 - 285+00	282+50 - 283+00
285+00 - 286+00	283+00 - 283+50
286+00 - 287+00	283+50 - 284+00
287+00 - 288+00	284+00 - 284+50
288+00 - 289+00	284+50 - 285+00
289+00 - 290+00	285+00 - 285+50
290+00 - 291+00	285+50 - 286+00
291+00 - 292+00	286+00 - 286+50
292+00 - 293+00	286+50 - 287+00
293+00 - 294+00	287+00 - 287+50
294+00 - 295+00	287+50 - 288+00
295+00 - 296+00	288+00 - 288+50
296+00 - 297+00	288+50 - 289+00

SHELBUrne

ELEVATION

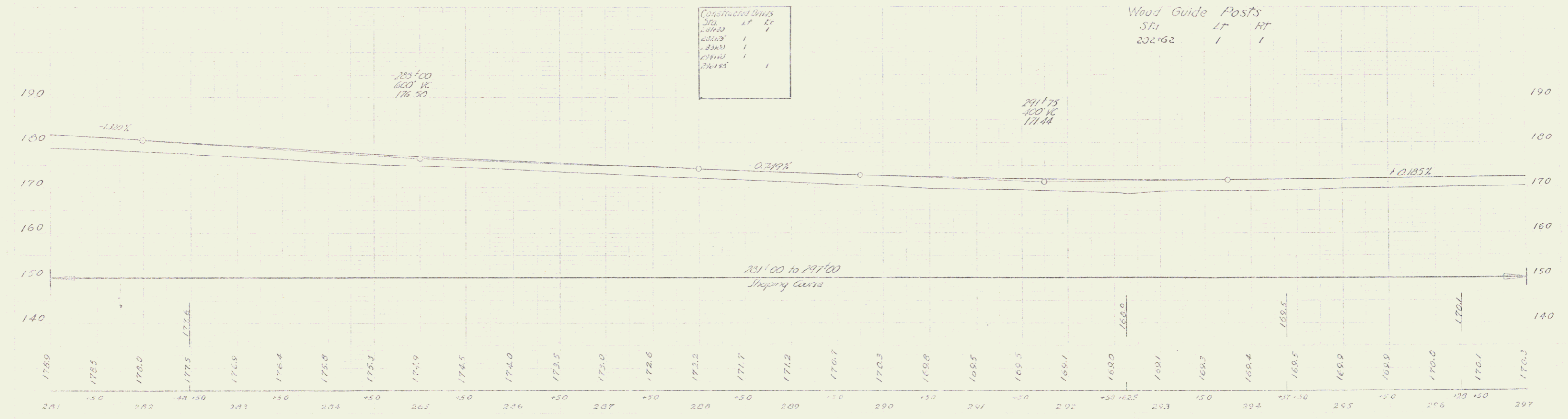

B.M. * 7 Spike in root of 24" Elm 40 ft. l of sta 281+50 - Elev 177.54

SHELBUrne - SOUTH BURLINGTON
Series 15 (15/2)
Sheet 15 of 73 sheets

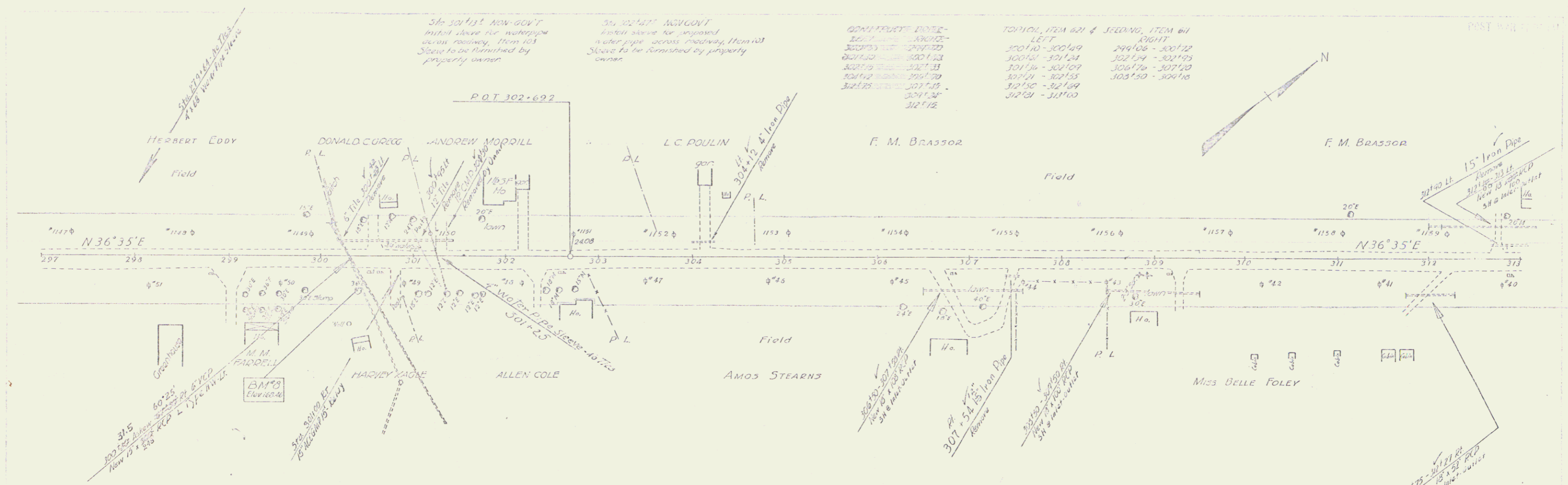

WOOD GUIDE POSTS -

301.12	301.15
301.15	301.18
301.18	301.21
301.21	301.24
301.24	301.27
301.27	301.30
301.30	301.33
301.33	301.36
301.36	301.39
301.39	301.42
301.42	301.45
301.45	301.48
301.48	301.51
301.51	301.54
301.54	301.57
301.57	301.60

TOPICAL ITEM 621 & SEEDING, ITEM 611 LEFT

300.10 - 300.19	299.06 - 300.12
300.19 - 301.24	302.14 - 302.19
301.24 - 301.29	302.19 - 302.24
301.29 - 301.34	302.24 - 302.29
301.34 - 301.39	302.29 - 302.34
301.39 - 301.44	302.34 - 302.39
301.44 - 301.49	302.39 - 302.44
301.49 - 301.54	302.44 - 302.49
301.54 - 301.59	302.49 - 302.54
301.59 - 301.64	302.54 - 302.59

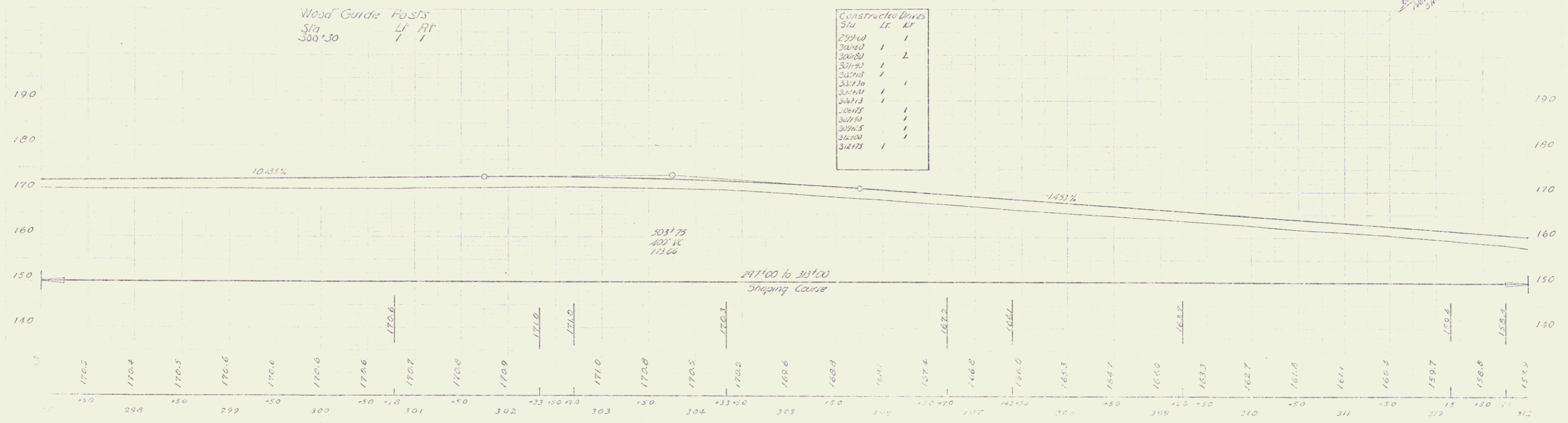

B.M. Spike in root of 36" Elm 36 ft. ht. of sta 300.40 - Elev. 168.46

SPRINGFIELD SOUTH BURLINGTON
 1915
 16

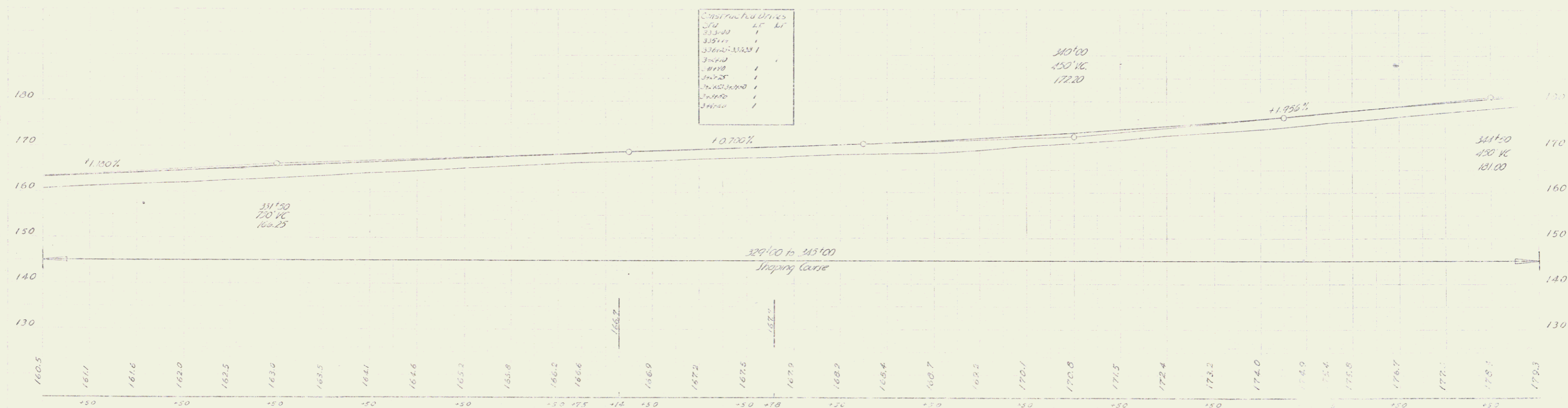
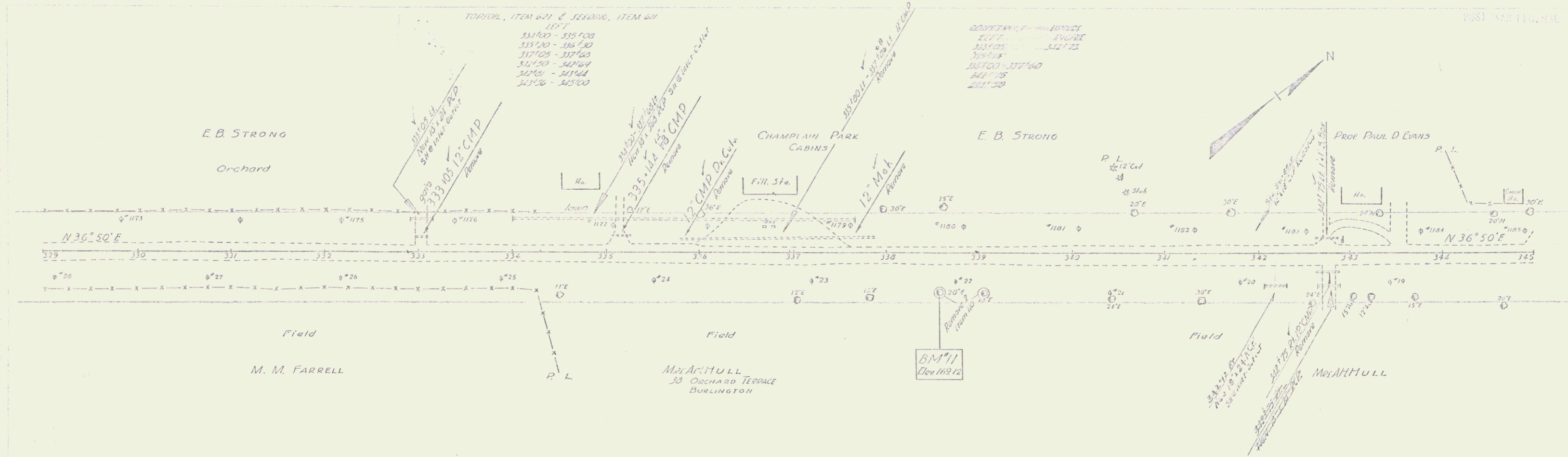

B.M. #11 Spike in root of 20" Elm 41 ft. N. of sta 336+56 - Elev. 169.12

SHELDONNE - SOUTH BURLINGTON
 SHEET 18 OF 19 (3)
 Sheet 18 of 19 sheets

TURCH, ITEM 621 & SEEDING, ITEM 611
 LEFT RIGHT
 361'50 - 361'00 370'10 - 371'00 RL
 362'00 - 363'00
 369'20 - 369'40

CONTRACTOR'S NOTES
 1. ALL DISTANCES TO BE MEASURED ALONG THE CENTERLINE OF THE ROAD.
 2. ALL DISTANCES TO BE MEASURED ALONG THE CENTERLINE OF THE ROAD.
 3. ALL DISTANCES TO BE MEASURED ALONG THE CENTERLINE OF THE ROAD.
 4. ALL DISTANCES TO BE MEASURED ALONG THE CENTERLINE OF THE ROAD.

Sta 370'00" NON GOVT
 Install street for water pipe
 at Pass boundary from 1911
 Street to be furnished by prop
 owner

Sta 372'10" NON GOVT
 Excavate trench for situation
 of optic tank as per

A 9'10" LH
 D 1'50"
 T 306.2
 L 611
 E 122
 Bank 1/2" per ft

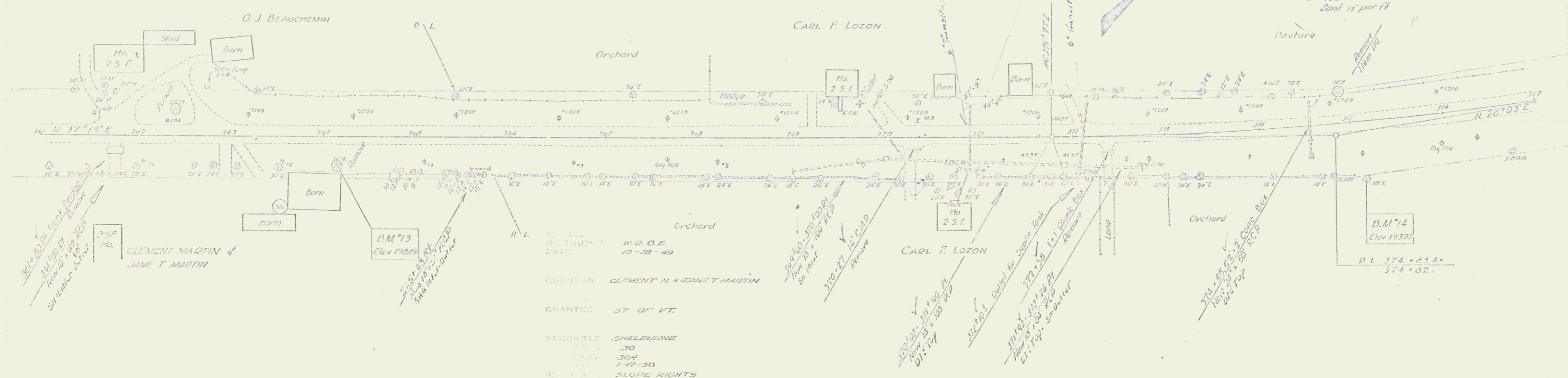

GRANTOR CLEMENT M. & JANE T. MARTIN
 GRANTEE ST. OF VT.
 RECORDED SHELburne
 BOOK 304
 PAGE 1-17-30
 REFERENCE SLOPE RIGHTS

Constructed Drives	LT	RT
361'50		
362'00		
362'10		
362'20		
362'30		
362'40		
362'50		
363'00		
363'10		
363'20		
363'30		
363'40		
363'50		
364'00		
364'10		
364'20		
364'30		
364'40		
364'50		
365'00		
365'10		
365'20		
365'30		
365'40		
365'50		
366'00		
366'10		
366'20		
366'30		
366'40		
366'50		
367'00		
367'10		
367'20		
367'30		
367'40		
367'50		
368'00		
368'10		
368'20		
368'30		
368'40		
368'50		
369'00		
369'10		
369'20		
369'30		
369'40		
369'50		
370'00		
370'10		
370'20		
370'30		
370'40		
370'50		
371'00		
371'10		
371'20		
371'30		
371'40		
371'50		
372'00		
372'10		
372'20		
372'30		
372'40		
372'50		
373'00		
373'10		
373'20		
373'30		
373'40		
373'50		
374'00		
374'10		
374'20		
374'30		
374'40		
374'50		
375'00		
375'10		
375'20		
375'30		
375'40		
375'50		
376'00		
376'10		
376'20		
376'30		
376'40		
376'50		
377'00		
377'10		
377'20		
377'30		
377'40		
377'50		
378'00		
378'10		
378'20		
378'30		
378'40		
378'50		
379'00		
379'10		
379'20		
379'30		
379'40		
379'50		
380'00		
380'10		
380'20		
380'30		
380'40		
380'50		
381'00		
381'10		
381'20		
381'30		
381'40		
381'50		
382'00		
382'10		
382'20		
382'30		
382'40		
382'50		
383'00		
383'10		
383'20		
383'30		
383'40		
383'50		
384'00		
384'10		
384'20		
384'30		
384'40		
384'50		
385'00		
385'10		
385'20		
385'30		
385'40		
385'50		
386'00		
386'10		
386'20		
386'30		
386'40		
386'50		
387'00		
387'10		
387'20		
387'30		
387'40		
387'50		
388'00		
388'10		
388'20		
388'30		
388'40		
388'50		
389'00		
389'10		
389'20		
389'30		
389'40		
389'50		
390'00		
390'10		
390'20		
390'30		
390'40		
390'50		
391'00		
391'10		
391'20		
391'30		
391'40		
391'50		
392'00		
392'10		
392'20		
392'30		
392'40		
392'50		
393'00		
393'10		
393'20		
393'30		
393'40		
393'50		
394'00		
394'10		
394'20		
394'30		
394'40		
394'50		
395'00		
395'10		
395'20		
395'30		
395'40		
395'50		
396'00		
396'10		
396'20		
396'30		
396'40		
396'50		
397'00		
397'10		
397'20		
397'30		
397'40		
397'50		
398'00		
398'10		
398'20		
398'30		
398'40		
398'50		
399'00		
399'10		
399'20		
399'30		
399'40		
399'50		
400'00		

Wood Girdle Posts
 ST 374-35
 LT RT
 1 1

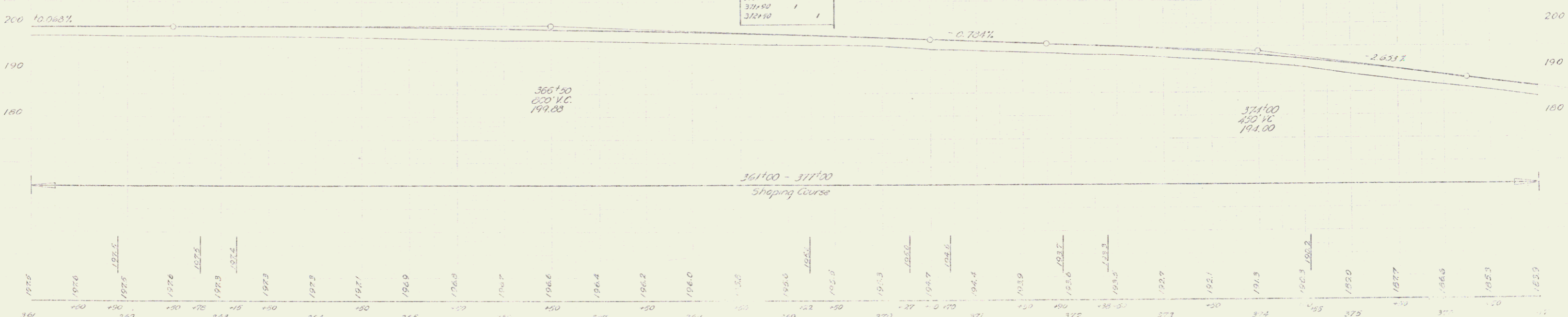

B.M. 13 Spike in root of 36" Elm 29' Rt. sta. 364+15 Elev 192.86
 B.M. 14 Spike in root of 18" Elm 60' Rt. sta. 375+15 Elev 193.07

Shelburne, Vt. 1911
 Sheet 100 of 73 sheets

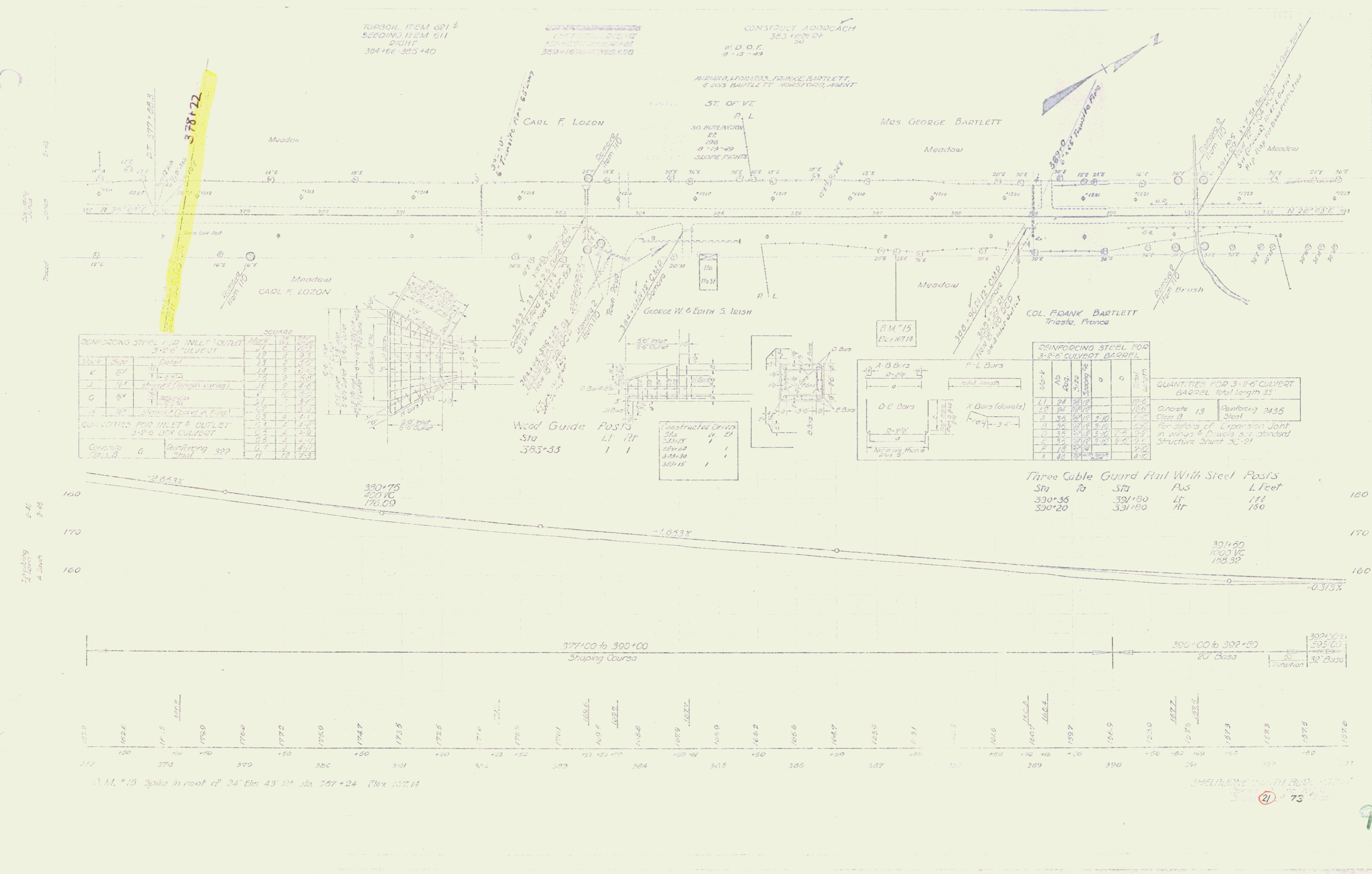

REINFORCING STEEL FOR INLET & OUTLET 3'-6" CULVERT

Mark	Qty	SQ. FT.
K	24	1.2
J	18	0.9
G	12	0.6
F	6	0.3
E	3	0.15
D	1	0.05
C	1	0.05
B	1	0.05
A	1	0.05

QUANTITIES FOR INLET & OUTLET 3'-6" BOX CULVERT

Item	Quantity
Concrete	6
Reinforcing Steel	322

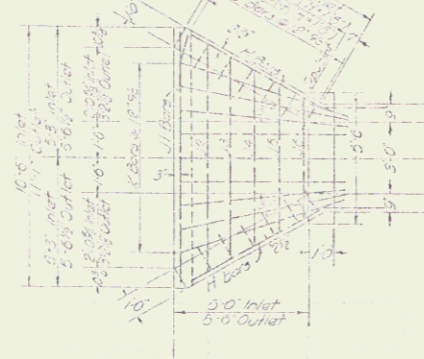

Wood Guide Posts
Sta 383+33
LI RT
I I

Construction Drives

Sta	LI	RT
383+33	I	I
384+30	I	I
387+15	I	I

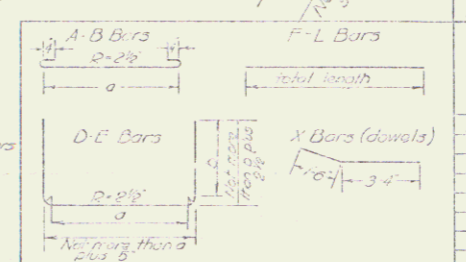

REINFORCING STEEL FOR 3'-6" CULVERT BARREL

Mark	No	Qty	SQ. FT.
L1	24	1.2	
L2	18	0.9	
L3	12	0.6	
L4	6	0.3	
L5	3	0.15	
L6	1	0.05	
L7	1	0.05	
L8	1	0.05	
L9	1	0.05	

QUANTITIES FOR 3'-6" CULVERT BARREL Total length 35'

Concrete 13
Class B
Steel Reinforcing 2435

For details of Expansion Joint in walls & Dowels see standard Structure sheet SC-21

Three Cable Guard Rail With Steel Posts

Sta	To	Sta	Post	L feet
330+36		391+80	LI	111
330+20		331+80	RT	150

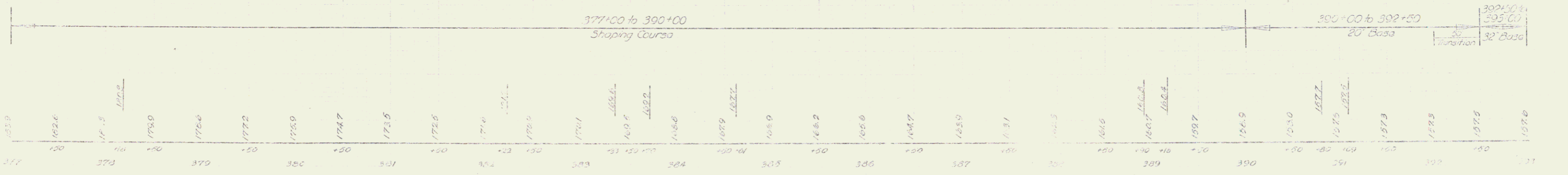
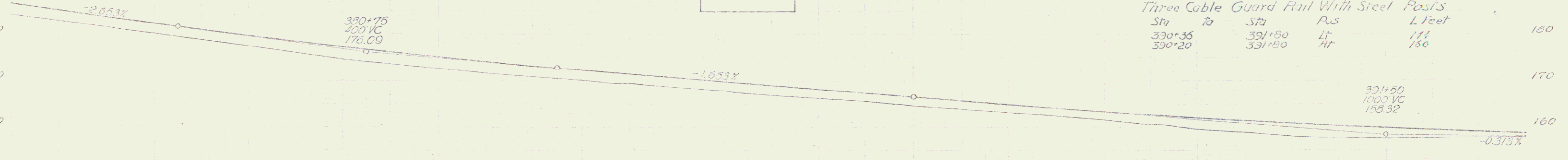

B.M. #15 Spike in root of 24" Elm 43' DI Sta 387+24 Elev 157.11

21 75

TOPSOIL, ITEM 021 & SEEDING, ITEM 011
 LEFT RIGHT
 395+42-395+94 393+20-393+74
 393+92-394+65 393+92-394+65

CONTRACT NO. 10-13-49
 INSTRUMENT NO. 10-13-49
 DATE 10-13-49

GRANTOR ROY R. & CATHERINE P. BARTLETT

GRANTEE ST. OF V.T.

RECORDED 30 BURLINGTON
 BOOK 82
 PAGE 835
 DATE 10-29-49

REMARKS SLOPE RIGHTS

ROY R. & CATHERINE P. BARTLETT

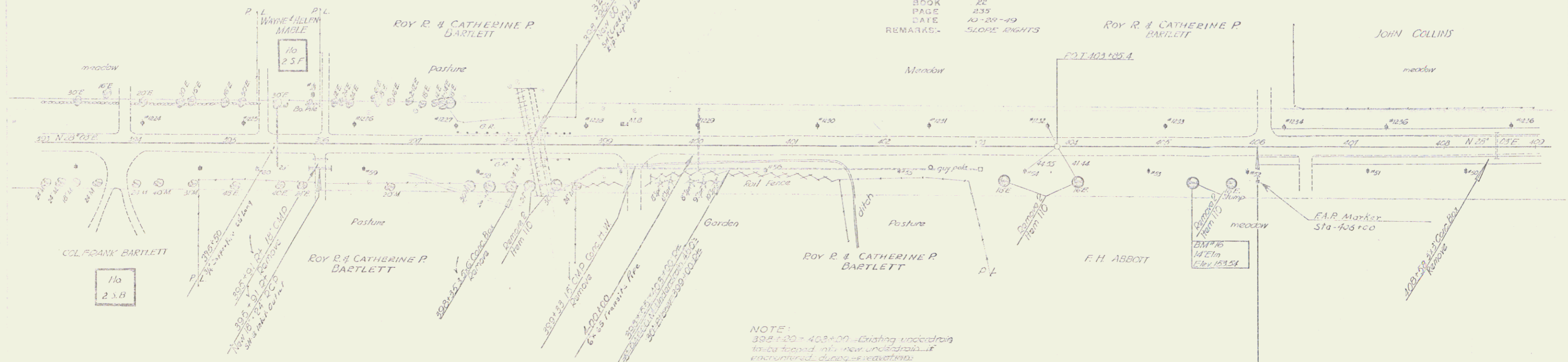
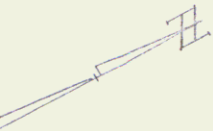

Three Cable Guard Rail With Steel Posts

Sta	To	Sta	Pos	LFoot
397+25		399+82	LT	144
397+70		399+82	RT	112

NOTE:
 395+20-403+00 - Existing underdrain
 to be topped, new underdrain to
 be constructed during relocations

Station	Depth
395+20	14.20
395+30	14.20
395+40	14.20
395+50	14.20
395+60	14.20
395+70	14.20
395+80	14.20
395+90	14.20

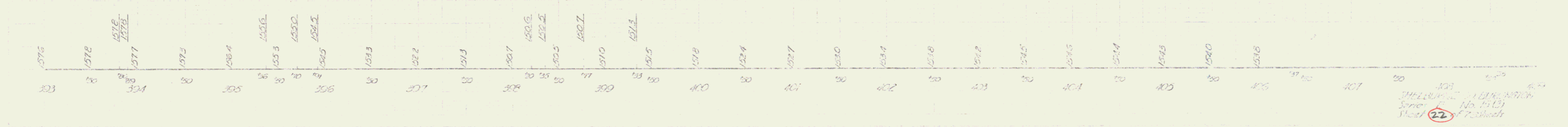
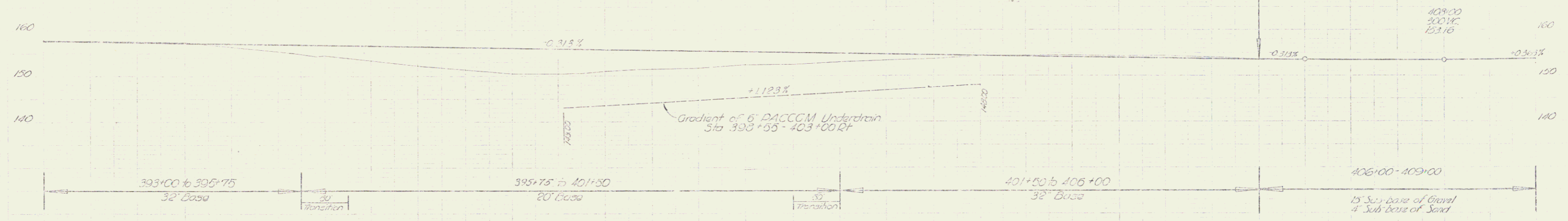

30 BURLINGTON
 BOOK 82
 PAGE 835
 DATE 10-29-49