

TURCH, ITEM 621 & SEEDING, ITEM 611
 LEFT RIGHT
 361'50 - 361'00 370'10 - 371'00 RI
 362'00 - 363'00
 369'20 - 369'40

CONTRACTOR'S NOTES
 1. ALL DISTANCES TO BE MEASURED ALONG THE CENTERLINE OF THE ROAD.
 2. ALL DISTANCES TO BE MEASURED ALONG THE CENTERLINE OF THE ROAD.
 3. ALL DISTANCES TO BE MEASURED ALONG THE CENTERLINE OF THE ROAD.
 4. ALL DISTANCES TO BE MEASURED ALONG THE CENTERLINE OF THE ROAD.

Sta 370'00" NON GOVT
 Install street for water pipe
 at Pass. Foundation 1800' 10"
 Slope to be furnished by prop.
 carrier

Sta 372'10" NON GOVT
 Excavate trench for situation
 of optic tank as set.

A 9'10" LH
 D 1'50"
 T 308.2
 L 611
 E 122
 Bank 1/2" per ft

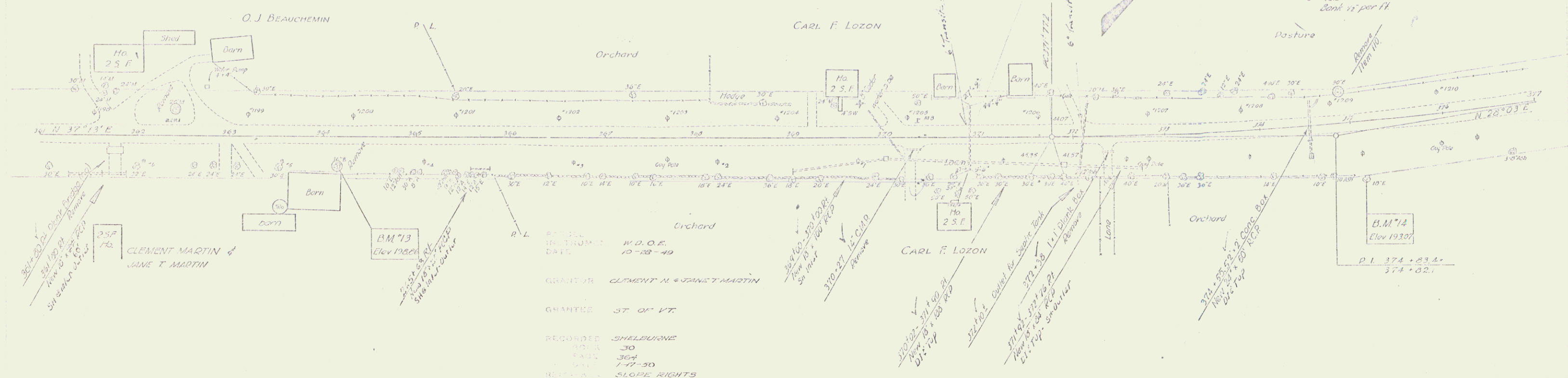

GRANTOR CLEMENT M. & JANE T. MARTIN
 GRANTEE ST. OF VT.
 RECORDED SHELburne
 BOOK 304
 PAGE 1-17-30
 REFERENCE SLOPE RIGHTS

Constructed Drives	LT	RT
361'50		
361'50		
361'50		
361'50		
361'50		
361'50		
361'50		
361'50		
361'50		
361'50		

Wood Girdle Posts
 ST- LT RT
 374-35 1 1

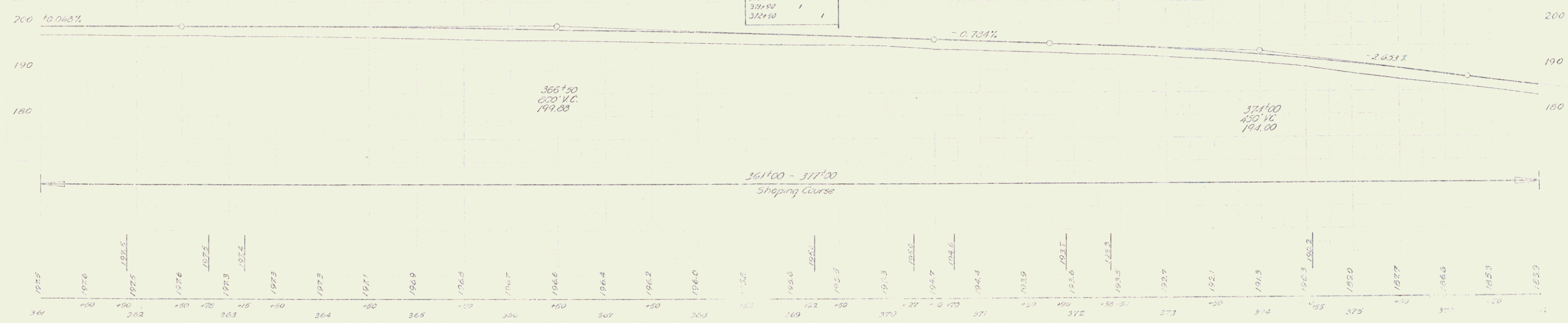

B.M. 13 Spike in root of 36" Elm 29' Rt. Sta. 364+15 Elev 192.86
 B.M. 14 Spike in root of 18" Elm 60' Rt. Sta. 375+15 Elev 193.07

Shelburne, Vt. 1911
 Sheet 100 of 73 sheets