

GUARD RAIL REQUIRED  
ON LEFT  
Sta. 176+70 to sta. 178+70 length 200ft  
- 107+91 - 107+65 - 24 -  
ON RIGHT  
Sta. 176+70 to sta. 178+70 length 200ft  
- 107+91 - 107+65 - 24 -  
TOTAL THIS SHEET 448A

NEW CULVERTS REQUIRED  
Sta. 177+38 - 18" C.I. Iron Pipe 40ft  
1-2-4 Concrete Headwalks 1.8 cu. yds.  
- 107+53 - 1-2-4 - " " 1.8 - -

STONE BASE REQUIRED  
Sta. 176+00 to sta. 188+00 length 1200ft

|                     |       |         |      |       |
|---------------------|-------|---------|------|-------|
| FED. ROAD DIST. NO. | STATE | SECTION | PLAN | PIECE |
| 9                   | VT.   |         |      | 1879  |

W. B. BAKER  
R. J. WATSON and C. J. WILLY  
CIVIL ENGINEERS  
100 STATE ST. BURLINGTON, Vt.

W. B. BAKER  
C. J. WILLY  
R. J. WATSON  
CIVIL ENGINEERS  
100 STATE ST. BURLINGTON, Vt.

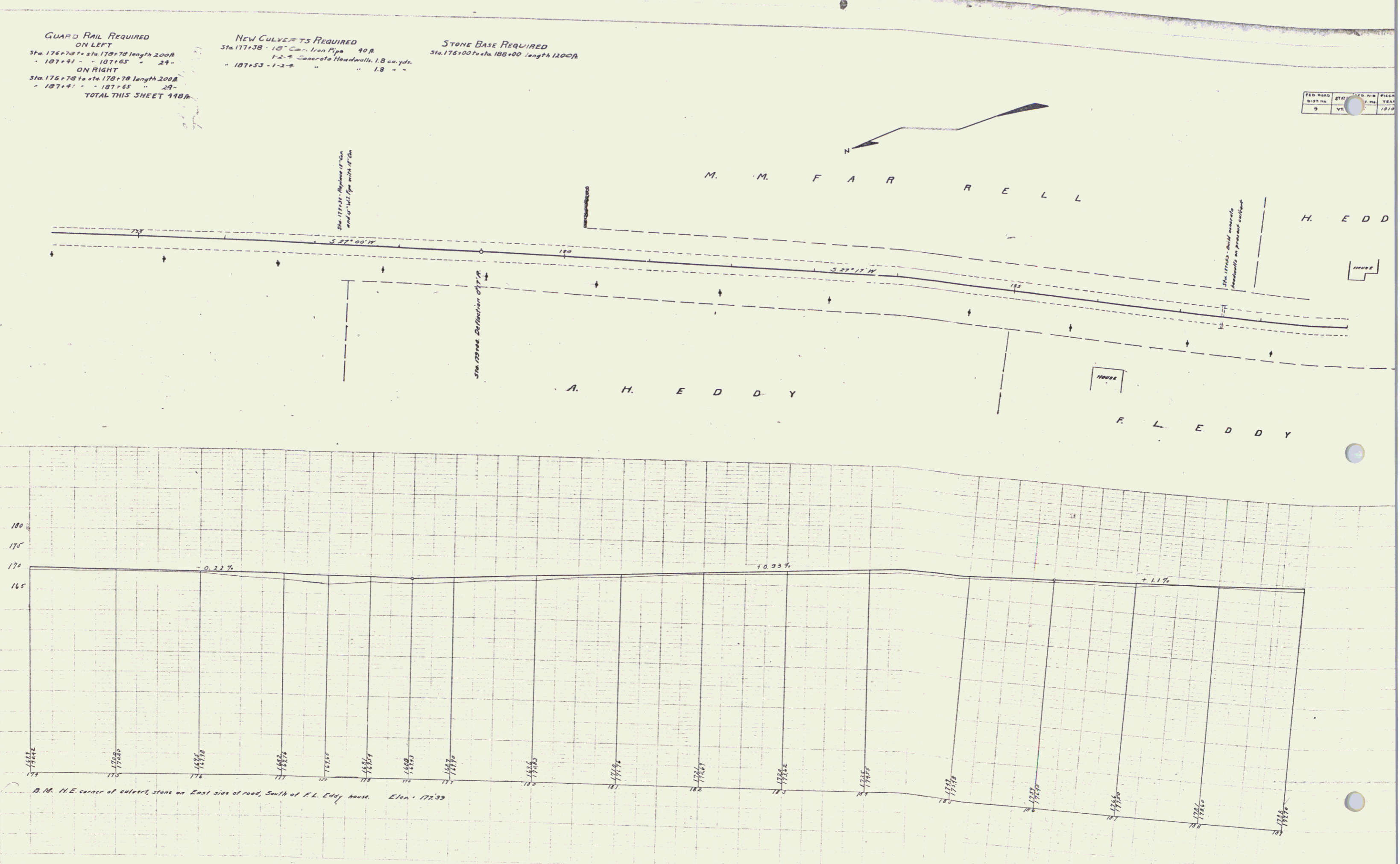

B.M. N.E. corner of culvert, starts on East side of road, South of F. L. Eddy house. Elev. 172.39

13  
Series No. 45-53  
Sheet