

GUARD RAIL REQUIRED
 ON LEFT
 Sta. 148+00 to Sta. 150+74 length 104 ft
 - 150+30 - " 154+66 = 368 -
 ON RIGHT
 Sta. 150+34 to Sta. 150+74 length 40 ft
 - 150+30 - " 154+66 = 368 -
TOTAL THIS SHEET 960 ft

FED. ROAD DIST. NO.	STATE	FED. AID PROJ. NO.	FISCAL YEAR	SHEET NO.	TOTAL SHEETS
3	VT	15	1978	18	33

H E N R Y R O W L E Y

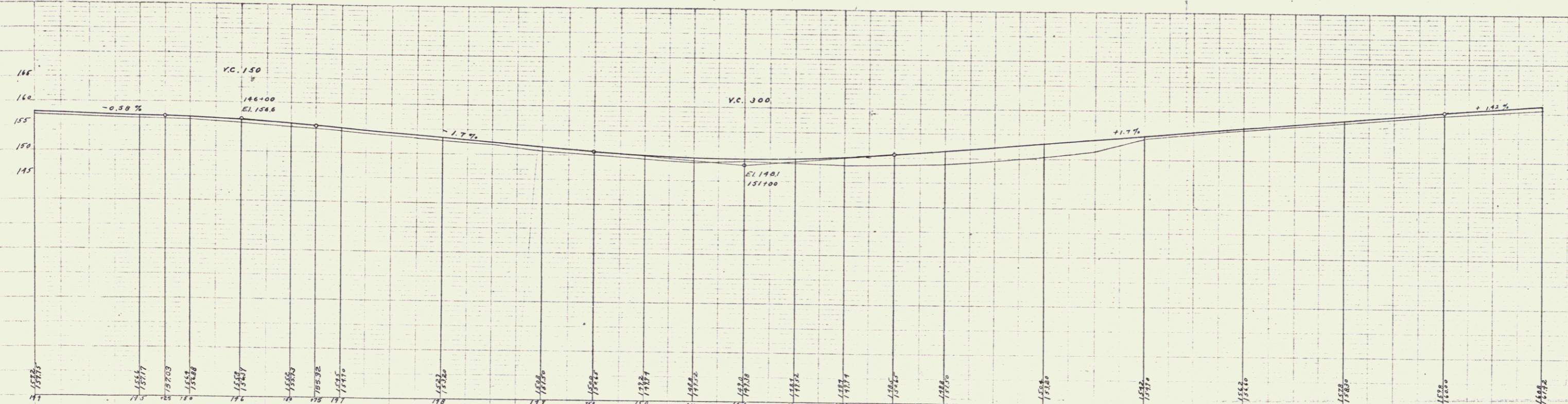
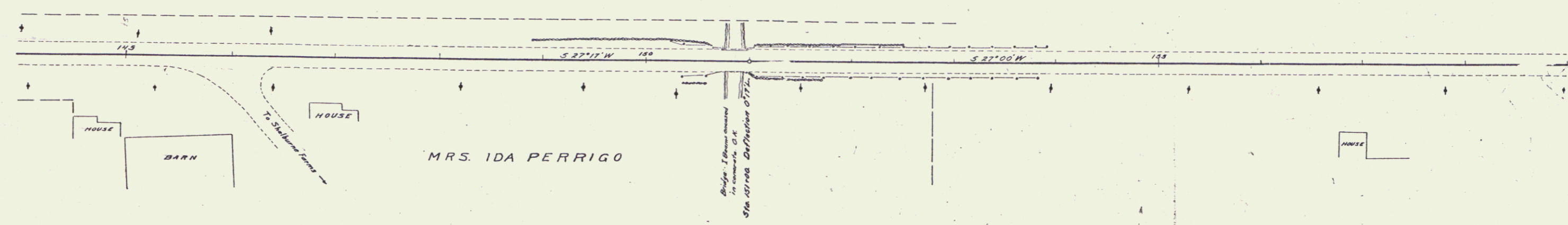
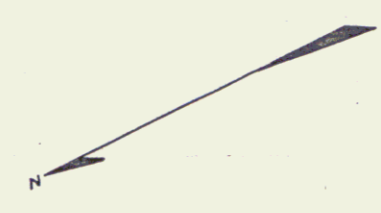

B.M. N.E. corner of threshold of first house north of road to Shelburne Farms, on west side of road. Elev. 148.33
 B.M. N.E. corner of East end face wall of bridge. Elev. 148.76

H.B. Moore
 Assistant City Engineer
 1/24/78

W.B. Moore
 City Engineer
 1/24/78